

(SUBMIT IN TRIPLICATE)

UNITED STATES
DEPARTMENT OF THE INTERIOR
GEOLOGICAL SURVEY

Land Office _____

Lease No. _____

Unit _____

14-0-101-100

SUNDRY NOTICES AND REPORTS ON WELLS

NOTICE OF INTENTION TO DRILL	SUBSEQUENT REPORT OF WATER SHUT-OFF
NOTICE OF INTENTION TO CHANGE PLANS	SUBSEQUENT REPORT OF SHOOTING OR ACIDIZING
NOTICE OF INTENTION TO TEST WATER SHUT-OFF	SUBSEQUENT REPORT OF ALTERING CASING
NOTICE OF INTENTION TO RE-DRILL OR REPAIR WELL	SUBSEQUENT REPORT OF RE-DRILLING OR REPAIR
NOTICE OF INTENTION TO SHOOT OR ACIDIZE	SUBSEQUENT REPORT OF ABANDONMENT
NOTICE OF INTENTION TO PULL OR ALTER CASING	SUPPLEMENTARY WELL HISTORY
NOTICE OF INTENTION TO ABANDON WELL	

(INDICATE ABOVE BY CHECK MARK NATURE OF REPORT, NOTICE, OR OTHER DATA)

Well No. _____ is located _____ ft. from _____ line and _____ ft. from _____ line of sec. _____.

_____ (Sec. and Sec. No.) _____ (Twp.) _____ (Range) _____ (Meridian)

_____ (Field) _____ (County or Subdivision) _____ (State or Territory)

The elevation of the derrick floor above sea level is _____ ft.

DETAILS OF WORK

(State names of and expected depths to objective sands; show sizes, weights, and lengths of proposed casings; indicate mudding jobs, cementing points, and all other important proposed work)

It is intended to drill a well with rotary tools thru the Mesa Verde formation. This circulation will be used thru the Pictured Cliffs and set intermediate casing. This circulation will be used thru the Mesa Verde and production liner will be set. Possible productive intervals will be perforated and fractured. Oct. 2, 1961.

Casing Program:

10 5/8" at 175' with 150 sacks cement circulated to the surface.

7 7/8" at 342' with 250 sacks cement.

1 1/2" liner at 567' with 500 sacks cement.

The 5/8" of section it is dedicated to the Mesa Verde formation.

The 3/4" of section it is dedicated to the Pictured Cliffs formation.

7/8" at 567'.

I understand that this plan of work must receive approval in writing by the Geological Survey before operations may be commenced.

Company _____

Address _____

Farmington, New Mexico

By _____ Original Signed C. D. COX

Title _____



Well Location and Acreage Dedication Plat

Section A.

Date **APRIL 8, 1959**

Operator **EL PASO NATURAL GAS COMPANY** Lease **SAN JUAN 28-7 UNIT** SF **078972**
 Well No. **106-X(PM)** Unit Letter **M** Section **10** Township **27-N** Range **7-W** NMPM
 Located **800** Feet From **SOUTH** Line, **1150** Feet From **WEST** Line
 County **RIO ARriba** G. L. Elevation **6688** Dedicated Acreage **160 & 320** Acres
 Name of Producing Formation **PICTURED CLIFF & MESA VERDE** Pool **SO. BLANCO PC & BLANCO MV**

1. Is the Operator the only owner in the dedicated acreage outlined on the plat below?

Yes ☒ No ☐2. If the answer to question one is "no", have the interests of all the owners been consolidated by communitization agreement or otherwise? Yes ☐ No ☐ If answer is "yes", Type of Consolidation.

3. If the answer to question two is "no", list all the owners and their respective interests below:

OwnerLand Description

Section B.

This is to certify that the information in Section A above is true and complete to the best of my knowledge and belief.

El Paso Natural Gas Company(Operator)
Original Signed **C. D. COX**

(Representative)

Box 997

(Address)

Farmington, New Mexico

NOTE: THIS PLAT IS RE-ISSUED TO SHOW MOVED LOCATION. ORIGINAL HOLE JUNKED AND ABANDONED. 8 12 59

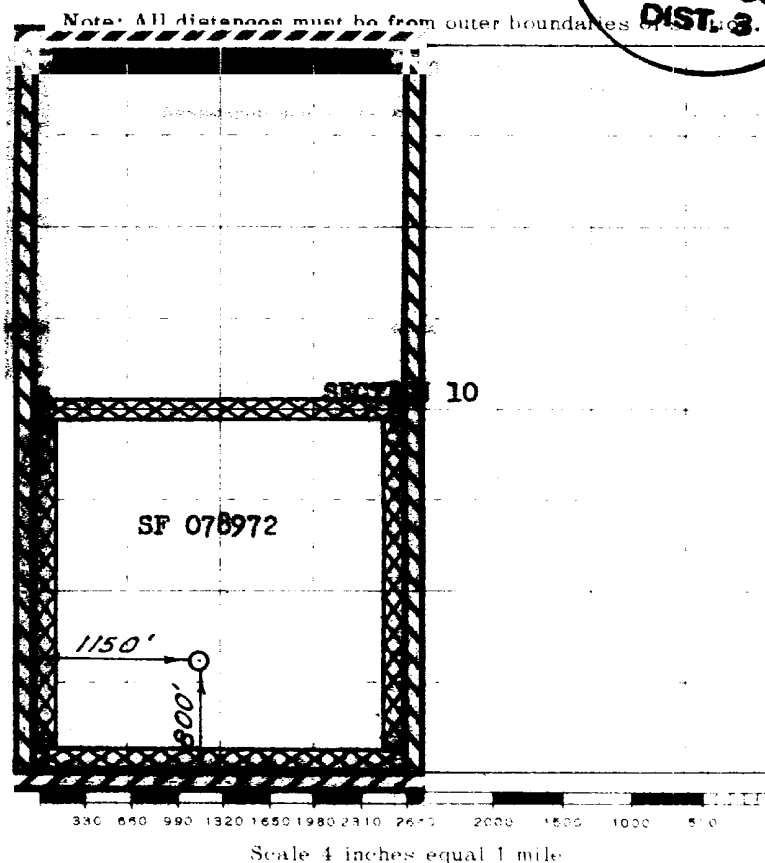

This is to certify that the above plat was prepared from field notes of actual surveys made by me or under my supervision and that the same are true and correct to the best of my knowledge and belief.

(Seal)

Date Surveyed

JANUARY 2, 1959

Farmington, New Mexico

David A. Kilmer
 Registered Professional Engineer and/or Land Surveyor

