

30-045-11888

UNITED STATES  
DEPARTMENT OF THE INTERIOR  
GEOLOGICAL SURVEY

## APPLICATION FOR PERMIT TO DRILL, DEEPEN, OR PLUG BACK

## 1a. TYPE OF WORK

DRILL ☒DEEPEN ☐PLUG BACK ☐

b. ALL

GAS  
WELL ☒

OTHER

SINGLE  
ZONE ☒MULTIPLE  
ZONE ☐

## 2. NAME OF OPERATOR

TENNECO OIL COMPANY

## 3. ADDRESS OF OPERATOR

P. O. BOX 1714, DURANGO, COLORADO 81302

## 4. LOCATION OF WELL (Report location clearly and in accordance with any State requirements.)\*

At surface

Unit 0

At proposed prod. zone 1190' FSL 1530' FEL

## 14. DISTANCE IN MILES AND DIRECTION FROM NEAREST TOWN OR POST OFFICE\*

## 10. DISTANCE FROM PROPOSED\*

LOCATION TO NEAREST  
PROPERTY OR LEASE LINE, FT.  
(Also to nearest drig. unit line, if any)

## 16. NO. OF ACRES IN LEASE

320

17. NO. OF ACRES ASSIGNED  
TO THIS WELL

320

E/C

18. DISTANCE FROM PROPOSED LOCATION\*  
TO NEAREST WELL, DRILLING, COMPLETED,  
OR APPLIED FOR, ON THIS LEASE, FT.

## 19. PROPOSED DEPTH

7600'

## 20. ROTARY OR CABLE TOOLS

Rotary

## 21. ELEVATIONS (Show whether DF, RT, GR, etc.)

6760 GR

## 22. APPROX. DATE WORK WILL START\*

12/8/65

## 23.

## PROPOSED CASING AND CEMENTING PROGRAM

SIZE OF HOLE	SIZE OF CASING	WEIGHT PER FOOT	SETTING DEPTH	QUANTITY OF CEMENT
13 3/4	10 3/4	32.75#	250	150 sx
9 7/8	7 5/8	24#	3100	1st stage 150 sx
6 3/4 7 5/8	4 1/2	11.6# & 10.5#	7600	2nd stage circulate to surface

1st stage 300 sx

2nd stage circulate to surface

We propose to rig up drill to approximate T. D. 7600'. Log, run casing shown above, with stage collar set approximately 300' below bottom of Mesaverde. Perf and frac and complete as a single Dakota. Conduct deliverability tests and run 2 3/8" tbg.

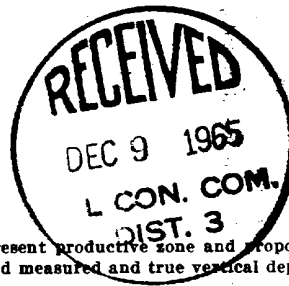

IN ABOVE SPACE DESCRIBE PROPOSED PROGRAM: If proposal is to deepen or plug back, give data on present productive zone and proposed new productive zone. If proposal is to drill or deepen directionally, give pertinent data on subsurface locations and measured and true vertical depths. Give blowout preventer program, if any.

## 24.

SIGNED

*Harold C. Nichols*  
Harold C. Nichols

TITLE Sr. Production Clerk

DATE December 6, 1965

(This space for Federal or State office use)

PERMIT NO.

APPROVAL DATE

APPROVED BY

TITLE

CONDITIONS OF APPROVAL, IF ANY:

Distribution:

5 copies to USGS in Farmington

1 copy to Continental

\*See Instructions On Reverse Side

1 copy to file

RECEIVED

DATE

DEC 8 1965

U. S. GEOLOGICAL SURVEY  
FARMINGTON, N. M.

**NEW MEXICO OIL CONSERVATION COMMISSION  
WELL LOCATION AND ACREAGE DEDICATION PLAT**

Form C-102  
Supersedes C-128  
Effective 1-1-61

All distances must be from the outer boundaries of the Section.

Operator <b>TENNECO OIL COMPANY</b>		Lease <b>SCHWERTFEGER "A"</b>		Well No. <b>5</b>
Unit Letter <b>P 0</b>	Section <b>6</b>	Township <b>27 North</b>	Range <b>8 West</b>	County <b>San Juan</b>
Actual Footage Location of Well: <b>1190</b> feet from the <b>South</b> line and <b>1530</b> feet from the <b>East</b> line				
Ground Level Elev. <b>6760 ungraded</b>	Producing Formation <b>Basin Dakota</b>	Pool <b>Basin Dakota</b>	Dedicated Acreage: <b>E/2</b> <del>320</del> Acres	

1. Outline the acreage dedicated to the subject well by colored pencil or hatchure marks on the plat below. **320.84**
2. If more than one lease is dedicated to the well, outline each and identify the ownership thereof (both as to working interest and royalty).
3. If more than one lease of different ownership is dedicated to the well, have the interests of all owners been consolidated by communitization, unitization, force-pooling, etc?

☐ Yes ☐ No If answer is "yes," type of consolidation \_\_\_\_\_

If answer is "no," list the owners and tract descriptions which have actually been consolidated. (Use reverse side of this form if necessary.) \_\_\_\_\_

No allowable will be assigned to the well until all interests have been consolidated (by communitization, unitization, forced-pooling, or otherwise) or until a non-standard unit, eliminating such interests, has been approved by the Commission.

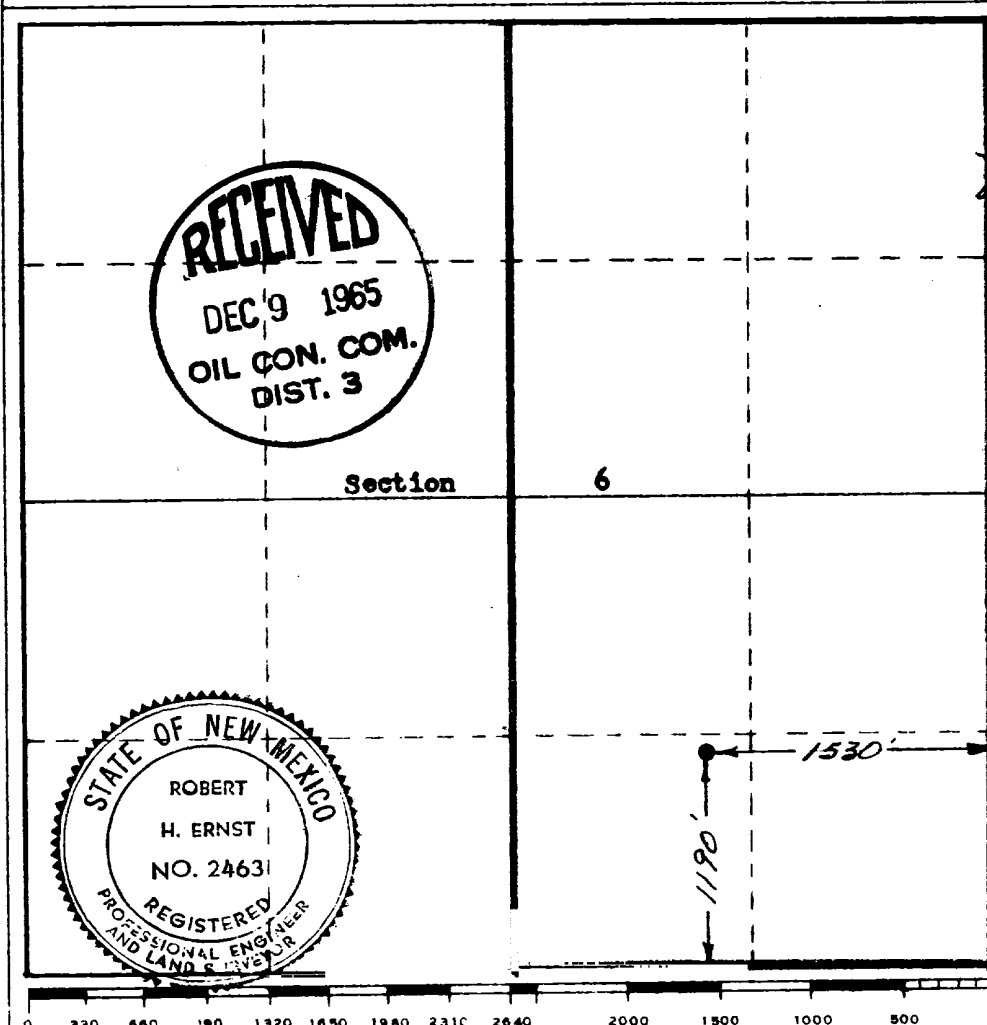

**CERTIFICATION**

I hereby certify that the information contained herein is true and complete to the best of my knowledge and belief.

*Harold C. Nichols*

Name **Harold C. Nichols**  
**Sr. Production Clerk**

Position  
**Tenneco Oil Company**

Company  
**December 6, 1965**

Date

I hereby certify that the well location shown on this plat was plotted from field notes of actual surveys made by me or under my supervision, and that the same is true and correct to the best of my knowledge and belief.

Date Surveyed  
**3 December 1965**

Registered Professional Engineer and/or Land Surveyor

*Robert H. Ernst*  
**ROBERT H. ERNST**

Certificate No.  
**N. Mex. PE & LS 2463**

**Ernst Engineering Company, Durango, Colorado**

TENNECO OIL COMPANY

3-25-68

## WELLS REQUIRING FILE CORRECTIONS ONLY

<u>LEASE NAME &amp; WELL NUMBER</u>	<u>LOCATION</u>	<u>POOL</u>	<u>PRESENT ACREAGE</u>	<u>CORRECT ACREAGE</u>
Jicarilla A #1	L-18-26N-5W	Basin Dakota	W 320	W 319.20 ✓
Jicarilla A #4	K-19-26N-5W	Basin Dakota	W 320	W 319.16 ✓
Foster #2	D-18-26N-7W	Basin Dakota	W 320	W 319.52 ✓
Moore B #1	G-3-26N-11W	Basin Dakota	E 320	E 319.63 ✓
Dawson A #1	N-4-27N-8W	Blanco MV	W 320	W 321.33 ✓
Dawson A #1	N-4-27N-8W	Basin Dakota	W 320	W 321.33 ✓
Schwerdtfeger A #3	D-6-27N-8W	Basin Dakota	W 320	W 320.68 ✓
Schwerdtfeger A #5	O-6-27N-8W	Basin Dakota	E 320	E 320.84 ✓
Florance #65	E-18-27N-8W	Basin Dakota	W 320	W 321.70 ✓
Lodewick #4	F-18-27N-9W	Basin Dakota	N 320	N 321.32 ✓
Lodewick #3	M-18-27N-9W	Basin Dakota	S 320	S 321.08 ✓
Bolack A #1	B-2-27N-11W	Basin Dakota	N 320	N 322.68 ✓
Schwerdtfeger A #2 X	D-31-28N-8W	Basin Dakota	W 291	W 291.16 ✓
Storey C #2	M-35-28N-9W	Basin Dakota	W 320	W 323.65 ✓
Schwerdtfeger A #1	C-36-28N-9W	Basin Dakota	W 320	W 318.85 ✓
Florance #30	M-1-29N-8W	Blanco MV	W 323.09	W 323.15 ✓
Florance #30	M-1-29N-8W	Basin Dakota	W 320	W 323.15 ✓
Florance #41	A-21-29N-9W	Blanco MV	E 312.90	E 312.80 ✓
Florance #96	H-24-29N-9W	Blanco PC	148.50	148.54 ✓
Dudley Cornell A #1	O-1-29N-12W	Basin Dakota	E 320	E 319.60 ✓
Central Cha Cha Unit #6	N-30-29N-13W	Cha Cha Gal.	85 (S/2 SW/4 & SW/4 SE/4)	86.09 ✓
Pritchard #1	M-1-30N-9W	Basin Dakota	W 320	W 323 ✓
Florance #47 X	G-5-30N-9W	Blanco PC	160	161.80 ✓
Florance #47 X	G-5-30N-9W	Blanco MV	E 320	E 321.80 ✓
Blanco Com 1 #1	G-2-30N-11W	Blanco MV	E 320	E 320.30 ✓
Blanco Com 2 #1	K-2-30N-11W	Blanco MV	W 320	W 320.10 ✓
Coldiron Com A #1	K-2-30N-11W	Basin Dakota	W 320	W 320.10 ✓