

UNITED STATES
DEPARTMENT OF THE INTERIOR
GEOLOGICAL SURVEY

31 045
647-20009

APPLICATION FOR PERMIT TO DRILL, DEEPEN, OR PLUG BACK

1a. TYPE OF WORK
 DRILL DEEPEN PLUG BACK

b. TYPE OF WELL
 OIL WELL GAS WELL OTHER SINGLE ZONE MULTIPLE ZONE

2. NAME OF OPERATOR
 El Paso Natural Gas Company

3. ADDRESS OF OPERATOR
 Box 990, Farmington, New Mexico

4. LOCATION OF WELL (Report location clearly and in accordance with any State requirements.*)
 At surface 890'S, 890'E
 At proposed prod. zone

14. DISTANCE IN MILES AND DIRECTION FROM NEAREST TOWN OR POST OFFICE*

15. DISTANCE FROM PROPOSED* LOCATION TO NEAREST PROPERTY OR LEASE LINE, FT. (Also to nearest drig. unit line, if any)

16. NO. OF ACRES IN LEASE

17. NO. OF ACRES ASSIGNED TO THIS WELL
 320

18. DISTANCE FROM PROPOSED LOCATION* TO NEAREST WELL, DRILLING, COMPLETED, OR APPLIED FOR, ON THIS LEASE, FT.

19. PROPOSED DEPTH
 6750'

20. ROTARY OR CABLE TOOLS
 Rotary

21. ELEVATIONS (Show whether DF, RT, GR, etc.)
 6711' GL

22. APPROX. DATE WORK WILL START*
 1-30-67

5. LEASE DESIGNATION AND SERIAL NO.
 SF 078001-B

6. IF INDIAN, ALLOTTEE OR TRIBE NAME

7. UNIT AGREEMENT NAME
 Huerfano Unit

8. FARM OR LEASE NAME
 Huerfano Unit

9. WELL NO.
 132

10. FIELD AND POOL, OR WILDCAT
 Basin Dakota

11. SEC., T., R., M., OR BLK. AND SURVEY OR AREA
 Sec. 26, T-26-N, R-10-W
 N.M.P.M.

12. COUNTY OR PARISH
 San Juan

13. STATE
 New Mexico

23. PROPOSED CASING AND CEMENTING PROGRAM

SIZE OF HOLE	SIZE OF CASING	WEIGHT PER FOOT	SETTING DEPTH	QUANTITY OF CEMENT
12 1/4"	6 5/8"	24#	300'	210 Sks. to circulate
7 7/8"	4 1/2"	10.5#	6750'	600 Sks. - 3 Stages



Cementing Production Casing:
 1st Stage to cover from total depth to top of Gallup formation.
 Second Stage to cover from top of Mancos to top of Mesa Verde formation.
 Third Stage to cover from Lewis to base of Ojo Alamo formation.

The Dakota formation will be selectively perforated and sand water fraced.

The E/2 of Section 26 is dedicated to this well.

IN ABOVE SPACE DESCRIBE PROPOSED PROGRAM: If proposal is to deepen or plug back, give data on present productive zone and proposed new productive zone. If proposal is to drill or deepen directionally, give pertinent data on subsurface locations and measured and true vertical depths. Give blowout preventer program, if any.

24. Original signed by
 SIGNED Carl E. Matthews TITLE Petroleum Engineer DATE 1-26-67

(This space for Federal or State office use)

PERMIT NO. _____ APPROVAL DATE _____

APPROVED BY [Signature] TITLE _____ DATE _____

CONDITIONS OF APPROVAL, IF ANY:

Instructions

General: This form is designed for submitting proposals to perform certain well operations, as indicated, on all types of lands and leases for appropriate action by either a Federal or a State agency or both, pursuant to applicable Federal and/or State laws and regulations. Any necessary special instructions concerning the use of this form and the number of copies to be submitted, particularly with regard to local, area, or regional procedures and practices, either are shown below or will be issued by, or may be obtained from, the local Federal and/or State office.

Item 1: If the proposal is to redrill to the same reservoir at a different subsurface location or to a new reservoir, use this form with appropriate notations. Consult applicable State or Federal regulations concerning subsequent work proposals or reports on the well.

Item 4: If there are no applicable State requirements, locations on Federal or Indian land should be described in accordance with Federal requirements. Consult local State or Federal office for specific instructions.

Item 14: Needed only when location of well cannot readily be found by road from the land or lease description. A plat, or plats, separate or on this reverse side, showing the roads to, and the surveyed location of, the well, and any other required information, should be furnished when required by Federal or State agency offices.

Items 15 and 18: If well is to be, or has been directionally drilled, give distances for subsurface location of hole in any present or objective production zone.

Item 22: Consult applicable Federal or State regulations, or appropriate officials, concerning approval of the proposal before operations are started.

**NEW MEXICO OIL CONSERVATION COMMISSION
WELL LOCATION AND ACERAGE DEDICATION PLAT**

All distances must be from the outer boundaries of the Section

Operator EL PASO NATURAL GAS COMPANY Well No. 132
 Unit Letter P Section 26-1 Township 26-1 Range 10-N County SAN JUAN
 Actual Footage Location of Well: 890 feet from SOUTH line 890 feet from EAST line
 Ground Level Elev. 6711 DAKOTA BASIN DAKOTA Section Average: 320.00 Acres

1. Outline the acreage dedicated to the subject well by centre line and/or acreage marks on the plat below.
2. If more than one tract is dedicated to the well, list each tract, giving the owner, his share, both as to working interest and royalty.
3. If more than one lease or interest in well acreage is dedicated to the well, have the interests of all owners been consolidated by communitization or other force majeure?

Yes No If answer is "yes," describe nature of consolidation Unitization
 If answer is "no," list the owners and tract location which have not been consolidated. (Use reverse side of this Form if necessary.)

No allowable well be assigned to the well and acreage have been consolidated by communitization, unitization, forced-pooling, or otherwise) and that a permit has been issued therefor and the same has been approved by this Commission.

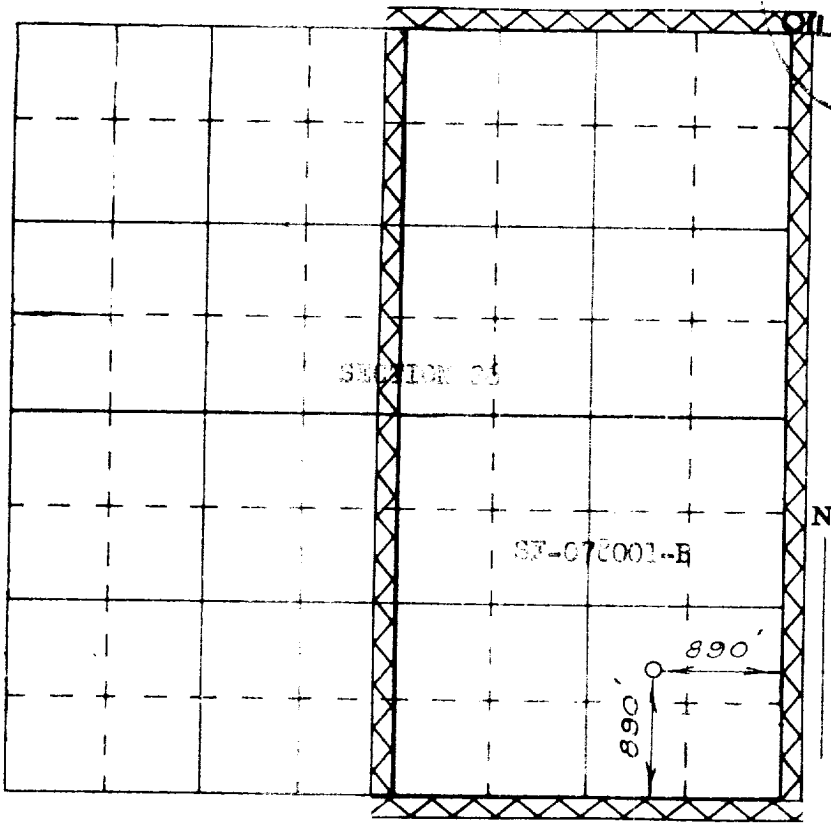

CERTIFICATION

I hereby certify that the information contained herein is true and complete to the best of my knowledge and belief
 Original signed by Carl E. Matthews
Petroleum Engineer
El Paso Natural Gas Company
January 26, 1967

I hereby certify that the well location shown on this plat was plotted from field notes of actual surveys made by me or under my supervision, and that the same is true and correct to the best of my knowledge and belief

JANUARY 16, 1967
 Registered Professional Engineer
 and Licensed Surveyor
Paul O. Kilmer
 Certificate No. 1740