

UNITED STATES
DEPARTMENT OF THE INTERIOR
GEOLOGICAL SURVEY

APPLICATION FOR PERMIT TO DRILL, DEEPEN, OR PLUG BACK

1a. TYPE OF WORK DRILL ☒ DEEPEN ☐ PLUG BACK ☐b. TYPE OF WELL
OIL WELL ☒ GAS WELL ☐ OTHER ☐ SINGLE ZONE ☒ MULTIPLE ZONE ☐

2. NAME OF OPERATOR

AMOCO PRODUCTION COMPANY

3. ADDRESS OF OPERATOR

501 Airport Drive, Farmington, New Mexico 87401

4. LOCATION OF WELL (Report location clearly and in accordance with any State requirements.)*
At surface 1830' FNL & 610' FLL, SECTION 15, T-26N, R-18W

At proposed prod. zone

Same

CONFIDENTIAL

14. DISTANCE IN MILES AND DIRECTION FROM NEAREST TOWN OR POST OFFICE*

21 miles south of Shiprock, New Mexico

15. DISTANCE FROM PROPOSED*
LOCATION TO NEAREST
PROPERTY OR LEASE LINE, FT.
(Also to nearest drlg. unit line, if any)

610'

18. DISTANCE FROM PROPOSED LOCATION*
TO NEAREST WELL, DRILLING, COMPLETED,
OR APPLIED FOR, ON THIS LEASE, FT.

4110'

16. NO. OF ACRES IN LEASE

2544.50

19. PROPOSED DEPTH

6450'

17. NO. OF ACRES ASSIGNED
TO THIS WELL

160

21. ELEVATIONS (Show whether DF, RT, GR, etc.)

To be determined

23.

PROPOSED CASING AND CEMENTING PROGRAM

SIZE OF HOLE	SIZE OF CASING	WEIGHT PER FOOT	SETTING DEPTH	QUANTITY OF CEMENT
17-1/4"	13-3/8"	48#	100'	100 sx
12-1/4"	9-5/8"	32.3#	1500'	500 sx
8-3/4"	7"	20# & 23#	6450'	300 sx

Amoco Production Company proposes to drill the subject well to test the Pennsylvanian Formation. Intermediate casing will be set across the Morrison water zones. The well will then be drilled through the Pennsylvanian and completion designed from open hole logs. A copy of all logs will be furnished to your office upon completion. A copy of the Location Plat is attached.

This is a "Tight Hole" and all information is confidential until released by Amoco Production Company.

CONFIDENTIAL

IN ABOVE SPACE DESCRIBE PROPOSED PROGRAM: If proposal is to deepen or plug back, give data on present productive zone and proposed new productive zone. If proposal is to drill or deepen directionally, give pertinent data on subsurface locations and measured and true vertical depths. Give blowout preventer program, if any.

24.

Original: [Signature]
J. ARKINSON

TITLE Area Engineer

DATE December 4, 1973

SIGNED

(This space for Federal or State office use)

PERMIT NO.

APPROVAL DATE

APPROVED BY

CONDITIONS OF APPROVAL, IF ANY:

TITLE

*See Instructions On Reverse Side

30-045-21386

5. LEASE DESIGNATION AND SERIAL NO.

14-20-603-3034

6. IF INDIAN, ALLOTTEE OR TRIBE NAME

Navajo Tribe

7. UNIT AGREEMENT NAME

8. FARM OR LEASE NAME

Navajo Tribal "U"

9. WELL NO.

19

10. FIELD AND POOL, OR WILDCAT

Tocito Dome Penn. "D"

11. SEC., T., R., M., OR BLK.
AND SURVEY OR AREA

SE/4 NE/4 Section 15,

T-26-N, R-18-W

12. COUNTY OR PARISH

San Juan

13. STATE

New Mexico

RECEIVED

DEC 6 1973

22. APPROX. DATE WORK WILL START*

December 1973

OIL CON. COM
DIST. 3

100 sx

500 sx

300 sx

RECEIVED

DEC 5 1973

U. S. GEOLOGICAL SURVEY

Instructions

General: This form is designed for submitting proposals to perform certain well operations, as indicated, on all types of lands and leases for appropriate action by either a Federal or a State agency, or both, pursuant to applicable Federal and/or State laws and regulations. Any necessary special instructions concerning the use of this form and the number of copies to be submitted, particularly with regard to local, area, or regional procedures and practices, either are shown below or will be issued by, or may be obtained from, the local Federal and/or State office.

Item 1: If the proposal is to redrill to the same reservoir at a different subsurface location or to a new reservoir, use this form with appropriate notations. Consult applicable State or Federal regulations concerning subsequent work proposals or reports on the well.

Item 4: If there are no applicable State requirements, locations on Federal or Indian land should be described in accordance with Federal requirements. Consult local State or Federal office for specific instructions.

Item 14: Needed only when location of well cannot readily be found by road from the land or lease description. A plat, or plats, separate or on this reverse side, showing the roads to, and the surveyed location of, the well, and any other required information, should be furnished when required by Federal or State agency offices.

Items 15 and 18: If well is to be, or has been directionally drilled, give distances for subsurface location of hole in any present or objective production zone.

Item 22: Consult applicable Federal or State regulations, or appropriate officials, concerning approval of the proposal before operations are started.

**NEW MEXICO OIL CONSERVATION COMMISSION
WELL LOCATION AND ACREAGE DEDICATION PLAT**

Form C-102
Supersedes C-128
Effective 1-1-65

All distances must be from the outer boundaries of the Section.

Operator Amoco Production Company			Lease Navajo Tribal "U"		Well No. 19
Unit Letter H	Section 15	Township 26N	Range 18W	County San Juan	
Actual Footage Location of Well: 1830 feet from the North line and 610 feet from the East line					
Ground Level Elev: 5660 ungraded	Producing Formation Pennsylvanian "D"	Pool Tocito Dome Penn. "D" <i>ex</i>		Dedicated Acreage: 160 Acres	

1. Outline the acreage dedicated to the subject well by colored pencil or hachure marks on the plat below.
2. If more than one lease is dedicated to the well, outline each and identify the ownership thereof (both as to working interest and royalty).
3. If more than one lease of different ownership is dedicated to the well, have the interests of all owners been consolidated by communitization, unitization, force-pooling, etc?

☐ Yes ☐ No If answer is "yes," type of consolidation _____

If answer is "no," list the owners and tract descriptions which have actually been consolidated (Use reverse side of this form if necessary.) _____

No allowable will be assigned to the well until all interests have been consolidated (by communitization, unitization, forced-pooling, or otherwise) or until a non-standard unit, eliminating such interests, has been approved by the Commission.

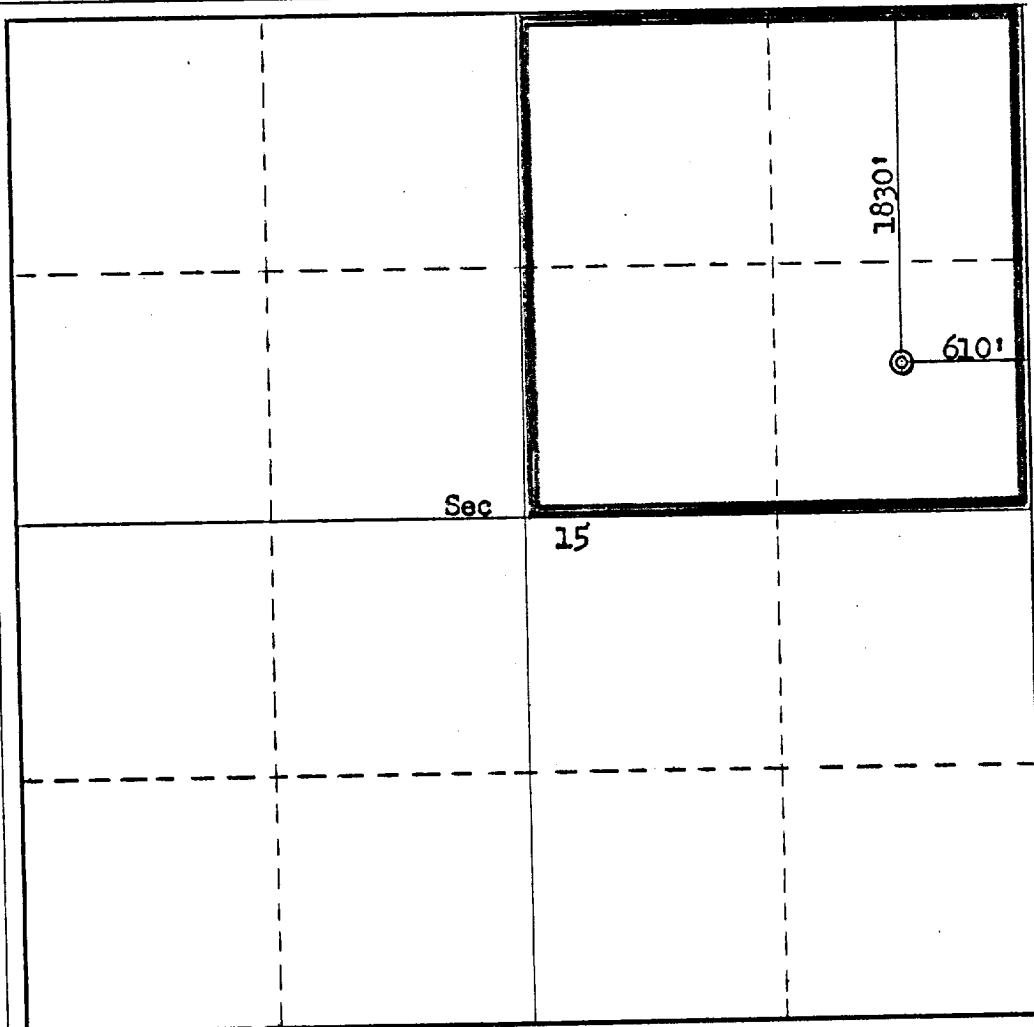
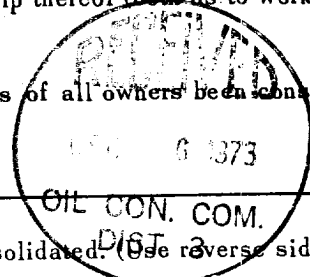

CERTIFICATION

I hereby certify that the information contained herein is true and complete to the best of my knowledge and belief.

J. Arnold Snell

Name
J. Arnold Snell

Position
Area Engineer

Company
AMOCO PRODUCTION COMPANY

Date
December 4, 1973

I hereby certify that the well location shown on this plat was plotted from field notes of actual surveys made by me or under my supervision, and that the same is true and correct to the best of my knowledge and belief.

Date Surveyed
December 3, 1973

Registered Professional Engineer and/or Land Surveyor

Fred B. Kerr Jr.
Fred B. Kerr Jr.

Certificate No.
3950



DEVELOPMENT PLAN FOR SURFACE USE
NAVAJO TRIBAL "U" NO. 19
SAN JUAN COUNTY, NEW MEXICO

Amoco Production Company proposes to drill the subject well with rotary tools on a graded location as shown on the attachments. The location is in accordance with NMOCC Order R-2758. Established roads exist in the area and only 2600 feet of new road will need to be constructed. Archeological clearance to drill this well has been obtained from the proper authorities. Clearance to perform work on this location will also be obtained from the Navajo Tribe.

No airstrips or field camps will be built and none exist nearby. There are no trees in the area and therefore no timber damage will result. Vegetation in the area is extremely sparse and consists primarily of tumbleweed. As the well is located in the middle of an active oil field, Amoco has previously completed a water source well. All water for drilling operations will come from this well. Upon completion of the subject well the location will be thoroughly cleaned and the reserve pit backfilled.

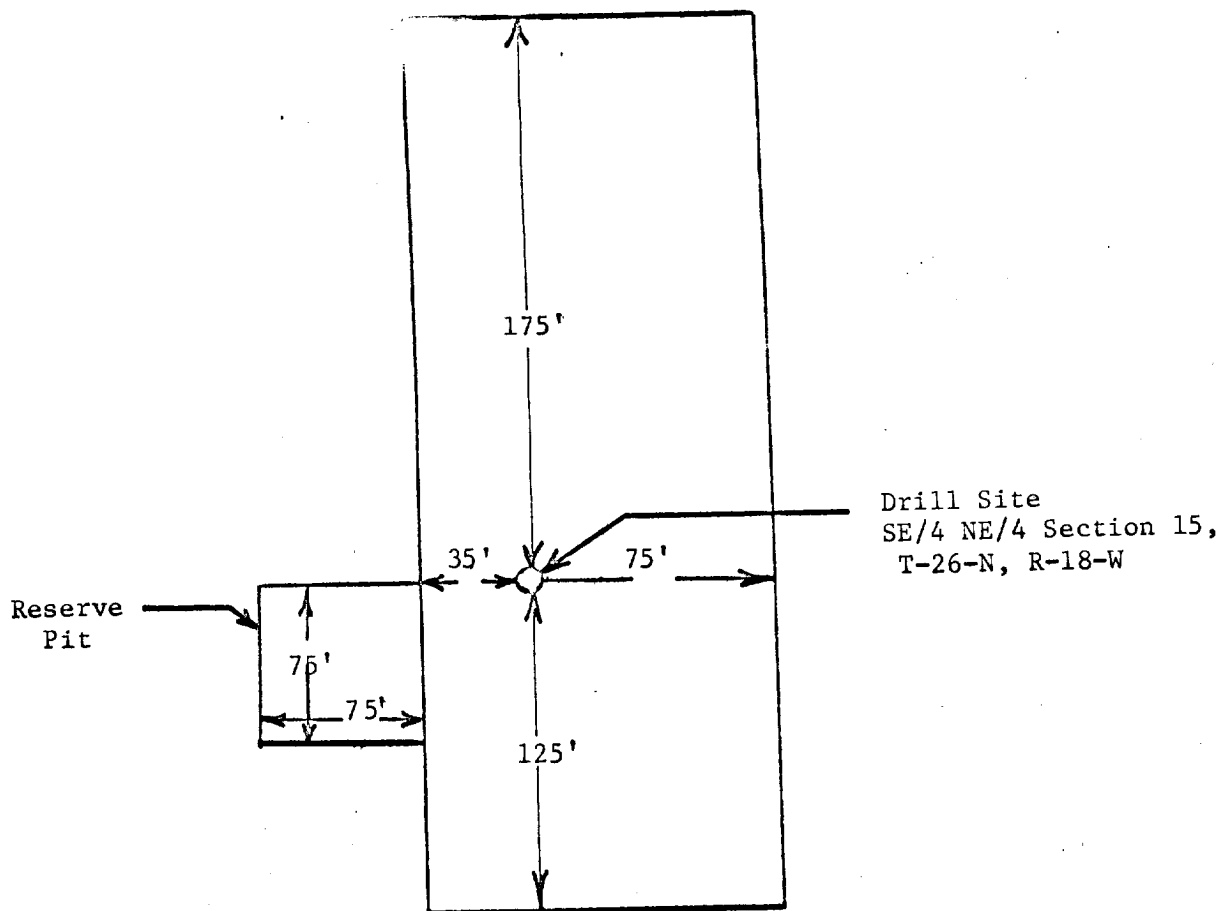
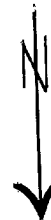

CONFIDENTIAL

Amoco Production Company	SCALE: None
DRILLING LOCATION DIAGRAM NAVAJO TRIBAL "U" NO. 19 - TOCITO DOME FIELD	DRG. NO. 73-JWC-1204

R 18 W

NAVAJO INDIAN
RESERVATION

Four
Corner
Pump
Sta

Pig Trap
Water Runs

State Hwy 66

CONFIDENTIAL

BLANCA

