

30-045-21771

NO. OF COPIES RECEIVED	6
DISTRIBUTION	
SANTA FE	1
FILE	1
U.S.G.S.	2
LAND OFFICE	1
OPERATOR	1

NEW MEXICO OIL CONSERVATION COMMISSION

Form C-101
Revised 1-1-65

5A. Indicate Type of Lease
STATE FEE

5. State Oil & Gas Lease No.
L 4640-1

APPLICATION FOR PERMIT TO DRILL, DEEPEN, OR PLUG BACK

1a. Type of Work
DRILL DEEPEN PLUG BACK

b. Type of Well
OIL WELL GAS WELL OTHER SINGLE ZONE MULTIPLE ZONE

2. Name of Operator
Jerome P. McHugh

3. Address of Operator
Box 234, Farmington, New Mexico 87401

4. Location of Well
UNIT LETTER A LOCATED 990 FEET FROM THE North LINE
AND 990 FEET FROM THE East LINE OF SEC. 16 TWP. 26N RGE. 12W NMPM

7. Unit Agreement Name
8. Farm or Lease Name
Chaco Plant
9. Well No.
1
10. Field and Pool, or Wildcat
Wildcat
12. County
San Juan

19. Proposed Depth
1300'
19A. Formation
Pictured Cliffs
20. Rotary or C.T.
Rotary

21. Elevations (Show whether DF, RT, etc.)
6060' GR
21A. Kind & Status Plug. Bond
Statewide
21B. Drilling Contractor
Joe Morrow
22. Approx. Date Work will start
5-1-75

PROPOSED CASING AND CEMENT PROGRAM

SIZE OF HOLE	SIZE OF CASING	WEIGHT PER FOOT	SETTING DEPTH	SACKS OF CEMENT	EST. TOP
7-7/8"	5-1/2"	14#	50'	10	Surface
4-3/4"	2-7/8"	6.5#	1300'	100	700

Drill well to test Pictured Cliffs formation using slim hole technique. Plan to set 2-7/8" tubing for casing through Pictured Cliffs formation, selectively perforate, and frac. Clean out after frac, run 1-1/4" tubing and complete well.

We do not plan to use blowout preventor while drilling well. We will use master valve and stripper head while completing well.

APPROVAL VALID
FOR 90 DAYS UNLESS
DRILLING COMMENCED,
EXPIRES 7-22-75

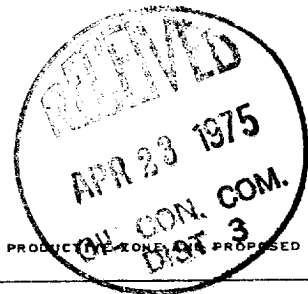

IN ABOVE SPACE DESCRIBE PROPOSED PROGRAM: IF PROPOSAL IS TO DEEPEN OR PLUG BACK, GIVE DATA ON PRESENT PRODUCTION ZONE & PROPOSED NEW PRODUCTION ZONE. GIVE BLOWOUT PREVENTER PROGRAM, IF ANY.

I hereby certify that the information above is true and complete to the best of my knowledge and belief.

Signed Thomas A. Dugan Title Engineer Date 4-21-75

(This space for State Use)

SUPERVISOR DIST. #3

APR 23 1975

APPROVED BY [Signature] TITLE _____ DATE _____

CONDITIONS OF APPROVAL, IF ANY:

NEW MEXICO OIL CONSERVATION COMMISSION
WELL LOCATION AND ACREAGE DEDICATION PLAT

Form C-102
Supersedes C-128
Effective 1-1-65

All distances must be from the outer boundaries of the Section.

Operator Jerome P. McHugh		Lease Chaco Plant			Well No. 1
Unit Letter A	Section 16	Township 26 North	Range 12 West	County San Juan	
Actual Footage Location of Well: 990 feet from the North line and 990 feet from the East line					
Ground Level Elev. 6060	Producing Formation Pictured Cliffs		Pool Wildcat		Dedicated Acreage: 160 Acres

1. Outline the acreage dedicated to the subject well by colored pencil or hachure marks on the plat below.
2. If more than one lease is dedicated to the well, outline each and identify the ownership thereof (both as to working interest and royalty).
3. If more than one lease of different ownership is dedicated to the well, have the interests of all owners been consolidated by communitization, unitization, force-pooling, etc?

Yes No If answer is "yes," type of consolidation _____
If answer is "no," list the owners and tract descriptions which have actually been consolidated (Use reverse side of this form if necessary.) _____

No allowable will be assigned to the well until all interests have been consolidated (by communitization, unitization, forced-pooling, or otherwise) or until a non-standard unit, eliminating such interests, has been approved by the Commission.

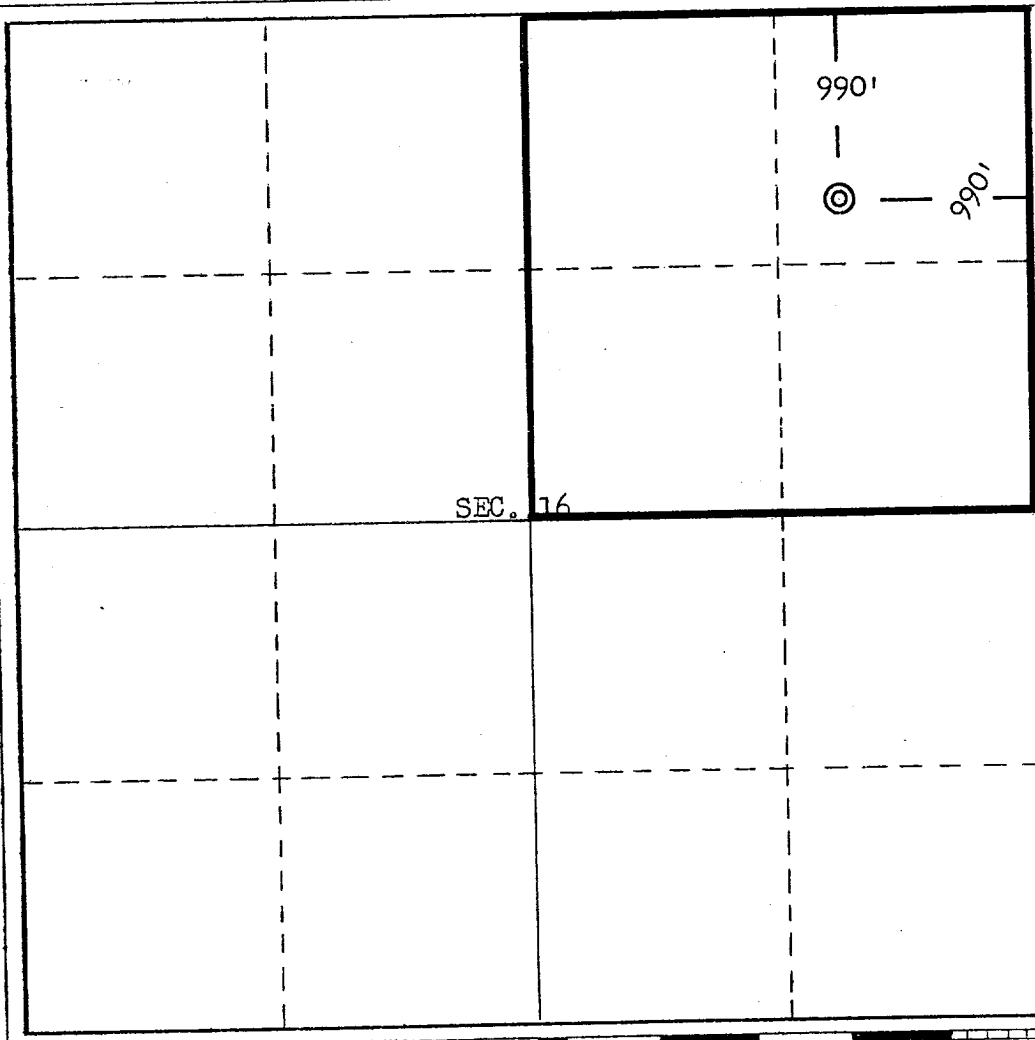
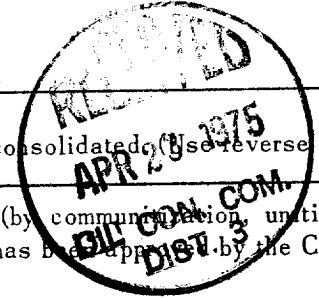

CERTIFICATION

I hereby certify that the information contained herein is true and complete to the best of my knowledge and belief.

Thomas A. Dugan
Name
Thomas A. Dugan
Position
Engineer
Company
Jerome P. McHugh

Date
4-21-75

I hereby certify that the well location shown on this plat was plotted from field notes of actual surveys made by me or under my supervision, and that the same are correct to the best of my knowledge and belief.
E. V. ECHCHAWK

Date Surveyed
April 4, 1975
Registered Professional Engineer
and/or Land Surveyor

E. V. Echchawk
Certificate No. 3602
E.V. Echchawk IS

