

UNITED STATES
DEPARTMENT OF THE INTERIOR
GEOLOGICAL SURVEY

APPLICATION FOR PERMIT TO DRILL, DEEPEN, OR PLUG BACK

1a. TYPE OF WORK

DRILL ☒DEEPEN ☐PLUG BACK ☐

b. TYPE OF WELL

OIL
WELL ☐GAS
WELL ☒

OTHER

SINGLE
ZONE ☐MULTIPLE
ZONE ☒

2. NAME OF OPERATOR

J. Gregory Merrion and Robert L. Bayless

3. ADDRESS OF OPERATOR

P.O. Box 1541, Farmington, NM 87401

4. LOCATION OF WELL (Report location clearly and in accordance with any State requirements.)*

At surface

790 FNL and 1450 FEL

At proposed prod. zone

Same

14. DISTANCE IN MILES AND DIRECTION FROM NEAREST TOWN OR POST OFFICE*

20 Miles South of Farmington

15. DISTANCE FROM PROPOSED*

LOCATION TO NEAREST

PROPERTY OR LEASE LINE, FT.

(Also to nearest drlg. unit line, if any)

790 ft.

16. NO. OF ACRES IN LEASE

1,274.48

17. NO. OF ACRES ASSIGNED
TO THIS WELL

160

18. DISTANCE FROM PROPOSED LOCATION*

TO NEAREST WELL, DRILLING, COMPLETED,
OR APPLIED FOR, ON THIS LEASE, FT.

530 ft.

19. PROPOSED DEPTH

1475 ft.

20. ROTARY OR CABLE TOOLS

Rotary

21. ELEVATIONS (Show whether DF, RT, GR, etc.)

6101 Ground Level

22. APPROX. DATE WORK WILL START*

As soon as possible

23.

PROPOSED CASING AND CEMENTING PROGRAM

SIZE OF HOLE	SIZE OF CASING	WEIGHT PER FOOT	SETTING DEPTH	QUANTITY OF CEMENT
9-3/4"	7"	23 lb./ft.	40 ft.	10 sacks
5"	2-7/8"	6.4 lb./ft.	1475 ft.	150 sacks

Will drill 9-3/4" hole to 40 ft. and set 40 ft. of 7", 23 lb./ft. casing with 10 sacks of cement. Will drill 5" hole to 1475 ft. and run open hole logs. If appears productive, will run 1475 ft. of 2-7/8", 6.4 lb./ft., J-55 casing and cement with 150 sacks. Will perforate and stimulate as required. Minimum specifications for pressure control equipment which is to be used - none required. Circulating medium will be clear water and natural mud with water loss control additives. The gas from this formation is not dedicated.

ESTIMATED TOPS

FORMATION

DEPTH

CONTENT

Ojo Alamo

280 ft.

Water

Kirtland

415 ft.

Fruitland

1100 ft.

Natural gas, salt water

Pictured Cliff

1360 ft.

Natural gas, salt water

IN ABOVE SPACE DESCRIBE PROPOSED PROGRAM: If proposal is to deepen or plug back, give data on present productive zone and proposed new productive zone. If proposal is to drill or deepen directionally, give pertinent data on subsurface locations and measured and true vertical depths. Give blowout preventer program, if any.

24.

SIGNED

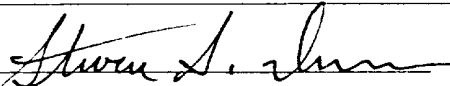

TITLE

Engineer

DATE

02-26-79

(This space for Federal or State office use)

PERMIT NO.

APPROVAL DATE

APPROVED BY

TITLE

CONDITIONS OF APPROVAL, IF ANY:



*See Instructions On Reverse Side

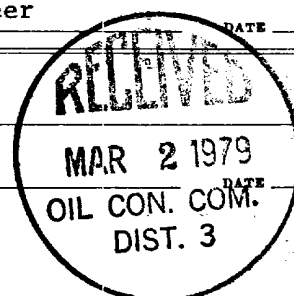

**NEW MEXICO OIL CONSERVATION COMMISSION
WELL LOCATION AND ACREAGE DEDICATION PLAT**

Form C-102
Supersedes C-128
Effective 1-1-65

All distances must be from the outer boundaries of the Section.

Operator MERRION & BAYLESS			Lease WESTERN-FEDERAL		Well No. 8
Unit Letter B	Section 18	Township 26N	Range 11W	County San Juan	
Actual Footage Location of Well: 790 feet from the North line and 1450 feet from the East line					
Ground Level Elev. 6101	Producing Formation Fruitland Pictured Cliffs		Pool South Gallegos ext Undesignated	Dedicated Acreage: 160 Acres	

1. Outline the acreage dedicated to the subject well by colored pencil or hachure marks on the plat below.
2. If more than one lease is dedicated to the well, outline each and identify the ownership thereof (both as to working interest and royalty).
3. If more than one lease of different ownership is dedicated to the well, have the interests of all owners been consolidated by communitization, unitization, force-pooling, etc?

☒ Yes ☐ No If answer is "yes," type of consolidation Communitization

If answer is "no," list the owners and tract descriptions which have actually been consolidated. (Use reverse side of this form if necessary.) _____

No allowable will be assigned to the well until all interests have been consolidated (by communitization, unitization, forced-pooling, or otherwise) or until a non-standard unit, eliminating such interests, has been approved by the Commission.

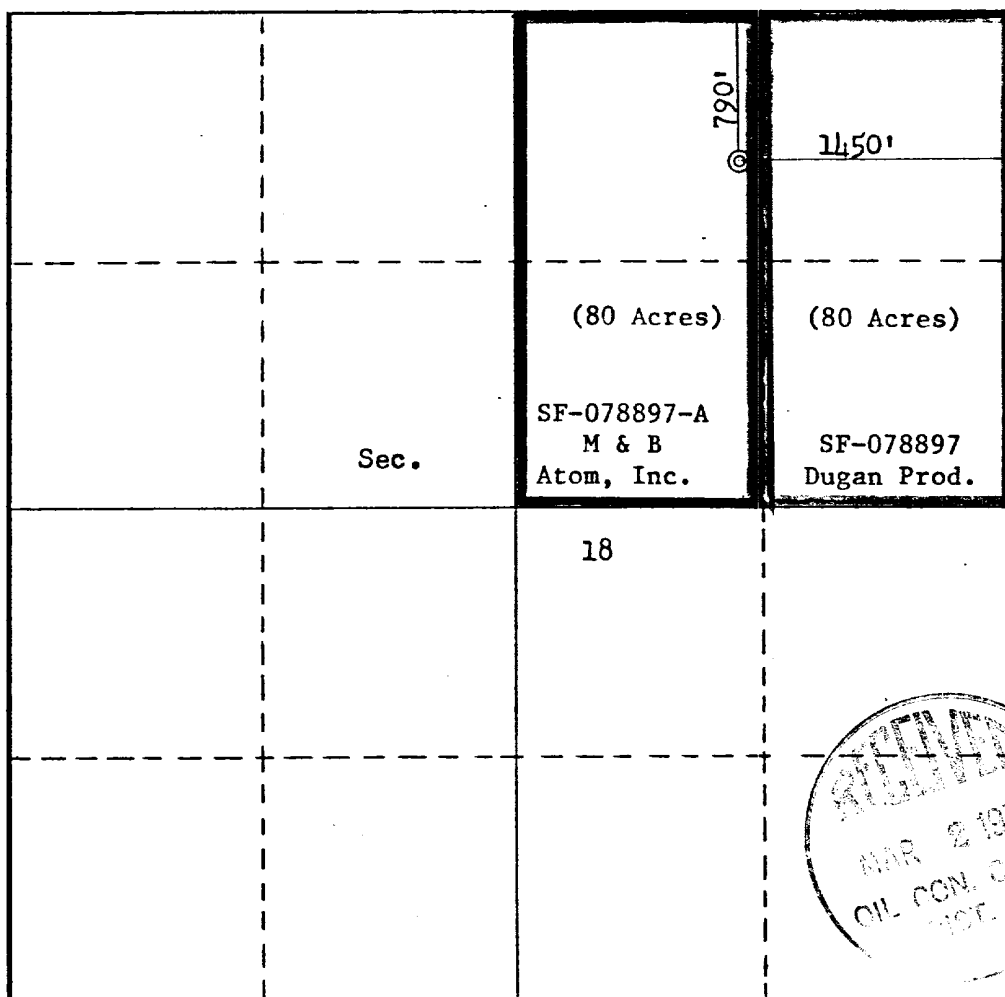

CERTIFICATION

I hereby certify that the information contained herein is true and complete to the best of my knowledge and belief.

Steven S. Dunn
Name

Engineer

Position
Merrion & Bayless

Company
February 26, 1979

Date

I hereby certify that the well location shown on this plat was plotted from field notes of actual surveys made by me or under my supervision, and that the same is true and correct to the best of my knowledge and belief.

Date Surveyed

February 26, 1979

Registered Professional Engineer and/or Land Surveyor

Fred B. Kerr
Fred B. Kerr

Certificate No.

3950

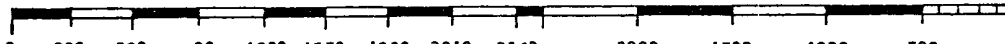

SURFACE USE AND OPERATIONS PLAN

MERRION & BAYLESS
Western Federal #8
Section 18, T26N, R11W

- 1 & 2. A topographical map is attached showing location of drillsite and access roads to location; new roads are color coded on the location map. The terrain is relatively flat and no improvements are planned on existing roads. A drive in truck mounted drilling rig will be used and will be driven in to the location with our road work. Our planned access road will be twelve feet in width, and will follow the existing terrain. No turnouts, culverts or cuts and fills are anticipated on the proposed access. In addition, natural drainage and surfacing material will be used.
3. Wells within one mile radius are shown on the topographical map.
4. A. Existing facilities owned or controlled by the Operator and shown on the attached map are as follows: Wellheads, pumping units.
B. No new facilities are contemplated.
C. Disturbed areas will be reseeded per BLM specifications.
5. A. Water will be hauled from the San Juan River.
B. Truck will haul water on proposed access route shown.
6. No construction materials will be used.
7. Methods of disposal of waste materials:
 - A. Cuttings will be buried in drilling pit.
 - B. Drilling fluids will be buried in drilling pit.
 - C. No produced fluids are anticipated.
 - D. Sewage will be buried.
 - E. Garbage and other waste material will be buried.
 - F. Operator will clean up, fill, and level pits and reseed location per BLM specifications.
8. No ancillary facilities.
9. Wellsite layout attached.
10. Restoration of drillsite -- pits will be filled and leveled and reseeded per BLM Specifications immediately after completion.
11. Other information: The lease is on Navajo Tribal surface land. The drillsite is fairly level, arid land with very little vegetation. There is no other surface use or facilities existent. An archeological survey statement will be furnished.
12. Operator representative: Robert L. Bayless
P.O. Box 1541
Farmington, NM 87401 (505) 325-5093
13. Certification:

I hereby certify that I, or persons under my direct supervision, have inspected the proposed drillsite and access route; that I am familiar with the conditions which presently exist; that the statements made in this plan are, to the best of my knowledge, true and correct; and, that the work associated with the operations proposed herein will be performed by Merrion & Bayless and its contractors and subcontractors in conformity with this plan and the terms and conditions under which it is approved.

02-27-79
Date: _____

ROBERT L. BAYLESS
Co-Owner
Merrion & Bayless

LOCATION AND EQUIPMENT LAY-OUT

MERRION & BAYLESS

Western Federal #8
Section 18, T26N, R11W
San Juan County, New Mexico

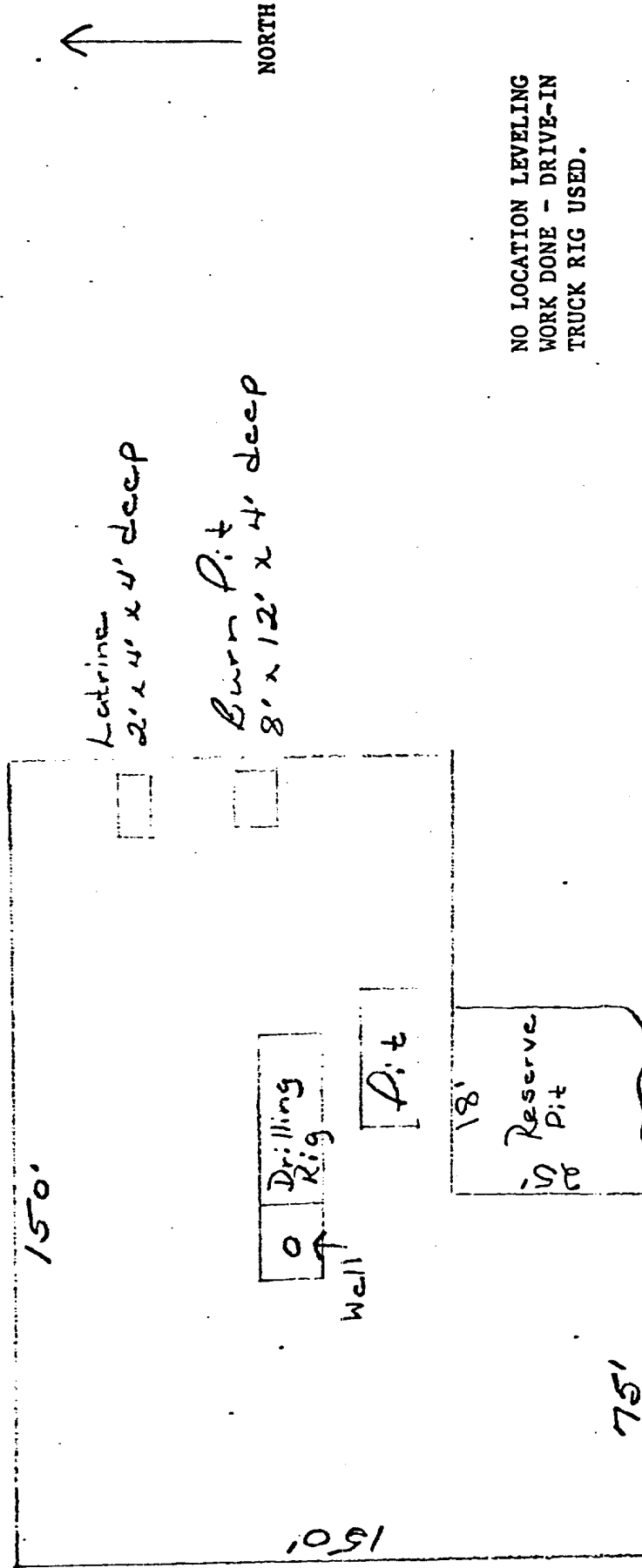

NO LOCATION LEVELING
WORK DONE - DRIVE-IN
TRUCK RIG USED.

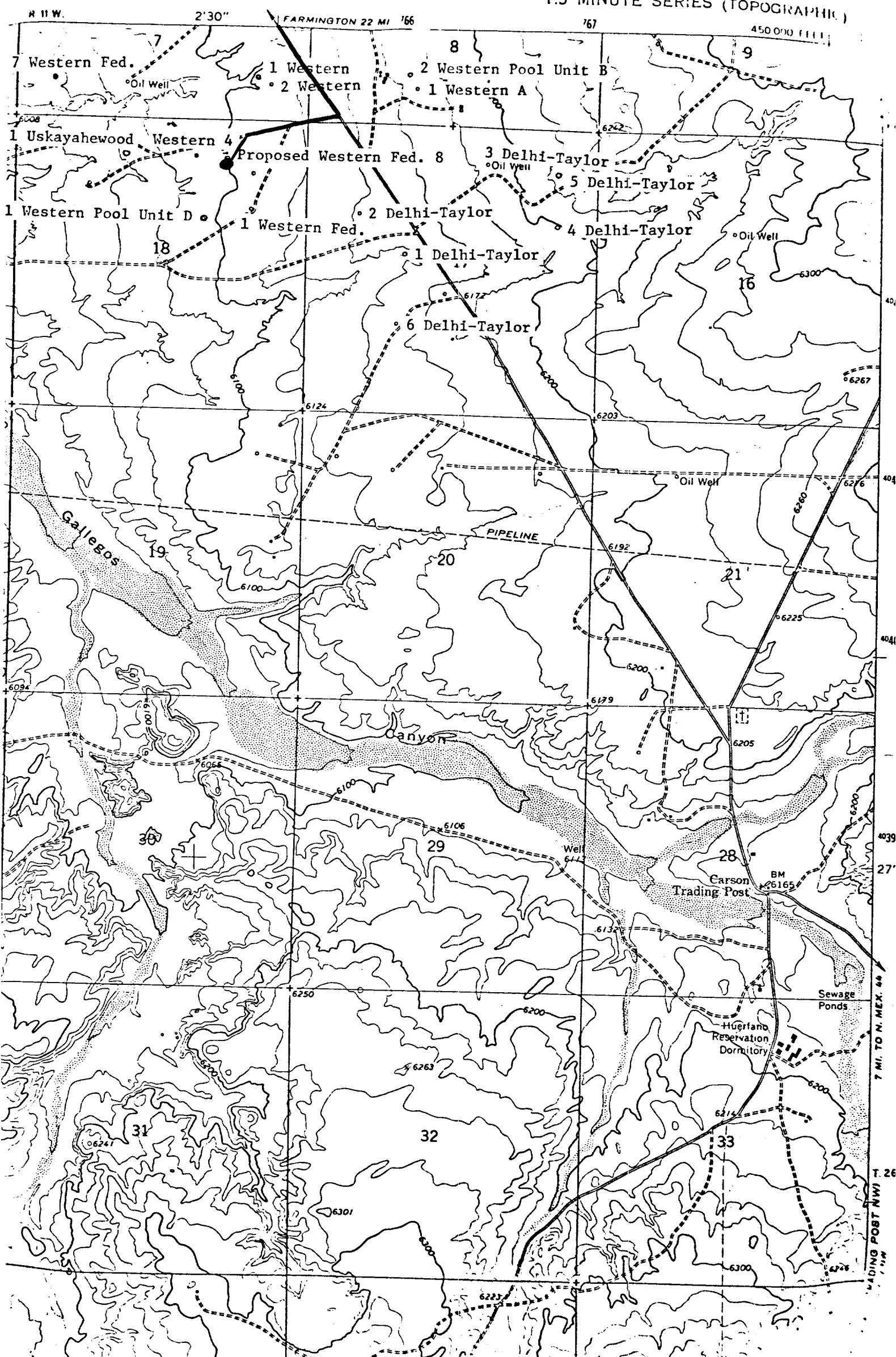

Vicinity Map for
MERRICK & BAYLESS #8 WESTERN-FEDERAL
790'FNL 1450'FEL Sec 18-T26N-R11W
SAN JUAN COUNTY, NEW MEXICO