

District I
P.O. Box 1980, Bldg. 100
Santa Fe, NM 87501

District II
P.O. Drawer DD, Artesia, NM 87210

District III
1000 Rio Brazos Rd, Aztec, NM 87410

George E. Fort
DEPUTY OIL & GAS INSPECTOR

State of New Mexico
Energy, Minerals and Natural Resources Department

SUBMIT 1 COPY TO
APPROPRIATE
DISTRICT OFFICE
AND 1 COPY TO
SANTA FE OFFICE

FEB 08 1999

OIL CONSERVATION DIVISION

2040 South Pacheco Street
Santa Fe, New Mexico 87505

Approved

PIT REMEDIATION AND CLOSURE REPORT

RECEIVED
NOV 12 1998

OIL CON. DIV.
DIST. 3

Operator: PNM Gas Services (RC Resources Corp) **Telephone:** 324-3764

Address: 603 W. Elm Street Farmington, NM 87401

Facility or Well Name: Newsom B #20

Location: Unit K Sec 5 T 26 N R 8 W County San Juan

Pit Type: Separator ☐ Dehydrator ☐ Other Drip

Land Type: BLM ☐ State ☐ Fee ☐ Other Navajo

Pit Location: Pit dimensions: length 20 width 20 depth 3

(Attach diagram) **Reference:** wellhead ☒ other

Footage from reference: 55'

Direction from reference: 10 Degrees ☒ East North ☐
of ☐ West South ☒

Depth to Ground Water:

(Vertical distance from contaminants to
seasonal high water elevation of ground
water)

Less than 50 feet	(20 points)	
50 feet to 99 feet	(10 points)	
Greater than 100 feet	(0 points)	<u>0</u>

Wellhead Protection Area:

(Less than 200 feet from a private
domestic water source, or, less than 1,000
feet from all other water sources)

Yes	(20 points)	
No	(0 points)	<u>0</u>

Distance to Surface Water:

(Horizontal distance to perennial lakes,
ponds, rivers, streams, creeks, irrigation
canals and ditches)

Less than 200 feet	(20 points)	
200 feet to 1,000 feet	(10 points)	
Greater than 1,000 feet	(0 points)	<u>0</u>

RANKING SCORE (TOTAL POINTS): 0

Newsom B #20

Date Remediation Started: 6/25/98 Date Completed: 6/25/98

Remediation Method: Excavation X Approx. Cubic Yard 141

(Check all appropriate sections)

Landfarmed X Amount Landfarmed (cubic yds) 141

Other _____

Remediation Location: Onsite X Offsite _____

(i.e., landfarmed onsite, name and location of offsite facility)

RECEIVED
NOV 12 1998

Backfill Material Location: _____

OIL CON. DIV.
DIST. 3

General Description of Remedial Action:

Excavated contaminated soil to a pit size of 14' X 17' X 16' and landfarmed soil onsite within a bermed area at a depth of 6" to 12". Soil was aerated by disking/plowing until soil met regulatory levels.

Ground Water Encountered: No ☒ Yes ☐ Depth _____

Final Pit Closure Sampling:

Sample Location Bottom of excavation.

(if multiple samples, attach sample result and diagram of sample locations and depths.)

Sample depth 16'

Sample date 6/25/98 Sample time 11:15:00 AM

Sample Results

Benzene (ppm) < 0.0020

Total BTEX (ppm) 0.0237

Field headspace (ppm) _____

TPH (ppm) 29.00 Method 8015A

Vertical Extent (ft) _____ Risk Analysis form attached Yes ☐ No ☒

Ground Water Sample: Yes ☐ No ☒ (If yes, see attached Groundwater Site Summary Report)

I HEREBY CERTIFY THAT THE INFORMATION ABOVE IS TRUE AND COMPLETE TO THE BEST OF MY KNOWLEDGE AND MY BELIEF

DATE **October 29, 1998**

SIGNATURE Maureen Gannon

PRINTED NAME **Maureen Gannon**
AND TITLE **Project Manager**

Newsom "B" #2D

6-25-98

RC Resources Corp.

Sec. 5, 26 N, 8 W, K

start of excavation:

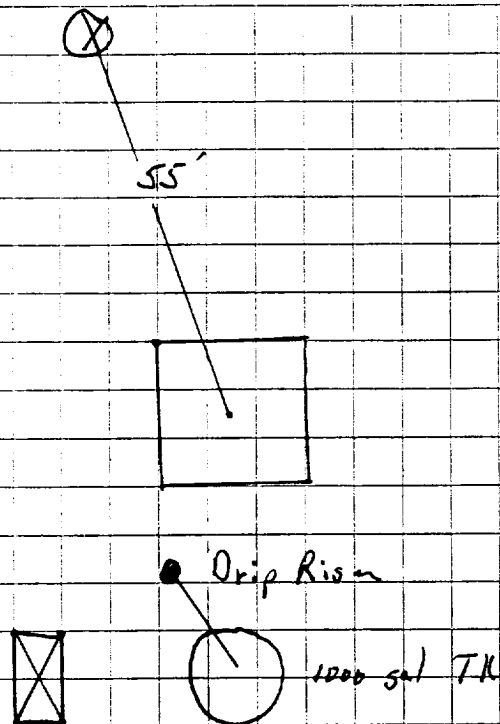

End of excavation:

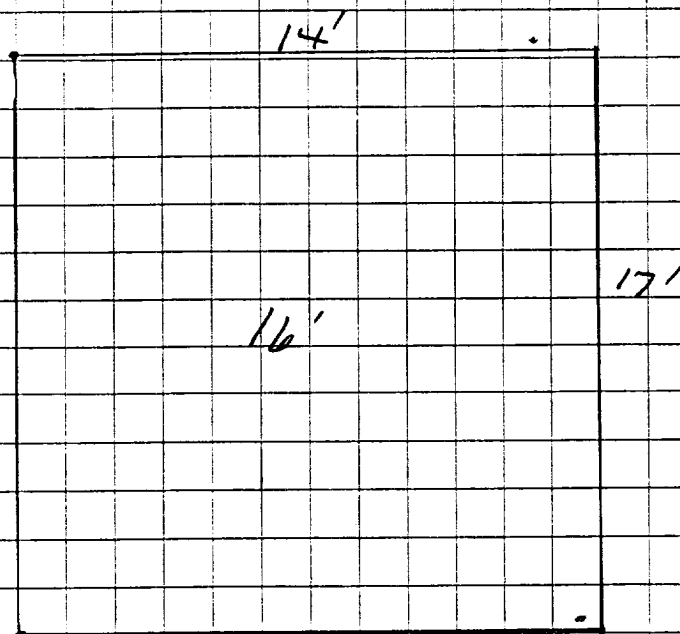

OFF: (505) 325-5667



LAB: (505) 325-1556

On Site Technologies, LTD.

Date: 06-Jul-98

CLIENT: PNM - Public Service Company of NM

Project: Newson "B" #20

Lab Order: 9806098

CASE NARRATIVE

Samples were analyzed using the methods outlined in the following references:

Test Methods for Evaluating Solid Waste, Physical/Chemical Methods, SW846, 3rd Edition

All method blanks, laboratory spikes, and/or matrix spikes met quality assurance objectives.

OFF: (505) 325-5667

ON SITE

TECHNOLOGIES, LTD.

LAB: (505) 325-1556

ANALYTICAL REPORT

Date: 06-Jul-98

Client:	PNM - Public Service Company of NM	Client Sample Info:	Newson "B" #20
Work Order:	9806098	Client Sample ID:	9806251115; Bottom @ 16ft.
Lab ID:	9806098-01A	Matrix:	SOIL
Project:	Newson "B" #20	Collection Date:	6/25/98 11:15:00 AM
		COC Record:	7331

Parameter	Result	PQL	Qual	Units	DF	Date Analyzed
DIESEL RANGE ORGANICS						
	SW8015					
T/R Hydrocarbons: C10-C28	29	25		mg/Kg	1	7/2/98
BTEX						
	SW8020A					
Methyl tert-Butyl Ether	ND	20		µg/Kg	2	7/2/98
Benzene	ND	2		µg/Kg	2	7/2/98
Toluene	4.8	4		µg/Kg	2	7/2/98
Ethylbenzene	2.6	2		µg/Kg	2	7/2/98
m,p-Xylene	13	4		µg/Kg	2	7/2/98
o-Xylene	3.3	2		µg/Kg	2	7/2/98

23.7
0237 ppm

Qualifiers:

PQL - Practical Quantitation Limit

ND - Not Detected at Practical Quantitation Limit

J - Analyte detected below Practical Quantitation Limit

B - Analyte detected in the associated Method Blank

S - Spike Recovery outside accepted recovery limits

R - RPD outside accepted recovery limits

E - Value above quantitation range

Surr: - Surrogate

1 of 1

OFF: (505) 325-5667



LAB: (505) 325-1556

ANALYTICAL REPORT

Date: 06-Jul-98

Client:	PNM - Public Service Company of NM	Client Sample Info:	Newson "B" #20
Work Order:	9806098	Client Sample ID:	9806251130; Walls @ 12ft.
Lab ID:	9806098-02A	Matrix:	SOIL
Project:	Newson "B" #20	Collection Date:	6/25/98 11:30:00 AM
		COC Record:	7331

Parameter	Result	PQL	Qual	Units	DF	Date Analyzed
DIESEL RANGE ORGANICS		SW8015				Analyst: HR
T/R Hydrocarbons: C10-C28	ND	25		mg/Kg	1	7/2/98
BTEX		SW8020A				Analyst: HR
Benzene	ND	1		µg/Kg	1	7/1/98
Toluene	ND	2		µg/Kg	1	7/1/98
Ethylbenzene	ND	1		µg/Kg	1	7/1/98
m,p-Xylene	ND	2		µg/Kg	1	7/1/98
o-Xylene	ND	1		µg/Kg	1	7/1/98

Qualifiers:	PQL - Practical Quantitation Limit	S - Spike Recovery outside accepted recovery limits
	ND - Not Detected at Practical Quantitation Limit	R - RPD outside accepted recovery limits
	J - Analyte detected below Practical Quantitation Limit	E - Value above quantitation range
	B - Analyte detected in the associated Method Blank	Surr: - Surrogate

1 of 1

Newsom "B" #20
RC Reservoir
Sec. 5, 26N, 8W

7/20/98

Landfarm: On location

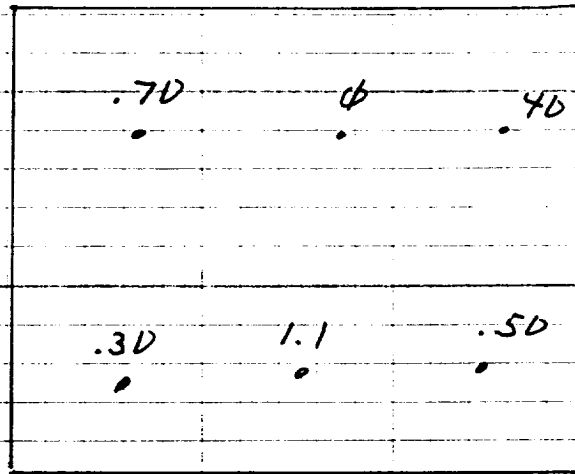

⊗

141 yards
2" - 12" depth

Soil vapor headspace = 5.3 ppm

9807201400

OFF: (505) 325-5667

ON SITE

LAB: (505) 325-1556

TECHNOLOGIES, LTD.

On Site Technologies, LTD.

Date: 28-Jul-98

CLIENT: PNM - Public Service Company of NM

Project: PNM Pit Remediation

Lab Order: 9807058

CASE NARRATIVE

Samples were analyzed using the methods outlined in the following references:

Test Methods for Evaluating Solid Waste, Physical/Chemical Methods, SW846, 3rd Edition

All method blanks, laboratory spikes, and/or matrix spikes met quality assurance objectives.

OFF: (505) 325-5667



LAB: (505) 325-1556

ANALYTICAL REPORT

Date: 28-Jul-98

Client:	PNM - Public Service Company of NM	Client Sample Info:	Newsom B #20 LF
Work Order:	9807058	Client Sample ID:	9807201400: 6pt. Comp.
Lab ID:	9807058-11A	Matrix:	SOIL
Project:	PNM Pit Remediation	Collection Date:	7/20/98 2:00:00 PM
		COC Record:	7389

Parameter	Result	PQL	Qual	Units	DF	Date Analyzed
DIESEL RANGE ORGANICS		SW8015				Analyst: HR
T/R Hydrocarbons: C10-C28	ND	25		mg/Kg	1	7/24/98

Qualifiers:

- PQL - Practical Quantitation Limit
- ND - Not Detected at Practical Quantitation Limit
- J - Analyte detected below Practical Quantitation Limit
- B - Analyte detected in the associated Method Blank

- S - Spike Recovery outside accepted recovery limits
- R - RPD outside accepted recovery limits
- E - Value above quantitation range
- Surr: - Surrogate

1 of 1

P.O. BOX 2606 • FARMINGTON, NM 87499

For more information, please contact us at (505) 325-5667