

NO. OF COPIES RECEIVED	
DISTRIBUTION	
SANTA FE	
FILE	
U.S.G.S.	
LAND OFFICE	
OPERATOR	

NEW MEXICO OIL CONSERVATION COMMISSION

30-045-26233

Form C-101
Revised 1-1-65

APPROVAL EXPIRES 8-27-85
UNLESS DRILLING IS COMMENCED.
SPUD NOTICE MUST BE SUBMITTED
WITHIN 10 DAYS.

5A. Indicate Type of Lease STATE <input checked="" type="checkbox"/> FEE <input type="checkbox"/>
5. State Oil & Gas Lease No. B-9590-5
7. Unit Agreement Name Huerfano Unit
8. Farm or Lease Name Huerfano Unit
9. Well No. 134E
10. Field and Pool, or Wildcat Basin Dakota
12. County San Juan
19. Proposed Depth 6775'
19A. Formation Dakota
20. Rotary or C.T. Rotary
21. Elevations (Show whether DF, RT, etc.) 6639' GR
21A. Kind & Status Plug. Bond statewide
21B. Drilling Contractor
22. Approx. Date Work will start

APPLICATION FOR PERMIT TO DRILL, DEEPEN, OR PLUG BACK

1a. Type of Work b. Type of Well OIL WELL <input type="checkbox"/> GAS WELL <input checked="" type="checkbox"/> OTHER <input type="checkbox"/> DRILL <input checked="" type="checkbox"/> DEEPEN <input type="checkbox"/> PLUG BACK <input type="checkbox"/> SINGLE ZONE <input checked="" type="checkbox"/> MULTIPLE ZONE <input type="checkbox"/>	2. Name of Operator E1 Paso Natural Gas Company	3. Address of Operator PO Box 4289, Farmington, NM 87499	4. Location of Well UNIT LETTER <u>A</u> LOCATED <u>880</u> FEET FROM THE <u>North</u> LINE AND <u>1090</u> FEET FROM THE <u>East</u> LINE OF SEC. <u>36</u> TWP. <u>26N</u> RGE. <u>10W</u> NMPM
23.			

PROPOSED CASING AND CEMENT PROGRAM

SIZE OF HOLE	SIZE OF CASING	WEIGHT PER FOOT	SETTING DEPTH	SACKS OF CEMENT	EST. TOP
12 1/4"	8 5/8"	24.0#	200'	165 cu.ft.	surface
7 7/8"	4 1/2"	10.5# & 11.6#	6775'	1422 cu.ft.	cover Ojo Alamo

1st stage cement - 369 cu.ft. 40% excess to cover Gallup
2nd stage cement - 551 cu.ft. 70% excess to cover Mesa Verde
3rd stage cement - 501 cu.ft. 100% excess to cover Ojo Alamo

Selectively perforate and sandwater fracture the Dakota formation.

3000 psi WP & 6000 psi test double gate preventer equipped with blind and pipe rams will be used for blow out prevention on this well.

This gas is dedicated.

The E/2 of Section 36 is dedicated to this well.

RECEIVED

FEB 27 1985

OIL CON. DIV.
DIST. 3

IN ABOVE SPACE DESCRIBE PROPOSED PROGRAM: IF PROPOSAL IS TO DEEPEN OR PLUG BACK, GIVE DATA ON PRESENT PRODUCTIVE ZONE AND PROPOSED NEW PRODUCTIVE ZONE. GIVE BLOWOUT PREVENTER PROGRAM, IF ANY.

I hereby certify that the information above is true and complete to the best of my knowledge and belief.

Signed [Signature] Title Drilling Clerk Date February 26, 1985

(This space for State Use)

APPROVED BY [Signature] TITLE SUPERVISOR DISTRICT # 3 DATE FEB 27 1985
CONDITIONS OF APPROVAL, IF ANY:

OIL CONSERVATION DIVISION

P. O. BOX 2088

SANTA FE, NEW MEXICO 87501

Form C-107
Revised 10-1-7

STATE OF NEW MEXICO

ENERGY AND MINERALS DEPARTMENT

All distances must be from the outer boundaries of the Section.

Operator EL PASO NATURAL GAS COMPANY			Lease HUERFANO UNIT (B-9590-5)		Well No. 134E
Unit Letter A	Section 36	Township 26N	Range 10W	County San Juan	
Actual Footage Location of Well: 880 feet from the North line and 1090 feet from the East line					
Ground Level Elev. 6639	Producing Formation Dakota		Pool Basin		Dedicated Acreage: 320.00 Acres

1. Outline the acreage dedicated to the subject well by colored pencil or hatchure marks on the plat below.
2. If more than one lease is dedicated to the well, outline each and identify the ownership thereof (both as to working interest and royalty).
3. If more than one lease of different ownership is dedicated to the well, have the interests of all owners been consolidated by communitization, unitization, force-pooling, etc?

☒ Yes ☐ No If answer is "yes," type of consolidation Unitization

If answer is "no," list the owners and tract descriptions which have actually been consolidated. (Use reverse side of this form if necessary.) _____

No allowable will be assigned to the well until all interests have been consolidated (by communitization, unitization, forced-pooling, or otherwise) or until a non-standard unit, eliminating such interests, has been approved by the Commission.

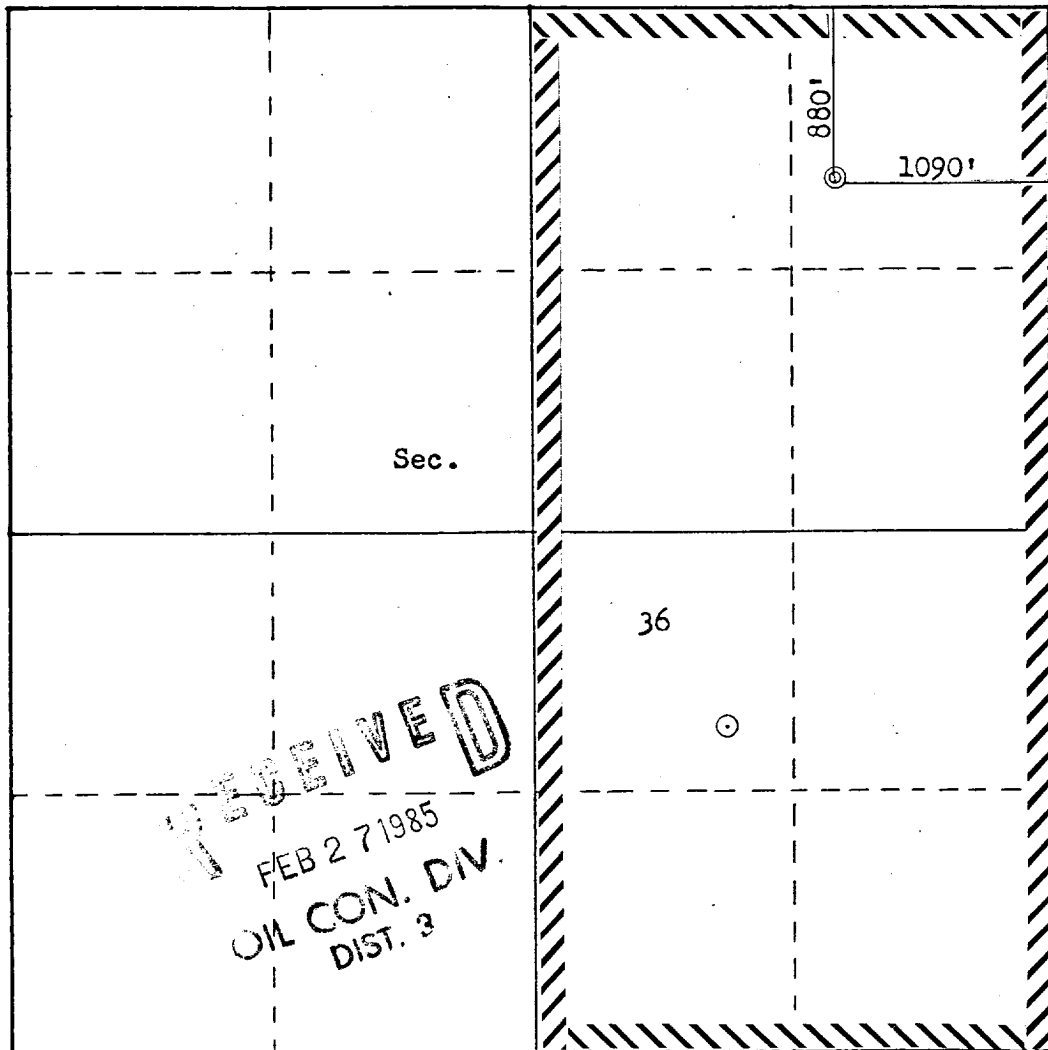

CERTIFICATION

I hereby certify that the information contained herein is true and complete to the best of my knowledge and belief.

Name

Drilling Clerk

Position

El Paso Natural Gas Co

Company

October 17, 1984

Date

I hereby certify that the well location shown on this plat was plotted from field notes of actual surveys made by me or under my supervision, and that the same is true and correct to the best of my knowledge and belief.

Date Surveyed

October 12, 1984

Registered Professional Engineer
and Land Surveyor

Fred B. Kerr Jr.

Certificate No.