

Submit to Appropriate
District Office
State Lease - 6 copies
Fee Lease - 5 copies

State of New Mexico
Energy, Minerals and Natural Resources Department

Form C-101
Revised 1-1-89

DISTRICT I
P.O. Box 1980, Hobbs, NM 88240

DISTRICT II
P.O. Drawer DD, Artesia, NM 88210

DISTRICT III
1000 Rio Brazos Rd., Aztec, NM 87410

OIL CONSERVATION DIVISION

P.O. Box 2088
Santa Fe, New Mexico 87504-2088

API NO. (assigned by OCD on New Wells)
30-045-27241
5. Indicate Type of Lease
STATE <input checked="" type="checkbox"/> FEE <input type="checkbox"/>
6. State Oil & Gas Lease No.
E-5116-2

APPLICATION FOR PERMIT TO DRILL, DEEPEN, OR PLUG BACK

1a. Type of Work:		7. Lease Name or Unit Agreement Name			
b. Type of Well:		Huerfanito Unit			
DRILL <input checked="" type="checkbox"/> RE-ENTER <input type="checkbox"/> DEEPEN <input type="checkbox"/> PLUG BACK <input type="checkbox"/>					
OIL WELL <input type="checkbox"/> GAS WELL <input checked="" type="checkbox"/> OTHER <input type="checkbox"/>					
SINGLE ZONE <input checked="" type="checkbox"/> MULTIPLE ZONE <input type="checkbox"/>					
2. Name of Operator		8. Well No.			
Meridian Oil Inc.		168			
3. Address of Operator		9. Pool name or Wildcat			
PO Box 4289, Farmington, NM 87499		Basin Fruitland Coal			
4. Well Location					
Unit Letter K : 1520 Feet From The South Line and 1490 Feet From The West Line					
Section 2 Township 26N Range 9W NMPM San Juan County					
10. Proposed Depth		11. Formation			
1986		Fruitland Coal			
12. Rotary or C.T.		Rotary			
13. Elevations (Show whether DF, RT, GR, etc.)		14. Kind & Status Plug. Bond			
6253' GL		statewide			
15. Drilling Contractor		16. Approx. Date Work will start			
17. PROPOSED CASING AND CEMENT PROGRAM					
SIZE OF HOLE	SIZE OF CASING	WEIGHT PER FOOT	SETTING DEPTH	SACKS OF CEMENT	EST. TOP
12 1/4"	9 5/8"	32.3#	200'	125 cu.ft.	circ.surf
8 3/4"	7"	20.0#	1850'	240 cu.ft.	cover O.A.
6 1/4"	5 1/2" liner	15.5#	1986'	do not cmt	

The Fruitland Coal formation will be completed.

A 3000 psi WP and 6000 psi test double gate preventer equipped with blind and pipe rams will be used for blow out prevention on this well.

This gas is dedicated.

The W/2 of Section 2 is dedicated to this well.

APPROVAL EXPIRES 9-17-89
UNLESS DRILLING IS COMMENCED.
SPUD NOTICE MUST BE SUBMITTED
WITHIN 10 DAYS.

RECEIVED
MAR 17 1989
OIL CON. DIV
DIST. 3

IN ABOVE SPACE DESCRIBE PROPOSED PROGRAM: IF PROPOSAL IS TO DEEPEN OR PLUG BACK, GIVE DATA ON PRESENT PRODUCTIVE ZONE AND PROPOSED NEW PRODUCTIVE ZONE. GIVE BLOWOUT PREVENTER PROGRAM, IF ANY.

I hereby certify that the information above is true and complete to the best of my knowledge and belief.

SIGNATURE [Signature] TITLE Regulatory Affairs DATE 3-16-89

TYPE OR PRINT NAME _____ TELEPHONE NO. _____

(This space for State Use)

APPROVED BY [Signature] DEPUTY OIL & GAS INSPECTOR, DIST. #3 DATE MAR 17 1989

CONDITIONS OF APPROVAL, IF ANY:

All distances must be from the outer boundaries of the Section.

Operator Meridian Oil Inc.			Lease Huerfanito Unit(E-5116-2)		Well No. 168
Unit Letter K	Section 2	Township 36 North	Range 9 West	County San Juan	
Actual Footage Location of Wells 1520 feet from the South line and 1490 feet from the West line					
Ground Level Elev. 6253'	Producing Formation Fruitland Coal		Pool Basin	Dedicated Acreage: 320.57	

1. Outline the acreage dedicated to the subject well by colored pencil or hachure marks on the plat below.
2. If more than one lease is dedicated to the well, outline each and identify the ownership thereof (both as to work interest and royalty).
3. If more than one lease of different ownership is dedicated to the well, have the interests of all owners been consolidated by communitization, unitization, force-pooling, etc?

☒ Yes ☐ No If answer is "yes," type of consolidation unitization

If answer is "no," list the owners and tract descriptions which have actually been consolidated. (Use reverse side of this form if necessary.)

No allowable will be assigned to the well until all interests have been consolidated (by communitization, unitization, forced-pooling, or otherwise) or until a non-standard unit, eliminating such interests, has been approved by the Division.

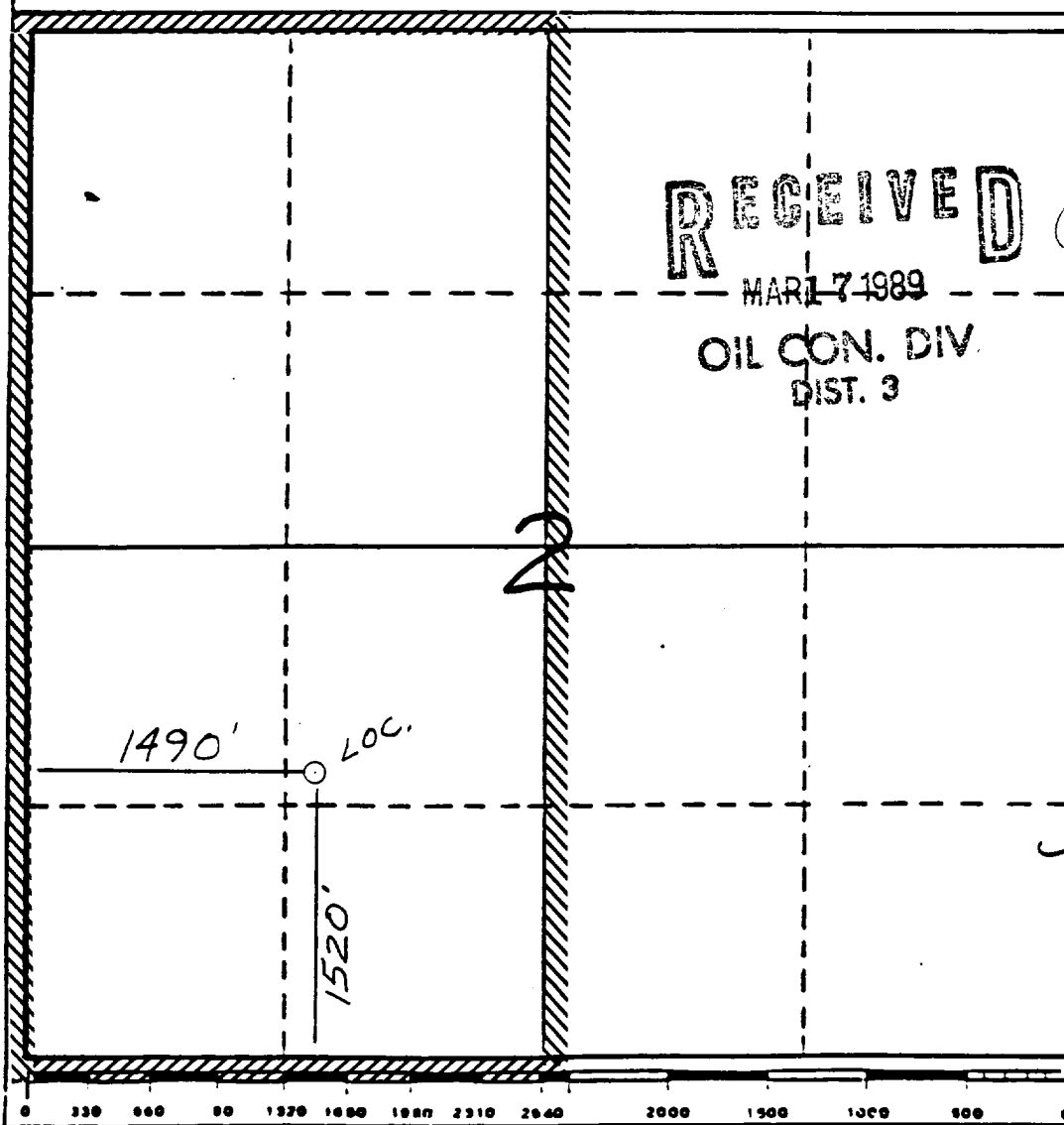

CERTIFICATION

I hereby certify that the information contained herein is true and complete to the best of my knowledge and belief.

Name
Regulatory Affairs

Position
Meridian Oil Inc.

Company
3-16-89

Date

I hereby certify that the location shown on this plat was plotted from notes of actual survey made by me under my supervision, and that the same is true and correct to the best of my knowledge and belief.

Date Surveyed

10-30-88

Registered Professional Engineer and/or Land Surveyor

Neale C. Edwards

Certificate No.
6857