

UNITED STATES
DEPARTMENT OF THE INTERIOR
BUREAU OF LAND MANAGEMENT

APPLICATION FOR PERMIT TO DRILL, DEEPEN, OR PLUG BACK

RECEIVED
MAR 16 PM 1:39

RECEIVED
MAR 24 1998
OIL CON. DIV.
DIST. 3

1a. Type of Work DRILL	5. Lease Number 14-20-603-770 Unit Reporting Number	
1b. Type of Well GAS	6. If Indian, All. or Tribe Navajo	
2. Operator BURLINGTON RESOURCES 4538 Oil & Gas Company	7. Unit Agreement Name	
3. Address & Phone No. of Operator PO Box 4289, Farmington, NM 87499 (505) 326-9700	8. Farm or Lease Name 7043 Ge-Elle-Gu-Lith-E 9. Well Number 500	
4. Location of Well 1415' FSL, 790' FWL Latitude 36° 30.0, Longitude 107° 43.7	10. Field, Pool, Wildcat 71629 Basin Fruitland Coal 11. Sec., Twn, Rge, Mer. (NMPM) 2 Sec 7, T-26-N, R-8-W API # 30-045-29553	
14. Distance in Miles from Nearest Town 7.5 miles to Huerfano Trading Post	12. County San Juan	13. State NM
15. Distance from Proposed Location to Nearest Property or Lease Line 790'	17. Acres Assigned to Well 320.39 W/2	
16. Acres in Lease	18. Distance from Proposed Location to Nearest Well, Drig, Compl, or Applied for on this Lease 90'	
19. Proposed Depth 2025'	20. Rotary or Cable Tools Rotary	
21. Elevations (DF, FT, GR, Etc.) 6146' GR	22. Approx. Date Work will Start	
23. Proposed Casing and Cementing Program See Operations Plan attached	DRILLING OPERATIONS AUTHORIZED ARE SUBJECT TO COMPLIANCE WITH ATTACHED "GENERAL REQUIREMENTS"	
24. Authorized by: <u>[Signature]</u> Regulatory/Compliance Administrator	Date <u>10-29-96</u>	

PERMIT NO. _____ APPROVAL DATE MAR 20 1998
APPROVED BY /s/ Duane W. Spencer TITLE _____ DATE MAR 20 1998

Archaeological Rep. submitted by Arboles Contract Arch. Technical Report #803 dated 9-20-95 as Newsom B #501
Threatened and Endangered Species Report submitted by Ecosphere dated 9-13-95
NOTE: This format is issued in lieu of U.S. BLM Form 3160-3

[Signature]

NMOCD

THE
LIBRARY OF THE
UNITED STATES DEPARTMENT OF
THE INTERIOR
BUREAU OF LAND MANAGEMENT
WASHINGTON, D. C. 20246

U.S. DEPARTMENT OF THE INTERIOR
BUREAU OF LAND MANAGEMENT
WASHINGTON, D. C. 20246

U.S. DEPARTMENT OF THE INTERIOR
BUREAU OF LAND MANAGEMENT
WASHINGTON, D. C. 20246

U.S. DEPARTMENT OF THE INTERIOR
BUREAU OF LAND MANAGEMENT
WASHINGTON, D. C. 20246

District I
PO Box 1980, Hobbs, NM 88241-1980
District II
PO Drawer DD, Artesia, NM 88211-0719
District III
1000 Rio Brazos Rd., Aztec, NM 87410
District IV
PO Box 2088, Santa Fe, NM 87504-2088

State of New Mexico
Energy, Minerals & Natural Resources Department

OIL CONSERVATION DIVISION
PO Box 2088
Santa Fe, NM 87504-2088

Form C-10
Revised February 21, 1996
Instructions on back
Submit to Appropriate District Office
State Lease - 4 Copies
Fee Lease - 3 Copies
AMENDED REPORT

WELL LOCATION AND ACREAGE DEDICATION PLAT, NM

API Number 30-045-29553	Pool Code 71629	Pool Name Basin Fruitland Coal
Property Code 7043	Property Name GE-ELE-GU-LITHE	Well Number 500
OGRID No. 14538	Operator Name MERIDIAN OIL INC.	Elevation 6146'

10 Surface Location

UL or lot no. L	Section 7	Township 26 N	Range 8 W	Lot Idn	Feet from the 1415	North/South line SOUTH	Feet from the 790	East/West line WEST	County SJ
--------------------	--------------	------------------	--------------	---------	-----------------------	---------------------------	----------------------	------------------------	--------------

11 Bottom Hole Location If Different From Surface

UL or lot no.	Section	Township	Range	Lot Idn	Feet from the	North/South line	Feet from the	East/West line	County
---------------	---------	----------	-------	---------	---------------	------------------	---------------	----------------	--------

12 Dedicated Acres W/320.39	13 Joint or Infill	14 Consolidation Code	15 Order No.
--------------------------------	--------------------	-----------------------	--------------

NO ALLOWABLE WILL BE ASSIGNED TO THIS COMPLETION UNTIL ALL INTERESTS HAVE BEEN CONSOLIDATED
OR A NON-STANDARD UNIT HAS BEEN APPROVED BY THE DIVISION

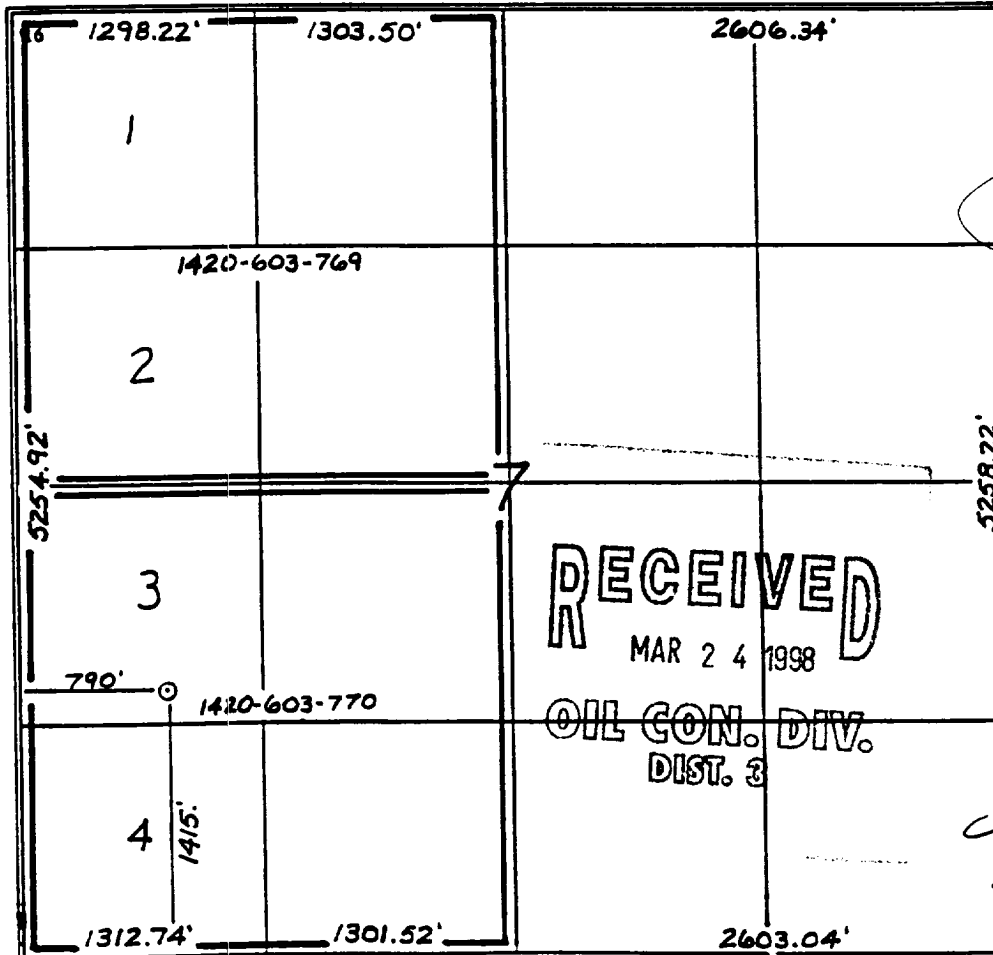

17 OPERATOR CERTIFICATION

I hereby certify that the information contained herein is true and complete to the best of my knowledge and belief.

Signature
Peggy Bradfield
Printed Name
Regulatory Administrator
Title
6-10-96
Date

18 SURVEYOR CERTIFICATION

I hereby certify that the well location shown on this plat was plotted from field notes of actual surveys made by me or under my supervision, and that the same is true and correct to the best of my belief.

8-8-95
Date of Survey
Signature and Seal of Surveyor

6857
Certificate Number

CAVING
1970

1970
1970

OPERATIONS PLAN

Well Name: Ge-Ele-Gu-Lith-E #500
Location: 1415' FSL, 790' FWL Section 7, T-26-N, R-8-W
 San Juan County, New Mexico
 Latitude 36° 30.0, Longitude 107° 43.7
Formation: Basin Fruitland Coal
Elevation: 6146' GL

Formation:	Top	Bottom	Contents
Surface	Nacimiento	1107'	
Ojo Alamo	1107'	1219'	aquifer
Kirtland	1219'	1690'	
Fruitland	1690'	1875'	
Fruitland Coal	1690'	1861'	
Pictured Cliffs	1875'		
Total Depth	2025'		

Logging Program: Mud logs: 1600' to TD
 Dens/Neut/Por; Density/Corr; Micro/GR; Numar MR: 1600-TD
 Ind/SP/GR: to TD

Mud Program:

Interval	Type	Weight	Vis.	Fluid Loss
0- 120'	Spud	8.4-8.9	40-50	no control
120-2025'	LSND	8.4-9.0	40-60	no control

Casing Program:

Hole Size	Depth Interval	Csg. Size	Wt.	Grade
12 1/4"	0 - 120'	8 5/8"	24.0 23.0#	H-40 M-50
7 7/8"	0 - 2025'	4 1/2"	10.5#	K-55

Tubing Program:

0 - 2025'	2 3/8"	4.7#	J-55
-----------	--------	------	------

Float Equipment: 8 5/8" surface casing - saw tooth guide shoe.
 Centralizers will be run in accordance with Onshore Order #2.

4 1/2" production casing - float shoe on bottom. Three centralizers run every other joint above shoe. Two centralizers run every 3rd joint to the base of the Ojo Alamo @ 1219'. Two turbolizing type centralizers - one below and one into the base of the Ojo Alamo @ 1219'. Standard centralizers thereafter every fourth joint up to the base of the surface pipe.

Wellhead Equipment: 8 5/8" x 4 1/2" x 2 3/8" x 11" 2000 psi screw-on type independent wellhead.

