

Form 9-331b  
(April 1952)  
Section 26

(SUBMIT IN TRIPLICATE)

Indian Agency Jicarilla Apache

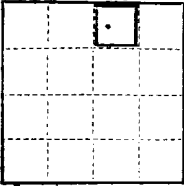

UNITED STATES  
DEPARTMENT OF THE INTERIOR  
GEOLOGICAL SURVEY

Allottee \_\_\_\_\_  
Lease No. 280

660' WEL., 2310' WEL.

SUNDRY NOTICES AND REPORTS ON WELLS

ILLEGIBLE

NOTICE OF INTENTION TO DRILL	<input checked="" type="checkbox"/>	SUBSEQUENT REPORT OF WATER SHUT-OFF	
NOTICE OF INTENTION TO CHANGE PLANS		SUBSEQUENT REPORT OF SHOOTING OR ACIDIZING	
NOTICE OF INTENTION TO TEST WATER SHUT-OFF		SUBSEQUENT REPORT OF ALTERING CASING	
NOTICE OF INTENTION TO REDRILL OR REPAIR WELL		SUBSEQUENT REPORT OF REDRILLING OR REPAIR	
NOTICE OF INTENTION TO SHOOT OR ACIDIZE		SUBSEQUENT REPORT OF ABANDONMENT	
NOTICE OF INTENTION TO PULL OR ALTER CASING		SUPPLEMENTARY WELL HISTORY	
NOTICE OF INTENTION TO ABANDON WELL			

(INDICATE ABOVE BY CHECK MARK NATURE OF REPORT, NOTICE, OR OTHER DATA)

July 2, 1962

Jicarilla 4-26

Well No. 2 is located 660 ft. from N line and 2310 ft. from E line of sec. 26

26 North 1 West 100W  
(Twp.) (Range) (Meridian)

Undesignated  
(Field)

Rio Arriba  
(County or Subdivision)

New Mexico  
(State or Territory)

ground level

The elevation of the ~~structure~~ above sea level is 7148 ft.

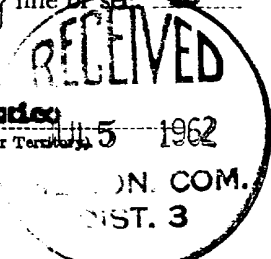

DETAILS OF WORK

(State names of and expected depths to objective sands; show sizes, weights, and lengths of proposed casings; indicate mudding jobs, cementing points, and all other important proposed work)

Notice is hereby given of intention to drill the Jicarilla 4-26 #2 to a total depth of approximately 4000 feet with rotary tools. 9-5/8", 36 1/2 ft., J-55, SMC surface casing will be set at 100 ft. in 11" hole and cemented to surface. 8-1/8" hole will be drilled below surface casing with mud to approximately 3500 feet. Logs will be run at 3500 feet. 5 1/2", 14 1/2 ft., J-95 SMC Casing will be set at 3500 feet and cemented with 200 ml. cement. Drilling will continue using air as drilling fluid to total depth. Primary objective is Gallup formation at 3500 ft. A 4" slotted flash joint liner will be set at total depth if commercial production is obtained.

I understand that this plan of work must receive approval in writing by the Geological Survey before operations may be commenced.

Company Standard Oil Company of Texas, A Division of California Oil Company

Address Drewer "B"

Morgan, Texas

By J. L. Rowland

Title District Engineer

Well Location and Acreage Dedication Plat

Section A.

Date July 2, 1962

Operator STANDARD OIL COMPANY OF TEXAS Lease Sierrita 4-65  
 Well No. 8 Unit Letter B Section 26 Township 28 NORTH Range 1 WEST NMPM  
 Located 660 Feet From the NORTH Line, 2310 Feet From the EAST Line  
 County RIO ARRIBA G. L. Elevation 7148.0 Dedicated Acreage 50 Acres  
 Name of Producing Formation Gallego Pool Subsaturated

1. Is the Operator the only owner in the dedicated acreage outlined on the plat below?  
 Yes  No
2. If the answer to question one is "no", have the interests of all the owners been consolidated by communitization agreement or otherwise? Yes  No . If answer is "yes", Type of Consolidation.
3. If the answer to question two is "no", list all the owners and their respective interests below:

Owner	Land Description

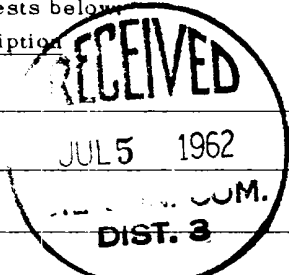

Section B.

Note: All distances must be from outer boundaries of section.

This is to certify that the information in Section A above is true and complete to the best of my knowledge and belief.  
**Standard Oil Company of Texas, A Division of California Oil Company**

J. L. Rowland (Operator)  
Rowland (Representative)  
Box 7, Mesquite, Texas (Address)

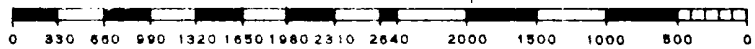
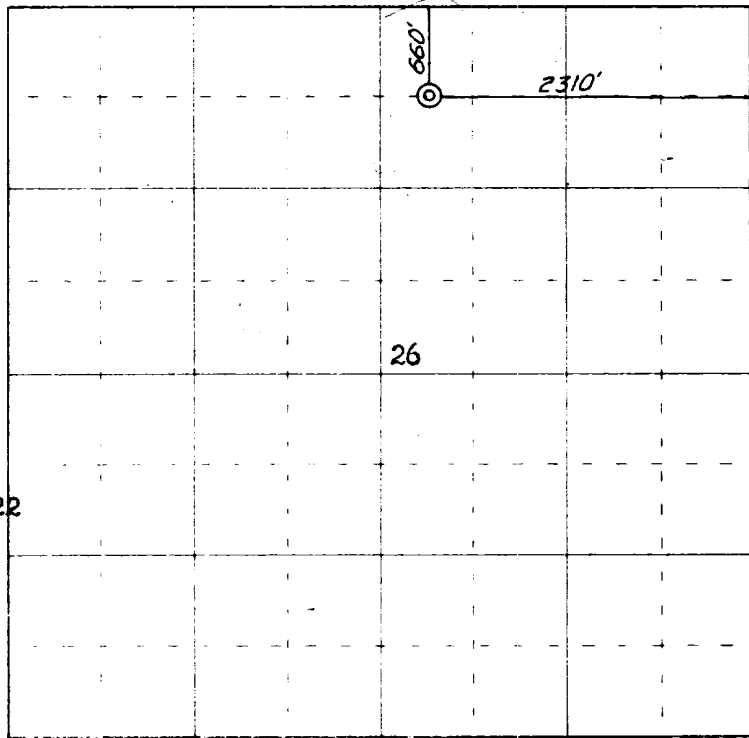

Scale 4 inches equal 1 mile

Ref. GLO Plat Dated 28 October 1922

This is to certify that the above plat was prepared from field notes of actual surveys made by me or under my supervision and that the same are true and correct to the best of my knowledge and belief.

Date Surveyed 22 June 1962

(Seal)  
 FARMINGTON, NEW MEXICO

Registered Professional Engineer and/or Land Surveyor  
**James P. Leese** N. Mex. Reg. No. 1463