

NEW MEXICO OIL CONSERVATION COMMISSION
Santa Fe, New Mexico

Form C-101
Revised (12/1/55)

NOTICE OF INTENTION TO DRILL

Notice must be given to the District Office of the Oil Conservation Commission and approval obtained before drilling or recompletion begins. If changes in the proposed plan are considered advisable, a copy of this notice showing such changes will be returned to the sender. Submit this notice in QUINTUPPLICATE. One copy will be returned following approval. See additional instructions in Rules and Regulations of the Commission. If State Land submit 6 Copies Attach Form C- 128 in triplicate to first 3 copies of form C-101

Farmington, New Mexico
(Place)

October 27, 1961
(Date)

OIL CONSERVATION COMMISSION
SANTA FE, NEW MEXICO

Gentlemen:

You are hereby notified that it is our intention to commence the Drilling of a well to be known as
El Paso Natural Gas Company

(Company or Operator)

San Juan 28-6 Unit

(Lease)

Well No. **100**, in **N** (Unit) The well is

located **1000** feet from the **South** line and **1850** feet from the

West line of Section **13**, T. **28N**, R. **6W**, NMPM.

(GIVE LOCATION FROM SECTION LINE) **Basin Dakota** Pool, **Rio Arriba** County

If State Land the Oil and Gas Lease is No.

If patented land the owner is.

Address.

We propose to drill well with drilling equipment as follows: **Rotary tools from surface to total depth.**

The status of plugging bond is **Statewide**

Drilling Contractor **Aspen Drilling Company**

We intend to complete this well in the **Dakota formation**
formation at an approximate depth of **7868** feet.

CASING PROGRAM

We propose to use the following strings of Casing and to cement them as indicated:

Size of Hole	Size of Casing	Weight per Foot	New or Second Hand	Depth	Sacks Cement
15"	10 3/4"	32.75# H	New	280'	280
8 3/4"				5760	
7 7/8"	4 1/2"	11.6 & 10.5J	New	7868	See Below

If changes in the above plans become advisable we will notify you immediately.

ADDITIONAL INFORMATION (If recompletion give full details of proposed plan of work.)

It is intended to cement the 4 1/2" OD production string in three stages as follows:

1st Stage - 182 cu. ft. cement - 50% excess to cover 100' above Greenhorn Formation.

2nd Stage - two stage tool set 50' to 100' below Point Lookout formation. 370 cu. ft. cement - 50% excess to cover 100' above the Cliff House Formation.

3rd Stage - Three stage tool will be set 50' to 100' below the Pictured Cliffs formation (Over

Sincerely yours,

El Paso Natural Gas Company

(Company or Operator)

By **Original Signed R. G. MILLER**

Position **Petroleum Engineer**

Send Communications regarding well to

E. S. Oberly

Address **Box 990, Farmington, New Mexico**

OIL CONSERVATION COMMISSION

By *[Signature]*

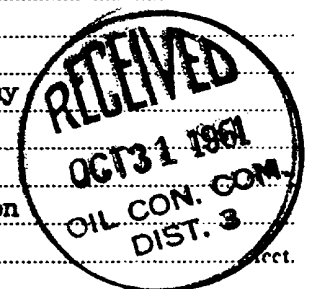

Cemented with 368 cu. ft. of cement - 35% excess to cover the Ojo Alamo Formation.

The W/2 of Section 13 is dedicated to this well.

NEW MEXICO OIL CONSERVATION COMMISSION

Well Location and Acreage Dedication Plat

Section A.

Date **OCTOBER 26, 1961**

Operator **EL PASO NATURAL GAS COMPANY** Lease **SAN JUAN 28-6 UNIT** FEE
 Well No. **100** Unit Letter **N** Section **13** Township **28-N** Range **6-W** NMPM
 Located **1000** Feet From **SOUTH** Line **1850** Feet From **WEST** Line
 County **RIO ARriba** G. L. Elevation **6454** Dedicated Acreage **320** Acres
 Name of Producing Formation **DAKOTA** Pool **BASIN DAKOTA**

1. Is the Operator the only owner in the Dedicated acreage outlined on the plat below?

Yes ☐ No ☒2. If the answer to question one is "no", have the interests of all the owners been consolidated by communization agreement or otherwise? Yes ☒ No ☐ If answer is "yes", Type of Consolidation.**Unit Agreement.**

3. If the answer to question two is "no", list all the owners and their respective interests below:

Owner

Land Description

Section B.

This is to certify that the information in Section A above is true and complete to the best of my knowledge and belief.

El Paso Natural Gas Company
 (Operator)

Original Signed **R. G. MULLEN**
 Site Representative

Box 990

(Address)

Farmington, New Mexico

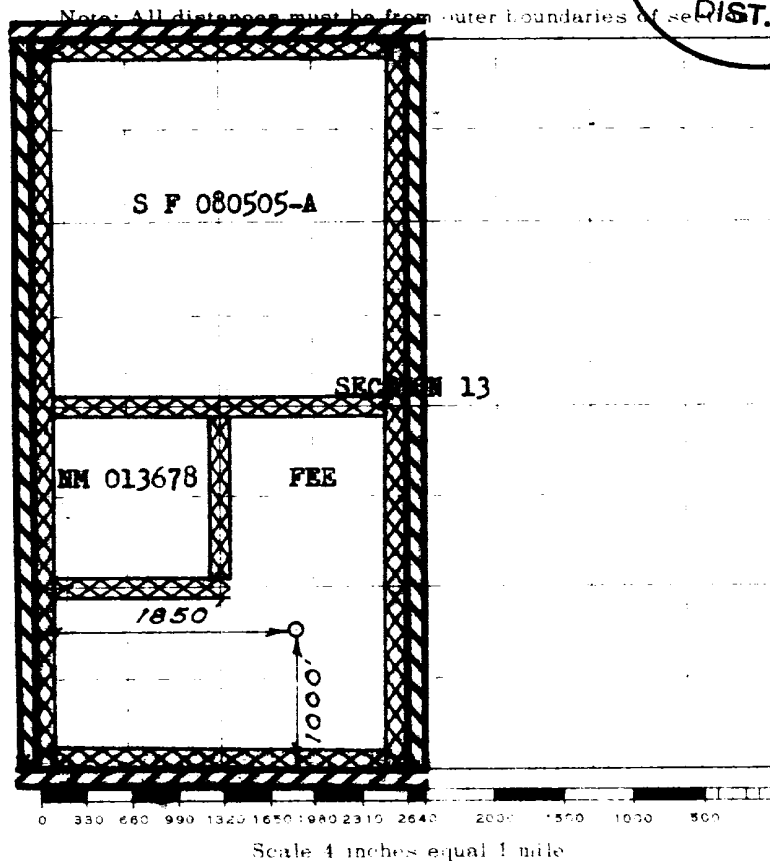

This is to certify that the above plat was prepared from field notes of actual surveys made by me or under my supervision and that the same are true and correct to the best of my knowledge and belief.

(Seal)

Date Surveyed **OCTOBER 20, 1961**

David O. Kilmer
 Registered Professional Engineer and/or Land Surveyor

Farmington, New Mexico