

UNITED STATES
DEPARTMENT OF THE INTERIOR
BUREAU OF LAND MANAGEMENT

RECEIVED
317

FEB 11 11:25 56

FORM APPROVED
Budget Bureau No. 1004-0135
Expires: March 31, 1993

5. Lease Designation and Serial No.

SF 078417

6. If Indian, Allottee or Tribe Name

7. If Unit or CA, Agreement Designation

8. Well Name and No.

San Juan 28-7 Unit # 134

9. API Well No.

30-039-21329

10. Field and Pool, or Exploratory Area

Blanco Mesaverde

11. County or Parish, State

Rio Arriba, NM

SUNDRY NOTICES AND REPORTS ON WELLS

Do not use this form for proposals to drill or to deepen or reentry to a different reservoir.
Use "APPLICATION FOR PERMIT—" for such proposals

SUBMIT IN TRIPLICATE

1. Type of Well

☐ Oil Well ☒ Gas Well ☐ Other

2. Name of Operator

CONOCO INC.

3. Address and Telephone No.

10 DESTA DR. STE. 100W, MIDLAND, TX. 79705-4500 (915) 686-5424

4. Location of Well (Footage, Sec., T. R. M. or Survey Description)

Section 21, T-28-N, R-7-W, K
1460' FSL & 1840' FWL

CHECK APPROPRIATE BOX(S) TO INDICATE NATURE OF NOTICE, REPORT, OR OTHER DATA

TYPE OF SUBMISSION

☒ Notice of Intent
☐ Subsequent Repon
☐ Final Abandonment Notice

TYPE OF ACTION

☐ Abandonment
☒ Recompletion
☐ Plugging Back
☐ Casing Repair
☐ Altering Casing
☐ Other

☐ Change of Plans
☐ New Construction
☐ Non-Routine Fracrunng
☐ Water Shut-Off
☐ Conversion to Injection
☐ Dispose Water

(Note: Repon result of multiple completion on WdI Completion or Recompletion Report and Log form.)

13. Describe Proposed or Completed Operations (Clearly state all pertinent details, and give pertinent dates, including estimated date of starting any proposed work. If well is directionally drilled, give subsurface locations and measured and true vertical depths for all markers and zones pertinent to this work.)*

It has been proposed to recomplete this well to the Meaverde using the attached procedure.

RECEIVED
FEB 1 9 1999

14. I hereby certify that the foregoing is true and correct

Signed

Kay Maddox

Title

Kay Maddox

Regulatory Agent

Date

February 4, 1999

(This space for Federal or State office use)

Approved by

/s/ Duane W. Spencer

Title

Team Lead, Petroleum Management

Date

FEB 17 1999

Conditions of approval if any.

BLM(6), NMOCD(1), SHEAR, PONCA, COST ASST, FILE ROOM

Title 18 U.S.C. Section 1001, makes it a crime for any person knowingly and willfully to make to any department or agency of the United States any false, fictitious or fraudulent statements or representations as to any matter within its jurisdiction.

*See Instruction on Reverse Side

NMOCD

(E)

✓

**San Juan 28-7 Unit # 134
Mesaverde Recompletion & DHC
API # 30-039-21329**

Please Refer questions to the following people:

Geologic/Logging:	Tom Johnson	(915) 686-6111
Engineering/Procedural:	Randy Herring Pager	(915) 686-6541 800-999-6710 I.D.# 991-7826
Fracturing:	Jim Russell: Pager Mobile	(505) 327-6222 (505) 324-1867 (505) 330-0005
Completion:	Greg Vick: Pager Mobile	(505) 324-5819 (505) 324-2601 (505) 320-4609
	Gilbert Hughes Pager Mobile	(505) 324-5812 (505) 327-8753 (505) 320-4785
	Lino Hernandez: Pager Mobile	(505) 324-5816 (505) 326-8198 (505) 320-6739

Other #'s

BLM:	(505) 599-8900	NMOCD:	(505) 334-6178
One Call:	1-800-321-2537		

Midland Continuous Fax: (915) 686-6112

EMERGENCY NUMBERS:

Aztec Fire & Police:	911	Air Care:	911 or 1-800-452-9990
NM State Police	325-7547	SJ County Sheriff:	334-6107

**San Juan 28-7 Unit # 134
Mesaverde Recompletion & DHC
API # 30-039-21329**

1. Hold tailgate safety meetings prior to rigging up, each morning, and whenever necessary.
2. Test Anchors, MIRU Workover Unit. If necessary, kill well with a minimum of 1 % KCl. NU BOP. POOH w/ 2 3/8" production string.
3. RU wireline unit & set 4 1/2" Fast-Drill plug over the Dakota +/- 5250'
4. RU Logging tools. Run GR/CBL from 5200' to 4200' to determine cmt integrity.
Note: Cmt squeeze if TOC is below 4200'. Contact BLM for approval prior to initiating squeeze work

Note: If Squeeze work is required adjust procedure to utilize a frac string.

1st Stage

5. Perforate the Lower MV (Point Lookout) across the following intervals using a 3 1/8" Select Fire gun w/ 11 gm charges. Run a GR strip and correlate to attached log

4682', 87', 89',
4705', 07',
4851', 53', 59', 68', 71', 74', 77', 91', 93',
4903', 16', 23', 26', 35', 37', 43', 47', 53', 55',
5020', 22', 55', 57', 73', 75', 84', & 86'.

Total: 32 holes
6. RU Acidizing equipment. Test lines to 4000 psi Break down perms using 500 gallons 15% HCl and 50% excess 1.1 sg balls (48) spaced equally throughout the job. Run as high a rate as possible without exceeding max pressure. **DO NOT EXCEED 3500 psi**
7. Retrieve balls and check for hits. If # hits less than 80% (26), re-acidize using the above procedure. Prep to frac.
8. Frac per attached procedure. Leave frac equipment on location. RIH and set w/ Fast-drill plug above Point lookout +/- 4500'

San Juan 28-7 Unit # 134
Mesaverde Recompletion & DHC
API # 30-039-21329

2nd Stage

9. Perforate the Menefee across the following intervals using a 3 1/8" Select Fire gun w/ 11 gm charges. Run GR and correlate to attached Log.
- 4266', 68', 70', 74', 81', 83', 91', 93', 95',
4311', 16', 20', 27', 29', 33', 47', 59', 61', 63', 81', 83', 85', 87', 94', 96',
4405', 07', 15', 17', & 26'
- Total: 30 totals
10. RU Acidizing equipment. Test lines to 4000 psi Break down perfs using 500 gallons 15% HCl and 50% excess 1.1 sg balls (45) spaced equally throughout the job. Run as high a rate as possible without exceeding max pressure. **DO NOT EXCEED 3500 psi**
11. Retrieve balls and check for hits. If # hits less than 80% (24), re-acidize using the above procedure. Prep to frac.
12. Frac per attached procedure. Clean Location and release frac equipment.
13. Rig up compressors and power swivel. RIH w/ bit & collars on tbgs. CO & DO Mesaverde bridge plugs to 5800'. Jet well w/ gas until well will flow on its own. Drywatch as necessary.
14. Test Mesaverde and obtain a stabilized flow rate for allocation purposes.
15. RU compressors and drill out bridge plug @ 5800' w/ gas. Clean out well to PBTD (7267'). Jet well w/ gas until well will flow on its own. Drywatch as necessary.
16. PU & RIH w/ 2 3/8" production string. Land SN at +/- 7120'. ND BOP and NU wellhead.
17. Record and notify necessary personnel for regulatory and gas allocation purposes.
18. RDMO workover unit and clean location.
19. Place well on production
20. Thank You.

Prepared By: _____
Randy B. Herring,
Sr. Production Engineer

District I
PO Box 1980, Hobbs, NM 88241-1980

District II
PO Drawer DD, Artesia, NM 88211-0719

District III
1000 Rio Brazos Rd. Aztec, NM 87410

District IV
PO Box 2088, Santa Fe, NM 87504-2088

State of New Mexico
Energy, Minerals & Natural Resources Department

OIL CONSERVATION DIVISION

PO Box 2088
Santa Fe, NM 87504-2088

Form C-102

Revised February 21, 1994

Instructions on back

Submit to Appropriate District Office

State Lease - 4 Copies

Fee Lease - 3 Copies

☐ AMENDED REPORT

WELL LOCATION AND ACREAGE DEDICATION PLAT

API Number 30-039-21329	2 Pool Code 72319	3 Pool Name Blanco Mesaverde
4 Property Code 016608	5 Property Name San Juan 28-7 Unit	6 Well Number # 134
7 OGRID No. 005073	8 Operator Name Conoco Inc., 10 Desta Drive, Ste. 100W, Midland, TX 79705-4500	9 Elevation 5998'

10 Surface Location

UL or lot no. K	Section 21	Township 28N	Range 7W	Lot Idn	Feet from the 1460'	North/South line South	Feet from the 1840'	East/West line West	County Rio Arriba
--------------------	---------------	-----------------	-------------	---------	------------------------	---------------------------	------------------------	------------------------	----------------------

11 Bottom Hole Location If Different From Surface

UL or lot no.	Section	Township	Range	Lot Idn	Feet from the	North/South line	Feet from the	East/West line	County
---------------	---------	----------	-------	---------	---------------	------------------	---------------	----------------	--------

12 Dedicated Acres 320	13 Joint or Infill	14 Consolidation Code	15 Order No. R-10987-A
---------------------------	--------------------	-----------------------	---------------------------

NO ALLOWABLE WILL BE ASSIGNED TO THIS COMPLETION UNTIL ALL INTERESTS HAVE BEEN CONSOLIDATED
OR A NON-STANDARD UNIT HAS BEEN APPROVED BY THE DIVISION

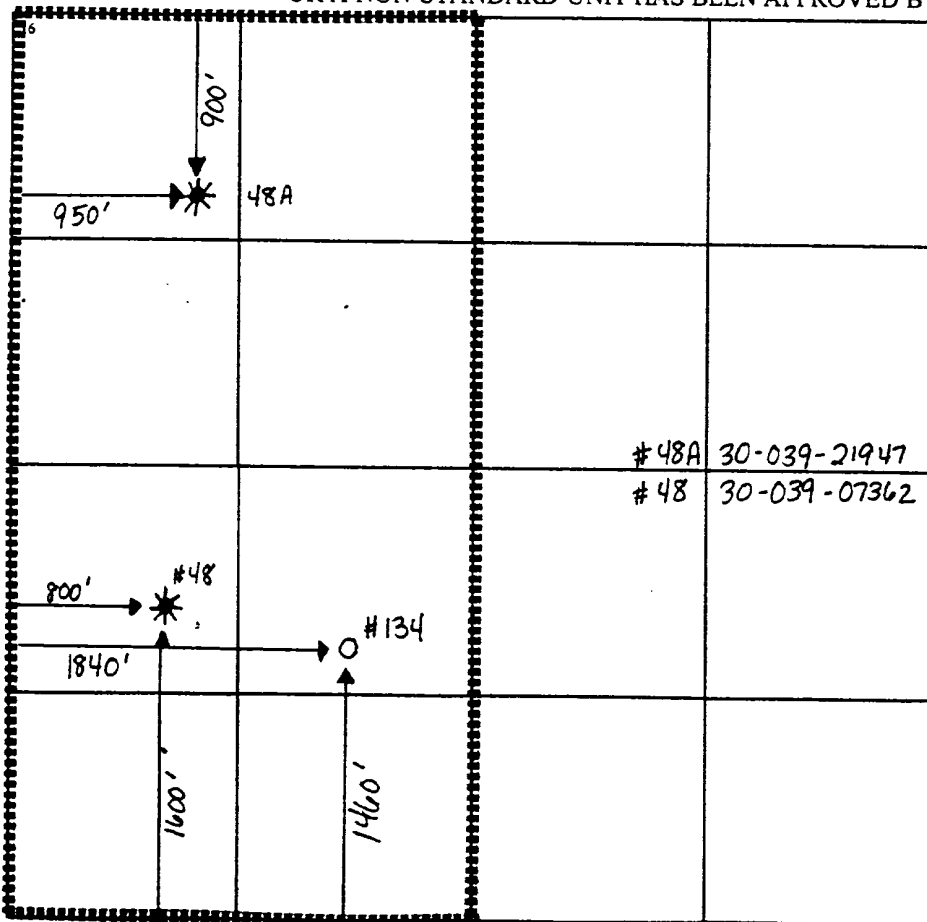

17 OPERATOR CERTIFICATION

I hereby certify that the information contained herein is true and complete to the best of my knowledge and belief

Signature

Kay Maddox

Printed Name

Regulatory Agent

Title

February 4, 1999

Date

18 SURVEYOR CERTIFICATION

I hereby certify that the well location shown on this plat was plotted from field notes of actual surveys made by me or under my supervision, and that the same is true and correct to the best of my belief.

Date of Survey

Signature and Seal of Professional Surveyor:

Certificate Number

OK @