

NEW MEXICO OIL CONSERVATION COMMISSION
WELL LOCATION AND ACREAGE DEDICATION PLAT

Form C-102
Supersedes C-128
Effective 1-1-65

All distances must be from the outer boundaries of the Section.

Operator EL PASO NATURAL GAS COMPANY			Lease SAN JUAN 28-7 UNIT (SF-078497-A)		Well No. 241-E
Unit Letter 0	Section 9	Township 28N	Range 7W	County Rio Arriba	
Actual Footage Location of Well: 980 feet from the South line and 1840 feet from the East line					
Ground Level Elev: 6214	Producing Formation Dakota		Pool Basin Dakota	Dedicated Acreage: 338.02 Acres	

1. Outline the acreage dedicated to the subject well by colored pencil or hachure marks on the plat below.
2. If more than one lease is dedicated to the well, outline each and identify the ownership thereof (both as to working interest and royalty).
3. If more than one lease of different ownership is dedicated to the well, have the interests of all owners been consolidated by communitization, unitization, force-pooling, etc?

Yes No If answer is "yes," type of consolidation Unitization

If answer is "no," list the owners and tract descriptions which have actually been consolidated. (Use reverse side of this form if necessary.)

No allowable will be assigned to the well until all interests have been consolidated (by communitization, unitization, forced-pooling, or otherwise) or until a non-standard unit, eliminating such interests, has been approved by the Commission.

NW 1/4 R-2948

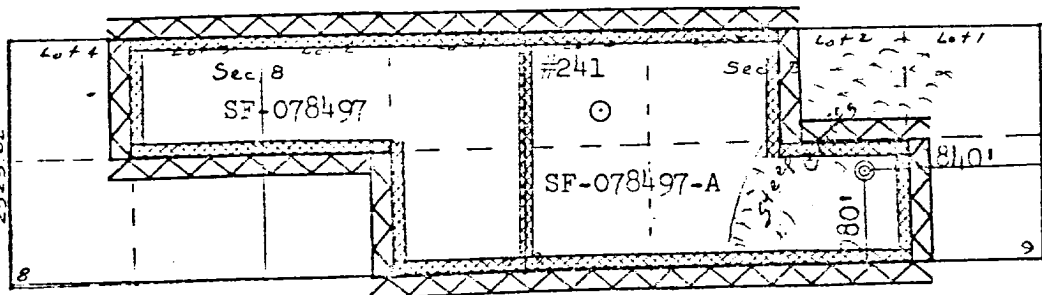

Scale: 1" = 2000'

Dedicated Acreage: Sec. 8 (Lots 1,2,3; SE/SE 1/4)
Sec. 9 (Lots 3 & 4, SW/SW 1/4, SE/SW 1/4, SW/SE 1/4)

CERTIFICATION

I hereby certify that the information contained herein is true and complete to the best of my knowledge and belief.

A. G. Gisco

Name
Drilling Clerk
El Paso Natural Gas Co.
Company
May 5, 1980
Date

I hereby certify that the well location shown on this plat was plotted from field notes of actual surveys made by me or under my supervision, and that the same are true and correct to the best of my knowledge and belief.

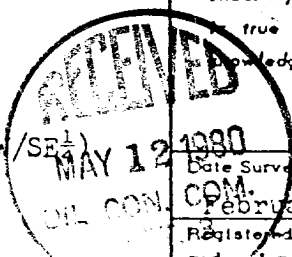

Date Surveyed
February 15, 1980
Registered Professional Engineer and Land Surveyor
Fred B. Kerr Jr.
Fred B. Kerr Jr.

Certificate No.
3950