

Oral approval received 1-18-57.

Budget Bureau No. 42-R358.4.
Approval expires 12-31-60.

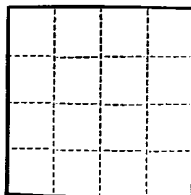

(SUBMIT IN TRIPLICATE)

UNITED STATES
DEPARTMENT OF THE INTERIOR
GEOLOGICAL SURVEY

Land Office **Santa Fe**
Lease No. **078500-A**
Unit **San Juan 26-7 Unit**
14-08-001-499

SUNDRY NOTICES AND REPORTS ON WELLS

NOTICE OF INTENTION TO DRILL.....	<input checked="" type="checkbox"/>	SUBSEQUENT REPORT OF WATER SHUT-OFF.....	
NOTICE OF INTENTION TO CHANGE PLANS.....		SUBSEQUENT REPORT OF SHOOTING OR ACIDIZING.....	
NOTICE OF INTENTION TO TEST WATER SHUT-OFF.....		SUBSEQUENT REPORT OF ALTERING CASING.....	
NOTICE OF INTENTION TO RE-DRILL OR REPAIR WELL.....		SUBSEQUENT REPORT OF RE-DRILLING OR REPAIR.....	
NOTICE OF INTENTION TO SHOOT OR ACIDIZE.....		SUBSEQUENT REPORT OF ABANDONMENT.....	
NOTICE OF INTENTION TO PULL OR ALTER CASING.....		SUPPLEMENTARY WELL HISTORY.....	JAN 18 1957
NOTICE OF INTENTION TO ABANDON WELL.....			

(INDICATE ABOVE BY CHECK MARK NATURE OF REPORT, NOTICE, OR OTHER DATA)

January 18, 1957

Well No. **66** is located **990** ft. from **(N)** line and **1650** ft. from **(E)** line of sec. **31**
NE Section 31 **28N** **7W** **104M**
(1/4 Sec. and Sec. No.) (Twp.) (Range) (Meridian)
Blanco **Rio Arriba** **New Mexico**
(Field) (County or Subdivision) (State or Territory)

The elevation of the derrick floor above sea level is **5983** ft.

DETAILS OF WORK

(State names of and expected depths to objective sands; show sizes, weights, and lengths of proposed casings; indicate mudding jobs, cementing points, and all other important proposed work)

It is intended to drill a well with rotary tools thru the Mesa Verde formation. Mud circulation will be used thru the Pictured Cliffs and set intermediate casing. Gas circulation will be used thru the Mesa Verde and production casing will be set. Possible productive intervals will be perforated and fractured. Estimated T.D. 4872'.

Casing Program:

10 3/4" at 170' with 125 sacks cement circulated to the surface.
7 5/8" at 2672' with 250 sacks cement.
5 1/2" at 4872' with 150 sacks cement.

The E/2 of Section 31 is dedicated to this well.
E/2 of 078500-A.

I understand that this plan of work must receive approval in writing by the Geological Survey before operations may be commenced.

Company **El Paso Natural Gas Company**

Address **Box 997**

Farmington, New Mexico

By _____

Title **Petroleum Engineer**

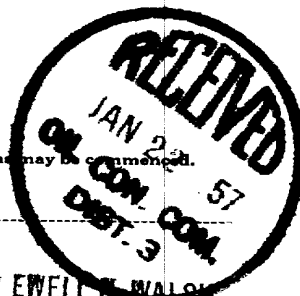

Original Signed **EWELL H. WALSH**



NEW MEXICO
OIL CONSERVATION COMMISSION

Form 10-129

WELL LOCATION AND/OR GAS PRODUCTION PLAT

JANUARY 17, 1957

EL PASO NATURAL GAS COMPANY SAN JUAN 28-7 UNIT SF 078500-A
68 31 28-N 7-W
990 NORTH 1650 EAST
RIO ARriba 5973
MESA VERDE BLANCO 315 ACRES
(1917 PLAT)

Note: All distances must be from center boundaries of section.

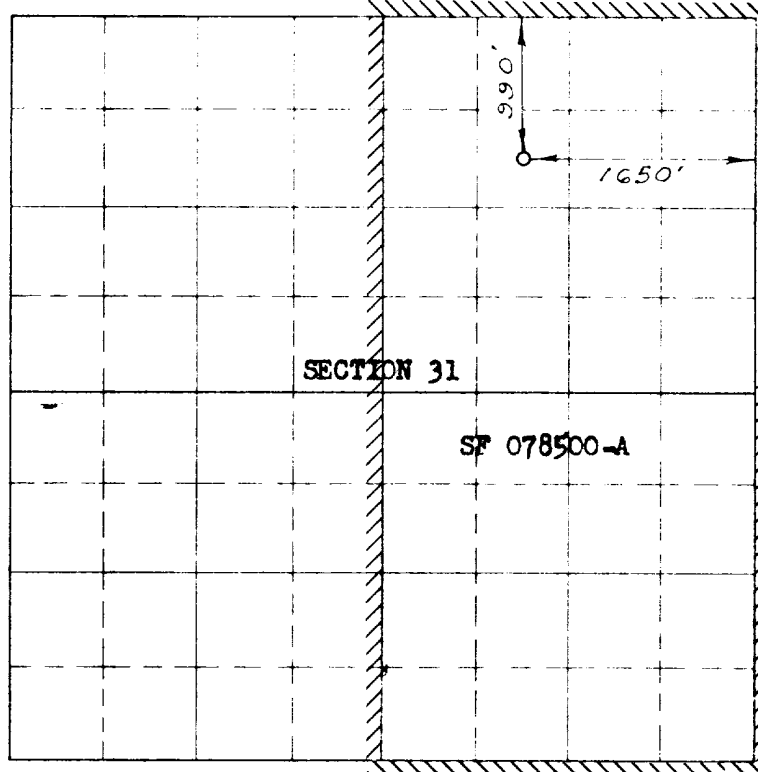

Scale: 1 inch equals 1 mile

U.S. DEPT. OF THE INTERIOR
BUREAU OF LAND MANAGEMENT
FARMINGTON, N.M.

NOTE

This section of
form is to be used
for gas wells only

This is to certify that the above plat was prepared from
field notes of actual surveys made by me or under my
supervision and that the same are true and correct to the
best of my knowledge and belief.

Date Surveyed DECEMBER 26, 1956

E. O. Vacker
Registered Professional Engineer and/or Land Surveyor

(Seal)

Farmington, New Mexico

1. Is this well a Dual Comp.
Yes _____ No X
2. If the answer to Question 1
is yes, are there any other dually
completed wells within the
dedicated acreage.
Yes _____ No _____

Original Signed EWELL N. WALSH
Name _____
Position Petroleum Engineer
Representing El Paso Natural Gas Co.
Address Box 997, Farmington, N.M.