

Company James D. Hancock & Co., Ltd.

Lease Mudge "B" SF-078896 Well No. 1

Sec. 29 T. 27 N., R. 11 W., N.M.P.M.

Location 990' from the North line and 990' from
the East line.

San Juan County

New Mexico

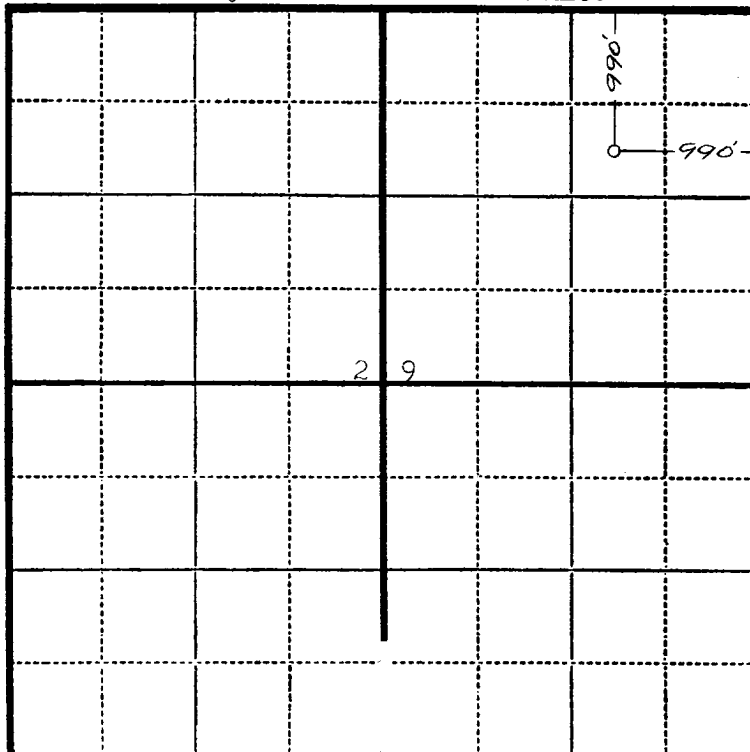

Scale—4 inches equals 1 mile.

This is to certify that the above plat was prepared from field notes of actual surveys made by me or under my supervision and that the same are true and correct to the best of my knowledge and belief.

Charles J. Finkler

Seal:

Registered Professional
Engineer and Land Surveyor.

Charles J. Finkler
N. Mex. Reg. No. 1302

Surveyed March 19, 1952

