

(SUBMIT IN TRIPLICATE)

Land Office Santa Fe  
Lease No. SF-073872A  
Unit \_\_\_\_\_

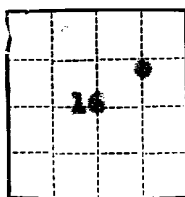

UNITED STATES  
DEPARTMENT OF THE INTERIOR  
GEOLOGICAL SURVEY

# SUNDRY NOTICES AND REPORTS ON WELLS

NOTICE OF INTENTION TO DRILL.....	<input checked="" type="checkbox"/>	SUBSEQUENT REPORT OF WATER SHUT-OFF.....	
NOTICE OF INTENTION TO CHANGE PLANS.....		SUBSEQUENT REPORT OF SHOOTING OR ACIDIZING.....	
NOTICE OF INTENTION TO TEST WATER SHUT-OFF.....		SUBSEQUENT REPORT OF ALTERING CASING.....	
NOTICE OF INTENTION TO RE-DRILL OR REPAIR WELL.....		SUBSEQUENT REPORT OF RE-DRILLING OR REPAIR.....	
NOTICE OF INTENTION TO SHOOT OR ACIDIZE.....		SUBSEQUENT REPORT OF ABANDONMENT.....	
NOTICE OF INTENTION TO PULL OR ALTER CASING.....		SUPPLEMENTARY WELL HISTORY.....	
NOTICE OF INTENTION TO ABANDON WELL.....			

(INDICATE ABOVE BY CHECK MARK NATURE OF REPORT, NOTICE, OR OTHER DATA)

August 9, 1960

**Bolack**  
Well No. **1-D** is located **1850** ft. from **(N)** line and **790** ft. from **(E)** line of **660** ft.  
**NE** **16** **27N** **11W** **N. M. P. M.**  
**SE NW** (1/4 Sec. and Sec. No.) (Twp.) (Range) (Meridian)  
**West Rutz Dakota** **San Juan** **New Mexico**  
(Field) (County or Subdivision) (State or Territory)

The elevation of the derrick floor above sea level is **6767** ft. **Not yet determined.**

## DETAILS OF WORK

(State names of and expected depths to objective sands; show sizes, weights, and lengths of proposed casings; indicate mudding jobs, cementing points, and all other important proposed work)

Operations to begin on or about August 29, 1960:

Drill 12 1/2" hole to approximately 200'.  
Set 8-5/8" casing at approximately 200' and circulate cement to surface.  
Drill 6-3/4" hole (or larger) to total depth at approximately 6775'. (Cut 30' core in the Dakota at approximately 6550', and drill stem test.)  
Log, and set 4 1/2" casing at total depth and two-stage cement to cover Dakota, Gallup, Pictured Cliffs formations.  
Complete in Dakota only.

I understand that this plan of work must receive approval in writing by the Geological Survey before operations may be commenced.

Company The Frontier Refining Company  
Address 4040 E. Louisiana Avenue  
Denver 23, Colorado  
By E. B. Granville  
Title Drilling & Production Superintendent

NEW MEXICO OIL CONSERVATION COMMISSION  
Well Location and Acreage Dedication Plat

Section A.

Date August 18, 1960

Operator Frontier Refining Company Lease 222,222  
Well No. 1-D Unit Letter H Section 16 Township 27 North Range 11 West NMPM  
Located 1850 Feet From North Line, 790 Feet From East Line  
County San Juan G. L. Elevation 6255 Dedicated Acreage 222 Acres  
Name of Producing Formation SAN JUAN Pool 222,222

1. Is the Operator the only owner\* in the dedicated acreage outlined on the plat below?  
Yes or No \_\_\_\_\_.
2. If the answer to question one is "no," have the interests of all the owners been consolidated by communitization agreement or otherwise? Yes \_\_\_\_\_ No \_\_\_\_\_. If answer is "yes," Type of Consolidation \_\_\_\_\_
3. If the answer to question two is "no," list all the owners and their respective interests below:

Owner

Land Description



Section B

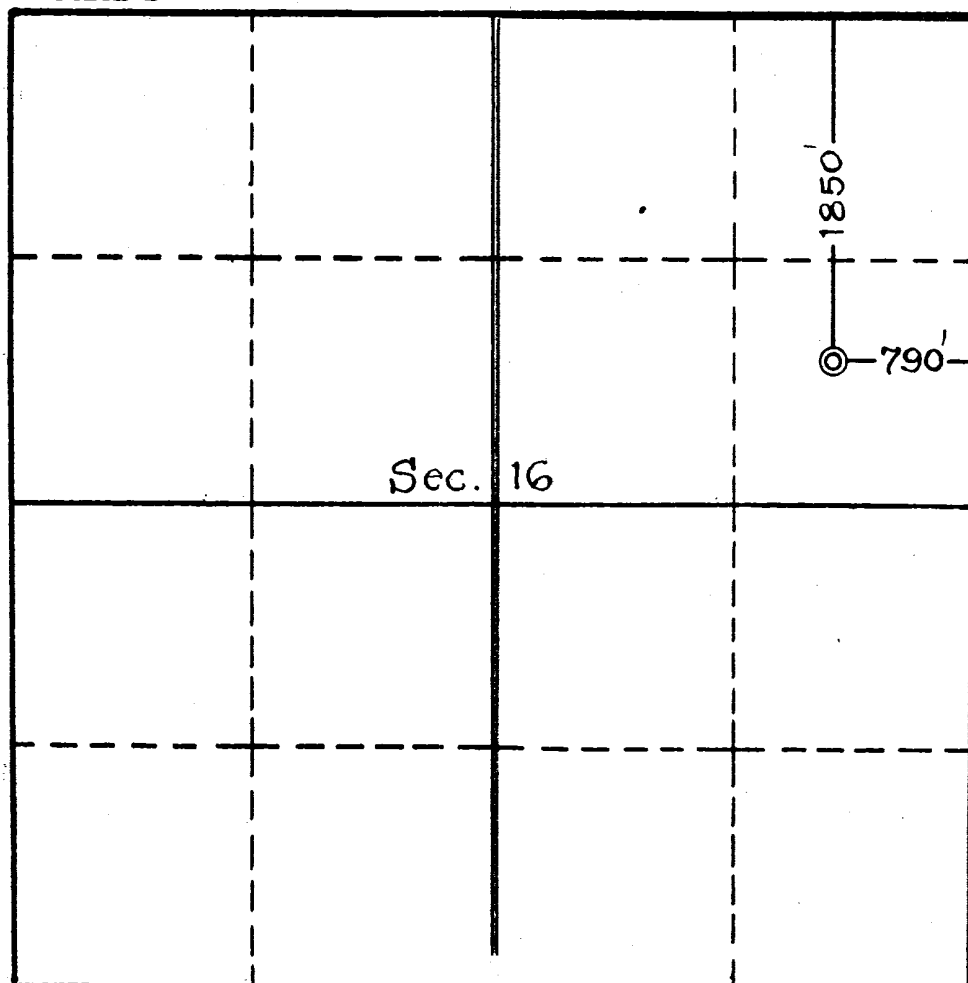

This is to certify that the information in Section A above is true and complete to the best of my knowledge and belief.

THE FRONTIER REFINING CO.  
(Operator)

J. M. Harrison  
(Representative)  
Box 22, Colorado  
6240 E. Louisiana Ave.  
Address

This is to certify that the well location shown on the plat in Section B was plotted from field notes of 1850 surveys made by me or under my supervision and that the same is true and correct to the best of my belief.

Date Surveyed August 17, 1960

C. L. Potat  
Registered Professional  
Engineer and/or Land Surveyor.



Certificate No. 3084

