

UNITED STATES
DEPARTMENT OF THE INTERIOR
GEOLOGICAL SURVEY

APPLICATION FOR PERMIT TO DRILL, DEEPEN, OR PLUG BACK

1a. TYPE OF WORK

DRILL ☒DEEPEN ☐PLUG BACK ☐

b. TYPE OF WELL

OIL
WELL ☐GAS
WELL ☒

OTHER

SINGLE
ZONE ☒MULTIPLE
ZONE ☐

2. NAME OF OPERATOR

PAN AMERICAN PETROLEUM CORPORATION

3. ADDRESS OF OPERATOR

Box 480, Farmington, New Mexico

4. LOCATION OF WELL (Report location clearly and in accordance with any State requirements.)*

990 FNL and 1650 FNL

At proposed prod. zone

14. DISTANCE IN MILES AND DIRECTION FROM NEAREST TOWN OR POST OFFICE*

15 miles south of Farmington, New Mexico

15. DISTANCE FROM PROPOSED*

LOCATION TO NEAREST
PROPERTY OR LEASE LINE, FT.
(Also to nearest drlg. unit line, if any)

990

18. DISTANCE FROM PROPOSED LOCATION*

TO NEAREST WELL, DRILLING, COMPLETED,
OR APPLIED FOR, ON THIS LEASE, FT.

None

16. NO. OF ACRES IN LEASE

512.4

19. PROPOSED DEPTH

6000'

17. NO. OF ACRES ASSIGNED
TO THIS WELL

320

20. ROTARY OR CABLE TOOLS

Rotary

21. ELEVATIONS (Show whether DF, RT, GR, etc.)

To be reported later

22. APPROX. DATE WORK WILL START*

September 20, 1964

23.

PROPOSED CASING AND CEMENTING PROGRAM

SIZE OF HOLE	SIZE OF CASING	WEIGHT PER FOOT	SETTING DEPTH	QUANTITY OF CEMENT
12-1/4"	8-5/8"	24#	350	250 sacks
7-7/8"	4-1/2"	10.5#	6000	1600 sacks (2 stage tool set 100' below base of Mesaverde)

Completion of well will be as indicated upon reaching total depth.
Copies of any logs run will be furnished upon completion of well.
Copies of location plat are attached.

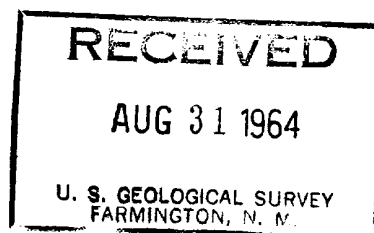
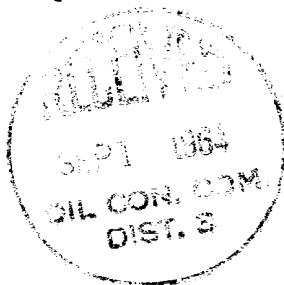

IN ABOVE SPACE DESCRIBE PROPOSED PROGRAM: If proposal is to deepen or plug back, give data on present productive zone and proposed new productive zone. If proposal is to drill or deepen directionally, give pertinent data on subsurface locations and measured and true vertical depths. Give blowout preventer program, if any.

24. Fred L. Nabors, District Engineer

SIGNED

ORIGINAL SIGNED BY
F. H. HOLLINGSWORTH

TITLE

DATE

August 28, 1964

(This space for Federal or State office use)

PERMIT NO.

APPROVAL DATE

APPROVED BY

TITLE

DATE

CONDITIONS OF APPROVAL, IF ANY:

Instructions

General: This form is designed for submitting proposals to perform certain well operations, as indicated, on all types of lands and leases for appropriate action by either a Federal or a State agency, or both, pursuant to applicable Federal and/or State laws and regulations. Any necessary special instructions concerning the use of this form and the number of copies to be submitted, particularly with regard to local, area, or regional procedures and practices, either are shown below or will be issued by, or may be obtained from, the local Federal and/or State office.

Item 1: If the proposal is to redrill to the same reservoir at a different subsurface location or to a new reservoir, use this form with appropriate notations. Consult applicable State or Federal regulations concerning subsequent work proposals or reports on the well.

Item 4: If there are no applicable State requirements, locations on Federal or Indian land should be described in accordance with Federal requirements. Consult local State or Federal office for specific instructions.

Item 14: Needed only when location of well cannot readily be found by road from the land or lease description. A plat, or plats, separate or on this reverse side, showing the roads to, and the surveyed location of, the well, and any other required information, should be furnished when required by Federal or State agency offices.

Items 15 and 18: If well is to be, or has been directionally drilled, give distances for subsurface location of hole in any present or objective production zone.

Item 22: Consult applicable Federal or State regulations, or appropriate officials, concerning approval of the proposal before operations are started.

NEW MEXICO OIL CONSERVATION COMMISSION
Well Location and Acreage Dedication Plat

SECTION A.

Date **AUGUST 27, 1964**

Operator **PAN AMERICAN PETROLEUM CORPORATION** Lease **FEDERAL GAS UNIT "G"**
Well No. **1** Unit Letter **C** Section **8** Township **27 NORTH** Range **12 WEST** NMPM
Located **990** Feet From **NORTH** Line **1650** Feet From **WEST** Line
County **SAN JUAN** G. L. Elevation **REPORT LATER** Dedicated Acreage **320** Acres
Name of Producing Formation **DAKOTA** Pool **BASIN DAKOTA**

1. Is the Operator the only owner* in the dedicated acreage outlined on the plat below? Yes _____ No **X**
2. If the answer to question One is "No," have the interests of all the owners been consolidated by communization agreement or otherwise? Yes **X** No _____. If answer is "Yes," Type of Consolidation **Communization**
agreements are circulating for signature; Pan American owns all acreage in the W/2 of Section 8 except the E/2 of the SW/4, which is owned by Bayview Oil Corp. & they have agreed to join in
3. If the answer to question Two is "No," list all the owners and their respective interests below: **the drilling of the well.**

OWNER

LAND DESCRIPTION

SECTION B.

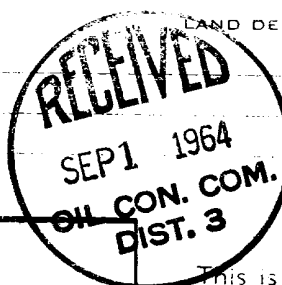
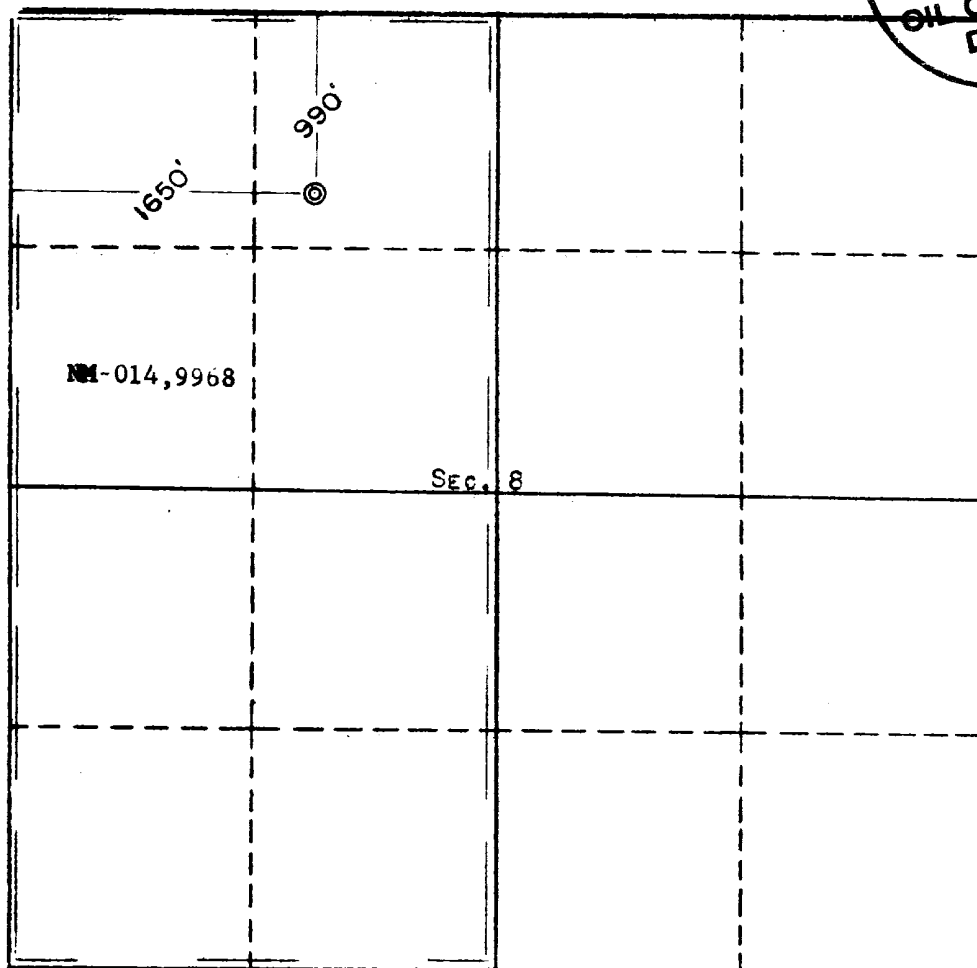

This is to certify that the information in Section A above is true and complete to the best of my knowledge and belief.

PAN AMERICAN PETROLEUM CORP.*F. H. Hollingsworth*
(OPERATOR)**F. H. Hollingsworth**

(REPRESENTATIVE)

P. O. Box 480**Farmington, New Mexico**

(ADDRESS)

This is to certify that the well location shown on the plat in Section B was plotted from field notes of actual surveys made by me or under my supervision and that the same is true and correct to the best of my knowledge and belief.

Date Surveyed **JUNE 1, 1964****Four States Engineering Co.**
FARMINGTON, NEW MEXICO*Four States Engineering Co.*
REGISTERED ENGINEER OR
LAND SURVEYORCertificate No. **3602**