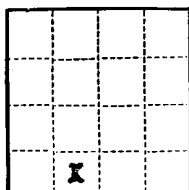

(SUBMIT IN TRIPLICATE)

Land Office Santa FeLease No. SF 077382Unit USA Hargrave "J"UNITED STATES
DEPARTMENT OF THE INTERIOR
GEOLOGICAL SURVEY

SUNDRY NOTICES AND REPORTS ON WELLS

NOTICE OF INTENTION TO DRILL.....	<input checked="" type="checkbox"/>	SUBSEQUENT REPORT OF WATER SHUT-OFF.....	
NOTICE OF INTENTION TO CHANGE PLANS.....		SUBSEQUENT REPORT OF SHOOTING OR ACIDIZING.....	
NOTICE OF INTENTION TO TEST WATER SHUT-OFF.....		SUBSEQUENT REPORT OF ALTERING CASING.....	
NOTICE OF INTENTION TO RE-DRILL OR REPAIR WELL.....		SUBSEQUENT REPORT OF RE-DRILLING OR REPAIR.....	
NOTICE OF INTENTION TO SHOOT OR ACIDIZE.....		SUBSEQUENT REPORT OF ABANDONMENT.....	
NOTICE OF INTENTION TO PULL OR ALTER CASING.....		SUPPLEMENTARY WELL HISTORY.....	
NOTICE OF INTENTION TO ABANDON WELL.....			

(INDICATE ABOVE BY CHECK MARK NATURE OF REPORT, NOTICE, OR OTHER DATA)

USA Hargrave "J"

Farmington, New Mexico June 8, 1959

Well No. 1 is located 790 ft. from S line and 1890 ft. from W line of sec. 3SW 1/4 of Section 3
(1/4 Sec. and Sec. No.)T27N
(Twp.)R10W
(Range)N.M.P.M.
(Meridian)Angels Peak Dakota
(Field)

San Juan

(County or Subdivision)

New Mexico
(State or Territory)

The elevation of the derrick floor above sea level is _____ ft. (To be reported later)

DETAILS OF WORK

(State names of and expected depths to objective sands; show sizes, weights, and lengths of proposed casings; indicate mudding jobs, cementing points, and all other important proposed work)

USA Hargrave "J" No. 1. We propose to drill the above well to an approximate total depth of 6600' with rotary tools to evaluate Dakota prospects. Stimulation and completion will be as indicated upon reaching total depth.

The following casing program is proposed:

SIZE	DEPTH	REMARKS
9-5/8"	350'	Neat - circulate.
4 1/2" or 3 1/2"	6600'	First stage 4 1/2 gel followed by 100 sacks neat. Second stage 4 1/2 gel. Casing will be cemented by 2-stage method with DV tool set approximately 100' below Pictured Cliffs. First stage will consist of sufficient cement to fill 500' above top of Dakota. Second stage will consist of sufficient cement to fill 200-300' above Pictured Cliffs.

Copies of location plat are attached. A copy of any survey taken will be submitted upon completion of well.

I understand that this plan of work must receive approval in writing by the Geological Survey before operations may be commenced.

Company Pan American Petroleum CorporationAddress Box 487Farmington, New MexicoORIGINAL SIGNED BY
R. M. Bauer, Jr.

By _____

Title Area Engineer

* Either 4-1/2" or 5-1/2" will be run dependent upon availability.

NEW MEXICO OIL CONSERVATION COMMISSION

Well Location and Acreage Dedication Plat

Section A.

Date April 16, 1959

Operator PAN AMERICAN PETROLEUM CORPORATION Lease U.S.A. HARGRAVE "J"
 Well No. 1 Unit Letter N Section 3 Township 27 NORTH Range 10 WEST NMPM
 Located 790 Feet From SOUTH Line, 1850 Feet From WEST Line
 County SAN JUAN G. L. Elevation * Dedicated Acreage 320.96 Acres
 Name of Producing Formation Dakota Pool Angels Peak Dakota

1. Is the Operator the only owner in the dedicated acreage outlined on the plat below?

Yes No X***To be reported later**2. If the answer to question one is "no", have the interests of all the owners been consolidated by communitization agreement or otherwise? Yes X No . If answer is "yes", Type of Consolidation.**Joint acreage holdings**

3. If the answer to question two is "no", list all the owners and their respective interests below:

OwnerLand Description

Section B.

This is to certify that the information
 in Section A above is true and complete
 to the best of my knowledge and belief.

PAN AMERICAN PETROLEUM CORPORATION

(Operator)

R. M. Bauer, Jr. RMBauer Jr.

(Representative)

Box 487, Farmington, New Mexico

(Address)

Note: All distances must be from outer boundaries of section.

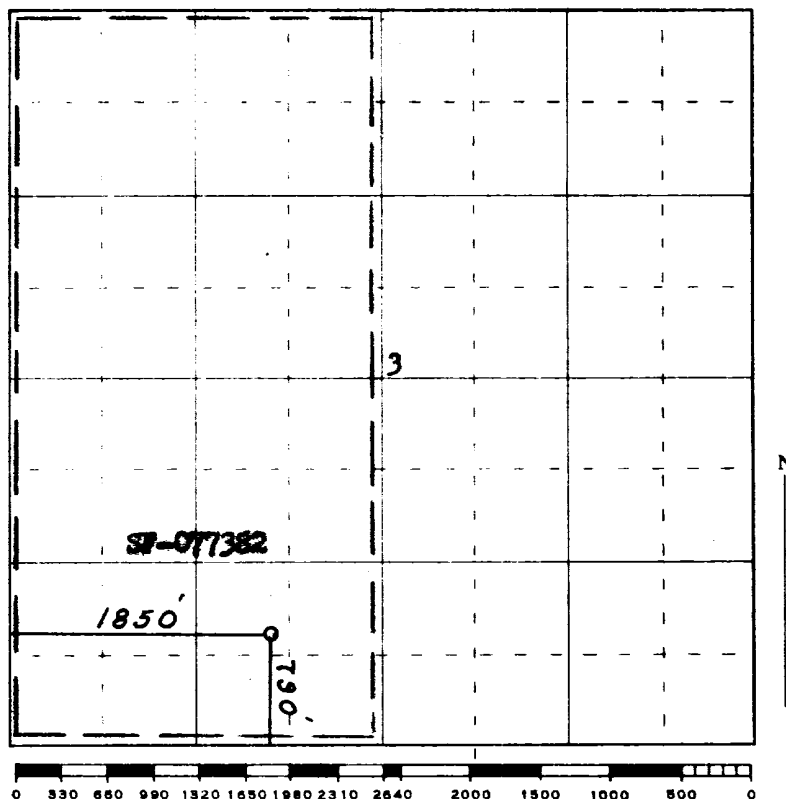

Scale 4 inches equal 1 mile

REF. GLO PLAT DATED 19 JULY 1915



Farmington, New Mexico

This is to certify that the above plat was prepared from field notes of actual surveys
 made by me or under my supervision and that the same are true and correct to the best
 of my knowledge and belief.

Date Surveyed 15 April 1959

James P. Leese
 Registered Professional Engineer and/or Land Surveyor
 James P. Leese N. Mex. Reg. No. 1463