

UNITED STATES
DEPARTMENT OF THE INTERIOR
GEOLOGICAL SURVEY

Land Office Santa Fe
Lease No. 078902
Unit West Kutz Field

SUNDRY NOTICES AND REPORTS ON WELLS

NOTICE OF INTENTION TO DRILL.....	<input checked="" type="checkbox"/>	SUBSEQUENT REPORT OF WATER SHUT-OFF.....	
NOTICE OF INTENTION TO CHANGE PLANS.....		SUBSEQUENT REPORT OF SHOOTING OR ACIDIZING.....	
NOTICE OF INTENTION TO TEST WATER SHUT-OFF.....		SUBSEQUENT REPORT OF ALTERING CASING.....	
NOTICE OF INTENTION TO RE-DRILL OR REPAIR WELL.....		SUBSEQUENT REPORT OF REDRILLING OR REPAIR.....	
NOTICE OF INTENTION TO SHOOT OR ACIDIZE.....		SUBSEQUENT REPORT OF ABANDONMENT.....	
NOTICE OF INTENTION TO PULL OR ALTER CASING.....		SUPPLEMENTARY WELL HISTORY.....	
NOTICE OF INTENTION TO ABANDON WELL.....			

(INDICATE ABOVE BY CHECK MARK NATURE OF REPORT, NOTICE, OR OTHER DATA)

September 15, 1952

(Lilly)

Well No. 1 is located 692 ft. from N line and 877 ft. from E line of sec. 4
NE/4 Sec. 4 27N 12W NMPM
(1/4 Sec. and Sec. No.) (Twp.) (Range) (Meridian)
West Kutz San Juan New Mexico
(Field) (County or Subdivision) (State or Territory)

The elevation of the derrick floor above sea level is ft. (Not available, will furnish later.)

DETAILS OF WORK

(State names of and expected depths to objective sands; show sizes, weights, and lengths of proposed casings; indicate muddling jobs, cementing points, and all other important proposed work)

Pictured Cliffs sand test. Estimated depth 1500'.

Surface casing: 80' of 40# 9 5/8" - Cemented to the surface.
Production casing: 1500' of 20# 6 5/8" - Cemented with 100 sacks.

If commercial production is indicated, the producing section will be shot with nitroglycerin.

I understand that this plan of work must receive approval in writing by the Geological Survey before operations may be commenced.

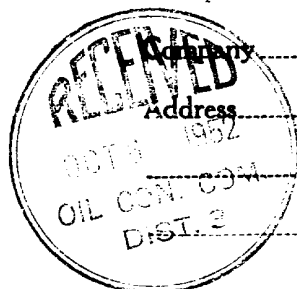

Company BENSON AND MONTIN
Address 315 1/2 West Main St.
Farmington, New Mexico

By Albert R. Greer
Albert R. Greer,
Title Field Sup't.

1912

1913

1914

1915

1916

1917

1918

1919

1920

1921

1922

1923

1924

1925

1926

1927

1928

1929

Company Benson-Montin

Lease _____ Well No. 1 Lilly

Sec. 4 T. 27 N., R. 12 W., N.M.P.M.

Location 1650' from the North line and 1650' from the East line.

San Juan County

New Mexico

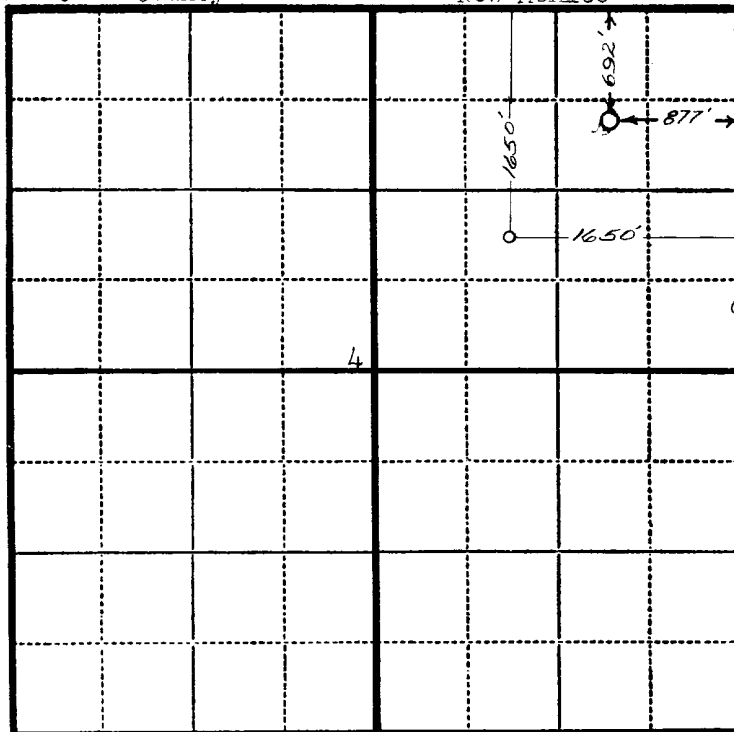

Location moved to point
692' from the North line
and 877' from the East
line of same Section.

Signed/

Albert R. Greer

Albert R. Greer
Registered Professional
Engineer #805
May 20, 1952

Scale—4 inches equals 1 mile.

This is to certify that the above plat was prepared from field notes of actual surveys made by me or under my supervision and that the same are true and correct to the best of my knowledge and belief.

Charles J. Finkles

Seal:

Registered Professional
Engineer and Land Surveyor.

Charles J. Finkles
N. Mex. Reg. No. 1302

Surveyed April 21, 19 52

