

NEW MEXICO OIL CONSERVATION COMMISSION
WELL LOCATION AND ACREAGE DEDICATION PLAT

Form C-102
Supersedes C-128
Effective 1-1-65

All distances must be from the outer boundaries of the Section.

Operator Dugan Production Corporation			Lease KR		Well No. 2
Unit Letter D	Section 29	Township 27 North	Range 13 West	County San Juan	
Actual Footage Location of Well: 973 feet from the North line and 1000 feet from the West line					
Ground Level Elev. 6085	Producing Formation Pictured Cliffs		Pool WAW FR Sand-PC *		Dedicated Acreage: 160 Acres

1. Outline the acreage dedicated to the subject well by colored pencil or hachure marks on the plat below.
2. If more than one lease is dedicated to the well, outline each and identify the ownership thereof (both as to working interest and royalty).
3. If more than one lease of different ownership is dedicated to the well, have the interests of all owners been consolidated by communitization, unitization, force-pooling, etc?

Yes No If answer is "yes," type of consolidation _____

If answer is "no," list the owners and tract descriptions which have actually been consolidated. (Use reverse side of this form if necessary.) _____

No allowable will be assigned to the well until all interests have been consolidated (by communitization, unitization, forced-pooling, or otherwise) or until a non-standard unit, eliminating such interests, has been approved by the Commission. *In compliance with NMOCD Order No. R-8769

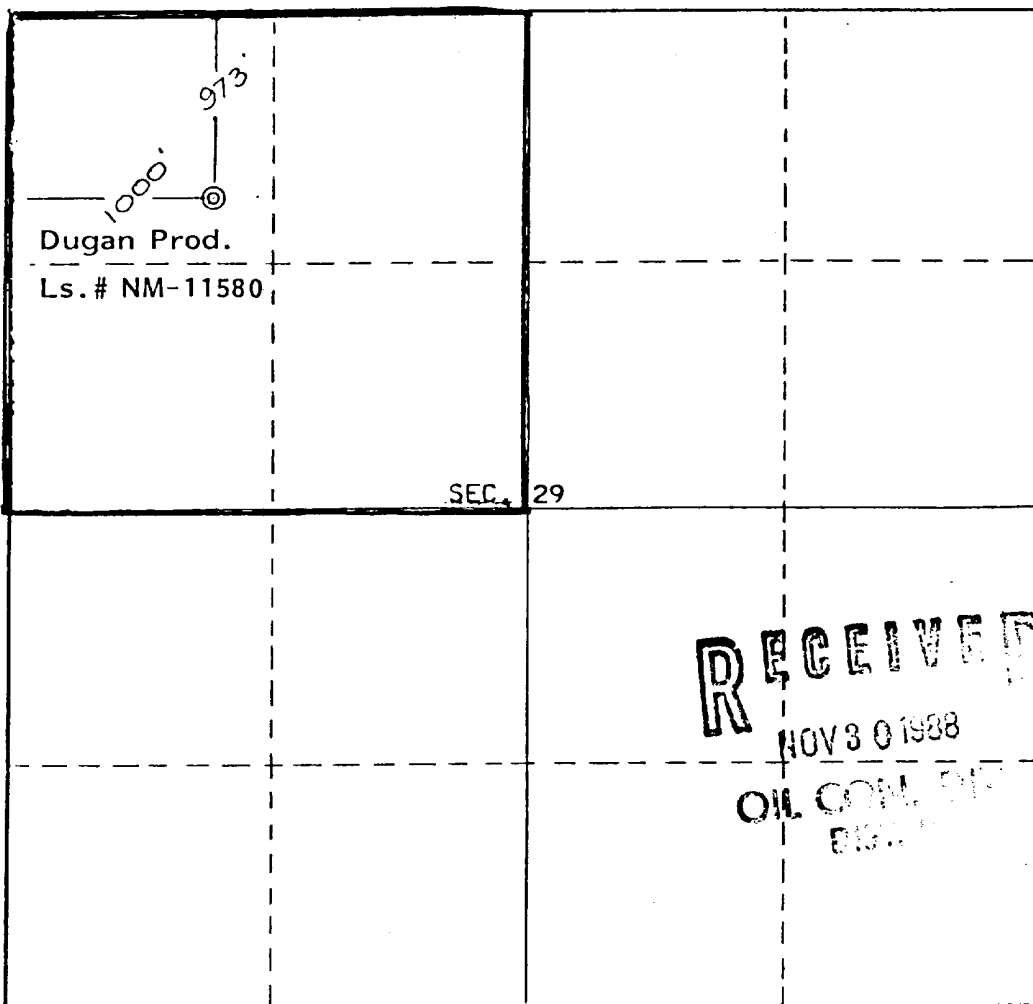

CERTIFICATION

I hereby certify that the information contained herein is true and complete to the best of my knowledge and belief.

Thomas A. Dugan

Name	Thomas A. Dugan
Position	Engineer
Company	Dugan Production Corp.
Date	11-28-88

I hereby certify that the well location shown on this plat was plotted from field notes of actual surveys made by me or under my supervision, and that the same is true and correct to the best of my knowledge and belief.

Date Surveyed	August 6, 1975
Registered Professional Engineer and/or Land Surveyor	<i>E.V. Echhawk</i>
Certificate No.	3602 E.V. Echhawk LS



MEXICO OIL
W/S.S.
+NSL

Form C-102
Supersedes C-128
Effective 1-1-55

NEW MEXICO OIL CONSERVATION COMMISSION
WELL LOCATION AND ACREAGE DEDICATION PLAT

All distances must be from the outer boundaries of the Section.

Operator Dugan Production Corporation			Lease KR		Well No. 2
Unit Letter D	Section 29	Township 27 North	Range 13 West	County San Juan	
Actual Footage Location of Well: 973 feet from the North line and 1000 feet from the West line					
Ground Level Elev. 6085	Producing Formation Fruitland Coal		Pool Basin-Fruitland Coal *		Dedicated Acreage: 320 Acres

1. Outline the acreage dedicated to the subject well by colored pencil or hachure marks on the plat below.
2. If more than one lease is dedicated to the well, outline each and identify the ownership thereof (both as to working interest and royalty).
3. If more than one lease of different ownership is dedicated to the well, have the interests of all owners been consolidated by communitization, unitization, force-pooling, etc?

Yes No If answer is "yes," type of consolidation _____

If answer is "no," list the owners and tract descriptions which have actually been consolidated. (Use reverse side of this form if necessary.) _____

No allowable will be assigned to the well until all interests have been consolidated (by communitization, unitization, forced-pooling, or otherwise) or until a non-standard unit, eliminating such interests, has been approved by the Commission.

*In compliance with NMOCD Order No. R-8768 and R-8769

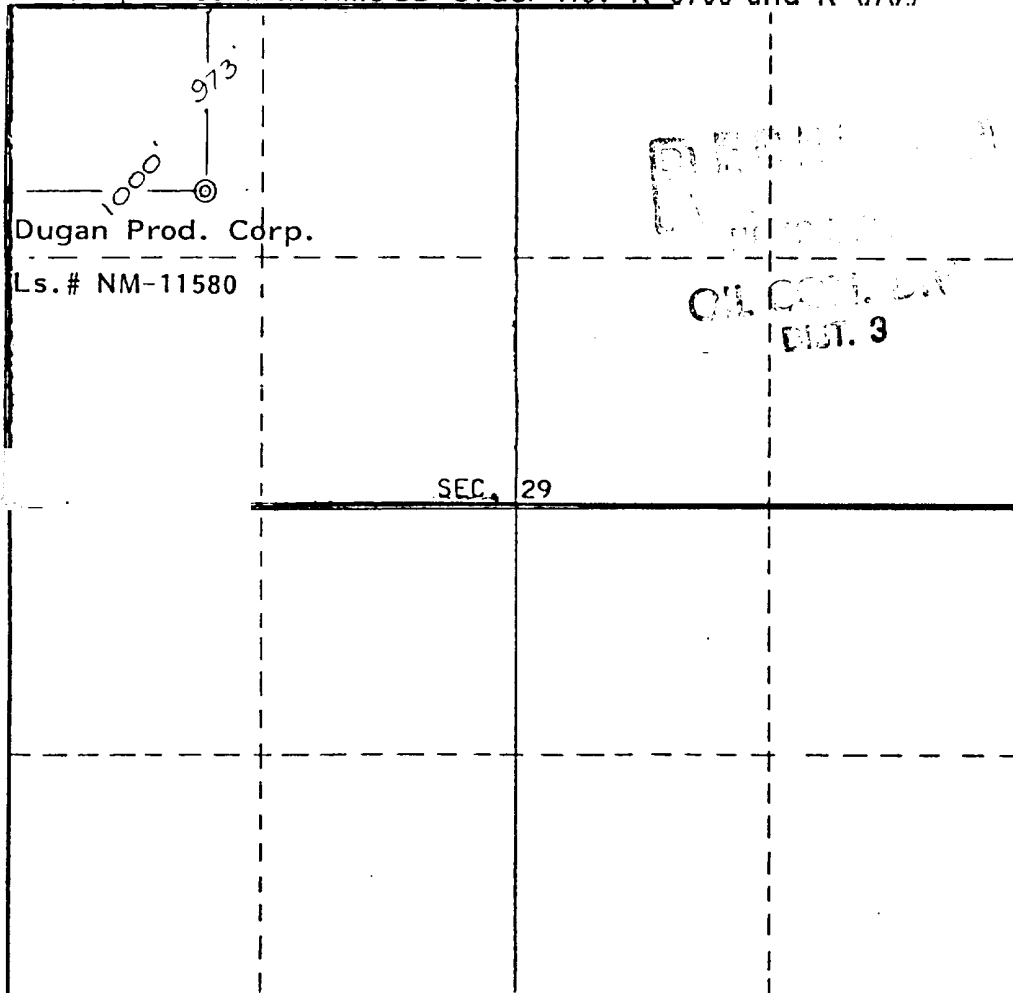

CERTIFICATION

I hereby certify that the information contained herein is true and complete to the best of my knowledge and belief.

Thomas A. Dugan

Name
Thomas A. Dugan

Position
Engineer

Company
Dugan Production Corp.

Date
11-17-88

I hereby certify that the well location shown on this plat was plotted from field notes of actual surveys made by me or under my supervision, and that the same is true and correct to the best of my knowledge and belief.

Date Surveyed
August 6, 1975

Registered Professional Engineer
and/or Land Surveyor

E.V. Echohawk

Certificate No. **3602**
E.V. Echohawk LS

