

UNITED STATES  
DEPARTMENT OF THE INTERIOR  
GEOLOGICAL SURVEY

30-043-23453

APPLICATION FOR PERMIT TO DRILL, DEEPEN, OR PLUG BACK

1a. TYPE OF WORK  
 DRILL                       DEEPEN                       PLUG BACK

b. TYPE OF WELL  
 OIL WELL                       GAS WELL                       OTHER   
 SINGLE ZONE                       MULTIPLE ZONE

2. NAME OF OPERATOR  
 Patrick Petroleum Corporation of Michigan

3. ADDRESS OF OPERATOR  
 388 Denver Club Building, Denver, Colorado, 80202

4. LOCATION OF WELL (Report location clearly and in accordance with any State requirements.)\*  
 At surface 2375' FWL & 790' FNL  
 At proposed prod. zone NENW Section 17, T27N, R12W

14. DISTANCE IN MILES AND DIRECTION FROM NEAREST TOWN OR POST OFFICE\*  
 17 Miles N to Farmington, New Mexico

15. DISTANCE FROM PROPOSED\* LOCATION TO NEAREST PROPERTY OR LEASE LINE, FT. (Also to nearest drig. unit line, if any) 790' FNL

16. NO. OF ACRES IN LEASE  
 640

17. NO. OF ACRES ASSIGNED TO THIS WELL  
 320

18. DISTANCE FROM PROPOSED LOCATION\* TO NEAREST WELL, DRILLING, COMPLETED, OR APPLIED FOR, ON THIS LEASE, FT.

19. PROPOSED DEPTH  
 6300'

20. ROTARY OR CABLE TOOLS  
 Rotary

21. ELEVATIONS (Show whether DF, RT, GR, etc.)  
 5739' GR

22. APPROX. DATE WORK WILL START\*  
 May 1, 1979

23. PROPOSED CASING AND CEMENTING PROGRAM

SIZE OF HOLE	SIZE OF CASING	WEIGHT PER FOOT	SETTING DEPTH	QUANTITY OF CEMENT
12-1/4"	8-5/8"	24.0	250'	175 sk 118" w/ 2% CaCl <sub>2</sub> Flocele
7-7/8"	4-1/2"	10.5	6300'	275 sk 50/50 Pozmix w/ 2% gel 6-1/4" #/sk gilsonite and 10% salt

We propose to drill a well to 6300' to test the Dakota formation and any shallower zones of significance. If productive, we will case as shown and complete. If dry, we will P&A as per USGS and State of New Mexico requirements.

*gas is identified*

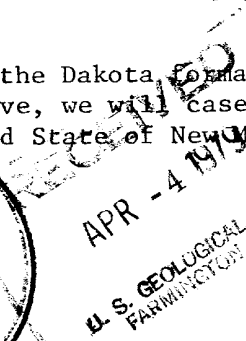
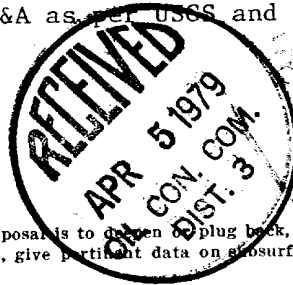

IN ABOVE SPACE DESCRIBE PROPOSED PROGRAM: If proposal is to open or plug back, give data on present productive zone and proposed new productive zone. If proposal is to drill or deepen directionally, give pertinent data on subsurface locations and measured and true vertical depths. Give blowout preventer program, if any.

24. SIGNED K. R. Gordon TITLE LeClair-Westwood, Inc. Agent  
Production Engineer DATE 3-30-79

(This space for Federal or State office use)

PERMIT NO. \_\_\_\_\_ APPROVAL DATE \_\_\_\_\_

APPROVED BY \_\_\_\_\_ TITLE \_\_\_\_\_ DATE \_\_\_\_\_

CONDITIONS OF APPROVAL, IF ANY:

\*See Instructions On Reverse Side

NMOCC

# PLAT #1

## NEW MEXICO OIL CONSERVATION COMMISSION WELL LOCATION AND ACREAGE DEDICATION PLAT

Form O-16  
Supersedes O-12P  
Effective 1-1-79

All distances must be from the outer boundaries of the Section.

Operator <b>PATRICK PETROLEUM CORPORATION of MICHIGAN</b>		Lease <b>S T P FEDERAL</b>		Well No. <b>1-<del>12</del></b>
Unit Letter <b>C</b>	Section <b>17</b>	Township <b>27 NORTH</b>	Range <b>12 WEST</b>	County <b>SAN JUAN</b>
Actual Footage Location of Well: <b>790</b> feet from the <b>NORTH</b> line and <b>2375</b> feet from the <b>WEST</b> line				
Ground Level Elev. <b>5739</b>	Producing Formation <b>Dakota</b>	Pool <i>Bruni</i>	Dedicated Acreage: <b>320</b> Acres	

1. Outline the acreage dedicated to the subject well by colored pencil or hachure marks on the plat below.
2. If more than one lease is dedicated to the well, outline each and identify the ownership thereof (both as to working interest and royalty).
3. If more than one lease of different ownership is dedicated to the well, have the interests of all owners been consolidated by communitization, unitization, force-pooling, etc?  
 Yes    No   If answer is "yes," type of consolidation \_\_\_\_\_

If answer is "no," list the owners and tract descriptions which have actually been consolidated. (Use reverse side of this form if necessary.) \_\_\_\_\_

No allowable will be assigned to the well until all interests have been consolidated (by communitization, unitization, forced-pooling, or otherwise) or until a non-standard unit, eliminating such interests, has been approved by the Commission.

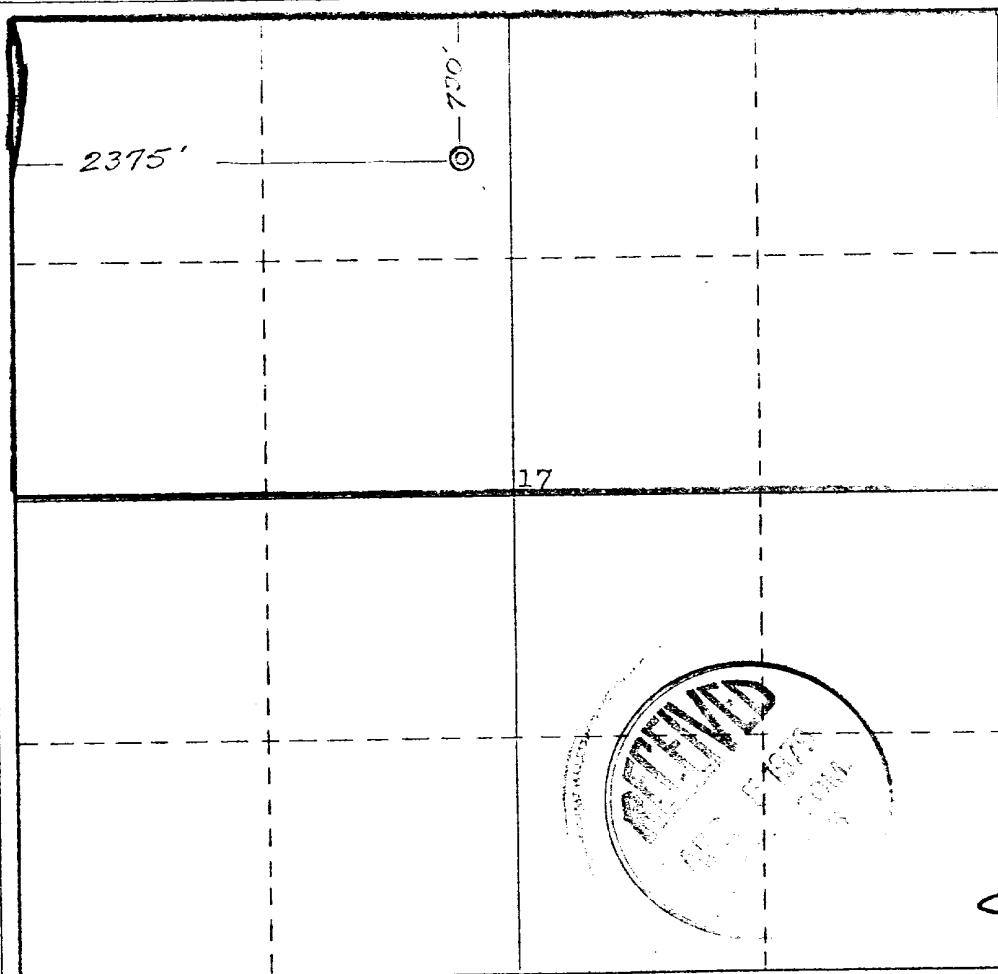

### CERTIFICATION

I hereby certify that the information contained herein is true and complete to the best of my knowledge and belief.

Name <i>K.R. Anderson</i>
Position <b>Production Engineer</b>
Company <b>LeClair-Westwood, Inc.</b>
Date <b>March 30, 1979</b>

I hereby certify that the information shown on this plat was plotted from field notes of actual surveys made by me or under my supervision, and that the same is true and correct to the best of my knowledge and belief.

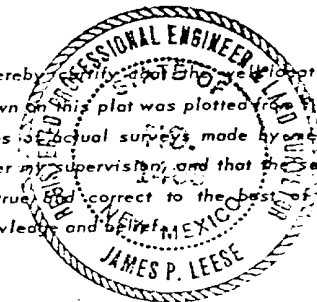

Date Surveyed <b>21 January 1979</b>
Registered Professional Engineer <i>James P. Leese</i> <b>James P. Leese</b>

Certificate No. **1463**

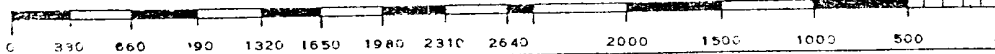

LeCLAIR  
WESTWOOD  
INC.

**LeCLAIR - WESTWOOD, INC.**  
388 DENVER CLUB BUILDING  
DENVER, COLORADO 80202  
(303) 825-4258

March 30, 1979

United States Department  
of the Interior  
Geological Survey  
P.O. BOX 959  
409 Petroleum Plaza  
Farmington, New Mexico 87401

Re: STP Federal #1-17  
NE NW Sec. 17, T27N, R12W  
San Juan County, New Mexico

Gentlemen:

We submit the following application and plats for permission to drill the STP Federal #1-17.

1. Existing Roads

- A. See attached surveyors plat (Plat #1).
- B. Exit New Mexico Highway 371 7.3 miles South of Farmington, New Mexico, turning left on Navajo road 3003. Go 6.7 miles to Navajo road 4047, turn right and go 3.2 miles to Navajo road 4022. Travel 0.8 miles West (right) on dirt road and then approximately 0.1 mile South (left) to lease road. Turn right and go approximately 300 feet to location.
- C. Access roads (see Map #1).
- D. Navajo roads 4047 and 4022 are two-lane paved roads. All other roads unimproved ranch roads.
- E. N/A
- F. Only minimal blading of existing dirt roads is planned.

2. Planned Access Roads

- A. New access road will be approximately 15' wide. There will be no reconstruction of existing roads.
- B. Grades are minimal (less than 5%).
- C. No turnouts will be constructed at this time.

- D. Only natural drainage exists and no new drainage will be constructed.
- E. There are no culverts to be installed and there is no cut and fill necessary to build the new road.
- F. No surfacing materials will be needed to be hauled to this location.
- G. No fences will need to be cut and no gates or cattle guards will need to be installed.
- H. The last 300 feet will be new access road and will be 15 feet wide with no grade to exceed 5%.

3. Location of Existing Wells

- A. There are no known water wells within a two-mile radius of the proposed well.
- B. There are 7 known abandoned wells within a two-mile radius of the proposed well (see Map #2).
- C. There is one known temporarily abandoned well within a two-mile radius of the proposed well.
- D. There are no known disposal wells within a two-mile radius of the proposed well.
- E. There are no known drilling wells within a two-mile radius of the proposed well.
- F. There are 41 producing wells within a two-mile radius of the proposed well.
- G. There are no known shut-in wells within a two-mile radius of the proposed well.
- H. There are no known injection wells within a two-mile radius of the proposed well.
- I. There are no known monitoring or observation wells within a two-mile radius of the proposed well.

4. Location of Existing and/or Proposed Facilities

- A. There are no tank batteries, production facilities, oil gathering lines, gas gathering lines, injection lines or disposal lines owned or controlled by Patrick Petroleum Corporation of Michigan within a one-mile radius of the proposed location.
- B. New facilities contemplated in the event of production are shown on the Tank Battery Plat.
  - 1. Proposed location will be on the existing drilling pad oriented as shown on the Tank Battery Plat.
  - 2. Dimensions of facilities - see Tank Battery Plat.
  - 3. Only native materials will be utilized.
  - 4. An earthen dike utilizing soil in the area immediately surrounding the storage tanks will be constructed to contain oil should a leak occur in the storage tanks. Proper fencing (five strand barbed wire) will be installed to prevent wildlife from entering the production facilities or tank battery. No fill or load lines will extend beyond fences, so wildlife cannot tamper with same. Wire will be laid across pits to prevent any wildlife entry.
- C. Any disturbed areas no longer needed will be returned to their original contours and reseeded in accordance with the BLM or the landowner's requirements.

5. Location and Type of Water Supply

- A. Plans are currently being made to purchase water from the Navajo Agricultural Products Industry.

6. Source of Construction Materials

- A. Only native materials are to be utilized.
- B. Navajo Irrigation Project lands are involved.
- C. Surface soils only in the immediate area will be utilized.
- D. Refer to Map #1.

7. Methods for Handling Waste Disposal

- A. Drill cuttings are to be contained in an earthen reserve pit.
- B. Drilling fluids are to be contained in an earthen reserve pit.
- C. The produced fluids will be produced into a test tank until such time as construction of treating facilities is completed.
- D. A waste hole for sewage discharge from the trailer will be drilled.
- E. Garbage and other waste materials are to be contained in a trash pit fenced with small mesh wire. This trash is to be burned periodically and the remains buried when the well is completed.
- F. All trash, garbage, etc., is to be gathered and burned or buried at the completion of drilling operations. Mud pits will be allowed to dry after drilling is completed and then adequately filled, tamped and leveled. All garbage and/or sewage pits will be filled as soon as the rig leaves the location.

8. Ancillary Facilities

There are no camps or airstrips planned.

9. Wellsite Layout

- A. See plat #2 for location of mud tanks, reserve pit, burn pit, trash pit, pipe rack, living facilities, and soil material stock-piles.
- B. See plat #2 for rig orientation, parking areas and access roads.
- C. Pits are not to be lined.

10. Plans for Restoration of Surface

- A. The reserve pit area will be fenced and allowed to dry for several weeks. Pits will be backfilled, leveled, contoured and reseeded as per BLM or surface owner's requirements.
- B. Seeding will be done in the fall of 1979 when the frost is out of the ground and before September 15, 1979 as required by BLM or surface owner.

10. Plans for Restoration of Surface, Con't.

- C. Pits will be fenced as stated in A above.
- D. If there is oil in the pit, it will be removed or the pit will be flagged overhead as required.
- E. The estimated date for starting rehabilitation operations is June, 1979 and the estimated completion date is September 15, 1979.

11. Other Information

- A. The topography of the subject area is basically gentle rolling hills with salt brush, rice grass, sage and other native grasses and the soil is sandy. The well site will require virtually no cut, only leveling. The reserve pit will be oriented E-W along the edge of a draw that runs into Gallegos Canyon to the West of the location. The production facilities will be located on the well site and will require no additional grading. No pronounced geological features exist.
- B. The surface in the general area of the site is used for growing crops and livestock grazing. The surface to be used is owned by the Navajo Indian Irrigation Project.
- C. There is occasionally water in the Gallegos Canyon river bottom. There are no known occupied dwelling, archeological, historical or cultural sites in the immediate area of the site. An archeological survey has not been made; however, a report will be submitted when the survey has been completed.

12. Lessee's or Operator's Representative

Mr. Kenneth R. Gordon will be the Patrick Petroleum Corporation of Michigan representative. Mr. Gordon can be reached by telephone in Denver, Colorado, at his office-(303) 825-4258, or at his residence-(303) 989-1584.

13. Certification

I hereby certify that I, or persons under my direct supervision, have inspected the proposed drillsite and access route; that I am familiar with the conditions which presently exist; that the statements made

U.S. Dept. of Interior  
STP Federal #1-17  
March 30, 1979  
Page 6

13. Certification, Con't.

in this plan are, to the best of my knowledge, true and correct; and that the work associated with the operations proposed herein will be performed by Patrick Petroleum Corporation of Michigan and its contractors and subcontractors in conformity with this plan and the terms and conditions under which it is approved.

LeCLAIR-WESTWOOD, INC.

3-30-79  
(Date)

By



Kenneth R. Gordon,  
Production Engineer

KRG:vmc

Attachments



TEN-POINT PROGRAM

STP FEDERAL #1-17

1. The outcropping geological formation on the surface is the Wasatch.
2. The estimated formation tops to be encountered are as follows:

FORMATION	DEPTH	SUBSEA
Fruitland	1030'	+4709'
Pictured Cliffs	1280'	+4459'
Mesaverde	2090'	+3649
Gallup	4840'	+ 899
Greenhorn	5690'	+ 49
Graneros	5750'	- 11
Dakota	5850'	- 111
Burro Canyon	5985'	- 246

3. The following depths are estimated for water, oil, gas and mineral-bearing zones:

SUBSTANCES	ANTICIPATED DEPTH
Coal (Scattered throughout)	Surface to bottom of Mesaverde
Water	Surface to 300'
Oil and Gas	Fruitland 1030' (possible show of oil and/or gas) Pictured Cliffs 1280' (possible commercial gas production) Mesaverde 2090' (possible show of oil and/or gas) Gallup 4840' (possible commercial oil and/or gas production) Dakota 5850' (possible commercial gas production)

4. Casing Design:

PURPOSE	DEPTH	SIZE O.D.	WEIGHT	GRADE	TYPE
Surface	0-250'	8-5/8"	24.0	K-55	ST&C
Production	0-6000'	4-1/2"	10.5	K-55	ST&C

B. Cement Program:

<u>SURFACE</u>	<u>TYPE &amp; AMOUNT OF CEMENT</u>
0-250' circulated	175 sacks class "B" cement with 2% CaCl <sub>2</sub> , 1/4 lb./sack flocele
<u>PRODUCTION</u>	<u>TYPE &amp; AMOUNT OF CEMENT</u>
0-6000'	275 sacks 50/50 Pozmix cement with 2% gel, 6-1/4 lb./sack Gilsonite and 10% salt

5. A. Diagram A details blowout preventer stack consisting of one 10"-900 series double ram hydraulic with Payne closing unit. Blowout preventer stack will be tested to 1000 psi after nipping up and thereafter each 24 hours, recording testing in daily drilling report.
- B. Casing head will be Series 900-10" flange 8-5/8" x 4-1/2", 3000 psi WP.
6. Drilling fluid will consist of the following:
 

0-250'	Gel slurry with lime to maintain sufficient viscosity to keep hole clean prior to setting surface casing.
250-4500'	Clear water with a flocculant.
4500-6000'	Low solids, non-dispersed mud with MW 9.0-9.2 ppg, vis. 36-40, FL 6-8 cc.
7. The following auxiliary equipment will be used:
  - A. Kelly Cock.
  - B. Float above the bit.
  - C. A sub with a full opening valve will be on the floor when the kelly is not in use.
8. A. A 90' core will be obtained through Graneros & Dakota formations.
- B. If conditions warrant, the following zones will be drill stem tested:

<u>FORMATION</u>	<u>DEPTH</u>
Graneros	5800-5850'
Dakota	5850-TD

Others will be run as required by well-site geologist.

8. C. The following open-hole logs will be run:
  1. IES - base surface casing to TD.
  2. GammaRay w/combination Neutron Density from 5985-3985'.
  3. Sonic - 5985-3985'.

D. Well will be stimulated (acidized or fraced) as dictated by formation characteristics. Diagrams will be submitted if a frac job is necessary.
9. No abnormal pressures or hydrogen sulfide gas are anticipated during the course of drilling to 6000' TD. The maximum bottom hole pressure will be 2400 psi at 6000'.
10. The captioned location is located within the STP Federal #1, Lease # NM 33016. Patrick Petroleum Corporation of Michigan plans to spud the STP Federal #1-17 after May 1, 1979, and intends to complete the well within 40 days after the spud date.

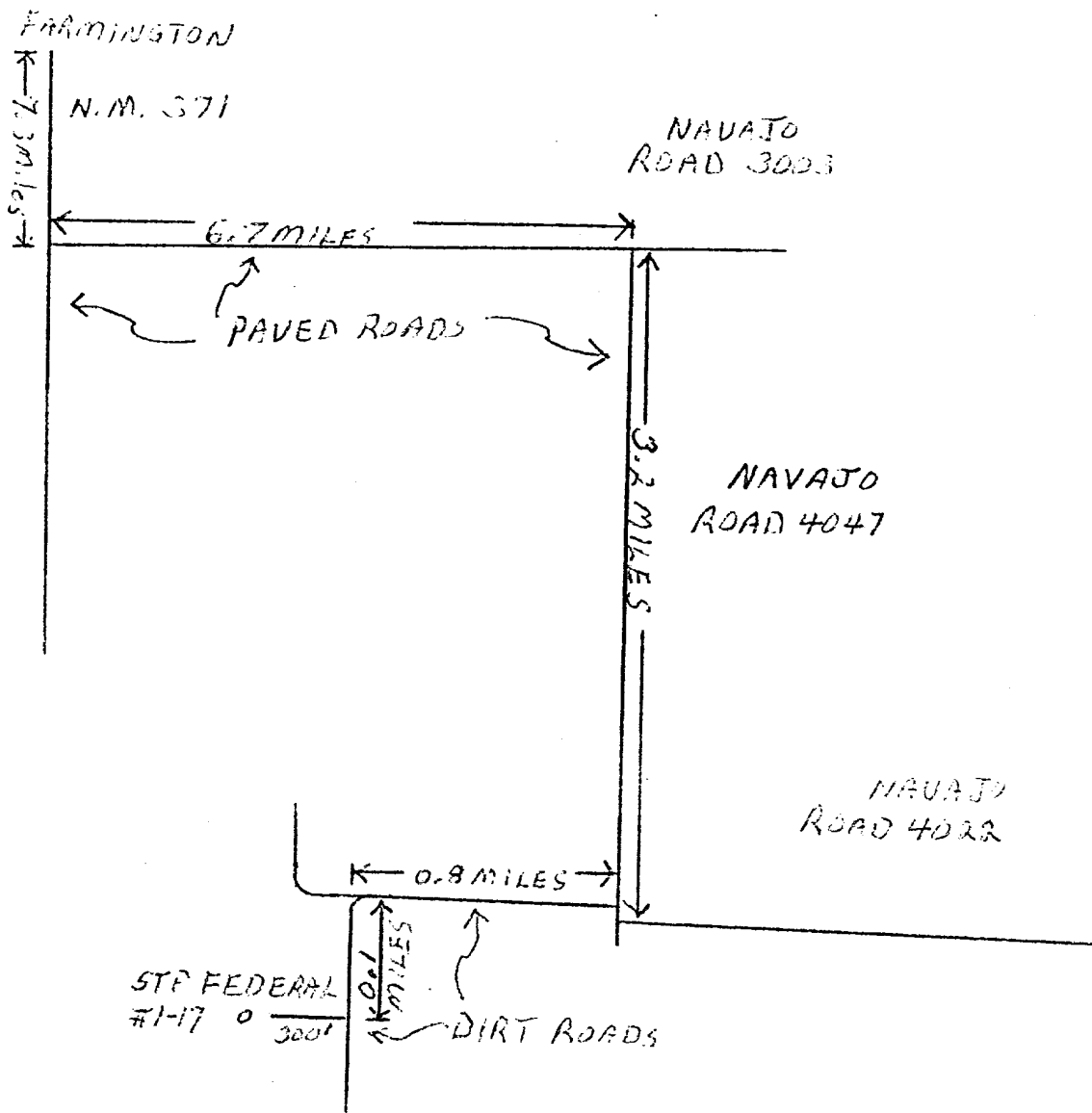

DETAILED ROAD MAP  
 PATRICK PETROLEUM CORPORATION  
 OF MICHIGAN  
 STP FEDERAL #1-17  
 Not to Scale

HUGH LAKE QUADRANGLE  
NEW MEXICO—SAN JUAN CO.  
7.5 MINUTE SERIES (TOPOGRAPHIC)

4357 II, NE  
(HORN CANYON)

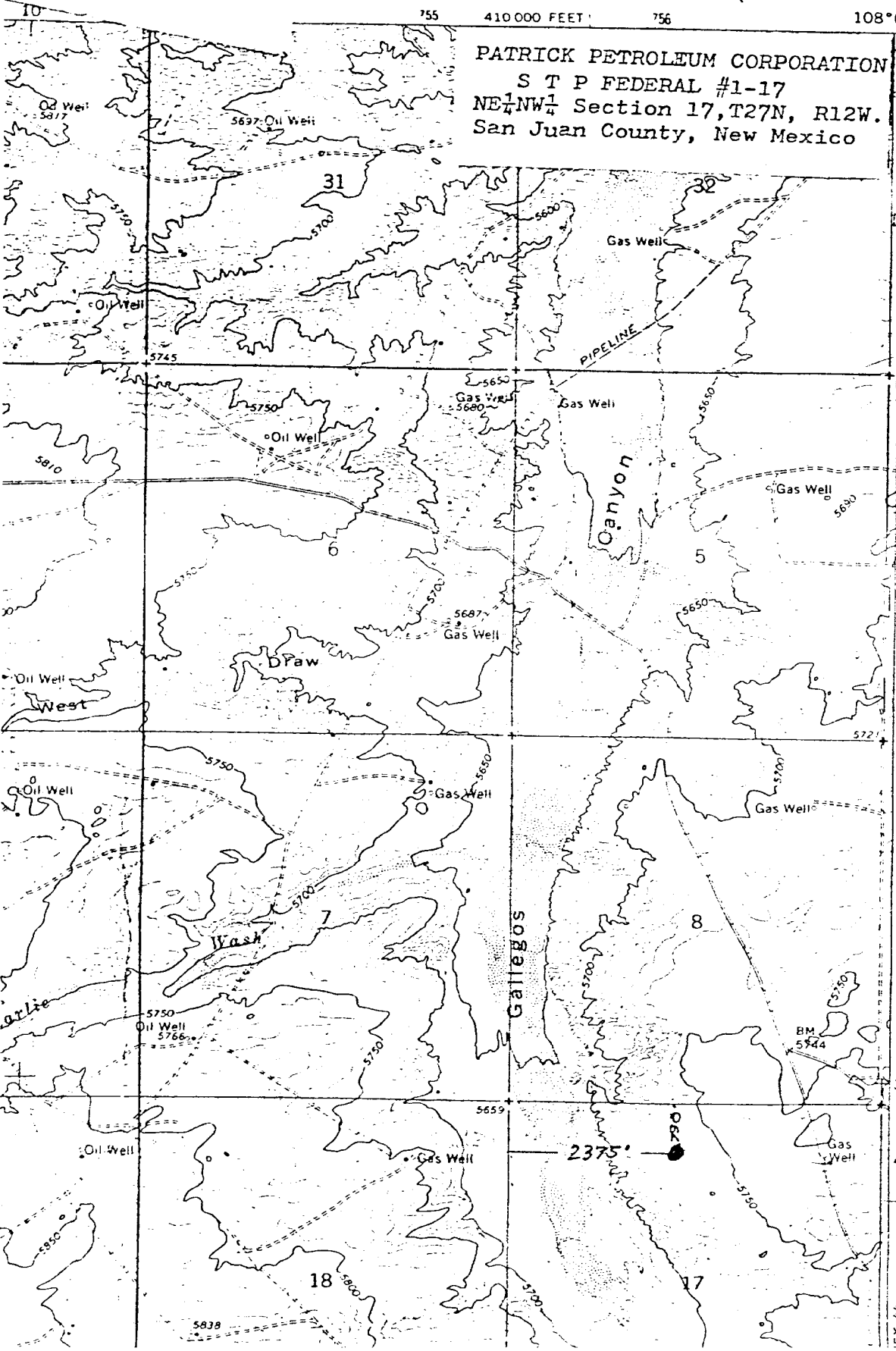

PATRICK PETROLEUM CORPORATION  
S T P FEDERAL #1-17  
NE $\frac{1}{4}$ NW $\frac{1}{4}$  Section 17, T27N, R12W.  
San Juan County, New Mexico

JAN 24 1979

Clair-Weedwood, Inc.

T. 28 N.

T. 27 N.

4055  
2 040 000  
FEET

4054

4053

35'

4052

EX. 44

Island Township Plat

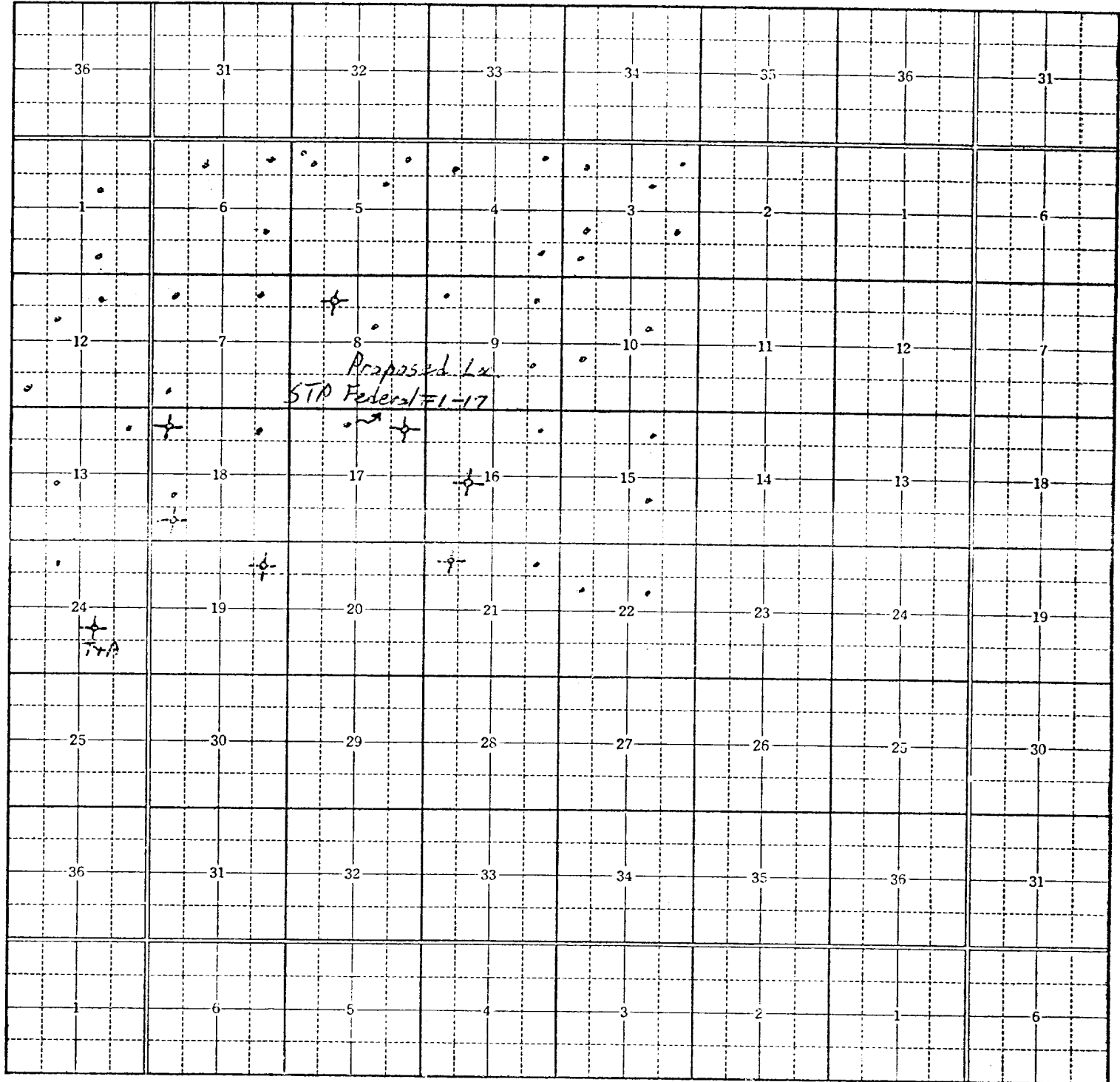

• Producing Well  
 ⊕ D+A

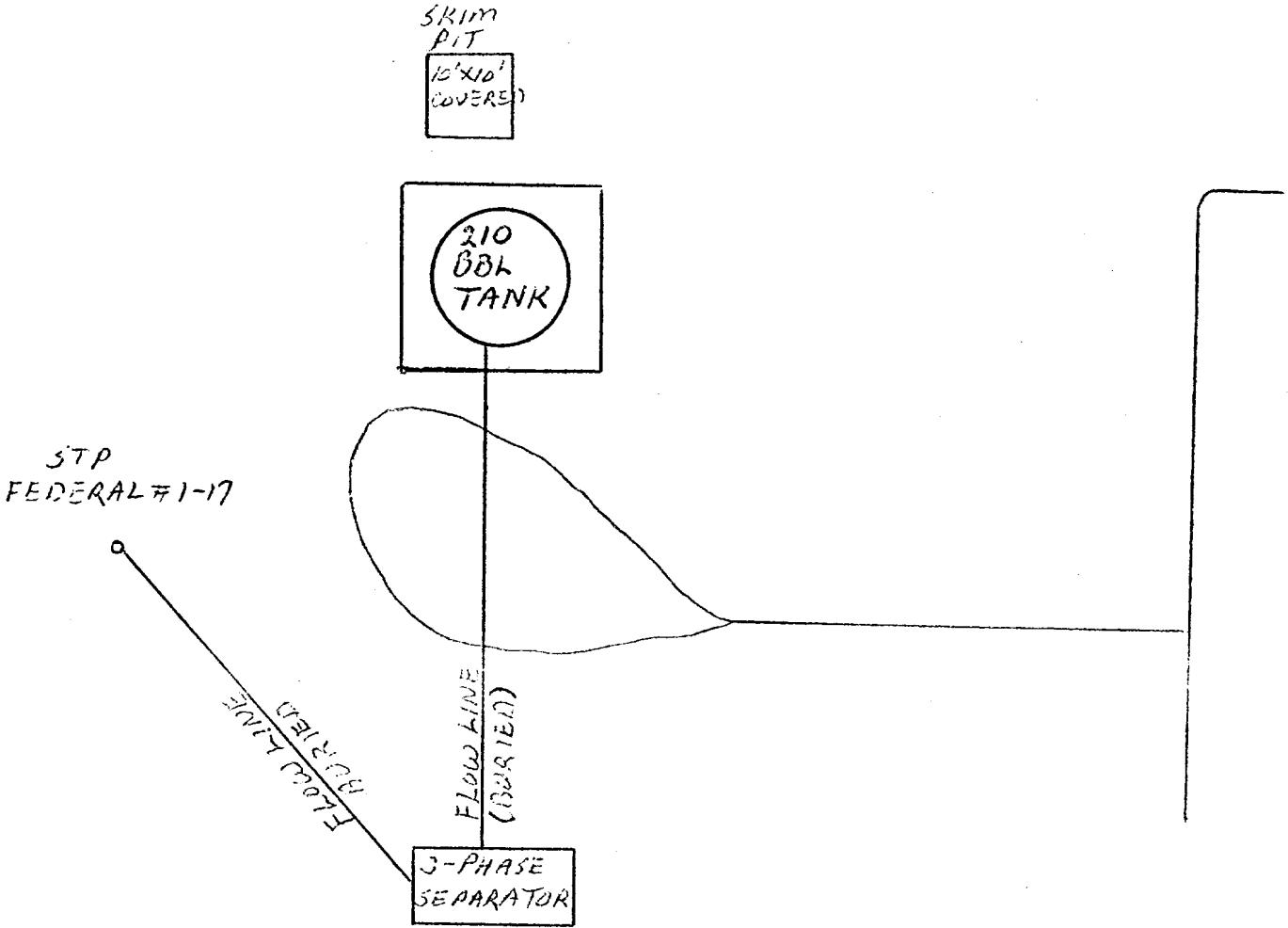

12

TANK BATTERY LAYOUT  
 PATRICK PETROLEUM CORPORATION  
 OF MICHIGAN  
 STP FEDERAL #1-17  
 NE NW Sec. 17 T27N, R12W  
 SAN JUAN COUNTY, NEW MEXICO  
 Not to Scale

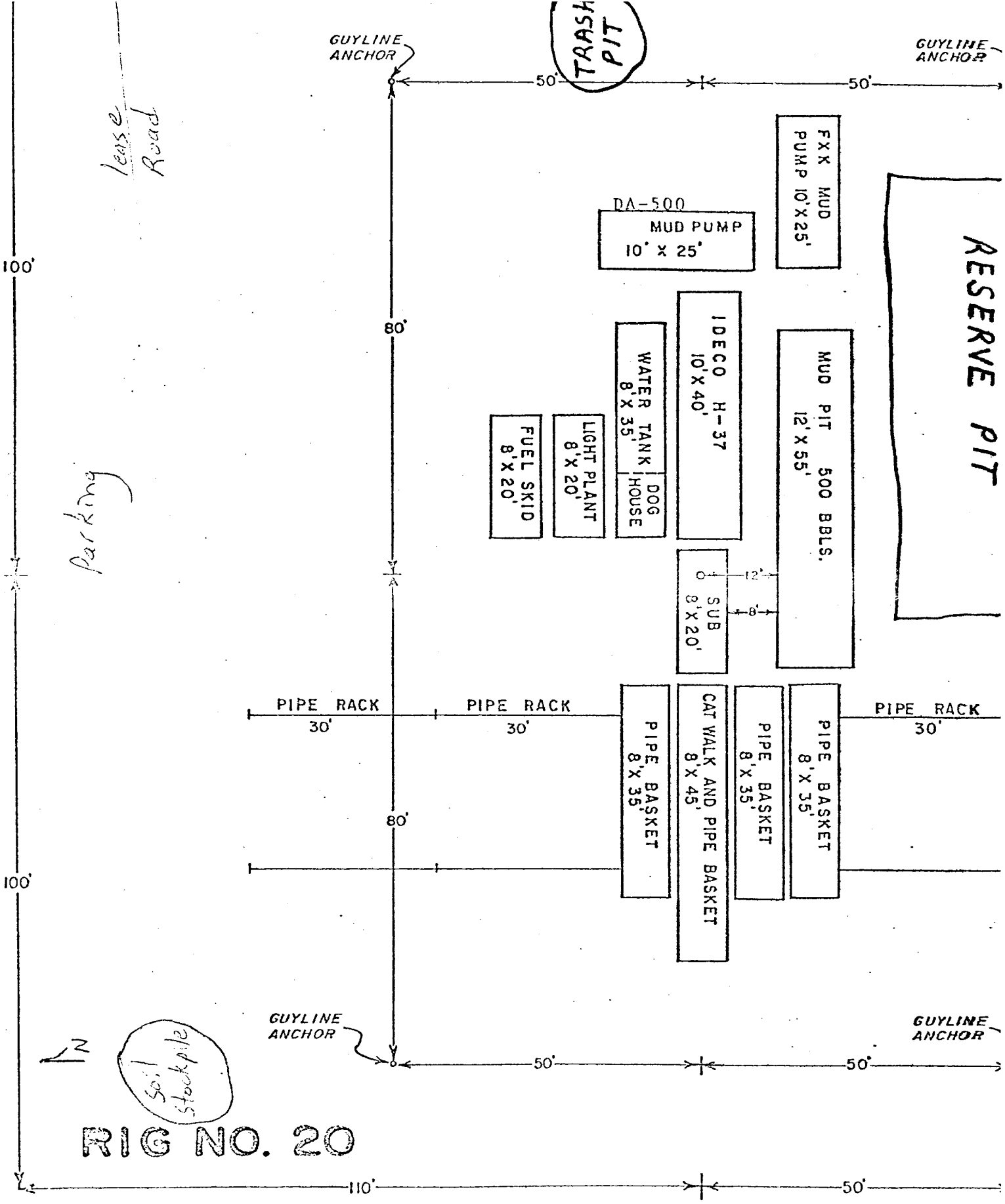

RIG NO. 20

SCALE: 1" = 20'

PLAT # 2



BLOW OUT PREVENTER EQUIPMEN

DIAGRAM A

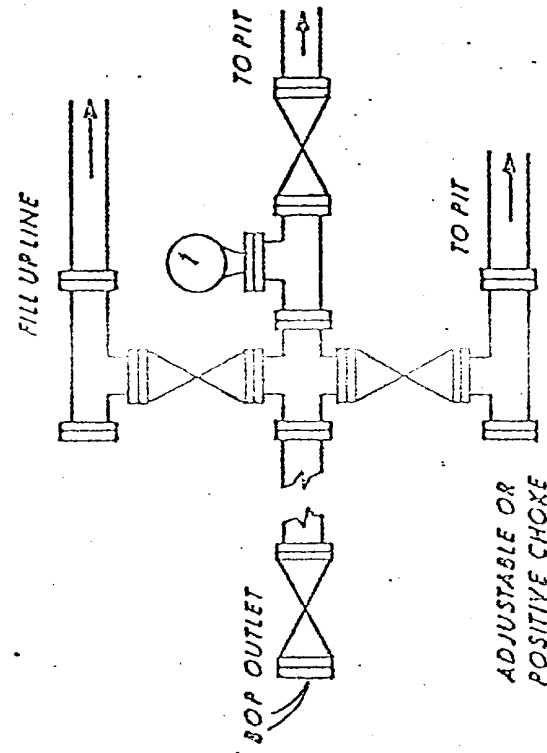
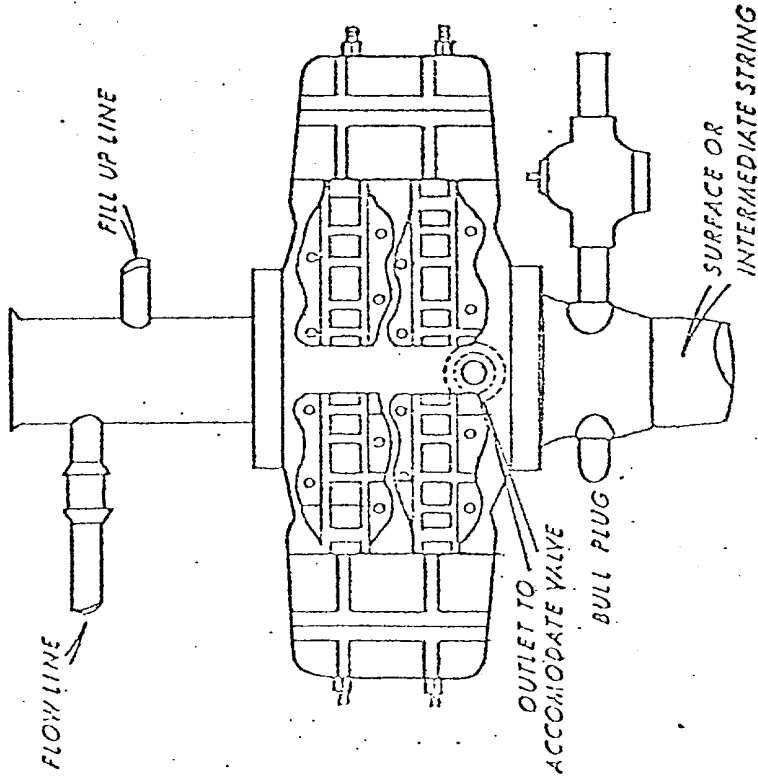

1. BOP VALVES AND ALL WORKING FITTINGS SHOULD BE IN GOOD WORKING CONDITION.
2. ALL BOLTS TO BE INSTALLED AND TIGHT.
3. ALL VALVES TO BE 3000# W.P. OR BETTER.
4. AFTER NIPPLING UP TEST RAMS AND PRESSURE UP TO 1000# FOR 15 MINUTES AND CHECK FOR POSSIBLE LEAKS.
5. ALL CREW MEMBERS TO BE FAMILIAR WITH BOP AND ACCUMULATORS.
6. KEEP HOLE FULL ON TRIPS.
7. USE ONLY FLANGE TYPE FITTINGS
8. RECHECK BOLTS FOR TIGHTNESS BEFORE 5000 FT. OR ENTERING PRODUCTION ZONES.
9. WHEN DRILLING USE,  
 TOP PREVENTER - DRILL PIPE RAMS  
 BOTTOM PREVENTER BLIND RAMS
10. WHEN RUNNING CASING USE,  
 TOP PREVENTER - CASING RAMS  
 BOTTOM PREVENTER BLIND RAMS

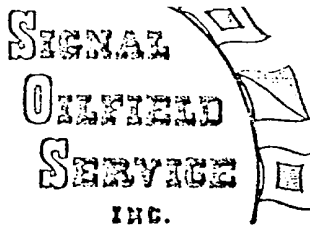

*used*

# RIG NO. 20

## DRILLING RIG SPECIFICATIONS AND EQUIPMENT (See Reverse Side for Drawing of Rig Layout)

RIG	Ideco BIR-550 H-37 Back-In Rambler with 12V-71 Engine and 103' - 224,000# capacity mast
SUBSTRUCTURE	11' high - 224,000# capacity
ROTARY TABLE	17 1/2" Ideco
PUMP #1	Emsco DA-500 7 1/2" x 16" 500 h.p. powered by 1 16V-71 GMC Diesel Engine
PUMP #2	Gardner-Denver FXK 7 1/4" x 14" 255 h.p. powered by 2 - 671 GMC Diesel Engines
MUD PIT	1 - 12' wide, 5' high, 50' long, 500 bbl. with Desilter and Shale Shaker
BLOWOUT PREVENTER	10" Double Gate Type E, Shaffer
LIGHT PLANT	1 - 75 kw and 1 - 50 kw in light plant house
WATER TANK	400 bbls.
FUEL TANK	2,500 gal.
DRILL PIPE	4 1/2" XH - 7,000 ft.
DRILL COLLARS	20 - 6" x 30'

June 1976

Prospect Name: Simpson Trading Post  
Well Name & No.: #1-17 S.T.P. Federal  
Location: Sec. 17, T27N-R12W 900' FNL & 2200' FWL  
County & State: San Juan Co., New Mexico

Elevation: 5730 Est. Topog.  
Projected TD: 6100'  
Prime Objective: Dakota  
Secondary Objective: Pic. Cliffs, Gallup

Est. Formation Tops:	Drlr.	Rel. S.L.
Fruitland	1030	+ 4700
Pictured Cliffs	1280	+ 4450
Mesaverde	2090	+ 3640
Gallup	4840	+ 890
Greenhorn	5690	+ 40
Graneros zone	5750	- 20
Dakota	5850	- 120
Burro Canyon	5985	- 255

Sample Program:  
Every 30' samples from surf. to 5700'  
Every 10' samples from 5700' to TD  
Mud Logger:  
From base of surface casing to TD - 1 man unit  
Logging Program:  
IES  
CNL - Dens. w/GR & Caliper  
BHC-Sonic

CORES:	<u>Fm.</u>	<u>Depth</u>	DST:	<u>Fm.</u>	<u>Depth</u>
	<u>90' Graneros-Dakota</u>	<u>≈ 5800' - 5890'</u>	<u>(2)</u>	<u>Graneros -</u>	<u>As required</u>
				<u>Dakota zones</u>	

Sidewall cores as required by wellsite geologist.

DRILLING PROGRAM

Hole Size	Interval	Size	Interval	Weight	Grade

CASING PROGRAM

MUD PROGRAM

Interval	Type	Weight	Viscosity	WL	% Oil	LCM	Other

PATRICK PETROLEUM PERSONNEL: ENGINEERING: \_\_\_\_\_  
B. C. Morrison 573-1207 Off.; 770-8064 Res.  
J. G. Hill 573-1207 Off.; 237-3810 Res. WELL SITE GEOLOGY: \_\_\_\_\_  
J. M. Wells 573-1207 Off.; 674-7791 Res. From top Greenhorn

ADDITIONAL INFORMATION: Provisions should be made to make fluid effect and susceptibility tests rapidly on the cores. Drill Graneros - Dakota with minimum water-loss mud.



**LeCLAIR - WESTWOOD, INC.**

388 DENVER CLUB BUILDING  
DENVER, COLORADO 80202  
(303) 825-4258

November 27, 1978

Bureau of Indian Affairs  
U. S. Department of Interior  
Navajo Area Office  
Window Rock, Arizona 86515

Attention: Mr. Thomas Lynch

RE: Federal No. NM-33016  
Patrick Petroleum Corporation of Michigan  
LeClair-Westwood, Inc., Agent  
BTP Federal 51-17  
33 NE 1/4 Section 17, T27N, R12W  
San Juan County, New Mexico

Gentlemen:

In compliance with rule A, Preliminary Environmental Review of Part II (Drilling Operations) of your Approval of Operations procedure, please find enclosed a topographic map of the subject area with the proposed location stipulated.

We ask your early consideration and approval of this site.

Yours very truly,

LeCLAIR-WESTWOOD, INC.

K. R. Gordon  
Production Engineer

RRS:blw

CC: U. S. Geological Survey  
Patrick Petroleum Corporation of Michigan (2)

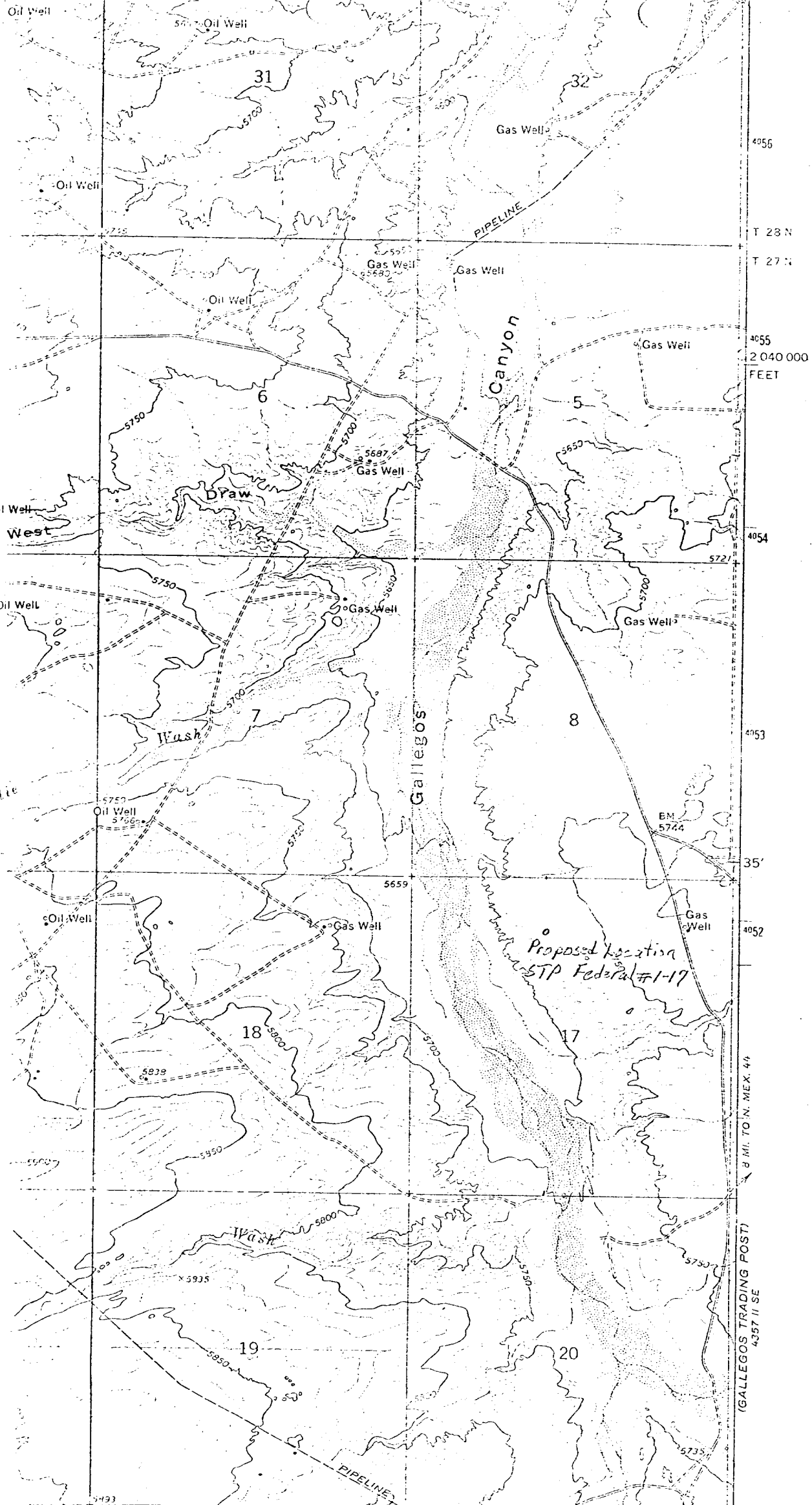

4056  
T 28 N  
T 27 N  
4055  
2 040 000  
FEET  
4054  
4053  
35'  
4052  
8 MI. TO N. MEX. 44  
(GALLEGOS TRADING POST)  
4357 11 SE



# United States Department of the Interior

BUREAU OF INDIAN AFFAIRS

Navajo Area Office

Window Rock, Arizona 86515

IN REPLY REFER TO:

ARPM/322

LeClair - Westwood, Inc.  
388 Denver Club Bldg.  
Denver, Colorado 80202

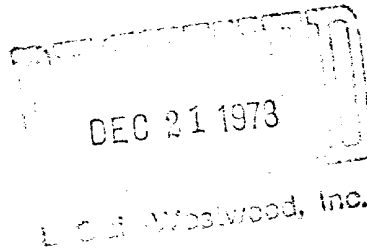

DEC 14 1978

Gentlemen:

Your letter dated November 27, 1978 requesting approval of drilling operations under Federal Lease No. NM-33016 is being forwarded to the Project Engineer, Navajo Indian Irrigation Project, for his appropriate action as he has authority over these lands.

We are asking the Project Engineer, Navajo Indian Irrigation Project, by copy hereof to respond to your request direct.

Sincerely yours,

ACTING ASSISTANT *Ben L. Ferguson*  
Area Director



**LeCLAIR - WESTWOOD, INC.**

388 DENVER CLUB BUILDING

DENVER, COLORADO 80202

(303) 825-4258

March 28, 1979

Navajo Agricultural Products Industry  
PO Box 86  
Farmington, NM 87401  
Attn: Art Allison

Re: Purchase of Drilling Water  
Patrick Petroleum Corporation of Michigan  
STP State #1-16  
STP Federal #1-17  
Secs. 16 & 17, T27N, R12W  
San Juan County, New Mexico

Dear Mr. Allison:

As per our telephone conversation of March 23, 1979, please be advised that Patrick Petroleum Corporation of Michigan would like to purchase water for the drilling of two gas wells.

Attached please find a map showing the locations of the subject wells, and the approximate location of the roads in the area. We would like to obtain the water from the irrigation canal which is approximately two miles east of the locations. We plan to commence drilling operations around May 15, 1979.

As soon as you know the answer, would you please inform us so we can look for another source of water if we cannot purchase this water.

We appreciate your prompt reply, and if you should have any questions, please do not hesitate to call.

Yours very truly,

LeCLAIR-WESTWOOD, INC.

Kenneth R. Gordon,  
Production Engineer

KRG:vmc

Island Township Plat

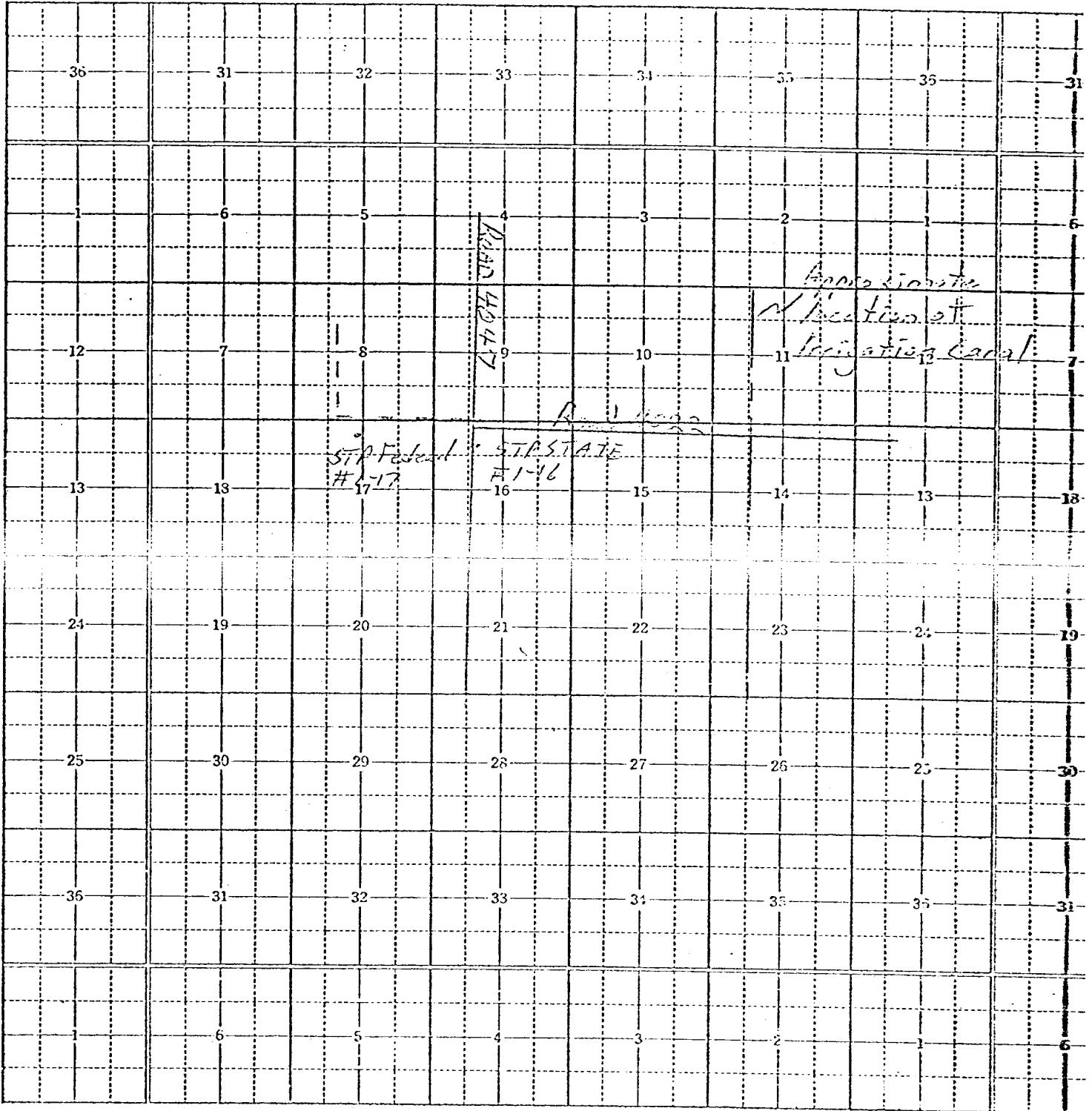





**LeCLAIR - WESTWOOD, INC.**

388 DENVER CLUB BUILDING  
DENVER, COLORADO 80202  
(303) 825-4258

March 29, 1979

Larry Linford  
PO Box 689  
Window Rock, AZ 86515

Re: Archeological Survey  
Patrick Petroleum Corp. of Michigan  
STP Federal #1-17  
NE NW Sec. 17, T27N, R12W  
San Juan County, New Mexico

Dear Mr. Linford:

As per our telephone conversation on March 20, 1979, this letter is to request that an archeological survey for the subject location be done.

Attached please find maps showing the location and access to the location.

We would appreciate if this survey could be completed as soon as possible. Should you have any questions, please advise.

Yours very truly,

LeCLAIR-WESTWOOD, INC.

K. R. Gordon,  
Production Engineer

KRG:vnc

Attachments

HUGH LAKE QUADRANGLE  
NEW MEXICO - SAN JUAN CO.  
7.5 MINUTE SERIES (TOPOGRAPHIC)

337 II NE  
(HORN CANYON)

TO 755 410 000 FEET 756 108° 07' 30" 36° 37' 30"

PATRICK PETROLEUM CORPORATION  
S T P FEDERAL #1-17  
NE $\frac{1}{4}$ NW $\frac{1}{4}$  Section 17, T27N, R12W.  
San Juan County, New Mexico

JAN 24 1979

Clair-Wellness, Inc

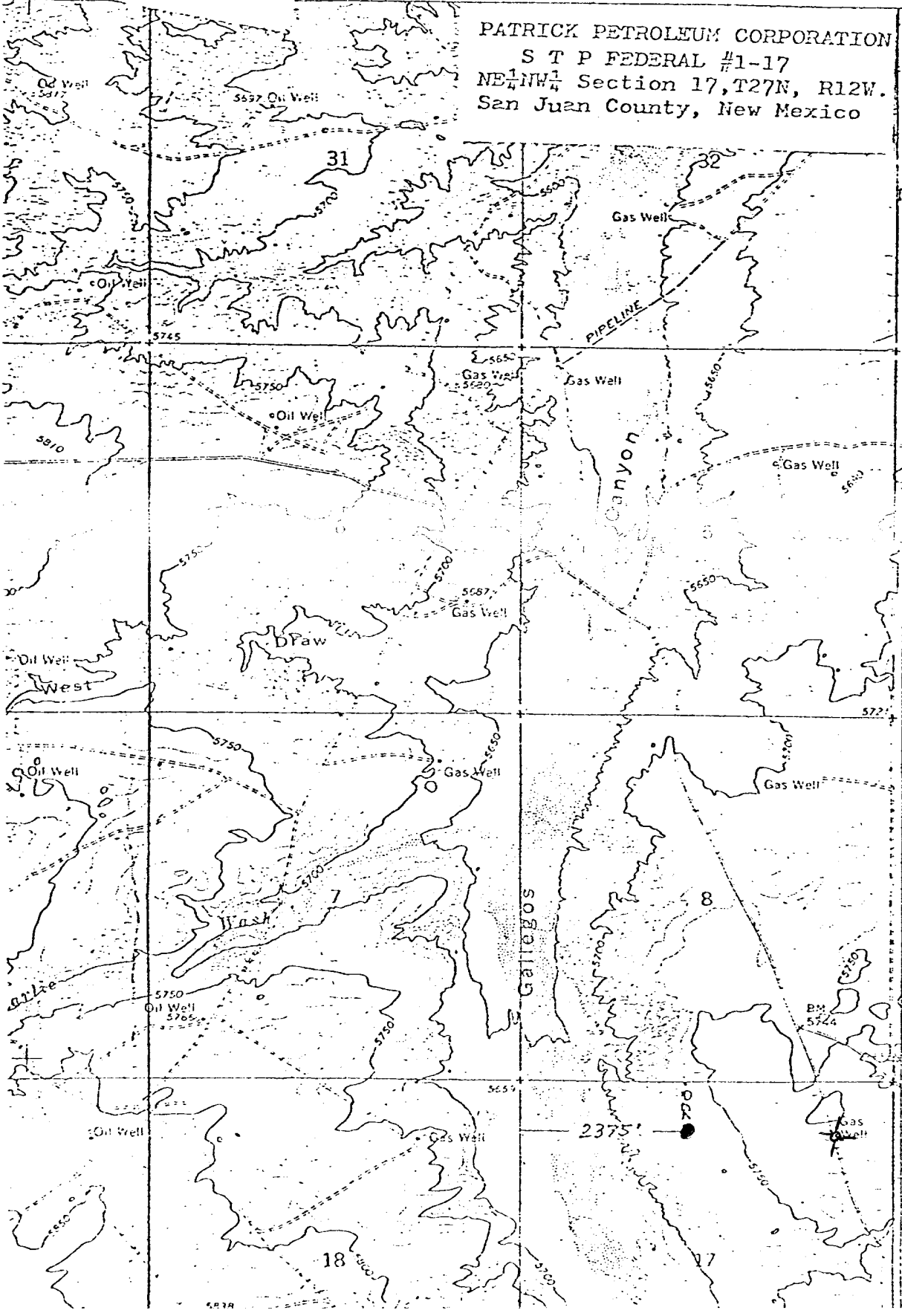

T. 28 N.

T. 27 N.

4055  
2 040 000  
FEET

4054

4053

35'

4052

C. 44

All distances must be from the outer boundaries of the Section.

Operator <b>PATRICK PETROLEUM CORPORATION</b> of <b>MICHIGAN</b>		Lease <b>S T P FEDERAL</b>		Well No. <b>1-17</b>
Unit Letter <b>C</b>	Section <b>27</b>	Township <b>27 NORTH</b>	Range <b>12 WEST</b>	County <b>SAN JUAN</b>
Actual Footage Location of Well: <b>790</b> feet from the <b>NORTH</b> line and <b>2375</b> feet from the <b>WEST</b> line				
Ground Level Elev. <b>5739</b>	Producing Formation	Pool	Dedicated Acreage: <b>A</b>	

1. Outline the acreage dedicated to the subject well by colored pencil or hachure marks on the plat below.
2. If more than one lease is dedicated to the well, outline each and identify the ownership thereof (both as to work interest and royalty).
3. If more than one lease of different ownership is dedicated to the well, have the interests of all owners been consolidated by communitization, unitization, force-pooling, etc?

Yes  No If answer is "yes," type of consolidation \_\_\_\_\_

If answer is "no," list the owners and tract descriptions which have actually been consolidated. (Use reverse side this form if necessary.) \_\_\_\_\_

No allowable will be assigned to the well until all interests have been consolidated (by communitization, unitization, force-pooling, or otherwise) or until a non-standard unit, eliminating such interests, has been approved by the Commission.

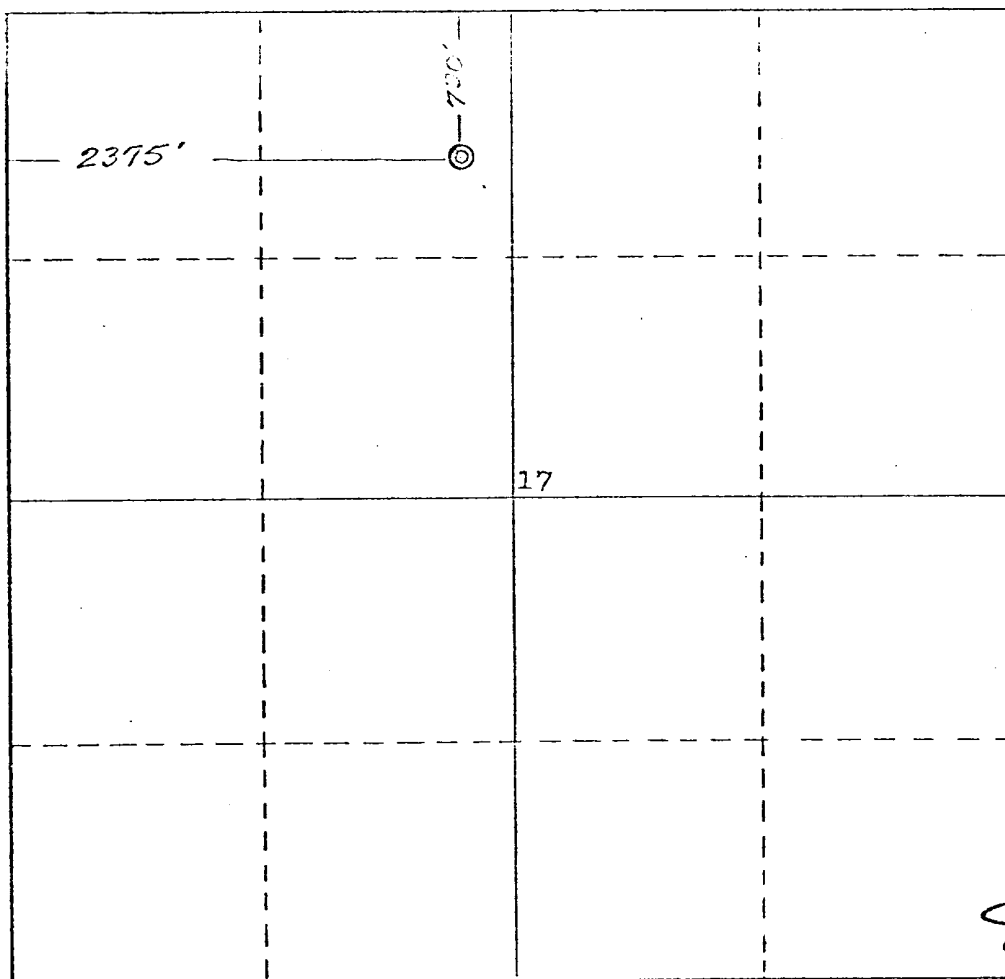

CERTIFICATION

I hereby certify that the information contained herein is true and complete to the best of my knowledge and belief.

Name \_\_\_\_\_  
 Position \_\_\_\_\_  
 Company \_\_\_\_\_  
 Date \_\_\_\_\_

I hereby certify that the information shown on this plat was plotted from notes of actual surveys made by me under my supervision, and that the same is true and correct to the best of my knowledge and belief.

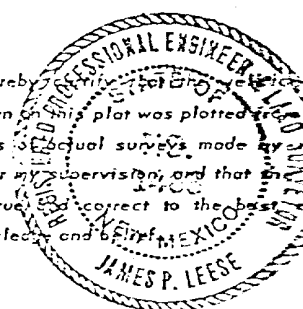

Date Surveyed **21 January 1979**  
 Registered Professional Engineer  
 Land Survey  
*James P. Leese*  
 James P. Leese

Certificate No. **1463**

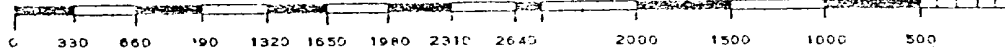

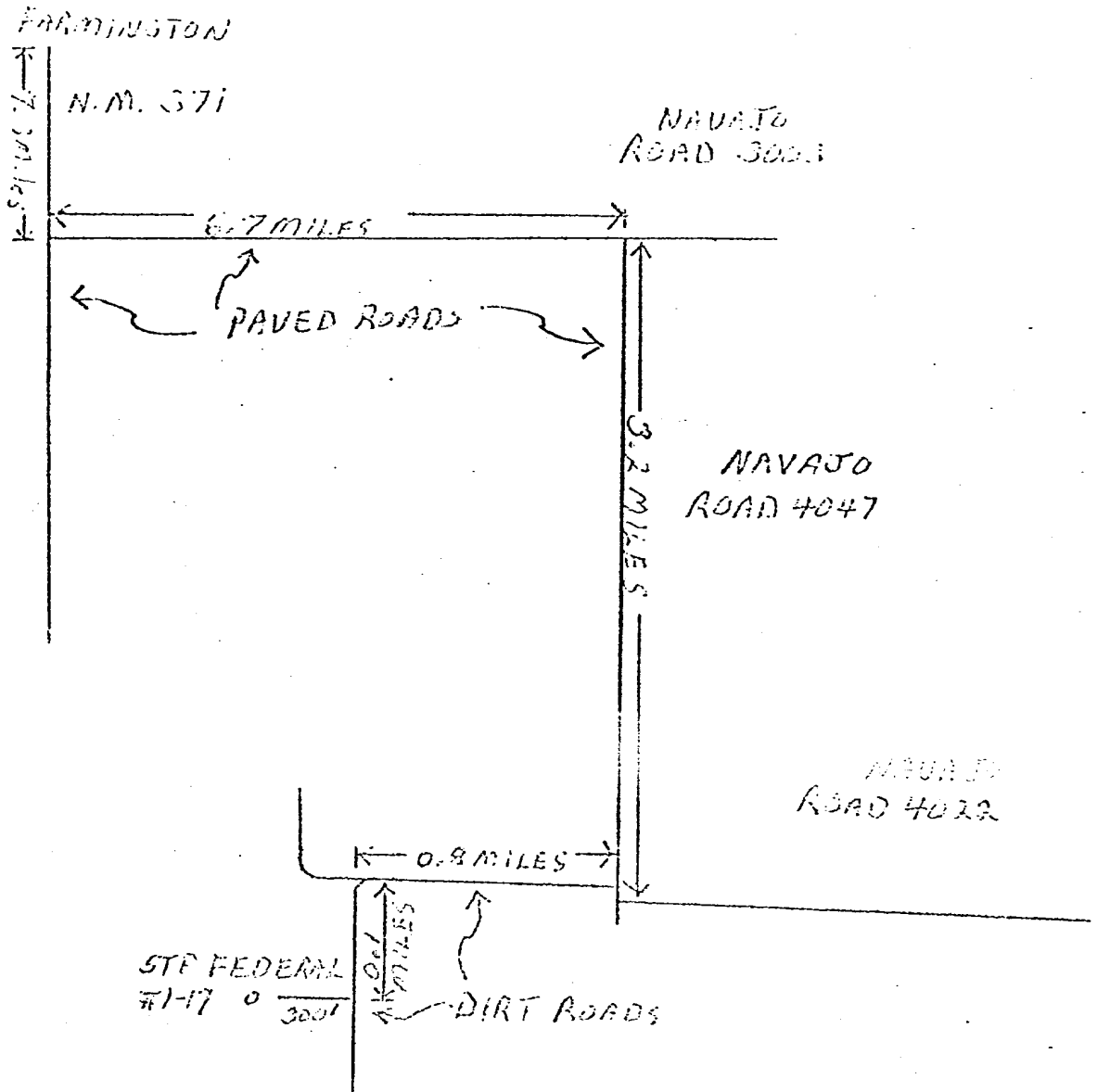

NE NW Sec 17, T 27N, R 12W  
 San Juan County, New Mexico  
 (NOT TO SCALE)