

UNITED STATES
DEPARTMENT OF THE INTERIOR
GEOLOGICAL SURVEY

30-045-24936

APPLICATION FOR PERMIT TO DRILL, DEEPEN, OR PLUG BACK

1a. TYPE OF WORK DRILL <input checked="" type="checkbox"/> DEEPEN <input type="checkbox"/> PLUG BACK <input type="checkbox"/>		5. LEASE DESIGNATION AND SERIAL NO. NM 03549
b. TYPE OF WELL OIL WELL <input type="checkbox"/> GAS WELL <input checked="" type="checkbox"/> OTHER <input type="checkbox"/>		6. IF INDIAN, ALLOTTEE OR TRIBE NAME
3. NAME OF OPERATOR Tenneco Oil Company		7. UNIT AGREEMENT NAME
8. ADDRESS OF OPERATOR P.O. Box 3249, Englewood, Colorado 80155		8. FARM OR LEASE NAME Gooch
4. LOCATION OF WELL (Report location clearly and in accordance with any State requirements.) At surface 1100 FNL, 1800 FWL At proposed prod. zone same as above		9. WELL NO. 2E
14. DISTANCE IN MILES AND DIRECTION FROM NEAREST TOWN OR POST OFFICE Approximately 9 miles SE of Blanco, N.M.		10. FIELD AND POOL, OR WILDCAT Basin Dakota
10. DISTANCE FROM PROPOSED LOCATION TO NEAREST PROPERTY OR LEASE LINE, FT. (Also to nearest drlg. unit line, if any) 1100'		11. SEC., T., R., M., OR B.E. AND SURVEY OR AREA Sec. 29, T28N, R8W
16. NO. OF ACRES IN LEASE 1876.58		12. COUNTY OR PARISH San Juan
17. NO. OF ACRES ASSIGNED TO THIS WELL 320		13. STATE N.M.
18. DISTANCE FROM PROPOSED LOCATION TO NEAREST WELL, DRILLING COMPLETED, OR APPLIED FOR, ON THIS LEASE, FT.		20. ROTARY OR CABLE TOOLS Rotary
21. ELEVATIONS (Show whether DF, RT, GR, etc.) 5870' GR		22. APPROX. DATE WORK WILL START July 1981

23. PROPOSED CASING AND CEMENTING PROGRAM

SIZE OF HOLE	SIZE OF CASING	WEIGHT PER FOOT	SETTING DEPTH	QUANTITY OF CEMENT
12 1/4"	9 5/8" new	36#	±250'	Circulate to surface
8 3/4"	7" new	23#	±2750'	Circulate to surface
6 1/4"	4 1/2" new	11.6#, 10.5#	±6730'	Circulate to liner top

See attached.

This action is subject to a final administrative appeal pursuant to 30 USC 230.

The gas is dedicated.

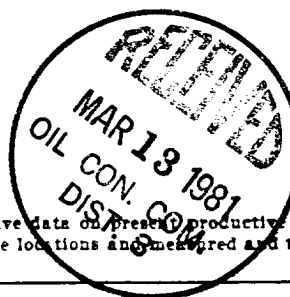

IN ABOVE SPACE DESCRIBE PROPOSED PROGRAM: If proposal is to deepen or plug back, give data on present productive zone and proposed new productive zone. If proposal is to drill or deepen directionally, give pertinent data on subsurface locations and measured and true vertical depths. Give blowout preventer program, if any.

SIGNED [Signature] TITLE Sr. Production Analyst DATE February 4, 1981

(This space for Federal or State office use)

PERMIT NO. _____ APPROVAL DATE _____

APPROVED BY _____ TITLE _____

CONDITIONS OF APPROVAL, IF ANY:

*See Instructions On Reverse Side

NMOCC

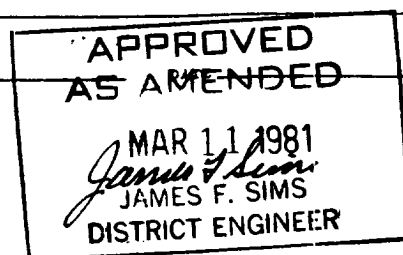

OIL CONSERVATION DIVISION

P. O. BOX 2088

Form C-107
Revised 10-1-78

STATE OF NEW MEXICO

ENERGY AND MINERALS DEPARTMENT

SANTA FE, NEW MEXICO 87501

All distances must be from the outer boundaries of the Section.

Operator TENNECO OIL COMPANY			Lease GOOCH		Well No. 21
Unit Letter C	Section 29	Township 28N	Range 8W	County San Juan	
Actual Footage Location of Well: 1100 feet from the North line and 1800 feet from the West line					
Ground Level Elev. 5670	Producing Formation Dakota		Pool Basin Dakota	Dedicated Acreage: 320 Acres	

1. Outline the acreage dedicated to the subject well by colored pencil or hachure marks on the plat below.
2. If more than one lease is dedicated to the well, outline each and identify the ownership thereof (both as to working interest and royalty).
3. If more than one lease of different ownership is dedicated to the well, have the interests of all owners been consolidated by communitization, unitization, force-pooling, etc?

☐ Yes ☐ No If answer is "yes," type of consolidation _____

If answer is "no," list the owners and tract descriptions which have actually been consolidated. (Use reverse side of this form if necessary.) _____

No allowable will be assigned to the well until all interests have been consolidated (by communitization, unitization, forced-pooling, or otherwise) or until a non-standard unit, eliminating such interests, has been approved by the Commission.

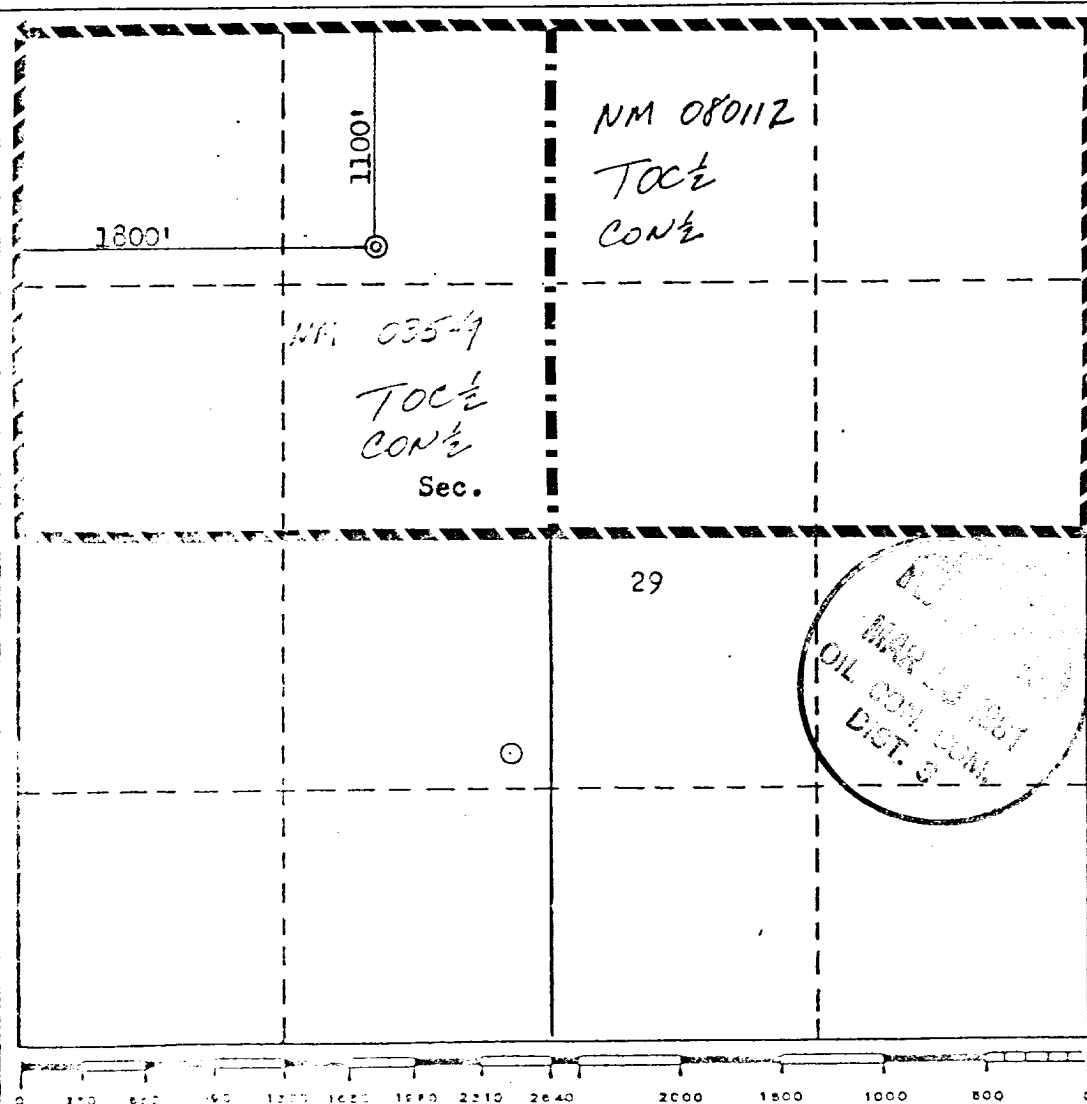

CERTIFICATION

I hereby certify that the information contained herein is true and complete to the best of my knowledge and belief.

R. A. Mishler

Name

R. A. Mishler

Position

Sr. Production Analyst

Company

Tenneco Oil Company

Date

February 4, 1981

I hereby certify that the well location shown on this plat was plotted from field notes of actual surveys made by me or under my supervision, and that the same is true and correct to the best of my knowledge and belief.

Date Surveyed

August 18, 1980

Registered Professional Engineer
and/or Land Surveyor*Fred B. Kerr Jr.*
Fred B. Kerr Jr.

Certificate No. 3950

FRED B. KERR, JR.

1115 AC
1.5

