

UNITED STATES
DEPARTMENT OF THE INTERIOR
BUREAU OF LAND MANAGEMENT

APPLICATION FOR PERMIT TO DRILL, DEEPEN, OR PLUG BACK

1a. TYPE OF WORK DRILL <input checked="" type="checkbox"/> DEEPEN <input type="checkbox"/> PLUG BACK <input type="checkbox"/>				RECEIVED 88 DEC 13 PM 12:57 FARMINGTON RESOURCE AREA FARMINGTON, NEW MEXICO	
b. TYPE OF WELL OIL WELL <input type="checkbox"/> GAS WELL <input checked="" type="checkbox"/> OTHER <input type="checkbox"/>					
2. NAME OF OPERATOR Meridian Oil Inc. 14538				5. LEASE DESIGNATION AND SERIAL NO. NM-011393	
3. ADDRESS OF OPERATOR PO Box 4289, Farmington, NM 87499				6. IF INDIAN, ALLOTTEE OR TRIBE NAME	
4. LOCATION OF WELL (Report location clearly and in accordance with any State requirements.) At surface 850'N, 1470'E At proposed prod. zone				7. UNIT AGREEMENT NAME	
14. DISTANCE IN MILES AND DIRECTION FROM NEAREST TOWN OR POST OFFICE* 18 miles from Blanco, NM				8. FARM OR LEASE NAME Cleveland 6916	
15. DISTANCE FROM PROPOSED* LOCATION TO NEAREST PROPERTY OR LEASE LINE, FT. (Also to nearest drig. unit line, if any.) 850'		16. NO. OF ACRES IN LEASE 12.80		9. WELL NO. 220	
18. DISTANCE FROM PROPOSED LOCATION* TO NEAREST WELL DRILLING COMPLETED OR APPLIED FOR, ON THIS LEASE, FT. 200'		19. PROPOSED DEPTH 2125'		10. FIELD AND POOL, OR WILDCAT Basin Fruitland Coal 71629	
21. ELEVATIONS (Show whether DF, RT, GR, etc.) 647 5845' GL		20. ROTARY OR CABLE TOOLS Rotary		11. SEC., T., R., M., OR SLE. AND SURVEY OR AREA Sec. 21, T-27-N, R-09-W NMPM	
23. DRILLING OPERATIONS AUTHORIZED ARE SUBJECT TO COMPLIANCE WITH ATTACHED "GENERAL REQUIREMENTS"		22. APPROX. DATE WORK WILL START*		12. COUNTY OR PARISH San Juan	
17. NO. OF ACRES ASSIGNED TO THIS WELL 320.00		13. STATE NM		17. NO. OF ACRES ASSIGNED TO THIS WELL 320.00	
SIZE OF HOLE 12 1/4"		SIZE OF CASING 9 5/8"		WEIGHT PER FOOT 32.3#	
8 3/4"		7"		20.0#	
SETTING DEPTH 200'		2125'		QUANTITY OF CEMENT 125 cf. circulated	
				287 cf. circ. surface	

The Fruitland coal formation will be completed.

A 3000 psi WP and 6000 psi test double gate preventer equipped with blind and pipe rams will be used for blow out prevention on this well.

This gas is dedicated.

The E/2 of Section 21 is dedicated to this well.

RECEIVED
FEB 14 1989
OIL CON. DIV.
DIST. 3

IN ABOVE DESCRIBE PROPOSED PROGRAM: If proposal is to deepen or plug back, give data on present productive zone and proposed new productive zone. If proposal is to drill or deepen directionally, give pertinent data on subsurface locations and measured and true vertical depths. Give blowout preventer program, if any.

24. SIGNED [Signature] TITLE Regulatory Affairs DATE 12-12-88

(This space for Federal or State office use)

PERMIT NO. _____ APPROVAL DATE _____

APPROVED BY _____ TITLE _____
CONDITIONS OF APPROVAL, IF ANY: _____

NMOCC

*See Instructions On Reverse Side

Title 18 U.S.C. Section 1001, makes it a crime for any person knowingly and willfully to make to any department or agency of the United States any false, fictitious or fraudulent statements or representations as to any matter within its jurisdiction.

All distances must be from the outer boundaries of the Section.

Operator Meridian Oil Inc.		Lease Cleveland (NM-011393)		Well No. 220
Unit Letter B	Section 21	Township 27 North	Range 9 West	County San Juan
Actual Footage Location of Wells 850 feet from the North line and 1470 feet from the East line				
Ground Level Elev. 6217'	Producing Formation Fruitland Coal	Pool Undesignated	Dedicated Acreage: 320.00 Acres	

1. Outline the acreage dedicated to the subject well by colored pencil or hachure marks on the plat below.
2. If more than one lease is dedicated to the well, outline each and identify the ownership thereof (both as to working interest and royalty).
3. If more than one lease of different ownership is dedicated to the well, have the interests of all owners been consolidated by communitization, unitization, force-pooling, etc?

☐ Yes ☐ No If answer is "yes," type of consolidation _____

If answer is "no," list the owners and tract descriptions which have actually been consolidated. (Use reverse side this form if necessary.) _____

No allowable will be assigned to the well until all interests have been consolidated (by communitization, unitization, force-pooling, or otherwise) or until a non-standard unit, eliminating such interests, has been approved by the Division.

CERTIFICATION

I hereby certify that the information contained herein is true and complete to the best of my knowledge and belief.

Scott D. Duffield

Name
Regulatory Affairs

Position
Meridian Oil Inc.

Company
12-13-88

Date

I hereby certify that the well location shown on this plat was plotted from the notes of actual surveys made by me under my supervision, and that the same is true and correct to the best of my knowledge and belief.

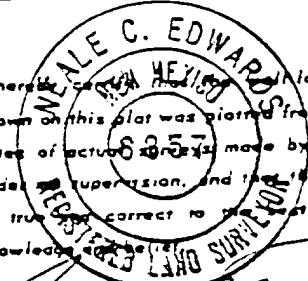

Date Surveyed
10-20-88

Registered Professional Engineer and/or Land Surveyor

Neale C. Edward

Certificate No.
6857

