

UNITED STATES
DEPARTMENT OF THE INTERIOR
BUREAU OF LAND MANAGEMENT

APPLICATION FOR PERMIT TO DRILL, DEEPEN, OR PLUG BACK

1a. Type of Work DRILL		RECEIVED JAN 20 1995 OIL CON. DIV. DIST. 3	5. Lease Number SF-077874	
1b. Type of Well GAS			6. If Indian, All. or Tribe	
2. Operator MERIDIAN OIL 14538		7. Unit Agreement Name		
3. Address & Phone No. of Operator PO Box 4289, Farmington, NM 87499 (505) 326-9700		8. Farm or Lease Name 6997 Feasel ✓ 9. Well Number 2R ✓		
4. Location of Well 970' FNL, 1650' FEL Latitude 36° 36' 32", Longitude 107° 51' 40"		10. Field, Pool, Wildcat 79200 Fulcher Kutz PC ✓ 11. Sec., Twn, Rge, Mer. (NMPM) B Sec 2, T-27-N, R-10-W API # 30-045- 30-045-29269 ✓		
14. Distance in Miles from Nearest Town 12 miles to Bloomfield, NM		12. County San Juan ✓		13. State NM
15. Distance from Proposed Location to Nearest Property or Lease Line 970'				
16. Acres in Lease		17. Acres Assigned to Well 161.26 NE/4 ✓		
18. Distance from Proposed Location to Nearest Well, Drlg, Compl, or Applied for on this Lease 70'				
19. Proposed Depth 2160'		20. Rotary or Cable Tools Rotary		
21. Elevations (DF, FT, GR, Etc.) 5952' GR		22. Approx. Date Work will Start 1st quarter 1995		
23. Proposed Casing and Cementing Program See Operations Plan attached This action is subject to technical and procedural review pursuant to 43 CFR 3105.3 and appeal pursuant to 43 CFR 3105.4		DRILLING OPERATIONS AUTHORIZED ARE SUBJECT TO COMPLIANCE WITH ATTACHED "GENERAL REQUIREMENTS"		
24. Authorized by: <u>[Signature]</u> Regional Drilling Engineer		Date <u>1/3/95</u>		

PERMIT NO. _____ APPROVAL DATE _____

APPROVED BY _____ TITLE _____ DATE _____

Archaeological Report submitted by Arboles Contract Archaeology Technical Report #670
Threatened and Endangered Species Report submitted by Ecosphere dated 11-01-94
NOTE: This format is issued in lieu of U.S. BLM Form 3160-3

APPROVED
AS AMENDED

JAN 18 1995
[Signature]
DISTRICT MANAGER

MMOCD

District I
PO Box 1980, Hobbs, NM 88241-1980
District II
PO Drawer DD, Artesia, NM 88211-0719
District III
1000 Rio Brazos Rd., Aztec, NM 87410
District IV
PO Box 2088, Santa Fe, NM 87504-2088

State of New Mexico
Energy, Minerals & Natural Resources Department

OIL CONSERVATION DIVISION
PO Box 2088
Santa Fe, NM 87504-2088

Form C-10
Revised February 21, 1994
Instructions on back
Submit to Appropriate District Office
State Lease - 4 Copies
Fee Lease - 3 Copies

☐ AMENDED REPORT

WELL LOCATION AND ACREAGE DEDICATION PLAT

1 API Number 30-045-29209		2 Pool Code 77200		3 Pool Name Fulcher Kutz Pictured Cliffs	
4 Property Code 6997		5 Property Name Feasel			6 Well Number 2R
7 OGRID No. 14538		8 Operator Name MERIDIAN OIL INC.			9 Elevation 5952'

10 Surface Location

UL or lot no. B	Section 2	Township 27 N	Range 10 W	Lot Idn	Feet from the 970	North/South line North	Feet from the 1650	East/West line East	County S.J.
--------------------	--------------	------------------	---------------	---------	----------------------	---------------------------	-----------------------	------------------------	----------------

11 Bottom Hole Location If Different From Surface

UL or lot no.	Section	Township	Range	Lot Idn	Feet from the	North/South line	Feet from the	East/West line	County
---------------	---------	----------	-------	---------	---------------	------------------	---------------	----------------	--------

12 Dedicated Acres 161.26	13 Joint or Infill	14 Consolidation Code	15 Order No.
------------------------------	--------------------	-----------------------	--------------

NO ALLOWABLE WILL BE ASSIGNED TO THIS COMPLETION UNTIL ALL INTERESTS HAVE BEEN CONSOLIDATED
OR A NON-STANDARD UNIT HAS BEEN APPROVED BY THE DIVISION

16		5280.00'		SF-077874		17 OPERATOR CERTIFICATION	
4		3		2 970'		I hereby certify that the information contained herein is true and complete to the best of my knowledge and belief.	
RECEIVED JAN 20 1995 OIL CON. DIV. DIST. 3		2		1650'		Signature Peggy Bradfield	
				SF-046563		Printed Name Regulatory Affairs	
						Title 12-30-94	
						Date	
						18 SURVEYOR CERTIFICATION	
						I hereby certify that the well location shown on this plat was plotted from field notes of actual surveys made by me or under my supervision, and that the same is true and correct to the best of my belief.	
						10-3-94	
						Date of Survey	
						Signature and Seal of Professional Surveyor	
						Certificate Number	

5274.06

OPERATIONS PLAN

Well Name: Feasel #2R
Location: 970'FNL, 1650'FEL Section 2, T-27-N, R-10-W
 San Juan County, New Mexico
 Latitude 36° 36' 32", Longitude 107° 51' 40"
Formation: Fulcher Kutz Pictured Cliffs
Elevation: 5952'GL

Formation:	Top	Bottom	Contents
Surface	San Jose	984'	
Ojo Alamo	984'	1109'	aquifer
Kirtland	1109'	1544'	
Fruitland	1544'	1920'	
Fruitland Coal Top	1772'	1905'	gas
Pictured Cliffs	1920'		gas
Total Depth	2160'		

Logging Program: Mud logs from 1500' to Total Depth.
 CNL/hi res LDT/ML/GR/CAL to Total Depth.

Mud Program:

Interval	Type	Weight	Vis.	Fluid Loss
0- 250'	Spud	8.4-8.9	40-50	no control
200-2160'	Non-dispersed	8.4-9.5	30-60	no control

Casing Program:

Hole Size	Depth Interval	Csg.Size	Wt.	Grade
12 1/4"	0 - 200'	8 5/8"	24.0#	K-55
7 7/8"	0 - 2160'	5 1/2"	15.5#	LT&C

Tubing Program: - 2 3/8", 4.7#, J-55 EUE 8rd tbg landed @ 2160'

Float Equipment: 8 5/8" surface casing - saw tooth guide shoe.
 Centralizers will be run in accordance with Onshore Order #2.

5 1/2" production casing - float shoe on bottom. Three centralizers run every other joint above shoe. Four centralizers run every 3rd joint to the base of the Ojo Alamo @ 1109'. Two turbolizing type centralizers - one below and one into the base of the Ojo Alamo @ 1109'. Standard centralizers thereafter every fourth joint up to the base of the surface pipe.

Wellhead Equipment: 8 5/8" x 5 1/2" x 2 3/8" x 11" 2000 psi xmas tree assembly.

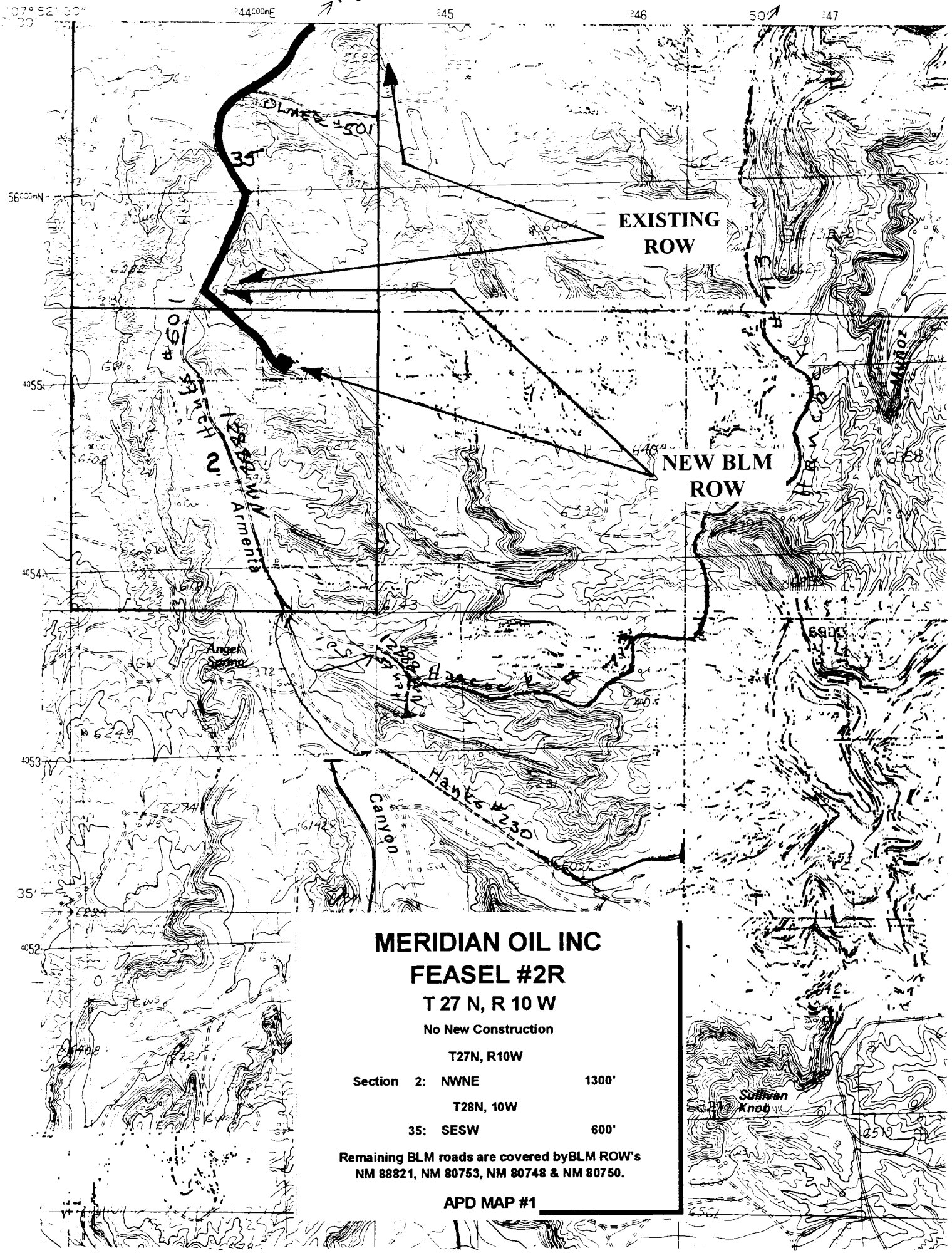

**MERIDIAN OIL INC
FEASEL #2R**

T 27 N, R 10 W

No New Construction

T27N, R10W

Section 2: NWNE 1300'

T28N, 10W

35: SESW 600'

**Remaining BLM roads are covered by BLM ROW's
NM 88821, NM 80753, NM 80748 & NM 80750.**

APD MAP #1