

District I
PO Box 1980, Hobbs, NM 88241-1980
District II
811 S. 1st Street, Artesia, NM 88210-2834
District III
1000 Rio Brazos Rd., Aztec, NM 87410
District IV
2040 South Pacheco, Santa Fe, NM 87505

State of New Mexico
Energy, Minerals & Natural Resources Department

OIL CONSERVATION DIVISION
2040 South Pacheco
Santa Fe, NM 87505

Form C-101
Revised October 18, 1999
Instructions on back
Submit to Appropriate District Office
State Lease - 6 Copies
Fee Lease - 5 Copies

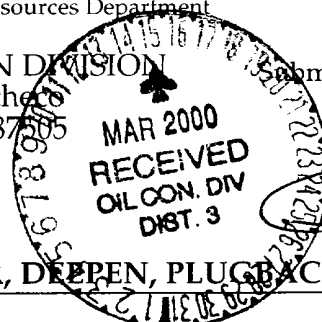

☒ AMENDED REPORT

APPLICATION FOR PERMIT TO DRILL, RE-ENTER, DEEPEN, PLUG BACK, OR ADD A ZONE

¹ Operator name and Address Cross Timbers Operating Company 2700 Farmington Ave., Bldg. K. Ste 1 Farmington, NM 87401		² OGRID Number 167067
		³ API Number 30-0 45-30155
⁴ Property Code 22631	⁵ Property Name R. B. SULLIVAN	⁶ Well No. 1R

⁷ Surface Location

UL or lot no.	Section	Township	Range	Lot. Idn	Feet from the	North/South Line	Feet from the	East/West line	County
G	11	27N	10W		1,980'	NORTH	1,975'	EAST	SAN JUAN

⁸ Proposed Bottom Hole Location If Different From Surface

UL or lot no.	Section	Township	Range	Lot. Idn	Feet from the	North/South Line	Feet from the	East/West line	County

⁹ Proposed Pool 1 FULCHER KUTZ PICTURED CLIFFS	¹⁰ Proposed Pool 2
--	-------------------------------

¹¹ Work Type Code N	¹² Well Type Code G	¹³ Cable/Rotary R	¹⁴ Lease Type Code P	¹⁵ Ground Level Elevation 6,008'
¹⁶ Multiple NO	¹⁷ Proposed Depth 2,110'	¹⁸ Formation PICTURED CLIFFS	¹⁹ Contractor UNKNOWN	²⁰ Spud Date APRIL 2000

²¹ Proposed Casing and Cement Program

Hole Size	Casing Size	Casing weight/foot	Setting Depth	Sacks of Cement	Estimated TOC
8-3/4"	7"	20#, J-55	200'	75	SURFACE
6-1/4"	4-1/2"	10.5#, J-55	2,110'	165	SURFACE

²² Describe the proposed program. If this application is to DEEPEN or PLUG BACK give the data on the present productive zone and proposed new productive zone. Describe the blowout prevention program, if any. Use additional sheets if necessary.

Surface casing cement program: Approximately 75 sx Type III cement containing 1/4 PPS Celloflake, 2% CaCl₂ (mixed at 14.6 ppg, 1.39 cubic feet/sk 6.67 gal wtr/sk). Circulate cement to surface.

Production casing cement program: Approximately 165 sx of 35:65 Poz/Type III cement containing 10 PPS CSE, 3% KCl, 1/4 PPS Celloflake, 0.65% bwoc-FL-62, 6% gel (mixed at 12.5 ppg, 2.07 cubic feet/sk, 10.95 gal wtr/sk). Circulate cement to surface. Actual cement volume will be calculated fr/caliper log.

BOP program: 7-1/16" x 3,000 psig double ram BOP.

²³ I hereby certify that the information given above is true and complete to the best of my knowledge and belief.

Signature: *Thomas DeLong* 3/14/00

Printed name: Thomas DeLong

Title: Production Engineer

OIL CONSERVATION DIVISION

Approved by: *SSS*

Title: SUPERVISOR DISTRICT # 3

Approval Date: MAR 15 2000 Expiration Date:

District I
PO Box 1980, Hobbs, NM 88241-1980

State of New Mexico
Energy, Minerals & Natural Resources Department

Form C-102
Revised February 21, 1994

District II
PO Drawer 00, Artesia, NM 88211-0719

OIL CONSERVATION DIVISION
PO Box 2088
Santa Fe, NM 87504-2088

Submit to Appropriate District Office
State Lease - 4 Copies
Fee Lease - 3 Copies

District III
1000 Rio Brazos Rd., Aztec, NM 87410

District IV
PO Box 2088, Santa Fe, NM 87504-2088

☒ AMENDED REPORT

WELL LOCATION AND ACREAGE DEDICATION PLAT

¹ API Number	² Pool Code 77200	³ Pool Name FULCHER KUTZ PICTURED CLIFFS
⁴ Property Code	⁵ Property Name R. B. SULLIVAN	⁶ Well Number 1R
⁷ OSRID No. 167057	⁸ Operator Name CROSS TIMBERS OPERATING COMPANY	⁹ Elevation 6008'

¹⁰ Surface Location

UL or lot no.	Section	Township	Range	Lot Idn	Feet from the	North/South line	Feet from the	East/West line	County
G	11	27N	10W		1980	NORTH	1975	EAST	SAN JUAN

¹¹ Bottom Hole Location If Different From Surface

UL or lot no.	Section	Township	Range	Lot Idn	Feet from the	North/South line	Feet from the	East/West line	County

¹² Dedicated Acres 160 - NE 1/4	¹³ Joint or Infill	¹⁴ Consolidation Code	¹⁵ Order No.
---	-------------------------------	----------------------------------	-------------------------

NO ALLOWABLE WILL BE ASSIGNED TO THIS COMPLETION UNTIL ALL INTERESTS HAVE BEEN CONSOLIDATED
OR A NON-STANDARD UNIT HAS BEEN APPROVED BY THE DIVISION

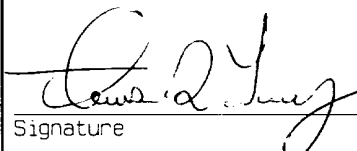
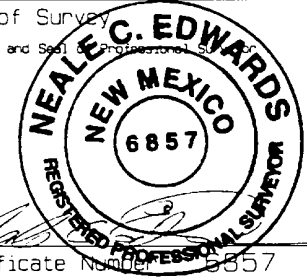
¹⁵	5274.06'		¹⁷ OPERATOR CERTIFICATION I hereby certify that the information contained herein is true and complete to the best of my knowledge and belief.  Signature Tom DeLong Printed Name Production Engineer Title 3-14-2000 Date
5280.00'	1980'	1975'	
	11		¹⁸ SURVEYOR CERTIFICATION I hereby certify that the well location shown on this plat was plotted from field notes of actual surveys made by me or under my supervision, and that the same is true and correct to the best of my belief. MARCH 8, 2000 Date of Survey Signature and Seal of Professional Surveyor  Certificate Number 6857
	5277.36'		

CROSS TIMBERS OPERATING COMPANY R.B. SULLIVAN #1R
1980' FNL & 1975' FEL, SECTION 11, T27N, R10W
NMPM, SAN JUAN COUNTY, NEW MEXICO
GROUND ELEVATION: 6008' DATE: MARCH 8, 2000

LATITUDE: 36°35'29"
LONGITUDE: 107°51'46"

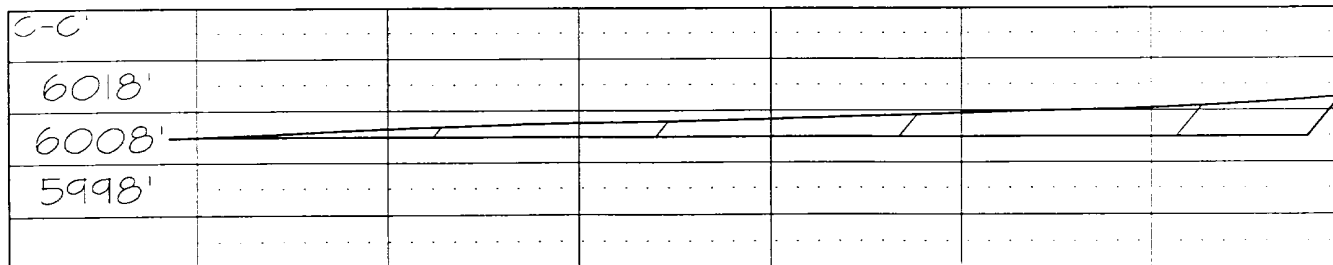
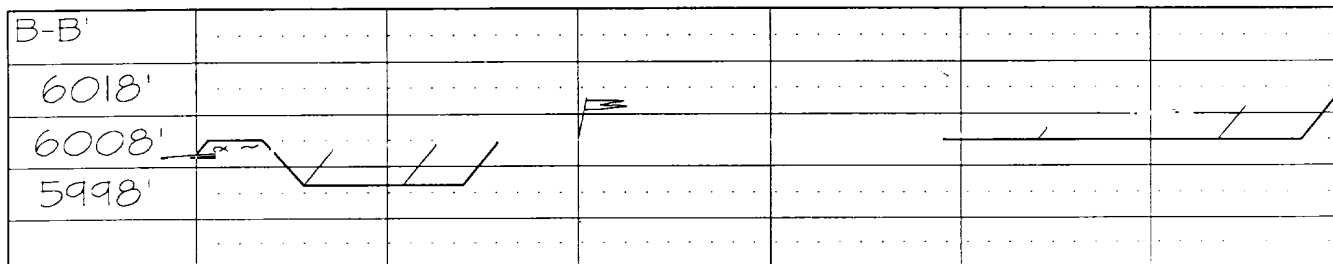
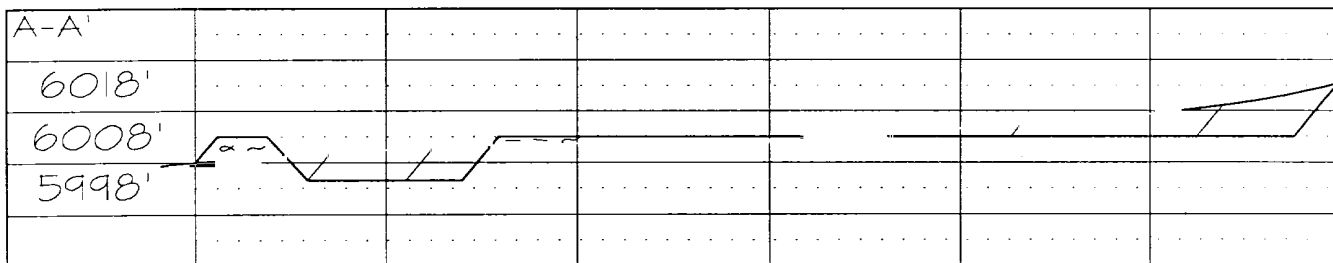
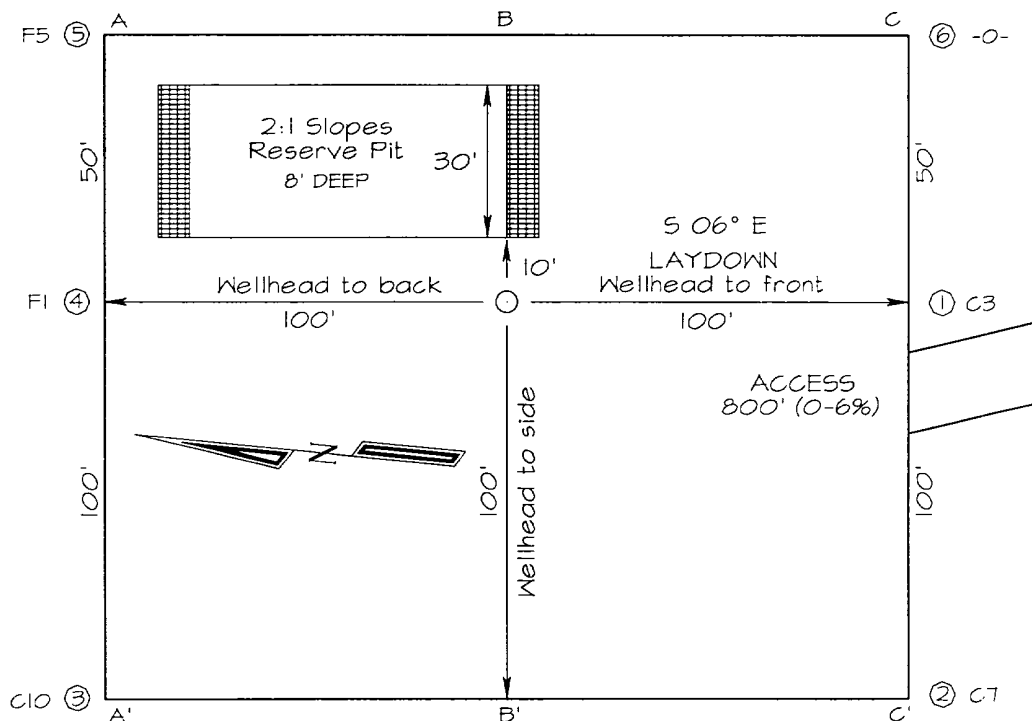

Note: Contractor should call One-Call for location of any marked or unmarked buried pipelines or cables on well pad and/or access road at least two (2) working days prior to construction

CROSS TIMBERS OPERATING COMPANY R.B. SULLIVAN #1R

1980' FNL & 1975' FEL, SECTION II, T27N, R10W, N.M.P.M.
SAN JUAN COUNTY, NEW MEXICO

