

El Paso Natural Gas Company

El Paso, Texas

July 10, 1956

DIRECT REPLY TO:
P. O. BOX 997
FARMINGTON, NEW MEXICO

Mr. A. L. Porter, Secretary and Director
Oil Conservation Commission
Box 871
Santa Fe, New Mexico

Dear Mr. Porter:

This is to request administrative approval of an unorthodox location to be located in the South Blanco Extension Pictured Cliffs Pool, San Juan County, New Mexico.

The well, our Storey No. 5-C is to be located 401' from the North Line and 362' from the West Line of Section 35, Township 28 North, Range 9 West, N.M.P.M., San Juan County, New Mexico. The northwestern corner of this quarter section contains a draw between shale cliffs and the remainder of the quarter section is broken shale and sandstone slopes which would make the cost of an orthodox location prohibitive.

The well is to be a Pictured Cliffs completion and since El Paso Natural Gas Company holds the lease to the West and North the approval of other operators has not been sought.

I am enclosing two copies of the Certified Well Location Plat sketching terrain conditions and two copies of our Intention to Drill.

Sincerely yours,
ORIGINAL SIGNED E. J. COEL

E. J. Coel
Senior Petroleum Engineer

EJC:ajh
Enclosure
cc: R. L. Hamblin
Phil McGrath
Emery Arnold ✓

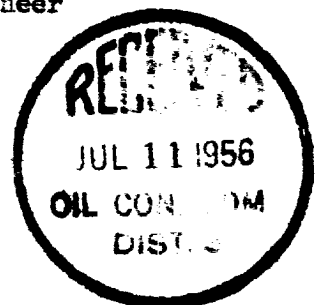

COPY

SECRET
100-100000-100000

ORIGINAL SIGNED 100-100000



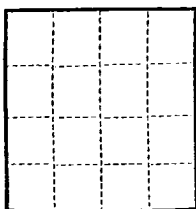

(SUBMIT IN TRIPLICATE)

UNITED STATES
DEPARTMENT OF THE INTERIOR
GEOLOGICAL SURVEY

Land Office Santa Fe
Lease No. 077111
Unit Storey

SUNDRY NOTICES AND REPORTS ON WELLS

NOTICE OF INTENTION TO DRILL.....	<input checked="" type="checkbox"/>	SUBSEQUENT REPORT OF WATER SHUT-OFF.....	
NOTICE OF INTENTION TO CHANGE PLANS.....		SUBSEQUENT REPORT OF SHOOTING OR ACIDIZING.....	
NOTICE OF INTENTION TO TEST WATER SHUT-OFF.....		SUBSEQUENT REPORT OF ALTERING CASING.....	
NOTICE OF INTENTION TO RE-DRILL OR REPAIR WELL.....		SUBSEQUENT REPORT OF RE-DRILLING OR REPAIR.....	
NOTICE OF INTENTION TO SHOOT OR ACIDIZE.....		SUBSEQUENT REPORT OF ABANDONMENT.....	
NOTICE OF INTENTION TO PULL OR ALTER CASING.....		SUPPLEMENTARY WELL HISTORY.....	
NOTICE OF INTENTION TO ABANDON WELL.....			

(INDICATE ABOVE BY CHECK MARK NATURE OF REPORT, NOTICE, OR OTHER DATA)

July 10, 1956

Well No. 5-C is located 401 ft. from N line and 362 ft. from W line of sec. 35

NW Section 35 28N 9E 100W
(1/4 Sec. and Sec. No.) (Twp.) (Range) (Meridian)

Gr. Blanco P.C. Extension San Juan New Mexico
(Field) (County or Subdivision) (State or Territory)

The elevation of the derrick floor above sea level is 6134 ft.

DETAILS OF WORK

(State names of and expected depths to objective sands; show sizes, weights, and lengths of proposed casings; indicate mudding jobs, cementing points, and all other important proposed work)

It is intended to drill a well thru the Pictured Cliff formation using rotary tools and to perforate and water fracture possible producing zones. Estimated total Depth 2460'.

Casing Program:

9 5/8" at 120' with 125 sacks regular cement circulated to surface
5 1/2" at 2460' with 75 sacks regular cement, 75 sacks Pozmix

The NW/4 of Section 35 is dedicated to this well.
NW/4, SF 077111.

I understand that this plan of work must receive approval in writing by the Geological Survey before operations may be commenced.

Company El Paso Natural Gas Company

Address Box 997

Farlington, New Mexico

ORIGINAL SIGNED E. S. OBERLY

By _____

Title Petroleum Engineer

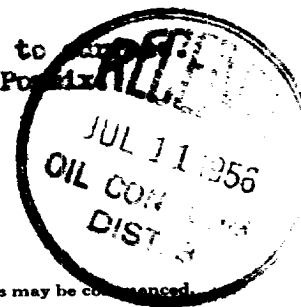



THE UNIVERSITY OF CHICAGO

NEW MEXICO
OIL CONSERVATION COMMISSION

WELL LOCATION AND/OR GAS PRODUCTION PLAT

JULY 6, 1956

EL PASO NATURAL GAS COMPANY

STOREY "C"

SF 077111

5

35

28 N

9 W

401

NORTH

362

WEST

SAN JUAN

6174

PICTURED CLIFF

SO. BLANCO
EXTENSION

160 AC.
(1916 PLAT)

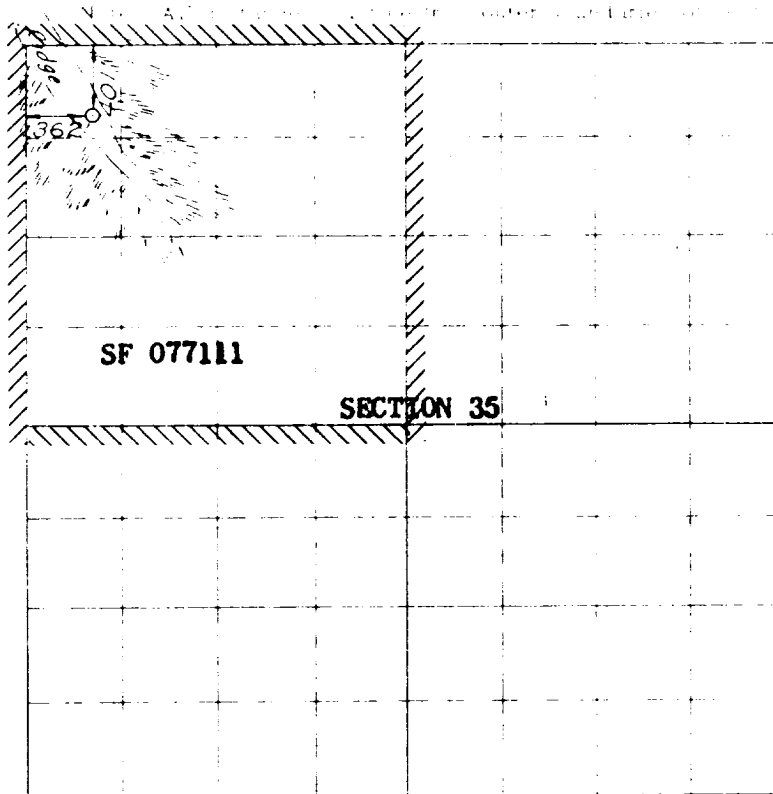

Scale: 1 inch = equal 1 mile



NOTE

This section of
form is to be used
for gas wells only



I hereby certify that the above plat was prepared from
field notes of actual surveys made by me or under my
supervision and that the same are true and correct to the
best of my knowledge and belief.

Date Surveyed JULY 21 1956

E. O. Oberly

Registered Professional Engineer and/or Land Surveyor

1. Is this well a Dual Comp.

Yes ☐ No ☒

2. If the answer to Question 1

is Yes, are there any other duals
completed wells within the
bordered acreage.

Yes ☐ No ☐

ORIGINAL SIGNED E. S. OBERLY

Name _____

Position Petroleum Engineer

Representing El Paso Natural Gas Co.

Address Box 997, Farmington, N.M.