

(SUBMIT IN TRIPLICATE)

UNITED STATES
DEPARTMENT OF THE INTERIOR
GEOLOGICAL SURVEY

Land Office Santa Fe
Lease No. SW-07963
Unit McClanahan

SUNDRY NOTICES AND REPORTS ON WELLS

NOTICE OF INTENTION TO DRILL.....	<input checked="" type="checkbox"/>	SUBSEQUENT REPORT OF WATER SHUT-OFF.....	
NOTICE OF INTENTION TO CHANGE PLANS.....		SUBSEQUENT REPORT OF SHOOTING OR ACIDIZING.....	
NOTICE OF INTENTION TO TEST WATER SHUT-OFF.....		SUBSEQUENT REPORT OF ALTERING CASING.....	
NOTICE OF INTENTION TO RE-DRILL OR REPAIR WELL.....		SUBSEQUENT REPORT OF RE-DRILLING OR REPAIR.....	
NOTICE OF INTENTION TO SHOOT OR ACIDIZE.....		SUBSEQUENT REPORT OF ABANDONMENT.....	
NOTICE OF INTENTION TO PULL OR ALTER CASING.....		SUPPLEMENTARY WELL HISTORY.....	
NOTICE OF INTENTION TO ABANDON WELL.....			

(INDICATE ABOVE BY CHECK MARK NATURE OF REPORT, NOTICE, OR OTHER DATA)

June 22, 1960

Well No. 10-D is located 1700 ft. from S line and 790 ft. from W line of sec. 24

SW $\frac{1}{4}$, Section 24
($\frac{1}{4}$ Sec. and Sec. No.)

28N
(Twp.)

10W
(Range)

S.M.P.M.
(Meridian)

Angel Peak Extension
(Field)

San Juan
(County or Subdivision)

New Mexico
(State or Territory)

The elevation of the derrick floor above sea level is 5771 ft. (Ground Elevation)

DETAILS OF WORK

(State names of and expected depths to objective sands; show sizes, weights, and lengths of proposed casings; indicate mudding jobs, cementing points, and all other important proposed work)

Propose To: Set 300' of 8 5/8" surface casing and cement to surface.

Drill to approximate total depth of 6440 feet or through Dakota formation. Run 4 1/2" casing to total depth with 2-stage cement collar set approximately 100' below Pictured Cliffs formation. Cement 1st stage with 225 sz. and second stage with 125 sz.

Perforate Dakota formation with four shots per foot. Sand-water frac with 90,000# sand and 90,000 gals. water. Run 2 1/8" tubing.

West one-half of Section 24, 320 acres dedicated to well.

I understand that this plan of work must receive approval in writing by the Geological Survey before operations can be commenced.

Company Astec Oil and Gas Company

Address Drewer 570

Farmington, New Mexico

ORIGINAL SIGNED BY IOE.C. SALMON

By Joe C. Salmon

Title District Superintendent

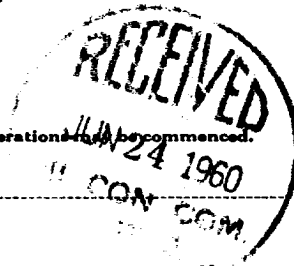

NEW MEXICO OIL CONSERVATION COMMISSION

Well Location and Acreage Dedication Plat

Section A.

Date June 10, 1960

Operator Antec Oil and Gas Company Lease McClanahan
Well No. 15-0 Unit Letter L Section 24 Township 28N Range 10W NMPM
Located 1700 Feet From South Line, 790 Feet From West Line
County San Juan G. L. Elevation 5771 Dedicated Acreage 300 Acres
Name of Producing Formation Bakota Pool Angel Peak Extension

1. Is the Operator the only owner* in the dedicated acreage outlined on the plat below?
Yes XX No
2. If the answer to question one is "no," have the interests of all the owners been consolidated by communitization agreement or otherwise? Yes No . If answer is "yes,"
Type of Consolidation
3. If the answer to question two is "no," list all the owners and their respective interests below:

Owner

Land Description

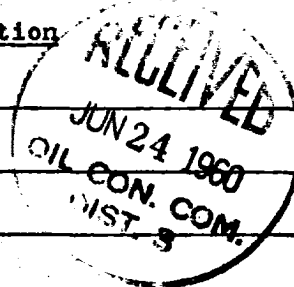

Section. B

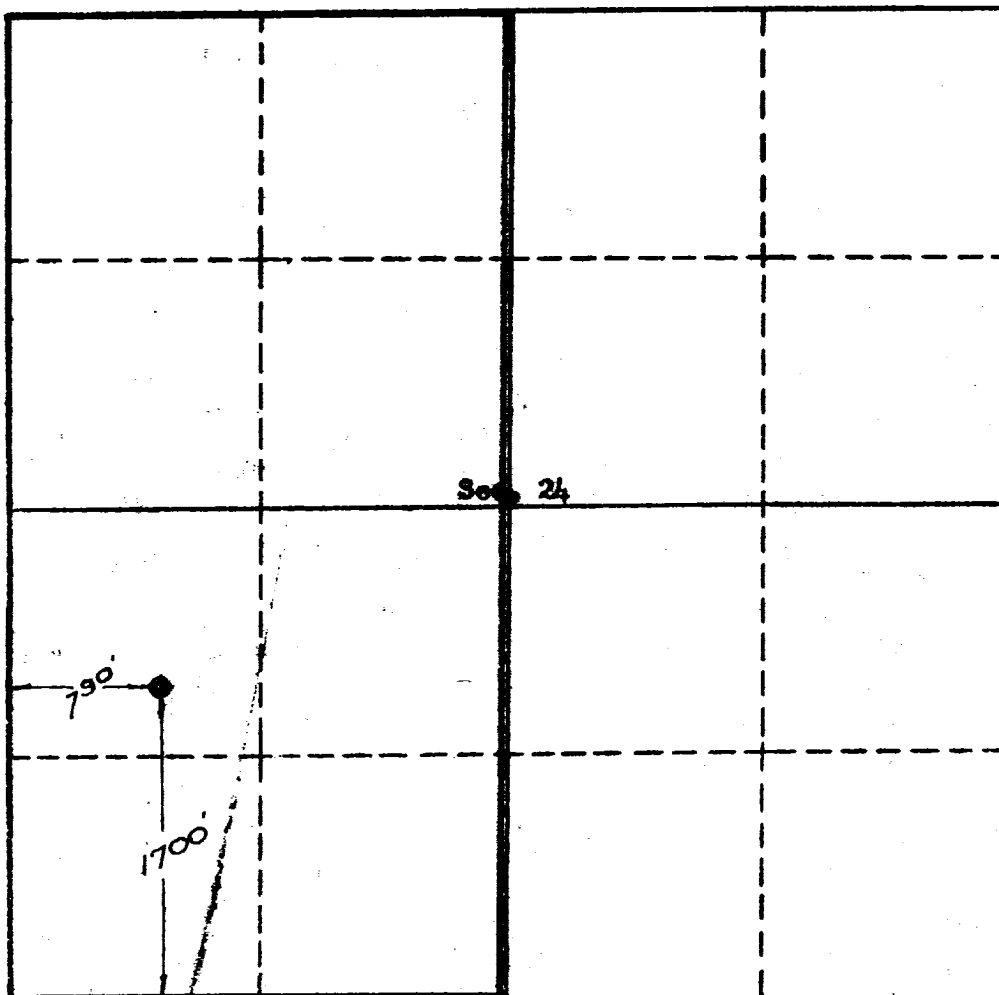

This is to certify that the information in Section A above is true and complete to the best of my knowledge and belief.

Antec Oil and Gas Co.
(Operator)

ORIGINAL SIGNED BY JOE C. SALMON
(Representative)

Box 706, Farmington, N.M.
Address

This is to certify that the well location shown on the plat in Section B was plotted from field notes of actual surveys made by me or under my supervision and that the same is true and correct to the best of my knowledge and belief.

Date Surveyed June 8, 1960

Ernest V. Echolaw
Ernest V. Echolaw
Registered Land Surveyor.

Certificate No. 1545

[The body of the document contains extremely faint, illegible text, likely bleed-through from the reverse side. The text is organized into several paragraphs, with some lines appearing as bulleted lists. A faint circular stamp or mark is visible on the left side of the page.]