

(SUBMIT IN TRIPLICATE)

UNITED STATES
DEPARTMENT OF THE INTERIOR
GEOLOGICAL SURVEY

Land Office Santa Fe
Lease No. SE - 020761
Unit Cain

SUNDRY NOTICES AND REPORTS ON WELLS

NOTICE OF INTENTION TO DRILL	XX	SUBSEQUENT REPORT OF WATER SHUT-OFF
NOTICE OF INTENTION TO CHANGE PLANS		SUBSEQUENT REPORT OF SHOOTING OR ACIDIZING
NOTICE OF INTENTION TO TEST WATER SHUT-OFF		SUBSEQUENT REPORT OF ALTERING CASING
NOTICE OF INTENTION TO RE-DRILL OR REPAIR WELL		SUBSEQUENT REPORT OF RE-DRILLING OR REPAIR
NOTICE OF INTENTION TO SHOOT OR ACIDIZE		SUBSEQUENT REPORT OF ABANDONMENT
NOTICE OF INTENTION TO PULL OR ALTER CASING		SUPPLEMENTARY WELL HISTORY
NOTICE OF INTENTION TO ABANDON WELL		

(INDICATE ABOVE BY CHECK MARK NATURE OF REPORT, NOTICE, OR OTHER DATA)

September 29, 1959, 19

Cain

Well No. 6 is located 1650 ft. from S line and 1550 ft. from E line of sec. 15

SE 1/4 Section 15, T-28N R-10W N. P. M.
(1/4 Sec. and Sec. No.) (Twp.) (Range) (Meridian)

Pictured Cliffs San Juan New Mexico
(Field) (County or Subdivision) (State or Territory)

The elevation of the derrick floor above sea level is 5914 ft. (ungraded ground)

DETAILS OF WORK

(State names of and expected depths to objective sands; show sizes, weights, and lengths of proposed casings; indicate mudding jobs, cementing points, and all other important proposed work)

Propose to: Set 90' of 3 5/8" surface casing with 100 sacks cement.
Drill through Pictured Cliffs formation to a total depth of 2090'.
Set 4 1/2" casing at total depth with 100 sacks cement.
Perforate Pictured Cliffs formation with 4 shots per foot.
Sand-Water Brac with 40,000 gallons water and 40,000# sand.
Run 1" Tubing.

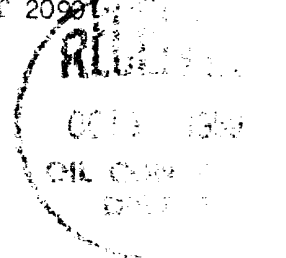

I understand that this plan of work must receive approval in writing by the Geological Survey before operations may be commenced.

Company Antec Oil and Gas Company

Address Box # 786,

Barminston, New Mexico

By ORIGINAL SIGNED BY JOE C. SALMON
Joe C. Salmon
Title District Superintendent

NEW MEXICO OIL CONSERVATION COMMISSION

Well Location and Acreage Dedication Plat

Section A.

Date September 28, 1959

Operator AZTEC OIL & GAS COMPANY Lease CAIN
Well No. 6 Unit Letter J Section 15 Township 28N Range 10W NMPM
Located 1650 Feet From South Line, 1550 Feet From East Line
County San Juan G. L. Elevation 5914 Dedicated Acreage 160 Acres
Name of Producing Formation Pictured Cliffs Pool Aztec Pictured Cliffs

1. Is the Operator the only owner* in the dedicated acreage outlined on the plat below?
Yes XXX No _____
2. If the answer to question one is "no," have the interests of all the owners been consolidated by communitization agreement or otherwise? Yes _____ No _____. If answer is "yes,"
Type of Consolidation _____
3. If the answer to question two is "no," list all the owners and their respective interests below:

Owner

Land Description

Section B

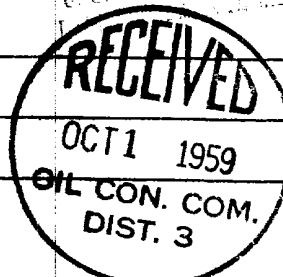
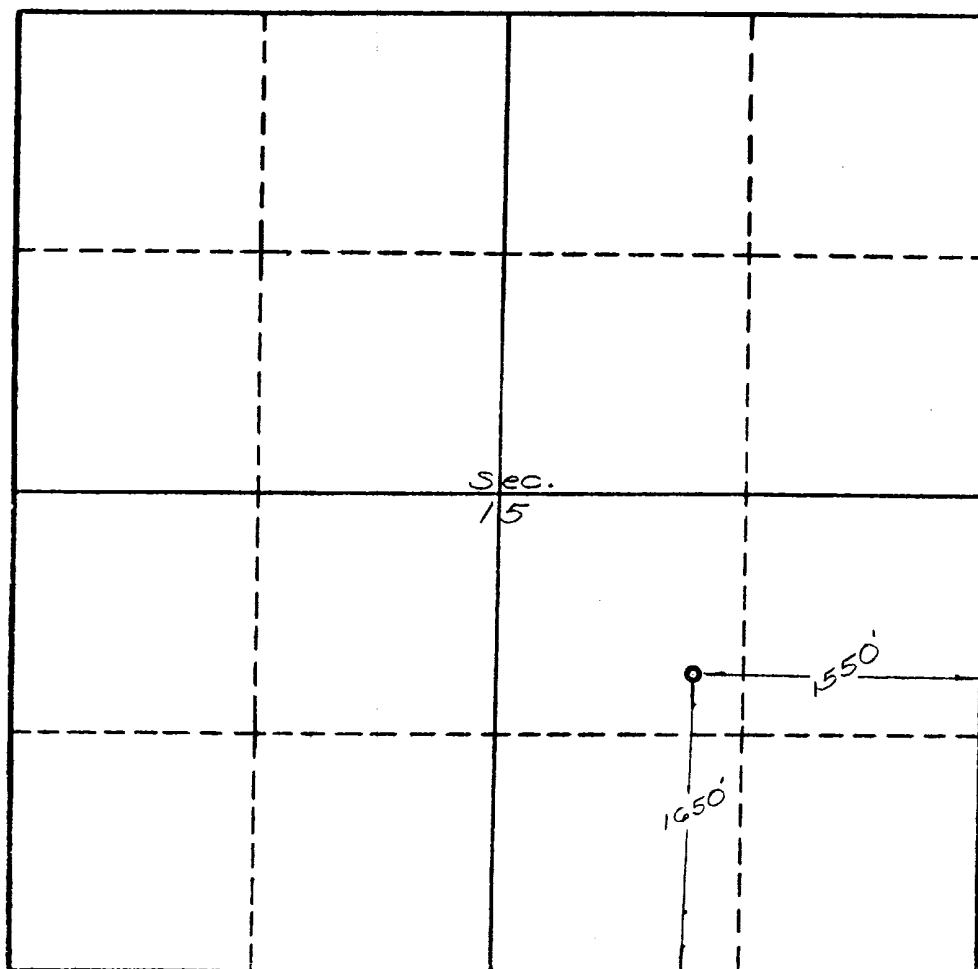

This is to certify that the information in Section A above is true and complete to the best of my knowledge and belief.

AZTEC OIL & GAS COMPANY
(Operator)

ORIGINAL SIGNED BY JOE C. SALMON
(Representative)

Box 786, Farmington, New Mex.
Address

This is to certify that the well location shown on the plat in Section A is based from field notes of actual surveys made by me or under my supervision and that the same is true and correct to the best of my knowledge and belief.

Date Surveyed Sept. 24, 1959

Ernest V. Echohawk
Registered Land Surveyor.

Certificate No. 1545