

UNITED STATES
DEPARTMENT OF THE INTERIOR
GEOLOGICAL SURVEY

APPLICATION FOR PERMIT TO DRILL, DEEPEN, OR PLUG BACK

1a. TYPE OF WORK

DRILL ☒DEEPEN ☐PLUG BACK ☐

b. TYPE OF WELL

OIL
WELL ☐GAS
WELL ☒

OTHER

SINGLE
ZONE ☒MULTIPLE
ZONE ☐

2. NAME OF OPERATOR

Tenneco Oil Company

3. ADDRESS OF OPERATOR

P. O. Box 1714, Durango, Colorado 81302

4. LOCATION OF WELL (Report location clearly and in accordance with any State requirements.)*

At surface

1050' FNL, 1510' FWL

At proposed prod. zone

14. DISTANCE IN MILES AND DIRECTION FROM NEAREST TOWN OR POST OFFICE*

10. DISTANCE FROM PROPOSED*

LOCATION TO NEAREST

PROPERTY OR LEASE LINE, FT.

(Also to nearest drlg. unit line, if any)

18. DISTANCE FROM PROPOSED LOCATION*

TO NEAREST WELL, DRILLING, COMPLETED,
OR APPLIED FOR, ON THIS LEASE, FT.

21. ELEVATIONS (Show whether DF, RT, GR, etc.)

5922 GR

16. NO. OF ACRES IN LEASE

320

19. PROPOSED DEPTH

6780

17. NO. OF ACRES ASSIGNED
TO THIS WELL

320 3' 8 85

20. ROTARY OR CABLE TOOLS

Rotary

22. APPROX. DATE WORK WILL START*

September 15, 1965

23.

PROPOSED CASING AND CEMENTING PROGRAM

SIZE OF HOLE	SIZE OF CASING	WEIGHT PER FOOT	SETTING DEPTH	QUANTITY OF CEMENT
12-1/4	8-5/8	24#	250	125 Sacks
7-7/8 to 6350	4-1/2	9.5 #	0-5780	First stage 200 sacks
6-3/4 to 6780	4-1/2	10.5#	5780-6780	Second stage sufficient amount to circulate to surface.

We propose to rig up drill to aprx 6780. Run Induction Electric and Gamma Ray Density log. Run 4-1/2 J-55 casing to TD. Cement with stage collar set at aprx 300' below bottom of Mesaverde. Log, perforate and frac and complete as single Dakota. Run 2-3/8 tubing and conduct deliverability tests.

RECEIVED

SEP 3 1965

U. S. GEOLOGICAL SURVEY

IN ABOVE SPACE DESCRIBE PROPOSED PROGRAM: If proposal is to deepen or plug back, give data on present production zone and proposed new productive zone. If proposal is to drill or deepen directionally, give pertinent data on subsurface locations and measured and true vertical depths. Give blowout preventer program, if any.

24.

SIGNED

Harold C. Nichols

TITLE Senior Production Clerk

DATE 9-2-65

(This space for Federal or State office use)

PERMIT NO.

APPROVAL DATE

APPROVED BY

CM

TITLE

CONDITIONS OF APPROVAL, IF ANY:

DATE

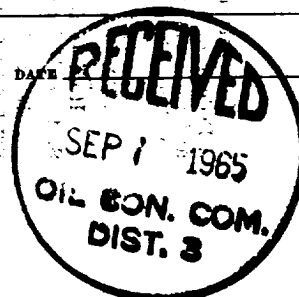

*See Instructions On Reverse Side

NEW MEXICO OIL CONSERVATION COMMISSION
WELL LOCATION AND ACREAGE DEDICATION PLAT

Form No. 1
Sales Section C-28
Effective 1-1-64

Location must be within the outer boundaries of the Section

TENNECO OIL COMPANY		SCHWEDTFEGER "A"		Area 1
C	36	28 North	9 West	San Juan

1050	North	1510	West
5922' ungraded	Basin Dakota	Basin Dakota	4318.85 320

1. Outline the acreage dedicated to the subject well by colored pencil or hatchure marks on the plat below.
2. If more than one lease is dedicated to the well, outline each and identify the ownership thereof (both as to working interest and royalty).
3. If more than one lease of different ownership is dedicated to the well, have the interests of all owners been consolidated by communitization, unitization, force-pooling, etc?

☐ Yes ☐ No If answer is "yes," type of consolidation _____

If answer is "no," list the owners and tract descriptions which have actually been consolidated. (See reverse side of this form if necessary.) _____

No allowable will be assigned to the well until all interests have been consolidated (by communitization, unitization, forced-pooling, or otherwise) or until a non-standard unit, eliminating such interests, has been approved by the Commission.

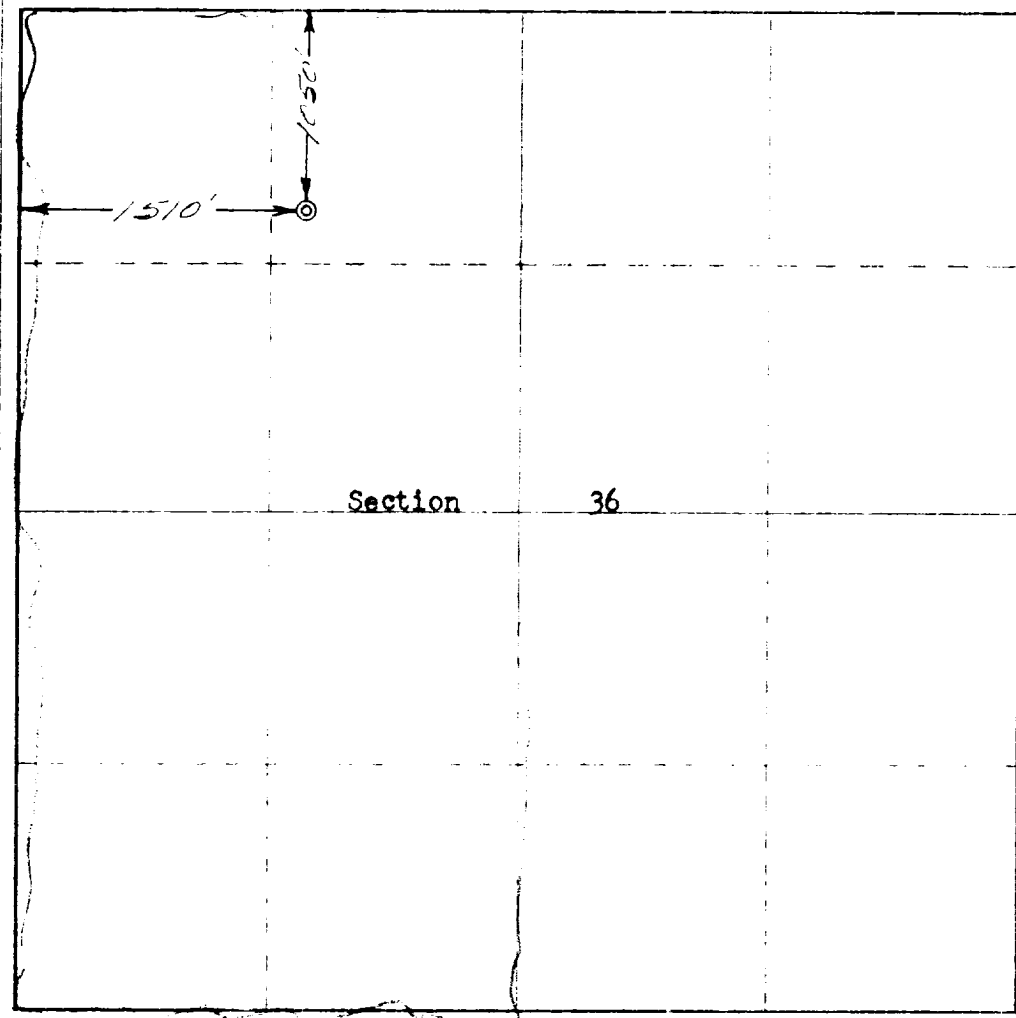
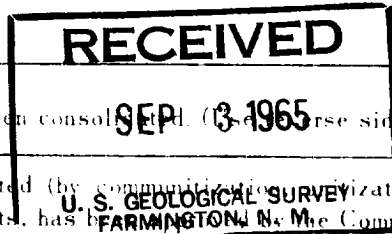

CERTIFICATION

I hereby certify that the information contained herein is true and complete to the best of my knowledge and belief.

Harold C. Nichols

Senior Production Clerk
Tenneco Oil Company
9-2-65

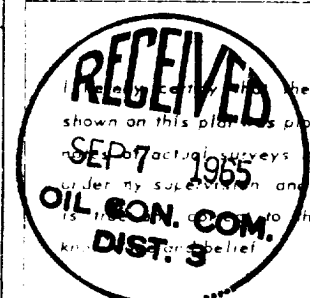

26 August 1965

Robert H. Ernst
ROBERT H. ERNST

N. Mex. PE & IS 2463