

Santa Fe

(SUBMIT IN TRIPLICATE)

UNITED STATES  
DEPARTMENT OF THE INTERIOR  
GEOLOGICAL SURVEY

Land Office

Lease No.

Unit

31/4 Sec. 24

## SUNDRY NOTICES AND REPORTS ON WELLS

NOTICE OF INTENTION TO DRILL.....	<input checked="" type="checkbox"/>	SUBSEQUENT REPORT OF WATER SHUT-OFF.....	
NOTICE OF INTENTION TO CHANGE PLANS.....		SUBSEQUENT REPORT OF SHOOTING OR ACIDIZING.....	
NOTICE OF INTENTION TO TEST WATER SHUT-OFF.....		SUBSEQUENT REPORT OF ALTERING CASING.....	
NOTICE OF INTENTION TO RE-DRILL OR REPAIR WELL.....		SUBSEQUENT REPORT OF RE-DRILLING OR REPAIR.....	
NOTICE OF INTENTION TO SHOOT OR ACIDIZE.....		SUBSEQUENT REPORT OF ABANDONMENT.....	
NOTICE OF INTENTION TO PULL OR ALTER CASING.....		SUPPLEMENTARY WELL HISTORY.....	
NOTICE OF INTENTION TO ABANDON WELL.....			

(INDICATE ABOVE BY CHECK MARK NATURE OF REPORT, NOTICE, OR OTHER DATA)

March 22

1955

Well No. 3 is located 1700 ft. from N line and 990 ft. from E line of sec. 24  
31/4 Sec. 24 28 N 10 W 187N  
(1/4 Sec. and Sec. No.) (Twp.) (Range) (Meridian)  
Fulcher-Mata P.C. (Ext.) San Juan New Mexico  
(Field) (County or Subdivision) (State or Territory)

The elevation of the ~~derrick floor~~ ground level above sea level is 5767 ft.

## DETAILS OF WORK

(State names of and expected depths to objective sands; show sizes, weights, and lengths of proposed casings; indicate mudlogging jobs, cementing points, and all other important proposed work)

Propose to set 8-5/8" surface casing at 150' and 5-1/2" at 1870', approximately, with rotary tools. Hole will be rat-holed ahead to estimated TD of 2,000' before 5-1/2" is set and logs will be run. Plug will be drilled and well cleaned out with cable tools. Open hole will be treated with about 10,000 gals. and 10,000 lbs. sand-oil.

Proposed production unit is 31/4 embracing 160 acres.

RECEIVED  
MAY 2 1955  
U. S. GEOLOGICAL SURVEY  
WASHINGTON, NEW MEXICO

I understand that this plan of work must receive approval in writing by the Geological Survey before operations may be commenced.

Company AMEC OIL & GAS COMPANYAddress 320 Mercantile Securities Bldg.Dallas 1, Texas

By

G. B. Williams  
G. B. Williams

Title

Petroleum Engineer

WAS ANY Astec Oil and Gas Company

McClanshan No. 3

SP-079634

Acres 1700'

1700' from the South line and 990' from the West line.

Section 10, SW 1/4

24 28 10 W. N.M. Co. San Juan County, New Mexico.

Ground Elevation 5768

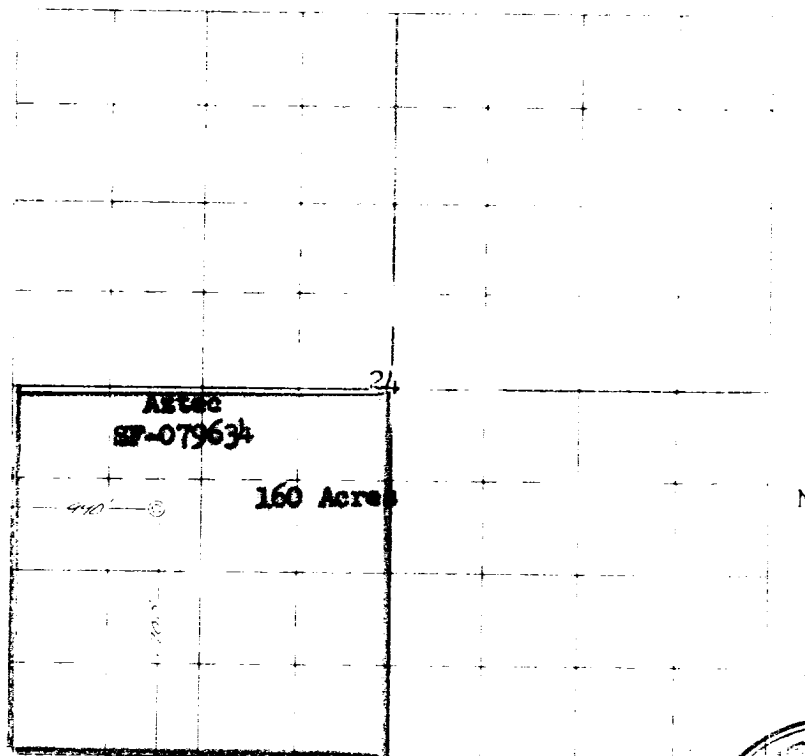

Scale - 4 inches = 1 mile

Surveyed March 18

This is to certify that the above plat was prepared from field notes of actual survey made by me or under my supervision and that the same are true and correct to the best of my knowledge and belief.

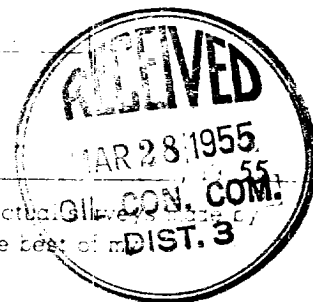

*Ernest V. Echoshawk*

Ernest V. Echoshawk  
Registered Land Surveyor  
N. M. Reg. #1545

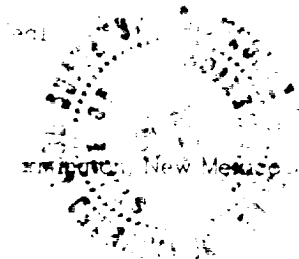

RECEIVED  
U. S. GEOLOGICAL SURVEY  
FARMINGTON NEW MEXICO