

UNITED STATES
DEPARTMENT OF THE INTERIOR
GEOLOGICAL SURVEY

SUNDRY NOTICES AND REPORTS ON WELLS

(Do not use this form for proposals to drill or to deepen or plug back to a different reservoir. Use Form 9-331-C for such proposals.)

1. oil well ☐ gas well ☒ other

2. NAME OF OPERATOR
PETROLEUM CORPORATION OF TEXAS

3. ADDRESS OF OPERATOR c/o Walsh Engr. & Prod.
P.O. Drawer 419 Farmington, N.M. 87401

4. LOCATION OF WELL (REPORT LOCATION CLEARLY. See space 17 below.)

AT SURFACE: 790'FSL, 790'FEL
AT TOP PROD. INTERVAL: Same
AT TOTAL DEPTH:

16. CHECK APPROPRIATE BOX TO INDICATE NATURE OF NOTICE, REPORT, OR OTHER DATA

REQUEST FOR APPROVAL TO:

TEST WATER SHUT-OFF ☐
FRACTURE TREAT ☐
SHOOT OR ACIDIZE ☐
REPAIR WELL ☐
PULL OR ALTER CASING ☐
MULTIPLE COMPLETE ☐
CHANGE ZONES ☐
ABANDON* ☐
(other) See Below

SUBSEQUENT REPORT OF:

☐
☐
☐
☐
☐
☐
☐
☐
☐
☐



5. LEASE
SF-047039 (B)

6. IF INDIAN, ALLOTTEE OR TRIBE NAME

7. UNIT AGREEMENT NAME

8. FARM OR LEASE NAME

Day "J"

9. WELL NO.

3-J

10. FIELD OR WILDCAT NAME

11. SEC., T., R., M., OR BLK. AND SURVEY OR
p AREA Sec. 8-T28N-R10W
N.M.P.M.

12. COUNTY OR PARISH San Juan
13. STATE New Mexico

14. API NO.

15. ELEVATIONS (SHOW DF, KDB, AND WD)
5799'D.F. 5800'K.B.

NOTE: Report results of multiple completion or zone change on Form 9-330.)

17. DESCRIBE PROPOSED OR COMPLETED OPERATIONS (Clearly state all pertinent details, and give pertinent dates, including estimated date of starting any proposed work. If well is directionally drilled, give subsurface locations and measured and true vertical depths for all markers and zones pertinent to this work.)*

~~Change in Pool~~

~~FROM: Fulcher Kutz Pictured Cliffs~~
TO: Aztec Fruitland
Dedication Plat

Subsurface Safety Valve: Manu. and Type

FOR: PETROLEUM CORPORATION OF TEXAS

18. I hereby certify that the foregoing is true and correct.

SIGNED EWELL N. WALSH President, Walsh
Ewell N. Walsh, PE TITLE Engr. & Prod.

DATE 9/3/82

(This space for Federal or State office use)

APPROVED BY
CONDITIONS OF APPROVAL, IF ANY:

TITLE DATE

ACCEPTED FOR RECORD

SEP 09 1982

*See Instructions on Reverse Side

BY FFK

NMOCC

**NEW MEXICO OIL CONSERVATION COMMISSION
WELL LOCATION AND ACREAGE DEDICATION PLAT**

Form O-100
Supersedes C-128
Effective 1-1-85

All distances must be from the outer boundaries of the Section.

Operator Petroleum Corporation of Texas			Lease Day J		Well No. 3-J
Unit Letter P	Section 8	Township 28N	Range 10W	County San Juan	
Actual Footage Location of Wells					
790 feet from the South line and		790 feet from the East line			
Ground Level Elev. 5789	Producing Formation Fruitland	Pool Aztec Fruitland Ext.	Dedicated Acreage: E 127.75 Acres		

1. Outline the acreage dedicated to the subject well by colored pencil or hachure marks on the plat below.
2. If more than one lease is dedicated to the well, outline each and identify the ownership thereof (both as to working interest and royalty).
3. If more than one lease of different ownership is dedicated to the well, have the interests of all owners been consolidated by communitization, unitization, force-pooling, etc?

☐ Yes ☐ No If answer is "yes," type of consolidation _____

If answer is "no," list the owners and tract descriptions which have actually been consolidated. (Use reverse side of this form if necessary.) _____

No allowable will be assigned to the well until all interests have been consolidated (by communitization, unitization, forced-pooling, or otherwise) or until a non-standard unit, eliminating such interests, has been approved by the Commission.

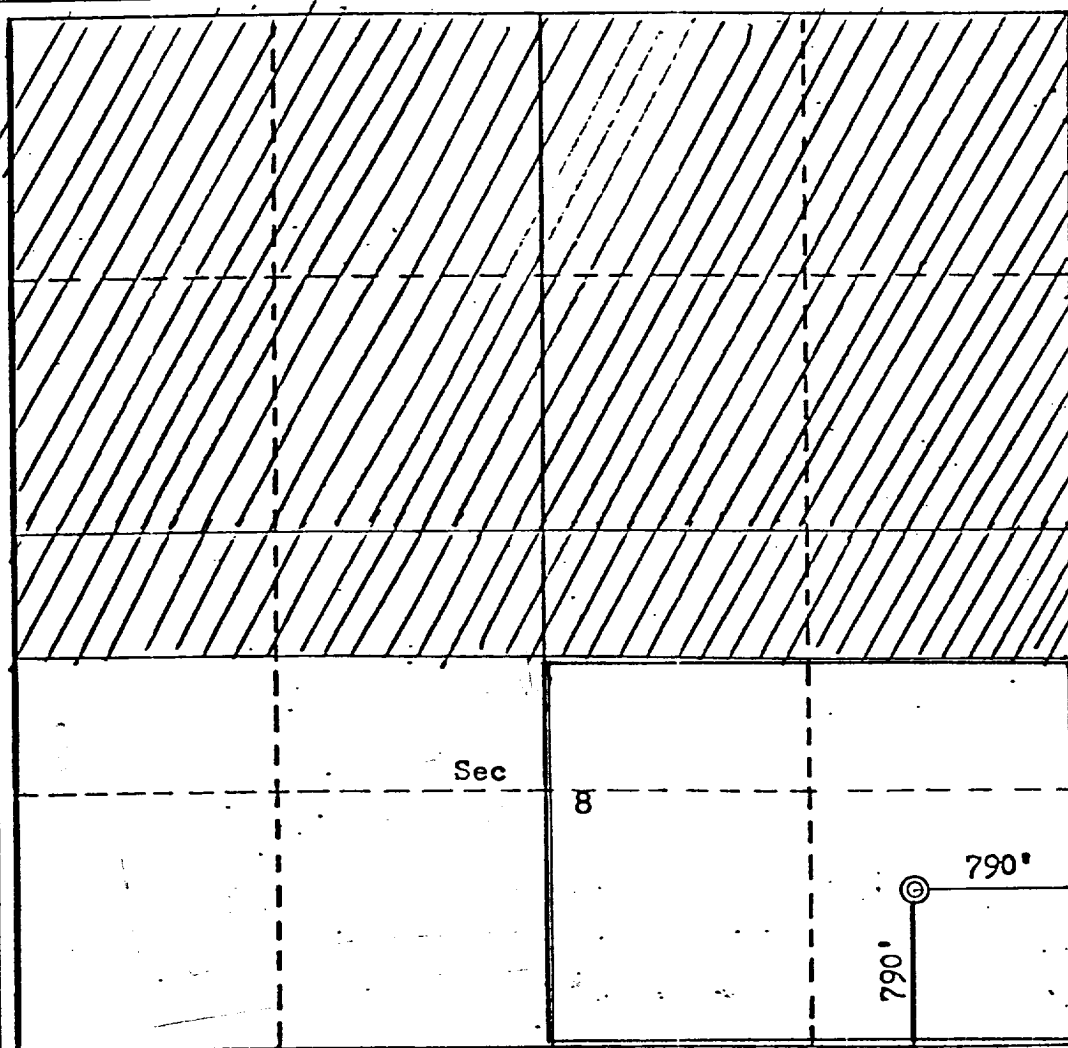

CERTIFICATION

I hereby certify that the information contained herein is true and complete to the best of my knowledge and belief.
FOR: PETROLEUM CORP. OF TEXAS

ORIGINAL SIGNED BY

Name **EWELL N. WALSH**
Ewell N. Walsh, P.E.

Position
President

Company
Walsh Engr. & Prod. Corp.

Date
9/3/82

I hereby certify that the well location shown on this plat was plotted from field notes of actual surveys made by me or under my supervision, and that the same is true and correct to the best of my knowledge and belief.

Date Surveyed
October 20, 1977

Registered Professional Engineer
and/or Land Surveyor

Fred B. Kerr
Fred B. Kerr

Certificate No.
3950

0 320 640 960 1280 1600 1920 2240 2560 2880 3200 3520 3840 4160 4480 4800 5120 5440 5760 6080 6400