

UNITED STATES
DEPARTMENT OF THE INTERIOR
GEOLOGICAL SURVEY

APPLICATION FOR PERMIT TO DRILL, DEEPEN, OR PLUG BACK

1a. TYPE OF WORK
DRILL ☒ DEEPEN ☐ PLUG BACK ☐

b. TYPE OF WELL
OIL WELL ☐ GAS WELL ☒ OTHER ☐ SINGLE ZONE ☒ MULTIPLE ZONE ☐

2. NAME OF OPERATOR
Petroleum Corporation of Texas Att: Mr. Fred Dueser

3. ADDRESS OF OPERATOR
P.O. Box 911 Breckenridge, Texas 76024

4. LOCATION OF WELL (Report location clearly and in accordance with any State requirements.)*
At surface 790' FNL, 790' FEL ✓
At proposed prod. zone Same

14. DISTANCE IN MILES AND DIRECTION FROM NEAREST TOWN OR POST OFFICE*

15. DISTANCE FROM PROPOSED* LOCATION TO NEAREST PROPERTY OR LEASE LINE, FT. (Also to nearest drlg. unit line, if any) 790'

16. NO. OF ACRES IN LEASE ---

17. NO. OF ACRES ASSIGNED TO THIS WELL 160.0

18. DISTANCE FROM PROPOSED LOCATION* TO NEAREST WELL, DRILLING, COMPLETED, OR APPLIED FOR, ON THIS LEASE, FT. 650'

19. PROPOSED DEPTH 2200

20. ROTARY OR CABLE TOOLS Rotary

21. ELEVATIONS (Show whether DF, RT, GR, etc.) 5801' GL

22. APPROX. DATE WORK WILL START* 2-1-78

5. LEASE DESIGNATION AND SERIAL NO. SF-047039 (B)

6. IF INDIAN, ALLOTTEE OR TRIBE NAME

7. UNIT AGREEMENT NAME

8. FARM OR LEASE NAME Day "H" ✓

9. WELL NO.

10. FIELD AND POOL, OR WILDCAT Pulcher Kutz Pictured Cliffs ✓

11. SEC., T., R., M., OR BLK. AND SURVEY OR AREA Sec. 17-T28N-R10W

12. COUNTY OR PARISH N.M.P.M.

13. STATE San Juan New Mexico ✓

23. PROPOSED CASING AND CEMENTING PROGRAM

SIZE OF HOLE	SIZE OF CASING	WEIGHT PER FOOT	SETTING DEPTH	QUANTITY OF CEMENT
12 1/4	8 5/8	24.0	100'	100 sxs
7 7/8	4 1/2	10.50	2200	To be determined

It is proposed to drill this well with rotary tools using drilling mud as a circulation medium through the Pictured Cliffs formation. All possible producing intervals in the Pictured Cliffs will be completed

ESTIMATED FORMATION TOPS.

Kirtland-1040'

Fruitland-1230'

Pictured Cliffs-1930'

The NE/4 of Section 17 is dedicated to this well. 160.00 Acres.
The natural gas from this well is committed.

IN ABOVE SPACE DESCRIBE PROPOSED PROGRAM: If proposal is to deepen or plug back, give data on present productive zone and proposed new productive zone. If proposal is to drill or deepen directionally, give pertinent data on subsurface locations and measured and true vertical depths. Give blowout preventer program, if any.

24. For: Petroleum Corporation of Texas

SIGNED Ewell N. Walsh, P.E.TITLE President, Walsh Engineering & Production Corp.DATE January 10, 1978

(This space for Federal or State office use)

PERMIT NO. _____ APPROVAL DATE _____

APPROVED BY _____ TITLE _____ DATE _____
CONDITIONS OF APPROVAL, IF ANY:

*See Instructions On Reverse Side

RECEIVED

JAN 11 1978

**NEW MEXICO OIL CONSERVATION COMMISSION
WELL LOCATION AND ACREAGE DEDICATION PLAT**

Form C-102
Supersedes C-128
Effective 1-1-65

All distances must be from the outer boundaries of the Section.

Operator Petroleum Corporation of Texas			Lease Day H		Well No. 2R
Unit Letter A	Section 17	Township 28N	Range 10W	County San Juan	
Actual Footage Location of Well:					
790 feet from the North line and		790 feet from the East line			
Ground Level Elev. 5801	Producing Formation Pictured Cliffs	Pool Fulcher Kutz P.C.		Dedicated Acreage: 160.0 Acres	

1. Outline the acreage dedicated to the subject well by colored pencil or hachure marks on the plat below.
2. If more than one lease is dedicated to the well, outline each and identify the ownership thereof (both as to working interest and royalty).
3. If more than one lease of different ownership is dedicated to the well, have the interests of all owners been consolidated by communitization, unitization, force-pooling, etc?

☐ Yes ☐ No If answer is "yes," type of consolidation _____

If answer is "no," list the owners and tract descriptions which have actually been consolidated. (Use reverse side of this form if necessary.) _____

No allowable will be assigned to the well until all interests have been consolidated (by communitization, unitization, forced-pooling, or otherwise) or until a non-standard unit, eliminating such interests, has been approved by the Commission.

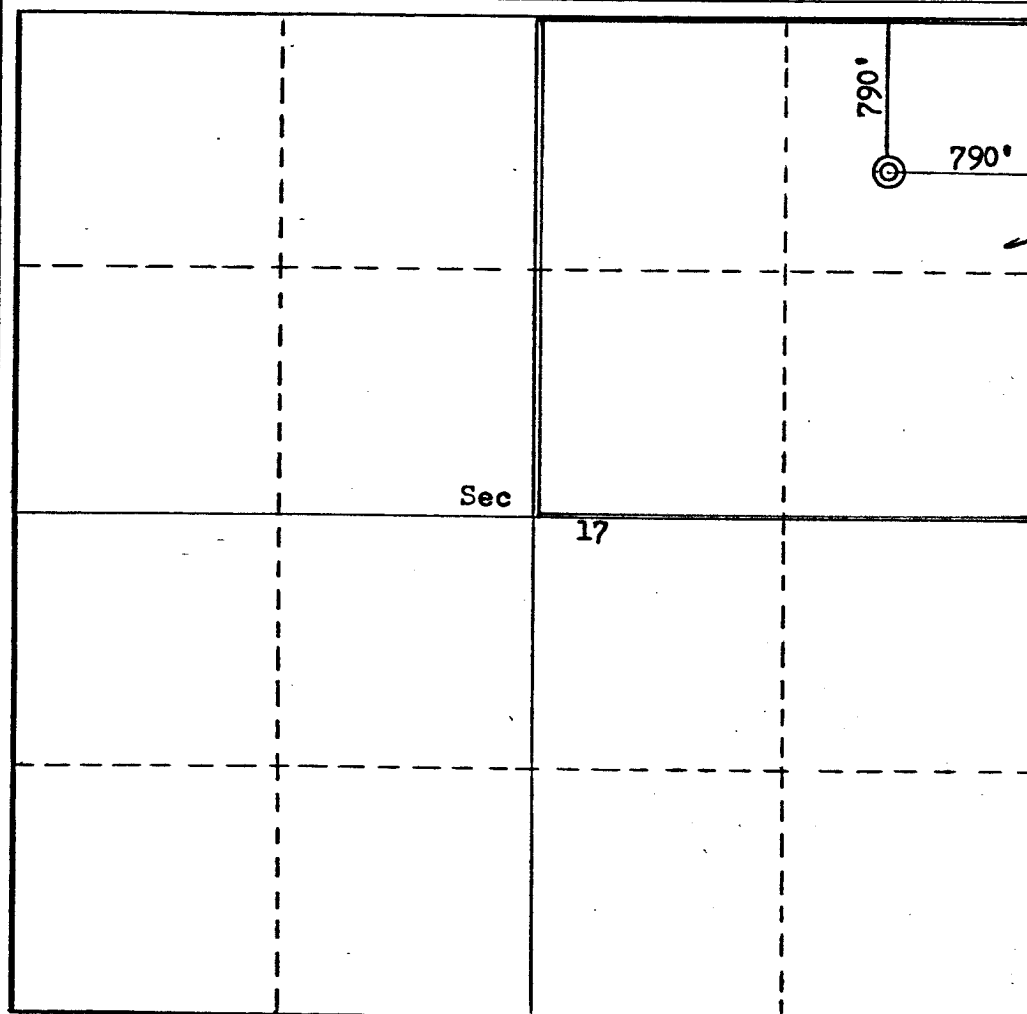

CERTIFICATION

I hereby certify that the information contained herein is true and complete to the best of my knowledge and belief.
For: **Petroleum Corp. of Texas**
[Signature]
Name **B. Walsh P.E.**
President

Position
Walsh Engineering & Production Corp
Company
January 10, 1978
Date

I hereby certify that the well location shown on this plat was plotted from field notes of actual surveys made by me or under my supervision, and that the same is true and correct to the best of my knowledge and belief.

Date Surveyed
October 20, 1977
Registered Professional Engineer and/or Land Surveyor
[Signature]
Fred B. Kerr Jr.

Certificate No.
3950

