

MERRION & BAYLESS
NTL-6 REQUIREMENTS

BIMSON #2
Section 17, T28N, R10W
San Juan County, New Mexico

- 1 & 2. A topographical map is attached showing location of drillsite and access roads to location. The terrain is relatively flat and no new roads will be built. A drive-in, truck-mounted drilling rig will be used and will be driven in to the location with our road work.
3. Wells within one mile radius are shown on the topographical map.
4. There are no existing or proposed facilities.
5. Water will be hauled from the San Juan River by truck.
6. No construction materials will be used.
7. Drill cuttings will be placed in a pit and covered when dry and location will be cleaned after work on well is completed.
8. No ancillary facilities.
9. Wellsite layout attached.
10. Restoration of drillsite -- pits will be filled and leveled and area reseeded to BLM specifications.
11. Other information: the drillsite is fairly level, arid land with very little vegetation. There is no other surface use or facilities existent. An archeological survey statement will be furnished.
12. Operator representative:

Robert L. Bayless
P.O. Box 1541
Farmington, NM 87401
Office Phone: 325-5093
Home Phone: 325-8985

13. Certification:

I hereby certify that I, or persons under my direct supervision, have inspected the proposed drillsite and access route; that I am familiar with the conditions which presently exist; that the statements made in this plan are, to the best of my knowledge, true and correct; and, that the work associated with the operations proposed herein will be performed by MERRION & BAYLESS and its contractors and subcontractors in conformity with this plan and the terms and conditions under which it is approved.

01-27-78
DATE

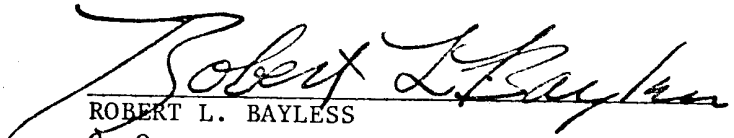
ROBERT L. BAYLESS
Co-Owner

LOCATION AND EQUIPMENT LOG

Sheet

MERRION & BAYLESS
Bimson #2
Section 17, T28N, R10W
San Juan County, New Mexico

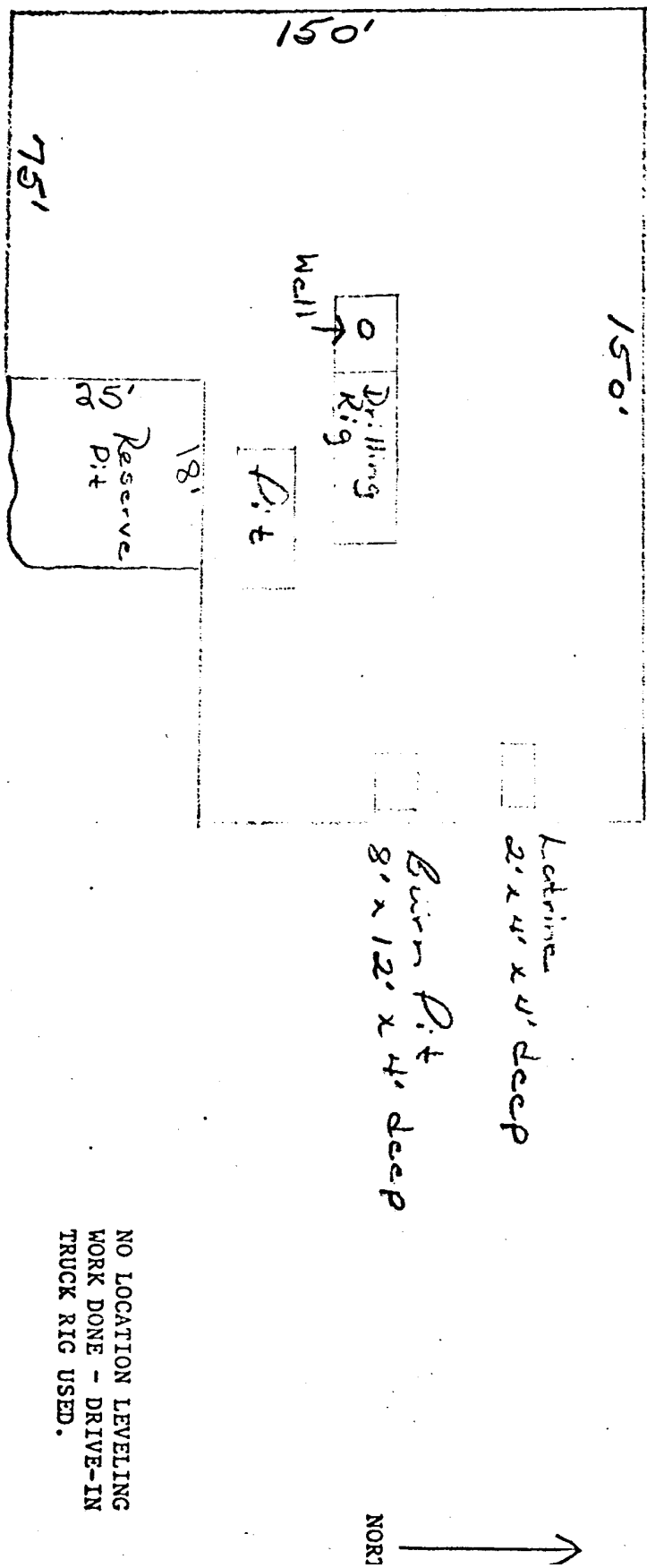

NO LOCATION LEVELING
WORK DONE - DRIVE-IN
TRUCK RIG USED.

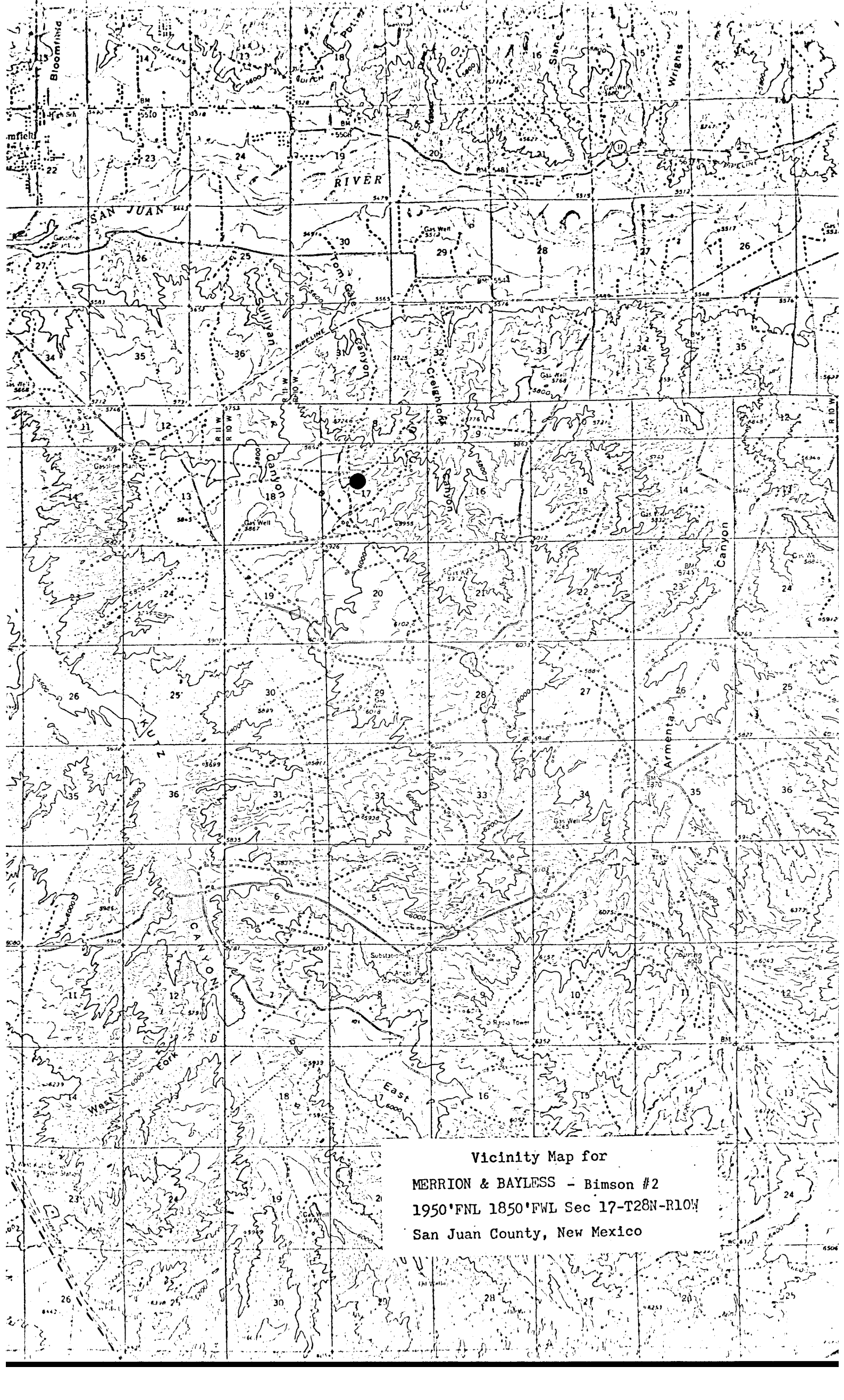

Vicinity Map for
MERRION & BAYLESS - Bimson #2
1950'FNL 1850'FWL Sec 17-T28N-R10W
San Juan County, New Mexico