

UNITED STATES
DEPARTMENT OF THE INTERIOR
GEOLOGICAL SURVEY

30-095-25969

APPLICATION FOR PERMIT TO DRILL, DEEPEN, OR PLUG BACK

1a. TYPE OF WORK
DRILL ☒ DEEPEN ☐ PLUG BACK ☐

b. TYPE OF WELL
OIL WELL ☒ GAS WELL ☐ OTHER ☐ SINGLE ZONE ☐ MULTIPLE ZONE ☐

2. NAME OF OPERATOR
Union Texas Petroleum Corporation

3. ADDRESS OF OPERATOR
P.O. Box 808, Farmington, New Mexico 87401

4. LOCATION OF WELL (Report location clearly and in accordance with any State requirements.)*
At surface
1800 ft./South line and 1845 ft./West line

At proposed prod. zone

Same as above

14. DISTANCE IN MILES AND DIRECTION FROM NEAREST TOWN OR POST OFFICE*
7-1/2 miles Southeast of Bloomfield, New Mexico, 87413

15. DISTANCE FROM PROPOSED*
LOCATION TO NEAREST
PROPERTY OR LEASE LINE, FT.
(Also to nearest drlg. unit line, if any) 380 ft.
380 ft.

18. DISTANCE FROM PROPOSED LOCATION*
TO NEAREST WELL, DRILLING, COMPLETED,
OR APPLIED FOR, ON THIS LEASE, FT.
535 ft.

21. ELEVATIONS (Show whether DF, RT, GR, etc.)

5664 ft.

23. PROPOSED CASING AND CEMENTING PROGRAM

SIZE OF HOLE	SIZE OF CASING	WEIGHT PER FOOT	SETTING DEPTH	QUANTITY OF CEMENT
13-3/4"	10-3/4" K55	40.50	300	240 cu. ft. (Circulated)
9-7/8"	7-5/8" K55	26.40	4900	1460 cu. ft. (Cover the Ojo Alamo)
6-3/4"	5-1/2" J55	15.50	4700' to 6161'	160 cu. ft. (Top of the liner)

We desire to drill 13-3/4" surface hole to approx. 300 ft. using natural mud as a circulating medium. Run new 10-3/4" csg. to T.D. Cement with approx. 240 cu. ft. of Class "B" cement circulated to the surface. Pressure test the casing to approx. 800 PSIG for 10 minutes. Drill 9-7/8" hole to approx. 4900 ft. using a starch base, permaloid, non-dispersed mud as the circulating medium. Log the well. Run new 7-5/8" casing to T.D. with a D.V. tool at approx. 2000 ft. Cement 1st stage w/ approx. 616 cu. ft. of 65/35/6 followed by approx. 100 cu. ft. of Class "B" cement. Cement the second stage w/ approx. 630 cu. ft. 65/35/12 followed by approx. 100 cu. ft. of Class "B" cement to cover the Ojo Alamo zone. Drill out the D.V. tool. Pressure test the pipe to 1500 PSIG for 10 minutes. Drill out with 6-3/4" bit to approx. 616 ft. using natural gas as the circulating medium. Log the well. Run new 5-1/2" casing to T.D. and cement w/approx. 160 cu. ft. of 50/50 poz. mix. W.O.C. Perforate and fracture the Gallup zone. Clean the well up. Run new 2-3/8" E.U.E., 4.7#, J55 tbg. to the Gallup zone. Run rod pump and rods. Set a pumping unit and tanks. Test the well and connect to a gathering system.

The gas from this well has previously been dedicated to a transporter.

IN ABOVE SPACE DESCRIBE PROPOSED PROGRAM: If proposal is to deepen or plug back, give data on present productive zone and proposed new productive zone. If proposal is to drill or deepen directionally, give pertinent data on subsurface locations and measured and true vertical depths. Give blowout preventer program, if any.

24. SIGNED RUDY D. MOTTO TITLE Field Operations Manager DATE September 10, 1982

(This space for Federal or State office use)

PERMIT NO. _____ APPROVAL DATE _____

APPROVED BY _____ TITLE _____
CONDITIONS OF APPROVAL, IF ANY:

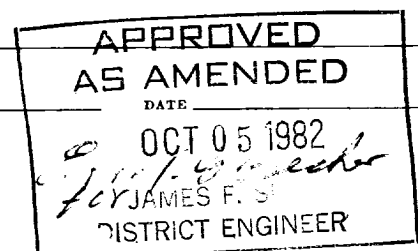

RECEIVED

All distances must be from the outer boundaries of the Section.

Lease ZACHRY			Well No. 38	
UNITED TEXAS PETROLEUM CORP.				
Unit Letter K	Section 12	Township 28 NORTH	Range 10 WEST	County San Juan
Actual Well Location of Well:				
1800 feet from the SOUTH		line and 1845	feet from the WEST	
Ground Level Elev. 5664	Producing Formation GALLUP	Pool Armenta Extension	Dedicated Acres: Lot 3 27.88 Acres	

1. Outline the acreage dedicated to the subject well by colored pencil or hatchure marks on the plat below.
2. If more than one lease is dedicated to the well, outline each and identify the ownership thereof (both as to working interest and royalty).
3. If more than one lease of different ownership is dedicated to the well, have the interests of all owners been consolidated by communitization, unitization, force-pooling, etc?

☐ Yes ☒ No If answer is "yes," type of consolidation _____

If answer is "no," list the owners and tract descriptions which have actually been consolidated. (Use reverse side of this form if necessary.) _____

No allowable will be assigned to the well until all interests have been consolidated (by communitization, unitization, forced-pooling, or otherwise) or until a non-standard unit, eliminating such interests, has been approved by the Division.

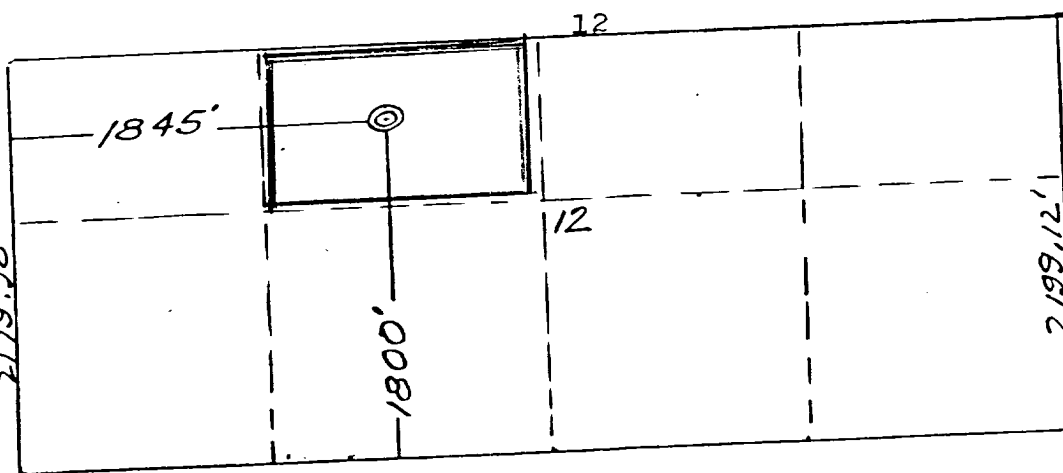

CERTIFICATION

I hereby certify that the information contained herein is true and complete to the best of my knowledge and belief.

Name
Rudy D. Motto

Position
Field Operations Manager

Company
Union Texas Petroleum

Date
August 1, 1982

I hereby certify that the well location shown on this plat is plotted from the notes of actual surveys made under the supervision of the State of New Mexico and is true and correct to the best of my knowledge and belief.

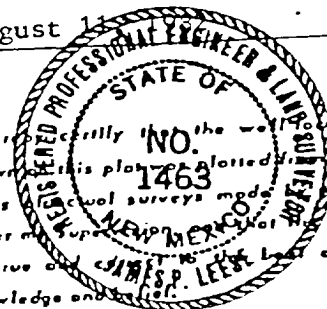

Date Surveyed
July 28, 1982

Registered Professional Engineer and/or Land Surveyor
James P. Lease

Certificate No.
1463

UNION TEXAS PETROLEUM CORP.
Zachry #38
NE $\frac{1}{4}$ SW $\frac{1}{4}$, Sec. 12, T28N, R10W, NMPM
San Juan County, New Mexico

