

UNITED STATES
DEPARTMENT OF THE INTERIOR
GEOLOGICAL SURVEY

APPLICATION FOR PERMIT TO DRILL, DEEPEN, OR PLUG BACK

1a. TYPE OF WORK DRILL <input checked="" type="checkbox"/> DEEPEN <input type="checkbox"/> PLUG BACK <input type="checkbox"/>		5. LEASE DESIGNATION AND SERIAL NO. SF-077085
b. TYPE OF WELL OIL WELL <input type="checkbox"/> GAS WELL <input checked="" type="checkbox"/> OTHER <input type="checkbox"/> SINGLE ZONE <input checked="" type="checkbox"/> MULTIPLE ZONE <input type="checkbox"/>		6. IF INDIAN, ALLOTTEE OR TRIBE NAME
2. NAME OF OPERATOR Tenneco Oil Company		7. UNIT AGREEMENT NAME
3. ADDRESS OF OPERATOR Box 3249, Englewood, CO 80155		8. FARM OR LEASE NAME Omler A
4. LOCATION OF WELL (Report location clearly and in accordance with any State requirements.) At surface 790' FNL, 1850' FEL At proposed prod. zone Same		9. WELL NO. 17
14. DISTANCE IN MILES AND DIRECTION FROM NEAREST TOWN OR POST OFFICE* 5 miles South of Blanco, NM		10. FIELD AND POOL OR WILDCAT Harris Mesa Field Ext.
15. DISTANCE FROM PROPOSED* LOCATION TO NEAREST PROPERTY OR LEASE LINE, FT. (Also to nearest drlg. unit line, if any) 790'	16. NO. OF ACRES IN LEASE 2240	11. SEC., T., R., M., OR BLK. AND SURVEY OR AREA Sec. 26, T28N, R10W
18. DISTANCE FROM PROPOSED LOCATION* TO NEAREST WELL, DRILLING, COMPLETED, OR APPLIED FOR, ON THIS LEASE, FT.	19. PROPOSED DEPTH 3040'	12. COUNTY OR PARISH San Juan
21. ELEVATIONS (Show whether DF, RT, GR, etc.) 5748' gr		13. STATE NM
20. ROTARY OR CABLE TOOLS Rotary		17. NO. OF ACRES ASSIGNED TO THIS WELL 160
22. APPROX. DATE WORK WILL START* ASAP		

23. PROPOSED CASING AND CEMENTING PROGRAM				
SIZE OF HOLE	SIZE OF CASING	WEIGHT PER FOOT	SETTING DEPTH	QUANTITY OF CEMENT
12-1/4"	9-5/8"	36#	+ 260'	Circ to surface
7-7/8"	4-1/2"	10.5#	- 3040'	Circ to surface

See attached drilling procedure

Gas is dedicated

IN ABOVE SPACE DESCRIBE PROPOSED PROGRAM: If proposal is to deepen or plug back, give data on present productive zone and proposed new productive zone. If proposal is to drill or deepen directionally, give pertinent data on subsurface locations and measured and true vertical depths. Give blowout preventer program, if any.

24. SIGNED Ken Russell TITLE Sr. Production Analyst DATE November 1, 1982
(This space for Federal or State office use)

PERMIT NO. _____ APPROVAL DATE _____
APPROVED BY _____ TITLE _____
CONDITIONS OF APPROVAL, IF ANY: _____

APPROVED
AS AMENDED

DEC 22 1982
JAMES F. SIMS
DISTRICT ENGINEER

Date Surveyed August 31, 1982
Registered Professional Engineer and Land Surveyor Fred B. Kerr Jr.
Certificate No. 4220

OIL CONSERVATION DIVISION

P. O. BOX 2088

SANTA FE, NEW MEXICO 87501

Form C-107
Revised 10-1-78

STATE OF NEW MEXICO
ENERGY AND MINERALS DEPARTMENT

All distances must be from the outer boundaries of the Section.

Operator TENNECO OIL COMPANY			Lease OMLER A		Well No. 17
Unit Letter B	Section 26	Township 28N	Range 10W	County San Juan	
Actual Footage Location of Well:					
790 feet from the North line and 1850 feet from the East line					
Ground Level Elev. 5748	Producing Formation Chacra	Pool Undesignated Chacra	Dedicated Acreage: 160 Acres		

1. Outline the acreage dedicated to the subject well by colored pencil or hachure marks on the plat below.
2. If more than one lease is dedicated to the well, outline each and identify the ownership thereof (both as to working interest and royalty).
3. If more than one lease of different ownership is dedicated to the well, have the interests of all owners been consolidated by communitization, unitization, force-pooling, etc?

☐ Yes ☐ No If answer is "yes," type of consolidation _____

If answer is "no," list the owners and tract descriptions which have actually been consolidated. (Use reverse side of this form if necessary.) _____

No allowable will be assigned to the well until all interests have been consolidated (by communitization, unitization, forced-pooling, or otherwise) or until a non-standard unit, eliminating such interests, has been approved by the Commission.

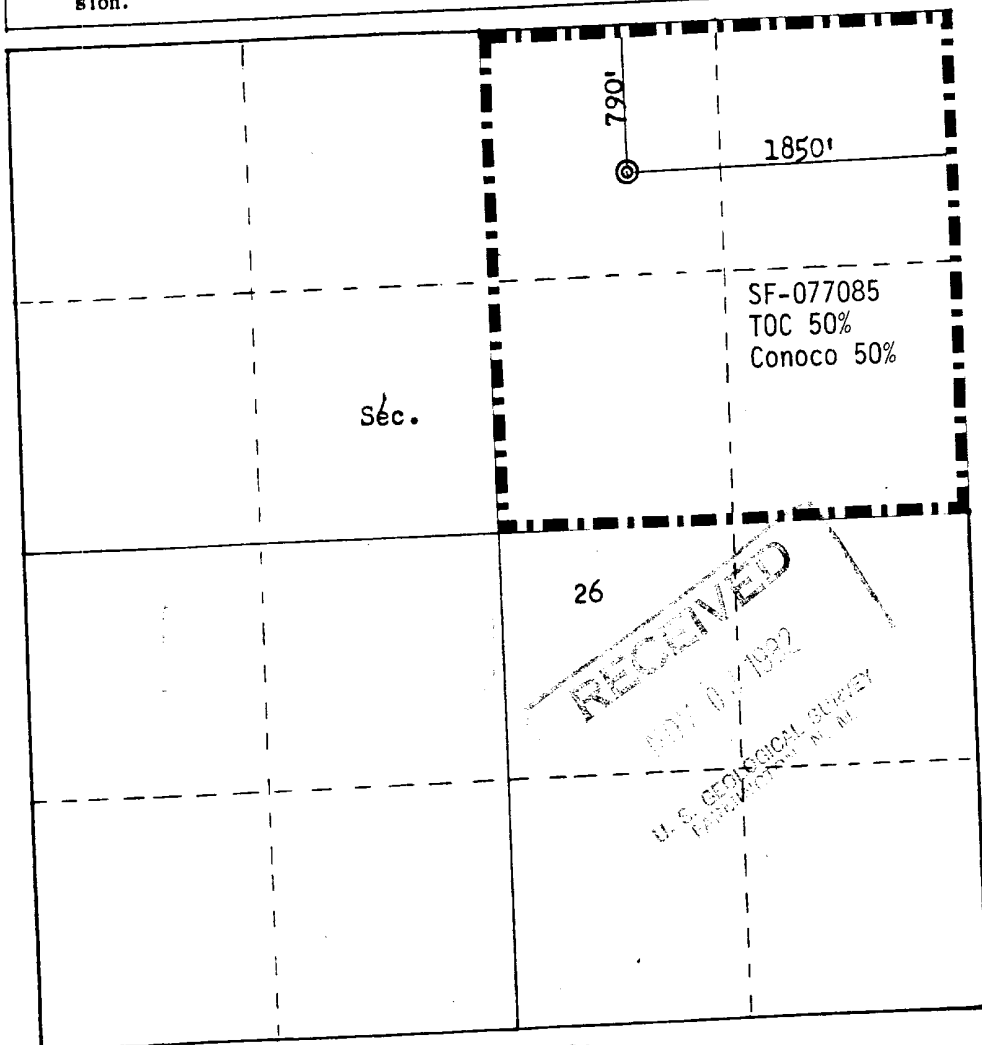

CERTIFICATION

I hereby certify that the information contained herein is true and complete to the best of my knowledge and belief.

Name

Ken Russell

Position

Sr. Production Analyst

Company

Tenneco Oil Co.

Date

November 1, 1982

I hereby certify that the well location shown on this plat was plotted from field notes of actual surveys made by me or under my supervision, and that the same is true and correct to the best of my knowledge and belief.

Date Surveyed

August 31, 1982

Registered Professional Engineer and Land Surveyor

Fred B. Kerr Jr.

Certificate No.

3950