

Form 9-331a  
(Feb. 1951)

cc: Oil Conservation Comm.  
Aztec, N. M. (2)  
Benson and Montin  
Oklahoma City

(SUBMIT IN TRIPLICATE)

UNITED STATES  
DEPARTMENT OF THE INTERIOR  
GEOLOGICAL SURVEY

Land Office Santa Fe  
Lease No. 600044  
Unit West Kutz Field

## SUNDRY NOTICES AND REPORTS ON WELLS

NOTICE OF INTENTION TO DRILL.....	<input checked="" type="checkbox"/>	SUBSEQUENT REPORT OF WATER SHUT-OFF.....	
NOTICE OF INTENTION TO CHANGE PLANS.....		SUBSEQUENT REPORT OF SHOOTING OR ACIDIZING.....	
NOTICE OF INTENTION TO TEST WATER SHUT-OFF.....		SUBSEQUENT REPORT OF ALTERING CASING.....	
NOTICE OF INTENTION TO RE-DRILL OR REPAIR WELL.....		SUBSEQUENT REPORT OF REDRILLING OR REPAIR.....	
NOTICE OF INTENTION TO SHOOT OR ACIDIZE.....		SUBSEQUENT REPORT OF ABANDONMENT.....	
NOTICE OF INTENTION TO PULL OR ALTER CASING.....		SUPPLEMENTARY WELL HISTORY.....	
NOTICE OF INTENTION TO ABANDON WELL.....			

(INDICATE ABOVE BY CHECK MARK NATURE OF REPORT, NOTICE, OR OTHER DATA)

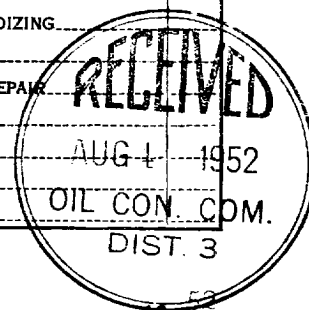

July 15, 1952

( Rhodes )

Well No. 2 is located 990 ft. from N line and 990 ft. from E line of sec. 31

SW/4 31 23N 11E R. 1N

(1/4 Sec. and Sec. No.) (Twp.) (Range) (Meridian)

West Kutz San Juan New Mexico

(Field) (County or Subdivision) (State or Territory)

The elevation of the derrick floor above sea level is \_\_\_\_\_ ft. Not available - will furnish later.

### DETAILS OF WORK

(State names of and expected depths to objective sands; show sizes, weights, and lengths of proposed casings; indicate mudding jobs, cementing points, and all other important proposed work)

Pictured Cliffs sand test. Estimated depth 1700'.  
Surface Casing: 90' of 33# 10 3/4" - Cemented to the surface.  
Production Casing: 1600' of 14# 5 1/2" - Cemented with 100 sacks.  
If commercial production is indicated, the producing section will be shot with nitroglycerin.

SW/4 of Section 31 - Designated Unit.

I understand that this plan of work must receive approval in writing by the Geological Survey before operations may be commenced.

Company BENSON AND MONTIN

Address 3154 N. Main St.

Barnington, N. M.

By Albert R. Greer  
Title Field Sup't.

Company Benson-Montin

Lease 80844 Well No. 2

Sec. 31 T. 28 N., R. 11 W., N.M.P.M.

Location 990' from the South line and 990' from  
the West line.

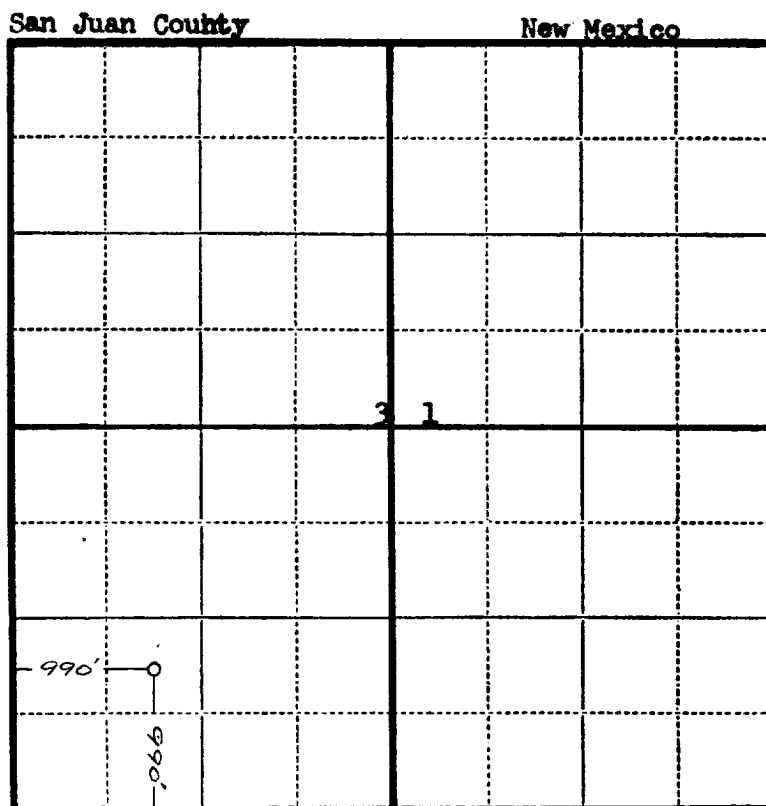

Scale—4 inches equals 1 mile.

This is to certify that the above plat was prepared from field notes of actual surveys made by me or under my supervision and that the same are true and correct to the best of my knowledge and belief.

*Charles J. Finklea*

Seal:

Registered Professional  
Engineer and Land Surveyor.

Charles J. Finklea  
N. Mex. Reg. No. 1302

Surveyed April 10, 1952