

cc: Oil Conservation Commission **SUBMIT IN TRIPLICATE**

Axtos, N. M. (2)

Benson & Montin

Oklahoma City

UNITED STATES

DEPARTMENT OF THE INTERIOR

GEOLOGICAL SURVEY

Land Office Santa Fe

Lease No. 078903

Unit West Kutz Field

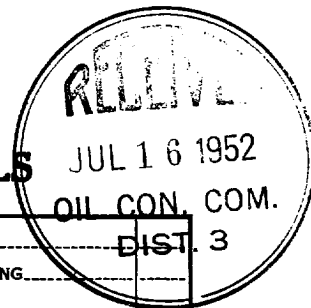

SUNDRY NOTICES AND REPORTS ON WELLS

NOTICE OF INTENTION TO DRILL.....	<input checked="" type="checkbox"/>	SUBSEQUENT REPORT OF WATER SHUT-OFF.....	
NOTICE OF INTENTION TO CHANGE PLANS.....		SUBSEQUENT REPORT OF SHOOTING OR ACIDIZING.....	
NOTICE OF INTENTION TO TEST WATER SHUT-OFF.....		SUBSEQUENT REPORT OF ALTERING CASING.....	
NOTICE OF INTENTION TO RE-DRILL OR REPAIR WELL.....		SUBSEQUENT REPORT OF REDRILLING OR REPAIR.....	
NOTICE OF INTENTION TO SHOOT OR ACIDIZE.....		SUBSEQUENT REPORT OF ABANDONMENT.....	
NOTICE OF INTENTION TO PULL OR ALTER CASING.....		SUPPLEMENTARY WELL HISTORY.....	
NOTICE OF INTENTION TO ABANDON WELL.....			

(INDICATE ABOVE BY CHECK MARK NATURE OF REPORT, NOTICE, OR OTHER DATA)

_____ July 6 _____, 1952
(Payne)
Well No. 7 is located 990 ft. from XX line and 990 ft. from W line of sec. 35
SW/4 35 28N 12W NMPM
(1/4 Sec. and Sec. No.) (Twp.) (Range) (Meridian)
West Kutz Field (= X) San Juan New Mexico
(Field) (County or Subdivision) (State or Territory)

The elevation of the derrick floor above sea level is _____ ft. **Not available -**
Will furnish later.

DETAILS OF WORK

(State names of and expected depths to objective sands; show sizes, weights, and lengths of proposed casings; indicate mudding jobs, cementing points, and all other important proposed work)

Picture Cliffs sand test.
Estimated depth 1600'

Surface Casing: 90' of 32# 10 3/4"
Production Casing: 1600' of 14# 5 1/2"
If commercial production is indicated, the producing section will be shot with nitroglycerin.

I understand that this plan of work must receive approval in writing by the Geological Survey before operations may be commenced.

Company BENSON AND MONTIN

Address 315 1/2 W. Main St.
Farmington, N. M.

By Albert R. Greer
Albert R. Greer
Title Field Sup't.

100-100000

100-100000

100-100000

100-100000

UNITED STATES
DEPARTMENT OF JUSTICE
BUREAU OF INVESTIGATION
WASHINGTON, D. C.

UNITED STATES DEPARTMENT OF JUSTICE

TO THE HONORABLE ATTORNEY GENERAL
FROM THE DIRECTOR, BUREAU OF INVESTIGATION
SUBJECT: [Illegible]

RE: [Illegible]

1. [Illegible]

2. [Illegible]

3. [Illegible]

4. [Illegible]

5. [Illegible]

6. [Illegible]

7. [Illegible]

8. [Illegible]

9. [Illegible]

10. [Illegible]

11. [Illegible]

12. [Illegible]

13. [Illegible]

14. [Illegible]

15. [Illegible]

16. [Illegible]

17. [Illegible]

18. [Illegible]

19. [Illegible]

20. [Illegible]



Company Benson-Montin
Lease 078903 Well No. 7
Sec. 35 T. 28 N., R. 12 W., N.M.P.M.
Location 990' from the South line and 990' from
the West line.

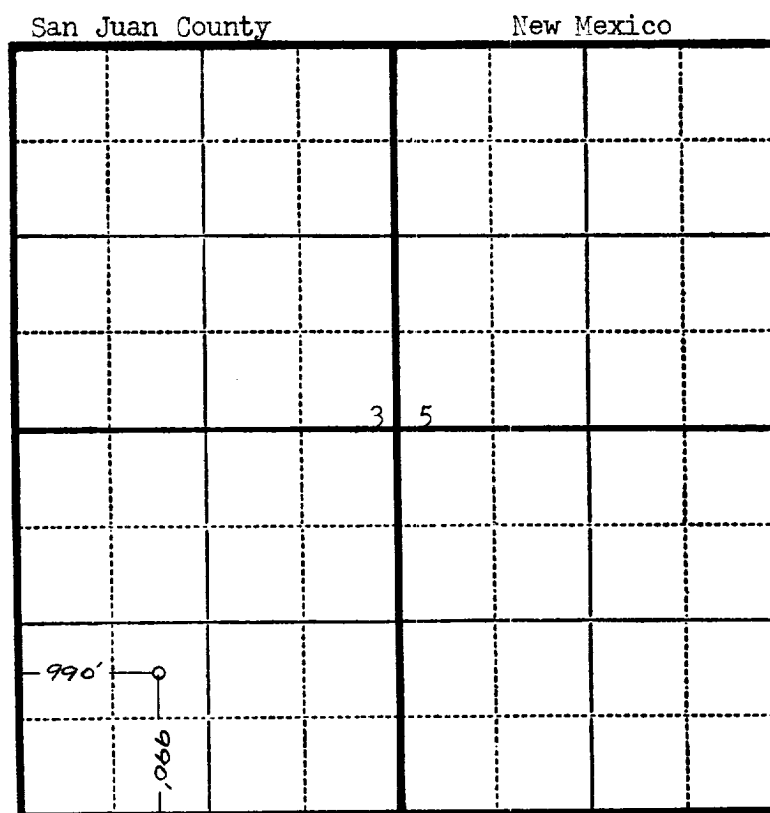

Scale—4 inches equals 1 mile.

This is to certify that the above plat was prepared from field notes of actual surveys made by me or under my supervision and that the same are true and correct to the best of my knowledge and belief.

Seal:

Charles J. Finklea
Registered Professional
Engineer and Land Surveyor.

Charles J. Finklea
N. Mex. Reg. No. 1302

Surveyed April 11, 19 52