

(SUBMIT IN TRIPLICATE)

UNITED STATES  
DEPARTMENT OF THE INTERIOR  
GEOLOGICAL SURVEY

Indian Agency \_\_\_\_\_  
**Navajo Tribe**  
Allottee \_\_\_\_\_  
Lease No. **I-149-222-0470**

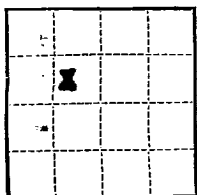

SUNDRY NOTICES AND REPORTS ON WELLS

NOTICE OF INTENTION TO DRILL		SUBSEQUENT REPORT OF WATER SHUT-OFF	
NOTICE OF INTENTION TO CHANGE PLANS	<input checked="" type="checkbox"/>	SUBSEQUENT REPORT OF SHOOTING OR ACIDIZING	
NOTICE OF INTENTION TO TEST WATER SHUT-OFF		SUBSEQUENT REPORT OF ALTERING CASING	
NOTICE OF INTENTION TO REDRILL OR REPAIR WELL		SUBSEQUENT REPORT OF REDRILLING OR REPAIR	
NOTICE OF INTENTION TO SHOOT OR ACIDIZE		SUBSEQUENT REPORT OF ABANDONMENT	
NOTICE OF INTENTION TO PULL OR ALTER CASING		SUPPLEMENTARY WELL HISTORY	
NOTICE OF INTENTION TO ABANDON WELL			

(INDICATE ABOVE BY CHECK MARK NATURE OF REPORT, NOTICE, OR OTHER DATA)

**Farmington, New Mexico February 10, 1964**

**Gallegos Canyon Unit - Dakota**

Well No. **139** is located **1745** ft. from **[N]** line and **1545** ft. from **[W]** line of sec. **31**

**SE/4 NW/4 Section 31**  
(1/4 Sec. and Sec. No.)

**T-28-N.**  
(Twp.)

**R-12-W**  
(Range)

**N.M.P.M.**  
(Meridian)

**Basin Dakota**  
(Field)

**San Juan**  
(County or Subdivision)

**New Mexico**  
(State or Territory)

The elevation of the derrick floor above sea level is \_\_\_\_\_ ft. (To be reported later.)

DETAILS OF WORK

(State names of and expected depths to objective sands; show sizes, weights, and lengths of proposed casings; indicate mudding jobs, cementing points, and all other important proposed work)

Reference our "Notice of Intention to Drill" dated February 6, 1964. This Sundry Notice filed to correct location as shown above and on attached Form G-128, "Well Location and Average Deduction Plot."

*Correction*

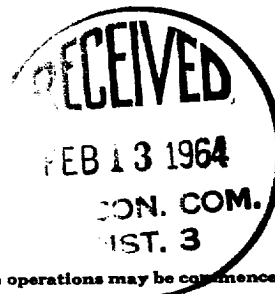

I understand that this plan of work must receive approval in writing by the Geological Survey before operations may be commenced.

Company **Pan American Petroleum Corporation**

Address **P. O. Box 429**

**Farmington, New Mexico**

**Fred L. Nabors, District Engineer**

By **ORIGINAL SIGNED BY F. H. HOLLINGSWORTH**

Title \_\_\_\_\_

Well Information and Location (Section 3)

Section 3

FEBRUARY 10, 1964

Operator PAN AMERICAN PETROLEUM CORPORATION

GALLEGOS CANYON UNIT

Well No. 159 Unit Letter F Section 31

Location 1765 Feet From HEALTH 1585

County SAN JUAN G. L. Edwards REPORT LATER

Name of Producing Formation DAKOTA

28 NORTH 12 WEST, NMPM

304 Acres

1. Is the operator the only owner in the oil and gas interests of the well?

Yes ☒ No ☐2. If the answer to question one is "No", have the interests of the owners been consolidated by formalization of interest? Yes ☒ No ☐

Gallegos Canyon Unit

3. If the answer to question two is "No", list all the names and their respective interests in the well:

Owner

Each Deed Interest

Section 3

Section 3, 11 stations, 1765 feet from corner of section 31.

This is to certify that the information is being furnished is true and complete to the best of my knowledge and belief.

PAN AMERICAN PETROLEUM CORP.

F. H. Hollingsworth

P. O. Box 480

Farmington, New Mexico

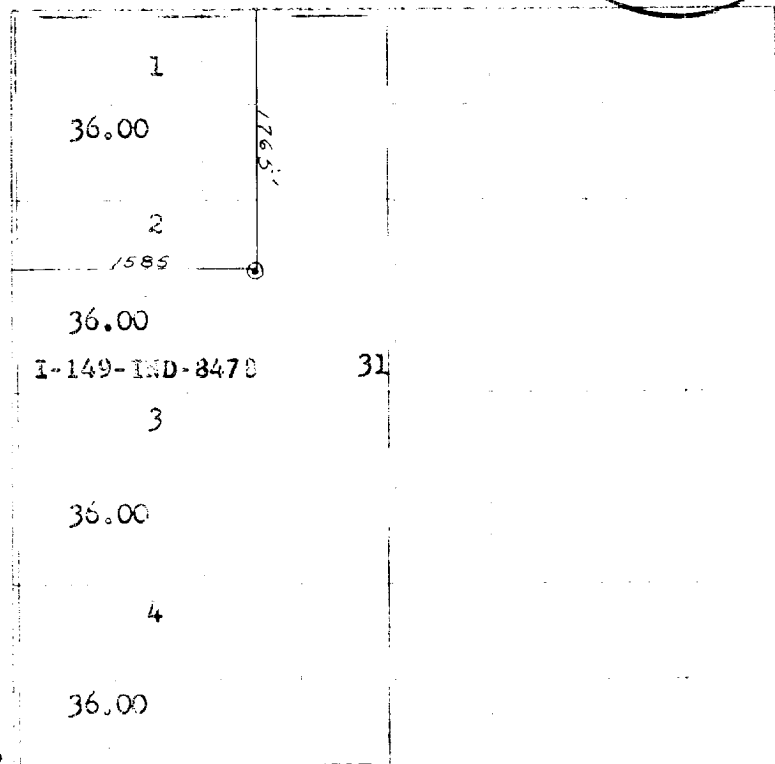

Ref: GLO Plat dated July 19, 1915

0 10 20 30 40 50 60 70 80 90 100 110 120 130 140 150 160 170 180 190 200 210 220 230 240 250 260 270 280 290 300 310 320 330 340 350 360 370 380 390 400 410 420 430 440 450 460 470 480 490 500 510 520 530 540 550 560 570 580 590 600 610 620 630 640 650 660 670 680 690 700 710 720 730 740 750 760 770 780 790 800 810 820 830 840 850 860 870 880 890 900 910 920 930 940 950 960 970 980 990 1000

Scale 4 inches equal 1 mile

I hereby certify that the above was prepared from field notes of actual surveys made by me or under my supervision and that the same are true and correct to the best of my knowledge and belief.

Date Surveyed 25 January 1964

James P. Leese  
Registered Engineer and/or Land Surveyor  
New Mexico Reg. No. 1463

Farmington, New Mexico