

Form 9-331a  
(Feb. 1951)

cc: Oil Conservation Comm. (SUBMIT IN TRIPLICATE)  
Aztec, N. M. (2)  
Benson & Montin  
Okla. City

UNITED STATES  
DEPARTMENT OF THE INTERIOR  
GEOLOGICAL SURVEY

Land Office Santa Fe  
Lease No. 6678903  
Unit \_\_\_\_\_

## SUNDRY NOTICES AND REPORTS ON WELLS

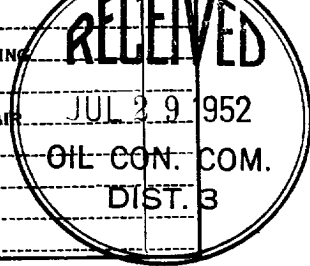
NOTICE OF INTENTION TO DRILL	<input checked="" type="checkbox"/>	SUBSEQUENT REPORT OF WATER SHUT-OFF	
NOTICE OF INTENTION TO CHANGE PLANS		SUBSEQUENT REPORT OF SHOOTING OR ACIDIZING	
NOTICE OF INTENTION TO TEST WATER SHUT-OFF		SUBSEQUENT REPORT OF ALTERING CASING	
NOTICE OF INTENTION TO RE-DRILL OR REPAIR WELL		SUBSEQUENT REPORT OF REDRILLING OR REPAIR	
NOTICE OF INTENTION TO SHOOT OR ACIDIZE		SUBSEQUENT REPORT OF ABANDONMENT	
NOTICE OF INTENTION TO PULL OR ALTER CASING		SUPPLEMENTARY WELL HISTORY	
NOTICE OF INTENTION TO ABANDON WELL			

(INDICATE ABOVE BY CHECK MARK NATURE OF REPORT, NOTICE, OR OTHER DATA)

July 15, 1952

(Payne)  
Well No. 6 is located 1650 ft. from N line and 980 ft. from E line of sec. 35

NE/4 35 28N 12W NDPM  
(4 Sec. and Sec. No.) (Twp.) (Range) (Meridian)  
West Kutz (ext) San Juan New Mexico  
(Field) (County or Subdivision) (State or Territory)

The elevation of the derrick floor above sea level is \_\_\_\_\_ ft. **Not available - will furnish later.**

### DETAILS OF WORK

(State names of and expected depths to objective sands; show sizes, weights, and lengths of proposed casings; indicate mudding jobs, cement-pictured cliffs ~~SAND~~ and all other important proposed work)

Estimated depth - 1600'

Surface Casing: 90' of 3 3/4" - Cemented to surface.  
Production Casing: 1600' of 14 1/2" - Cemented with 100 sacks.  
If commercial production is indicated, the producing section will be shot with nitroglycerin.

I understand that this plan of work must receive approval in writing by the Geological Survey before operations may be commenced.

Company BENSON AND MONTIN  
Address 315 1/2 W. Main St.  
Farington, New Mexico

By Albert R. Greer  
Title Field Sup't.

UNITED STATES DEPARTMENT OF AGRICULTURE  
BUREAU OF ENTOMOLOGY  
WASHINGTON, D. C.

REPORT OF THE ENTOMOLOGICAL SURVEY

The following report was prepared by the Entomological Survey, Bureau of Entomology, United States Department of Agriculture, Washington, D. C., for the purpose of providing information regarding the progress of the survey during the year 1917.

REPORT OF THE ENTOMOLOGICAL SURVEY FOR THE YEAR 1917

By J. H. KROMBEIN, Chief of the Entomological Survey

WASHINGTON, D. C., 1918

Published by the Bureau of Entomology, United States Department of Agriculture

UNITED STATES GOVERNMENT PRINTING OFFICE

1918

The following report was prepared by the Entomological Survey, Bureau of Entomology, United States Department of Agriculture, Washington, D. C., for the purpose of providing information regarding the progress of the survey during the year 1917.

Company Benson-Montin

Lease 078903 Well No. 6

Sec. 35 T. 28 N., R. 12 W., N.M.P.M.

Location 1650' from the North line and 990' from  
the West line.

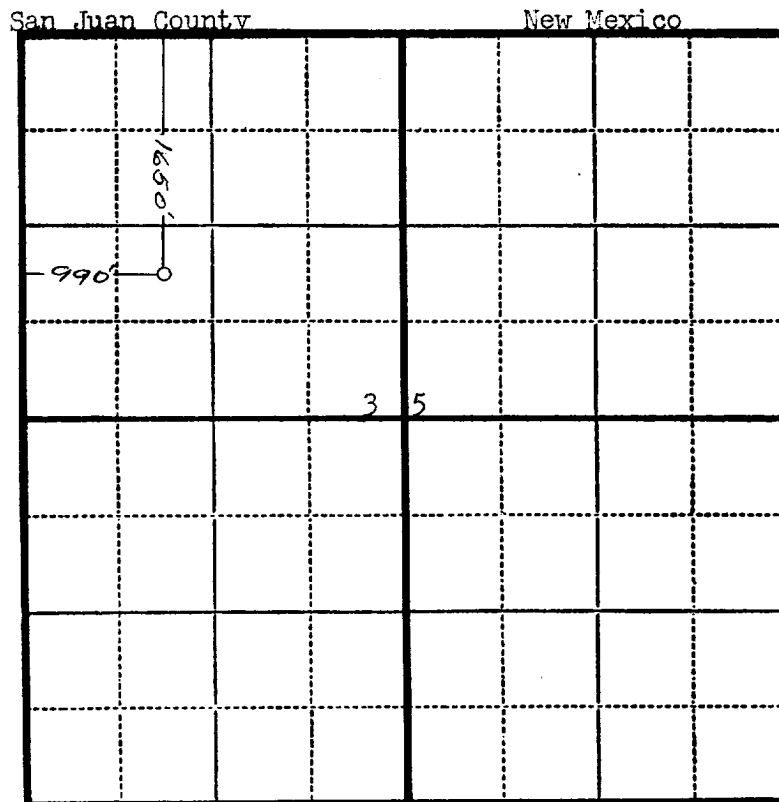

Scale—4 inches equals 1 mile.

This is to certify that the above plat was prepared from field notes of actual surveys made by me or under my supervision and that the same are true and correct to the best of my knowledge and belief.

Seal:

*Charles J. Firklea*  
Registered Professional  
Engineer and Land Surveyor.

Charles J. Firklea  
N. Mex. Reg. No. 1302

Surveyed April 12, 19 52