

(SUBMIT IN TRIPLICATE)

Indian Agency Navajo

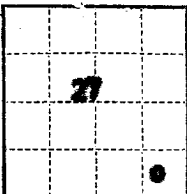

UNITED STATES  
DEPARTMENT OF THE INTERIOR  
GEOLOGICAL SURVEY

Allottee \_\_\_\_\_  
Contract ~~xxx~~ No. 14-20-603-2204

SUNDRY NOTICES AND REPORTS ON WELLS

NOTICE OF INTENTION TO DRILL.....	<input checked="" type="checkbox"/>	SUBSEQUENT REPORT OF WATER SHUT-OFF.....	
NOTICE OF INTENTION TO CHANGE PLANS.....		SUBSEQUENT REPORT OF SHOOTING OR ACIDIZING.....	
NOTICE OF INTENTION TO TEST WATER SHUT-OFF.....		SUBSEQUENT REPORT OF ALTERING CASING.....	
NOTICE OF INTENTION TO REDRILL OR REPAIR WELL.....		SUBSEQUENT REPORT OF REDRILLING OR REPAIR.....	
NOTICE OF INTENTION TO SHOOT OR ACIDIZE.....		SUBSEQUENT REPORT OF ABANDONMENT.....	
NOTICE OF INTENTION TO PULL OR ALTER CASING.....		SUPPLEMENTARY WELL HISTORY.....	
NOTICE OF INTENTION TO ABANDON WELL.....			

(INDICATE ABOVE BY CHECK MARK NATURE OF REPORT, NOTICE, OR OTHER DATA)

April 10, 1961

Well No. 1 is located 440 ft. from XX line and 660 ft. from E line of sec. 27

C SE SE Sec 27 28N 14W NMPS  
(1/4 Sec. and Sec. No.) (Twp.) (Range) (Meridian)  
Wildcat San Juan County New Mexico  
(Field) (County or Subdivision) (State or Territory)

The ~~elevation of the derrick floor above sea level~~ ground level is 9721 ft.

DETAILS OF WORK

(State names of and expected depths to objective sands; show sizes, weights, and lengths of proposed casings; indicate mudding jobs, cementing points, and all other important proposed work)

It is proposed to drill a wildcat well to test the Gallup. If tests indicate that the Gallup is not a producer, the well will be drilled deeper to test the Dakota to an approximate depth of 6000'. Approx 200' of 8-5/8" surface casg will be set and cemented to the top. 4 1/2" or 5 1/2" casg will be set through all possible pays and cemented. All possible producing zones will be adequately tested by S-logs, DST's, etc.

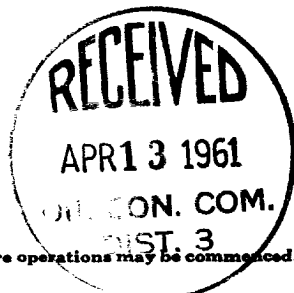

I understand that this plan of work must receive approval in writing by the Geological Survey before operations may be commenced.

Company Gulf Oil Corporation

Address Production Department

Box 1346

Salt Lake City, Utah

By \_\_\_\_\_

ORIGINAL SIGNED  
By: T. A. TRAX

Title Area Production Manager

10/10/2020

10/10/2020

10/10/2020

10/10/2020

10/10/2020

10/10/2020

10/10/2020

10/10/2020

10/10/2020

10/10/2020

10/10/2020

10/10/2020

10/10/2020

10/10/2020

10/10/2020

10/10/2020

10/10/2020

10/10/2020

10/10/2020

10/10/2020

10/10/2020

10/10/2020

10/10/2020

10/10/2020

10/10/2020

10/10/2020

10/10/2020

10/10/2020

10/10/2020

10/10/2020

10/10/2020

10/10/2020

10/10/2020

10/10/2020

10/10/2020

10/10/2020

10/10/2020

10/10/2020

10/10/2020

10/10/2020

10/10/2020

10/10/2020

10/10/2020

10/10/2020

10/10/2020

10/10/2020

10/10/2020

10/10/2020

10/10/2020

10/10/2020

10/10/2020

10/10/2020

10/10/2020

10/10/2020

10/10/2020

10/10/2020

10/10/2020

10/10/2020

10/10/2020

10/10/2020

10/10/2020

10/10/2020

10/10/2020

10/10/2020

10/10/2020

10/10/2020

10/10/2020

10/10/2020

10/10/2020

10/10/2020

10/10/2020

10/10/2020

10/10/2020

10/10/2020

10/10/2020

10/10/2020

10/10/2020

10/10/2020

10/10/2020

10/10/2020

10/10/2020

ORIGINAL SIGNED  
10/10/2020

10/10/2020

10/10/2020

10/10/2020

10/10/2020

10/10/2020

NEW MEXICO OIL CONSERVATION COMMISSION  
Well Location and Acreage Dedication Plat

## SECTION A.

Date April 10, 1961

Operator Gulf Oil Corporation Lease Gulf Mobil ~~Association~~ Ojo Navajo  
Well No. 1 Unit Letter P Section 27 Township 28 North Range 14 West NMPM  
Located 660 Feet From South Line, 660 Feet From East Line  
County San Juan G. L. Elevation 5721 Dedicated Acreage 40 Acres  
Name of Producing Formation Gallup Pool Undesignated Gallup

1. Is the Operator the only owner\* in the dedicated acreage outlined on the plat below? Yes \_\_\_\_\_ No X
2. If the answer to question One is "No," have the interests of all the owners been consolidated by communitization agreement or otherwise? Yes X No \_\_\_\_\_. If answer is "Yes," Type of Consolidation \_\_\_\_\_  
Joint Operating Agreement
3. If the answer to question Two is "No," list all the owners and their respective interests below:

OWNER

LAND DESCRIPTION

## SECTION B.

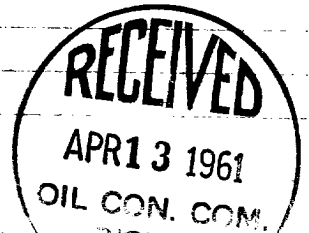
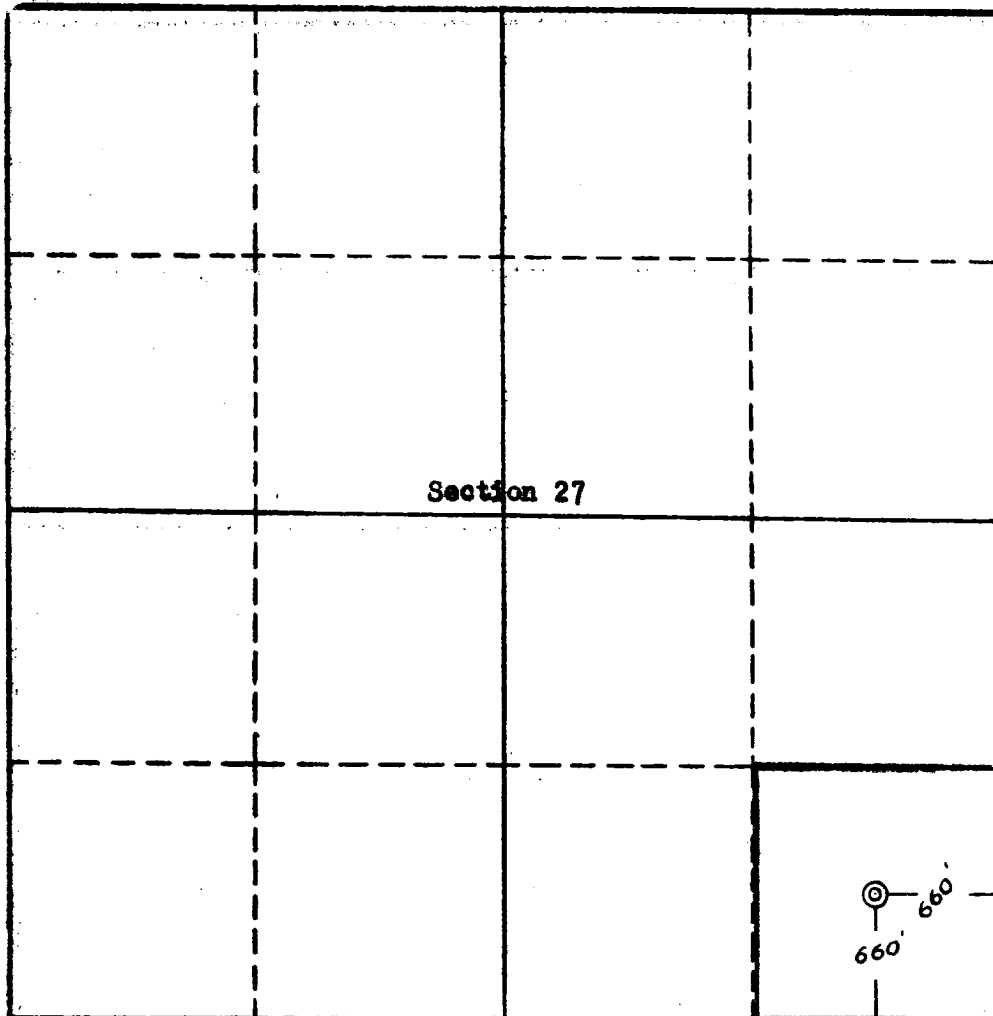

This is to certify that the information in Section A above is true and complete to the best of my knowledge and belief.

Gulf Oil Corporation

(OPERATOR)  
ORIGINAL SIGNED

By: T. A. TRAX

Area Production Manager

Box 1346

Salt Lake City, Utah

(ADDRESS)

This is to certify that the information shown on this plat, which was plotted from field notes of actual survey, is true and correct to the best of my knowledge and belief.

Date Surveyed April 8, 1961Four States Engineering Co.  
FARMINGTON, NEW MEXICOE. L. Potal  
REGISTERED ENGINEER OR  
LAND SURVEYORCertificate No. 3084