

**(SUBMIT IN TRIPLICATE)**

Land Office **Santa Fe**

Lease No. **077968**

Unit **USA C. J. Holder**

UNITED STATES  
DEPARTMENT OF THE INTERIOR  
GEOLOGICAL SURVEY

			X

## SUNDRY NOTICES AND REPORTS ON WELLS

NOTICE OF INTENTION TO DRILL	<input checked="" type="checkbox"/>	SUBSEQUENT REPORT OF WATER SHUT-OFF
NOTICE OF INTENTION TO CHANGE PLANS	<input type="checkbox"/>	SUBSEQUENT REPORT OF SHOOTING OR ACIDIZING
NOTICE OF INTENTION TO TEST WATER SHUT-OFF	<input type="checkbox"/>	SUBSEQUENT REPORT OF ALTERING CASING
NOTICE OF INTENTION TO RE-DRILL OR REPAIR WELL	<input type="checkbox"/>	SUBSEQUENT REPORT OF RE-DRILLING OR REPAIR
NOTICE OF INTENTION TO SHOOT OR ACIDIZE	<input type="checkbox"/>	SUBSEQUENT REPORT OF ABANDONMENT
NOTICE OF INTENTION TO PULL OR ALTER CASING	<input type="checkbox"/>	SUPPLEMENTARY WELL HISTORY
NOTICE OF INTENTION TO ABANDON WELL	<input type="checkbox"/>	

**RECEIVED**  
**FEB 14 1964**  
 U. S. GEOLOGICAL SURVEY  
 FARMINGTON, N.M.

(INDICATE ABOVE BY CHECK MARK NATURE OF REPORT, NOTICE, OR OTHER DATA)

USA C. J. Holder

Farmington, New Mexico February 13, 1958

Well No. 1 is located 990 ft. from S line and 990 ft. from E line of sec.

SE/4 of Section 21

**T-28-N**

**R-13-N**

K.N.P.N.

(1/4 Sec. and Sec. No.)

(Twp.)

(Range)

(Meridian)

## Undesignated Dakota

## San Juan

New Mexico

-----  
(Field)

(County or Subdivision)

(State or Territory)

The elevation of the derrick floor above sea level is \_\_\_\_\_ ft. (To be reported later)

## DETAILS OF WORK

(State names of and expected depths to objective sands; show sizes, weights, and lengths of proposed casings; indicate mudding jobs, cementing points, and all other important proposed work)

We propose to drill the above well to the Dakota formation at a depth of approximately 6400'. Rotary tools will be used to total depth. Stimulation and completion will be as indicated upon reaching this formation.

The following casing program is proposed:

<u>SIZE</u>	<u>DEPTH</u>	<u>CEMENT</u>	<u>REMARKS</u>
8-5/8"	500'	—	Heat circulate to surface.
5-1/2"	6400'	—	150% theoretical amount cement to bring top of cement on 5-1/2" production string about 300' above top of Gallup.

Copies of location plat are attached. A copy of any survey taken will be submitted upon completion of well.

**I understand that this plan of work must receive approval in writing by the Geological Survey before operations may be commenced.**

Company Pan American Petroleum Corporation

Address **Box 487**

Farmington, New Mexico

ORIGINAL SOURCE BY

By D. J. SQUITT

Title Field Clerk

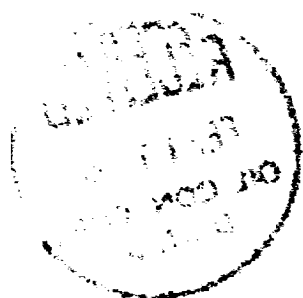

## NEW MEXICO OIL CONSERVATION COMMISSION

## Well Location and Acreage Dedication Plat

Section A.

Date **3 FEBRUARY 1958**

Operator **PAN AMERICAN PETROLEUM CORPORATION** Lease **USA\* G.J. HOLDER**  
 Well No. **1** Unit Letter **P** Section **21** Township **28 NORTH** Range **13 WEST** NMPM  
 Located **990** Feet From **THE SOUTH** Line, **990** Feet From **THE EAST** Line  
 County **SAN JUAN** G. L. Elevation **\*** Dedicated Acreage **160** Acres  
 Name of Producing Formation **Dakota** Pool **Undesignated Dakota**

1. Is the Operator the only owner in the dedicated acreage outlined on the plat below?  
 Yes ☐ No ☒ **\*To be reported later.**
2. If the answer to question one is "no", have the interests of all the owners been consolidated by communitization agreement or otherwise? Yes ☒ No ☐ If answer is "yes", Type of Consolidation.

**Pan American (Operator) and Southern Union Co-Owners.**

3. If the answer to question two is "no", list all the owners and their respective interests below:

Owner

Land Description

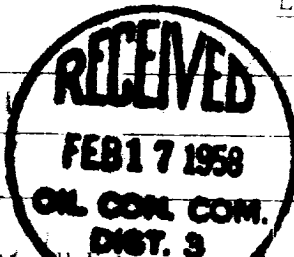

**RECEIVED**  
**FEB 14 1958**  
 U. S. GEOLOGICAL SURVEY  
 FARMINGTON, NEW MEXICO

Section B.

Note: All distances must be from outer boundaries of section.

This is to certify that the information in Section A above is true and complete to the best of my knowledge and belief.

**PAN AMERICAN PETROLEUM CORPORATION**

**E. M. Bauer, Jr.** (Representative)  
**Box 487, Farmington, New Mexico**  
 (Address)

REF. GEO Plat dated: 19 July 1915

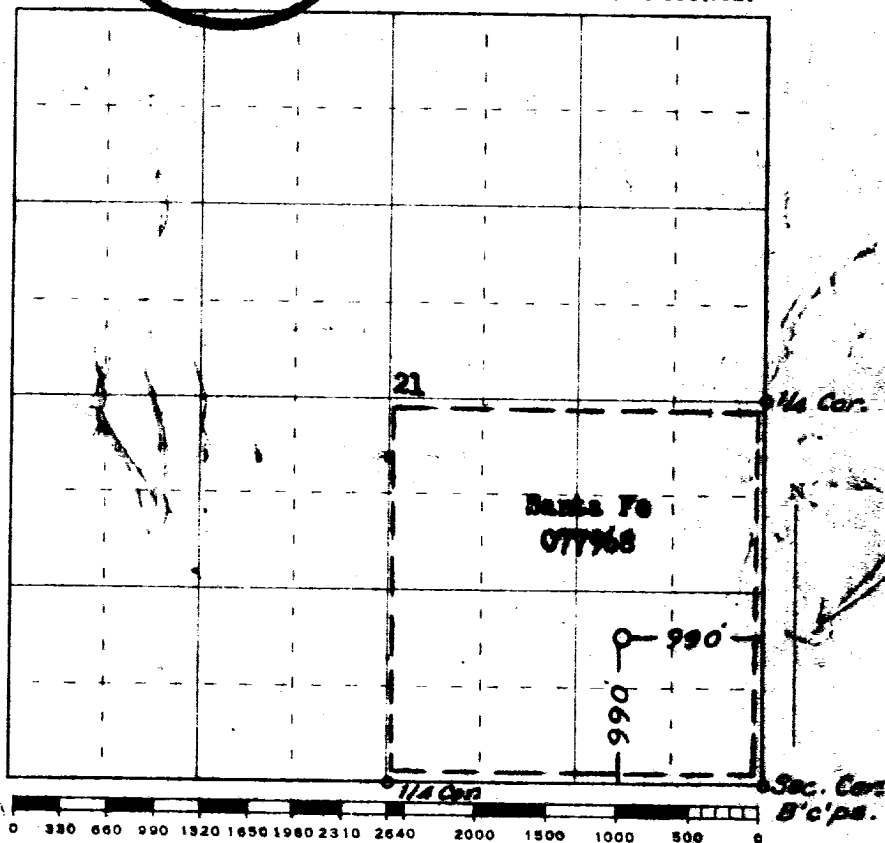

Scale 4 inches equal 1 mile



This is to certify that the above plat was prepared from field notes of actual surveys made by me or under my supervision and that the same are true and correct to the best of my knowledge and belief.

Date Surveyed **1 FEBRUARY 1958**

**James P. Lense**  
 Registered Professional Engineer and/or Land Surveyor  
**JAMES P. LENSE NEW MEX. REG. NO. 2262**