

(SUBMIT IN TRIPLICATE)

UNITED STATES  
DEPARTMENT OF THE INTERIOR  
GEOLOGICAL SURVEY

Land Office **New Mexico**  
Lease No. **MM-09967** & **A 11-**  
Unit **G. L. Davies** **C369374**  
**"B"**

SUNDRY NOTICES AND REPORTS ON WELLS

NOTICE OF INTENTION TO DRILL.....	SUBSEQUENT REPORT OF WATER SHUT-OFF.....
NOTICE OF INTENTION TO CHANGE PLANS.....	SUBSEQUENT REPORT OF SHOOTING OR ACIDIZING.....
NOTICE OF INTENTION TO TEST WATER SHUT-OFF.....	SUBSEQUENT REPORT OF ALTERING CASING.....
NOTICE OF INTENTION TO RE-DRILL OR REPAIR WELL.....	SUBSEQUENT REPORT OF RE-DRILLING OR REPAIR.....
NOTICE OF INTENTION TO SHOOT OR ACIDIZE.....	SUBSEQUENT REPORT OF ABANDONMENT.....
NOTICE OF INTENTION TO PULL OR ALTER CASING.....	SUPPLEMENTARY WELL HISTORY.....
NOTICE OF INTENTION TO ABANDON WELL.....	

AUG 5 1963

U. S. GEOLOGICAL SURVEY  
FARMINGTON, NEW MEXICO

(INDICATE ABOVE BY CHECK MARK NATURE OF REPORT, NOTICE, OR OTHER DATA)

Farmington, New Mexico, July 25 21, 19 63

G. L. Davies "B"  
Well No. **1** is located **1090** ft. from **[N]** line and **1090** ft. from **[E]** line of sec. **27**  
**NE/4 NE/4 Section 27** **T-28-N** **R-13-W** **N.M.P.M.**  
(1/4 Sec. and Sec. No.) (Twp.) (Range) (Meridian)  
**Basin Dakota** **San Juan** **New Mexico**  
(Field) (County or Subdivision) (State or Territory)

RECEIVED  
AUG 6 1963  
CON. COM.  
DIST. 3

The elevation of the derrick floor above sea level is \_\_\_\_\_ ft. (To be reported later)

DETAILS OF WORK

(State names of and expected depths to objective sands; show sizes, weights, and lengths of proposed casings; indicate mudding jobs, cementing points, and all other important proposed work)

We propose to drill the above well to an approximate depth of 6500 feet with rotary tools to evaluate Dakota prospects. Stimulation and completion will be as indicated upon reaching total depth. The following casing program is proposed:

Size	Depth	Cement	Remarks
8-5/8"	350'	225 sk.	Quintrength neat containing 2% Calcium Chloride--Circ.
4-1/2"	6500'	800 sk.	700 sk. Quintrength neat containing 4% gel and 1 1/2 pounds Medium Tuf Plug per sack followed by 100 sk. Quintrength neat.

A copy of any survey taken will be submitted upon completion of well. Copies of location plat are attached.

I understand that this plan of work must receive approval in writing by the Geological Survey before operations may be commenced.

Company **Fan American Petroleum Corporation**

Address **P. O. Box 480**

**Farmington, New Mexico**

Attn: **L. O. Spear, Jr.**

By **ORIGINAL SIGNED BY  
F. H. HOLLINGSWORTH**

Title **Petroleum Engineer**

# NEW MEXICO OIL CONSERVATION COMMISSION

## Well Location and Acreage Dedication Plat

### SECTION A.

Operator **Pan American Petroleum Corporation** Lease **G. L. Davies "B"** Date **July 29, 1963**  
 Well No. **1090** Unit Letter **A** Section **27** Township **28 North** Range **13 West** NMPM  
 Located **1090** Feet From **North** Line **1090** Feet From **East** Line  
 County **San Juan** G. L. Elevation **Report Later** Dedicated Acreage **320** Acres  
 Name of Producing Formation **Dakota** Pool **Basin Dakota**

1. Is the Operator the only owner\* in the dedicated acreage outlined on the plat below? Yes ☐ No ☒ X
2. If the answer to question One is "No," have the interests of all the owners been consolidated by communitization agreement or otherwise? Yes ☒ X No ☐ If answer is "Yes," Type of Consolidation  
**Jointly owned acreage - Southern Union Production Company (Two Leases)**
3. If the answer to question Two is "No," list all the owners and their respective interests below:

OWNER

LAND DESCRIPTION

### SECTION B.

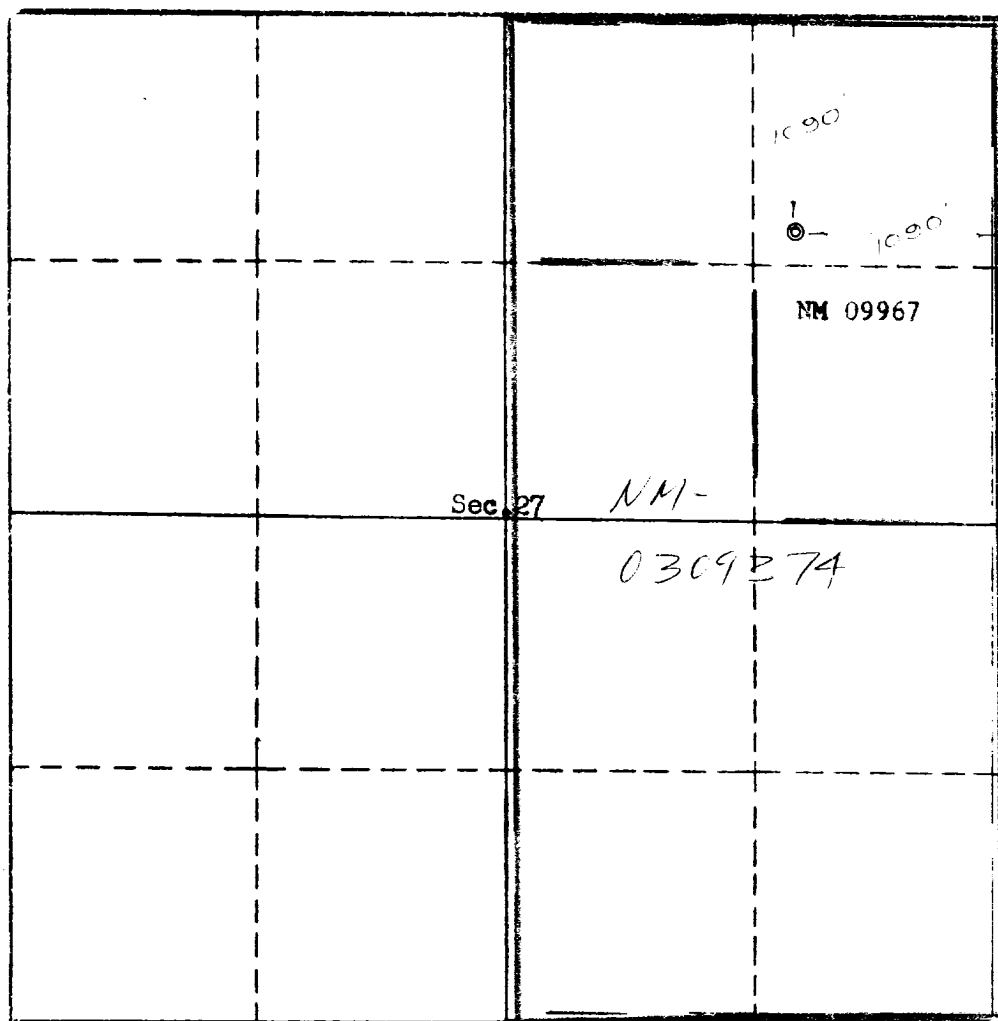

This is to certify that the information in Section A above is true and complete to the best of my knowledge and belief.

**Pan American Petroleum Corp.**  
**F. H. Hollingsworth**  
**Petroleum Engineer**  
**P. O. Box 480**  
**Farmington, New Mexico**

This is to certify that the well location shown on the plat in Section B was plotted from field notes of actual surveys made by me or under my supervision and that the same is true and correct to the best of my knowledge and belief.

Date Surveyed **July 16, 1963**  
**Four States Engineering Co.**  
**FARMINGTON, NEW MEXICO**

**REGISTERED ENGINEER OR LAND SURVEYOR**

Certificate No. **3602**