

(SUBMIT IN TRIPLICATE)

UNITED STATES
DEPARTMENT OF THE INTERIOR
GEOLOGICAL SURVEY

Land Office Santa Fe

Lease No. 078828

Unit I-Sec-844

RECEIVED

JUL 31 1952

SUNDRY NOTICES AND REPORTS ON WELLS

GEOLOGICAL SURVEY
FARMINGTON, N. M.

NOTICE OF INTENTION TO DRILL	<input checked="" type="checkbox"/>	SUBSEQUENT REPORT OF WATER SHUT-OFF
NOTICE OF INTENTION TO CHANGE PLANS	<input type="checkbox"/>	SUBSEQUENT REPORT OF SHOOTING OR ACIDIZING
NOTICE OF INTENTION TO TEST WATER SHUT-OFF	<input type="checkbox"/>	SUBSEQUENT REPORT OF ALTERING CASING
NOTICE OF INTENTION TO RE-DRILL OR REPAIR WELL	<input type="checkbox"/>	SUBSEQUENT REPORT OF REDRILLING OR REPAIR
NOTICE OF INTENTION TO SHOOT OR ACIDIZE	<input type="checkbox"/>	SUBSEQUENT REPORT OF ABANDONMENT
NOTICE OF INTENTION TO PULL OR ALTER CASING	<input type="checkbox"/>	SUPPLEMENTARY WELL HISTORY
NOTICE OF INTENTION TO ABANDON WELL	<input type="checkbox"/>	

(INDICATE ABOVE BY CHECK MARK NATURE OF REPORT, NOTICE, OR OTHER DATA)



July 31

Well No. 16 is located 890 ft. from N line and 1650 ft. from E line of sec. 27

NE 1/4 Sec. 27
(1/4 Sec. and Sec. No.)

28N
(Twp.)

12W
(Range)

NMPM
(Meridian)

New Mexico

West Kutz (EIT)
(Field)

San Juan

(County or Subdivision)

(State or Territory)

The elevation of the derrick floor above sea level is _____ ft. Not available will furnish later.

DETAILS OF WORK

(State names of and expected depths to objective sands; show sizes, weights, and lengths of proposed casings; indicate mudding jobs, cementing points, and all other important proposed work)

Pictured Cliffs or Farmington test. Estimated depth - 800', if completed in Farmington, or 1450' if completed in Pictured Cliffs.
Surface casing: 660' of 8 5/8", cement circulated to surface.
Production casing: If completed in Farmington sand, same as surface casing.
If completed in Pictured Cliffs, 1400' of 14# 5 1/2", cemented with 100 sacks.

We propose to drill this well with cable tools.
If commercial production is indicated, producing section will be shot with nitroglycerin

NE 1/4 of Section 27 - Designated Unit.

I understand that this plan of work must receive approval in writing by the Geological Survey before operations may be commenced.

Company BENSON AND MONTIN
Address 315 1/2 West Main St.
1901 Farmington, N. M.
Farmington, New Mexico

By Albert R. Greer
Albert R. Greer
Title Field Supt.

RECEIVED

JUL 31 1952

U. S. GEOLOGICAL SURVEY
FARMINGTON, N. M.

Company Benson-Montin

Lease _____ Well No. _____

Sec. 27 T. 28 N., R. 12 W., N.M.P.M.

Location 890' from the North line and 1650' from the East line.

San Juan County

New Mexico

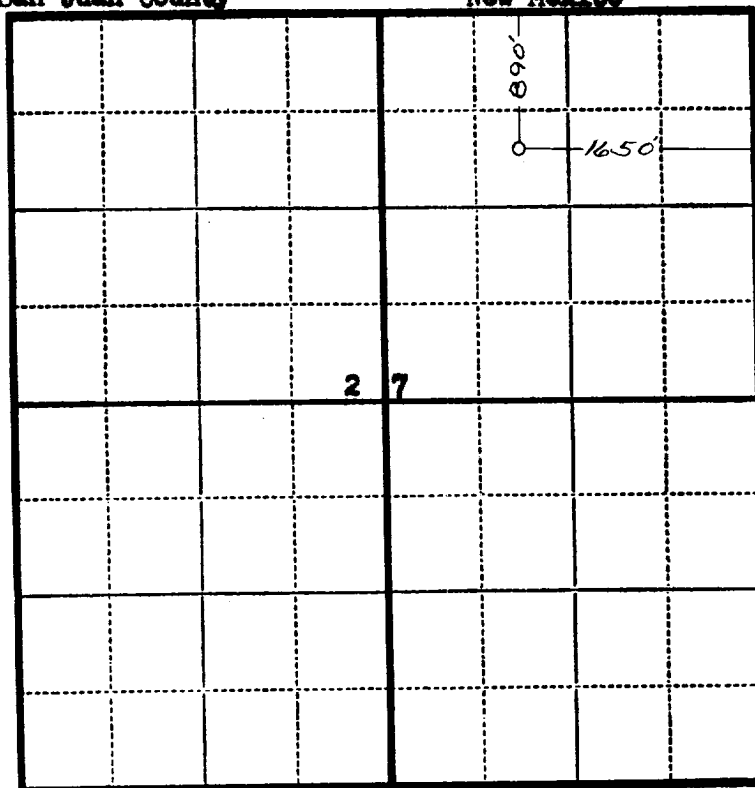

N

Scale—4 inches equals 1 mile.

This is to certify that the above plat was prepared from field notes of actual surveys made by me or under my supervision and that the same are true and correct to the best of my knowledge and belief.

Charles J. Finklea

Seal:

Registered Professional
Engineer and Land Surveyor.

Charles J. Finklea
N. Mex. Reg. No. 1302

Surveyed April 12, 1952