

(SUBMIT IN TRIPLICATE)

UNITED STATES
DEPARTMENT OF THE INTERIOR
GEOLOGICAL SURVEY

Land Office **Santa Fe**
Lease No. **SF-077966**
Unit **Gallegos Canyon Unit**

SUNDRY NOTICES AND REPORTS ON WELLS

NOTICE OF INTENTION TO DRILL.....	<input checked="" type="checkbox"/>	SUBSEQUENT REPORT OF WATER SHUT-OFF.....
NOTICE OF INTENTION TO CHANGE PLANS.....		SUBSEQUENT REPORT OF SHOOTING OR ACIDIZING.....
NOTICE OF INTENTION TO TEST WATER SHUT-OFF.....		SUBSEQUENT REPORT OF ALTERING CASING.....
NOTICE OF INTENTION TO RE-DRILL OR REPAIR WELL.....		SUBSEQUENT REPORT OF RE-DRILLING OR REPAIR.....
NOTICE OF INTENTION TO SHOOT OR ACIDIZE.....		SUBSEQUENT REPORT OF ABANDONMENT.....
NOTICE OF INTENTION TO PULL OR ALTER CASING.....		SUPPLEMENTARY WELL HISTORY.....
NOTICE OF INTENTION TO ABANDON WELL.....		

(INDICATE ABOVE BY CHECK MARK NATURE OF REPORT, NOTICE, OR OTHER DATA)

Gallegos Canyon Unit

Farmington, New Mexico September 14, 1961

Well No. **112** is located **1980** ft. from **S** line and **775** ft. from **E** line of sec. **23**

NE/4 SE/4 Section 23 **T-26-W** **R-13-W** **N.M.P.M.**
(1/4 Sec. and Sec. No.) (Twp.) (Range) (Meridian)

Cha Cha Gallup **San Juan** **New Mexico**
(Field) (County or Subdivision) (State or Territory)

The elevation of the derrick floor above sea level is _____ ft. (To be reported later)

DETAILS OF WORK

(State names of and expected depths to objective sands; show sizes, weights, and lengths of proposed casings; indicate mudding jobs, cementing points, and all other important proposed work)

We propose to drill the above well to approximately 5900' to test and develop production Gallup zones. Stimulation will be as indicated upon penetration of Gallup pay. Rotary tools will be used to total depth. Casing program as follows:

SIZE	DEPTH	CEMENT	REMARKS
8-5/8"	200'	200	Neat - Circulate
4-1/2"	5900'	350	First stage - 125 sacks 6 percent gel with 1-1/2 pounds Tuf Plug per sack with 75 sacks neat on bottom. Second stage - 150 sacks neat cement. 4-1/2" casing to be cemented by the second stage method with the stage tool set about 100' below base of Pictured Cliffs.

Copies of location plats attached. A copy of any survey taken will be submitted upon completion of well.

I understand that this plan of work must receive approval in writing by the Geological Survey before operations may be commenced.

Company **Pan American Petroleum Corporation**

Address **P. O. Box 480**

Farmington, New Mexico

Attn: **L. O. Speer, Jr.**

ORIGINAL SIGNED BY
By **R. M. Bauer, Jr.**

Title **Senior Petroleum Engineer**

Verbal approval received Baier to Glover September 14, 1961.

NEW MEXICO OIL CONSERVATION COMMISSION

Well Location and Acreage Dedication Plat

SECTION A.

Date September 14, 1961

Operator Pan American Petroleum Corporation Lease Gallegos Canyon Unit
Well No. 112 Unit Letter I Section 23 Township 28 North Range 13 West NMPM
Located 1980 Feet From South Line 775 Feet From East Line
County San Juan G. L. Elevation To report later Dedicated Acreage 80 Acres
Name of Producing Formation Gallup Pool Cha Cha Gallup

1. Is the Operator the only owner in the dedicated acreage outlined on the plat below? Yes ☒ No ☐
2. If the answer to question One is "No," have the interests of all the owners been consolidated by communication agreement or otherwise? Yes ☒ No ☐ If answer is "Yes" Type of Consolidation Gallegos Canyon Unit acreage
3. If the answer to question Two is "No," list all the owners and their respective interests below

OWNER

LAND DEED

SECTION B.

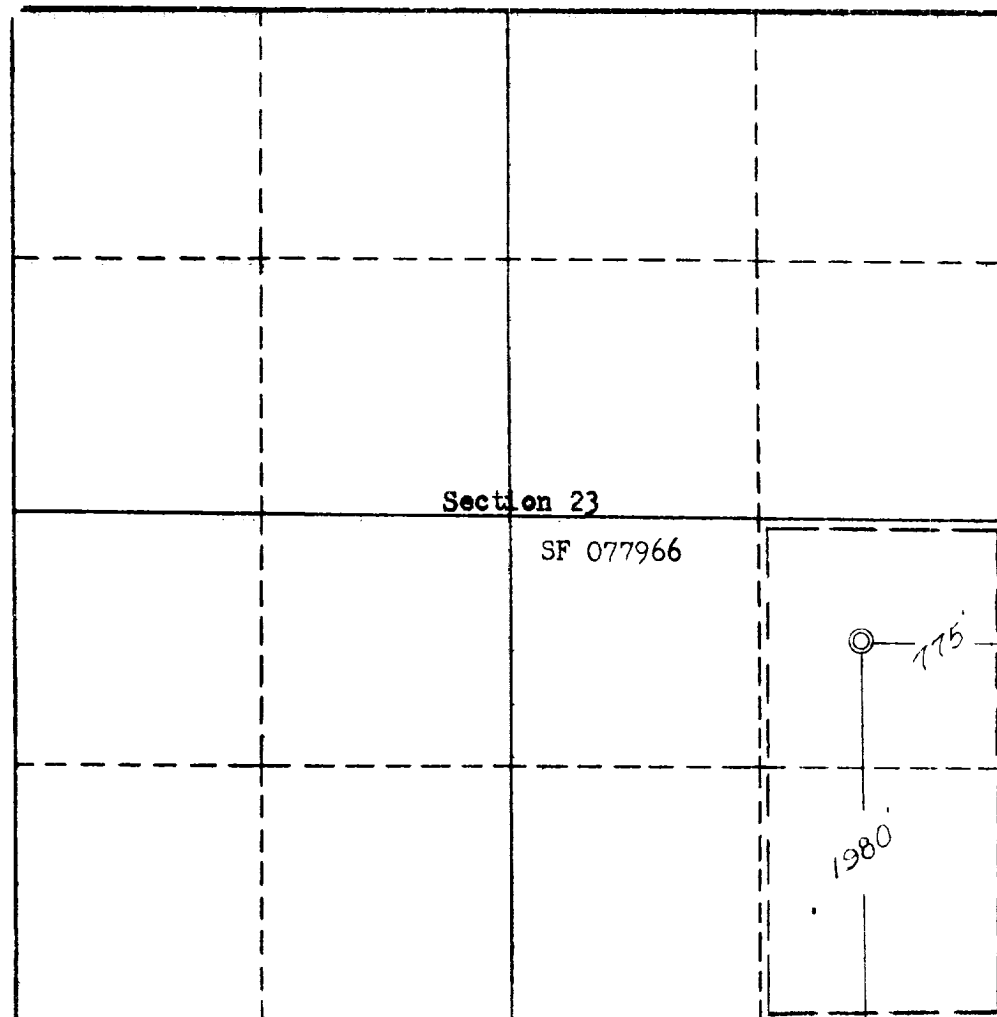

This is to certify that the information in Section A above is true and complete to the best of my knowledge and belief.

Pan American Petroleum Corp.

R. M. Bauer, Jr.
R. M. Bauer, Jr.

Box 480, Farmington, New Mexico

This is to certify that the well location shown on the plat in Section B was plotted from field notes of actual surveys made by me or under my supervision and that the same is true and correct to the best of my knowledge and belief.

Date Surveyed September 2, 1961

Four States Engineering Co.
FARMINGTON, NEW MEXICO

REGISTERED ENGINEER OR LAND SURVEYOR

Certificate No. 3084

