

**CORRECTED COPY**

## Section A.

Date June 29, 1962

Operator **SUNRAY OIL COMPANY** Lease **GALLEGOS CANYON UNIT**  
Well No. **127** Unit Letter **I** Section **21** Township **28 NORTH** Range **12 WEST**, NMPM  
Located **1980** Feet From **the SOUTH** Line, **660** Feet From **the EAST** Line  
County **SAN JUAN** G. L. Elevation **5605.0** Dedicated Acreage \_\_\_\_\_ Acres  
Name of Producing Formation \_\_\_\_\_ Pool **80**  
1. Is the Operator the only owner in the dedicated acreage outlined on the plat below? **Undesignated**

1. Is the Operator the only owner in the dedicated acreage outlined on the plat below?  
Yes            No
2. If the answer to question one is "no", have the interests of all the owners been consolidated by communitization agreement or otherwise? Yes            No           . If answer is "yes", Type of Consolidation:

- [illegible]

U. S. GEOLOGICAL SURVEY  
BUREAU OF MINES, NEW MEXICO

## Section B.\*

Note: All distances must be from outer boundaries of section.

This is to certify that the information in Section A above is true and complete to the best of my knowledge and belief.

~~Surrey BX 611 Company~~  
(Operator)

(Operator)

(Representative

~~200 Petr. Club Plaza Bldg.~~  
(Address)

(Address)

**Farmington, New Mexico**

Ref: GLO ~~plnt~~ dated 19 July 1915

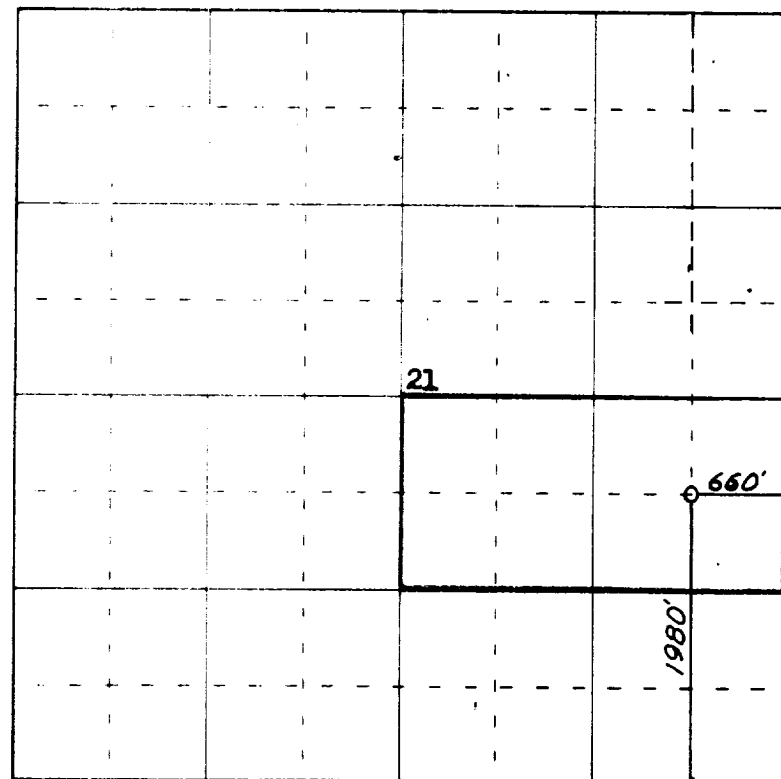
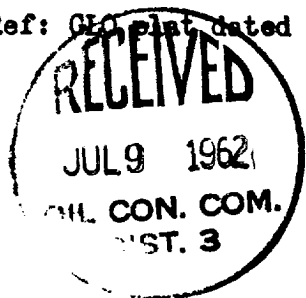

**N**

Scale 4 inches equal 1 mile

This is to certify that the above plat was prepared from field notes of actual surveys made by me or under my supervision and that the same are true and correct to the best of my knowledge and belief.

Date Surveyed 1 June 1962

Registered Professional Engineer and/or Land Surveyor  
James P. Leese N. Max. Reg. No. 1463

**Farlington, New Mexico**