

(SUBMIT IN TRIPLICATE)  
UNITED STATES  
DEPARTMENT OF THE INTERIOR  
GEOLOGICAL SURVEY

Land Office Santa Fe  
Lease No. 078828  
Unit I-Sec. 244  
Gallegos Canyon Unit

## SUNDRY NOTICES AND REPORTS ON WELLS

NOTICE OF INTENTION TO DRILL	<input checked="" type="checkbox"/>	SUBSEQUENT REPORT OF WATER SHUT-OFF	
NOTICE OF INTENTION TO CHANGE PLANS		SUBSEQUENT REPORT OF SHOOTING OR ACIDIZING	
NOTICE OF INTENTION TO TEST WATER SHUT-OFF		SUBSEQUENT REPORT OF ALTERING CASING	
NOTICE OF INTENTION TO RE-DRILL OR REPAIR WELL		SUBSEQUENT REPORT OF REDRILLING OR REPAIR	
NOTICE OF INTENTION TO SHOOT OR ACIDIZE		SUBSEQUENT REPORT OF ABANDONMENT	
NOTICE OF INTENTION TO PULL OR ALTER CASING		SUPPLEMENTARY WELL HISTORY	
NOTICE OF INTENTION TO ABANDON WELL			

(INDICATE ABOVE BY CHECK MARK NATURE OF REPORT, NOTICE, OR OTHER DATA)

March 11, 19 54

Well No. 67 is located 1150 ft. from N line and 1650 ft. from E line of sec. 22

NW/4 NE/4 Sec. 22 28N 12W N.M.P.M.  
(1/4 Sec. and Sec. No.) (Twp.) (Range) (Meridian)  
West Kute San Juan New Mexico  
(Field) (County or Subdivision) (State or Territory)

The elevation of the derrick floor above sea level is \_\_\_\_\_ ft. (Not available. Will furnish later).

### DETAILS OF WORK

(State names of and expected depths to objective sands; show sizes, weights, and lengths of proposed casings; indicate mudding jobs, cementing points, and all other important proposed work)

Pictured (Cliffs Sand test. Estimated depth 1550'.

Surface Casing: 90' of 10-3/4" OD 32.75# new casing, cemented with 80 sacks circulated to surface.

Production Casing: Approximately 1500' of used 6-5/8" OD 20# casing cemented to surface.

If commercial production is indicated, producing section will be shot with nitroglycerin.

I understand that this plan of work must receive approval in writing by the Geological Survey before operations may be commenced.

Company BENSON-MONTIN  
Address 315 1/2 West Main  
Farmington, New Mexico

By Albert J. Green  
Title Field Superintendent

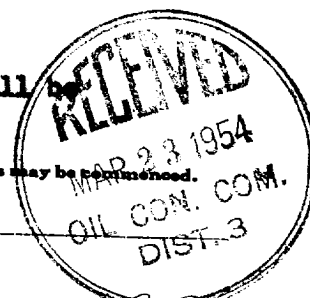



Company WILLIAMSON OIL FIELD

Lease WILLIAMSON CANYON UNIT Well No. 67

Sec. 22, T. 28 N, R. 12 E

Location 1150 Feet from north line; 1650 feet  
from east line.

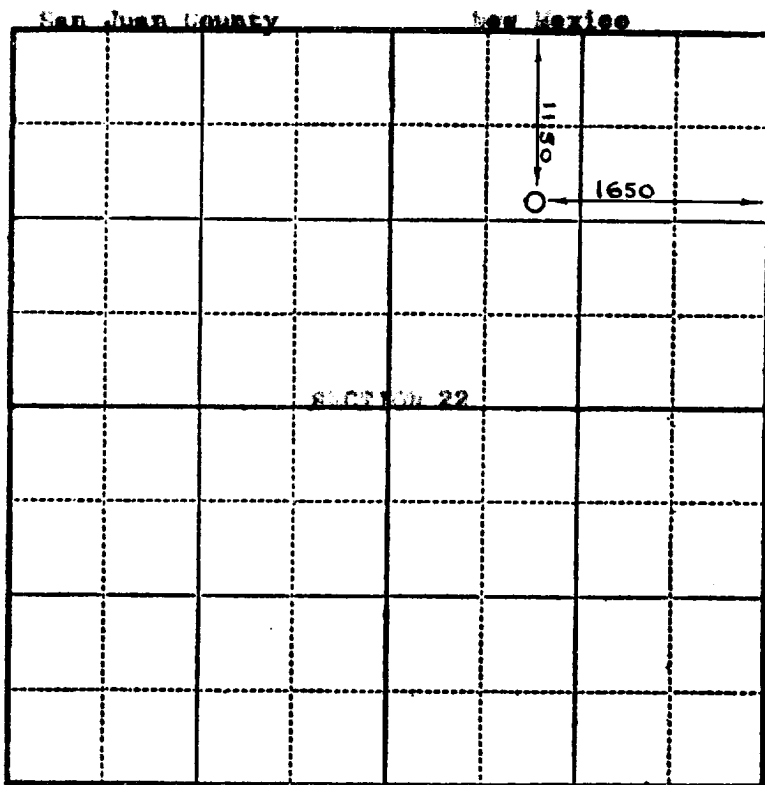

Scale—4 inches equal 1 mile.

This is to certify that the above plat was prepared from field notes of actual surveys made by me or under my supervision and that the same are true and correct to the best of my knowledge and belief.

*Stephen H. Kinney*

Seal:

Registered Professional  
Engineer and Land Surveyor.



Surveyed February 2, 19 54