

(SUBMIT IN TRIPLICATE)

Land Office **Santa Fe**
File No. **3F-077966**
Gallegos Canyon Unit

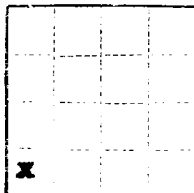

UNITED STATES
DEPARTMENT OF THE INTERIOR
GEOLOGICAL SURVEY

SUNDRY NOTICES AND REPORTS ON WELLS

NOTICE OF INTENTION TO DRILL <input checked="" type="checkbox"/>	SUBSEQUENT REPORT OF WATER SHUT-OFF
NOTICE OF INTENTION TO CHANGE PLANS	SUBSEQUENT REPORT OF SHOOTING OR ACIDIZING
NOTICE OF INTENTION TO TEST WATER SHUT-OFF	SUBSEQUENT REPORT OF ALTERING CASING
NOTICE OF INTENTION TO RE-DRILL OR REPAIR WELL	SUBSEQUENT REPORT OF RE-DRILLING OR REPAIR
NOTICE OF INTENTION TO SHOOT OR ACIDIZE	SUBSEQUENT REPORT OF ABANDONMENT
NOTICE OF INTENTION TO PULL OR ALTER CASING	SUPPLEMENTARY WELL HISTORY
NOTICE OF INTENTION TO ABANDON WELL	

(INDICATE ABOVE BY CHECK MARK NATURE OF REPORT, NOTICE, OR OTHER DATA)

Gallegos Canyon Unit

Farmington, New Mexico September 12, 1961

Well No. **113** is located **510** ft. from **S** line and **510** ft. from **E** line of sec. **14**
SW/4 SW/4 of Section 14 T-28-N R-13-W N.M.P.M.
(1/4 Sec. and Sec. No.) (Twp.) (Range) (Meridian)

Cha Cha Gallup
(Field)

San Juan
(County or Subdivision)

New Mexico
(State or Territory)

The elevation of the derrick floor above sea level is _____ ft. (To be reported later)

DETAILS OF WORK

(State names of and expected depths to objective sands; show sizes, weights, and lengths of proposed casings; indicate mudding jobs, cementing points, and all other important proposed work)

We propose to drill the above well to approximately 5900' to test and develop production Gallup zones. Stimulation will be as indicated upon penetration of Gallup pay. Rotary tools will be used to total depth. Casing program as follows:

SIZE	DEPTH	CEMENT	REMARKS
8-5/8"	200'	110-160	Neat - Circulate
4-1/2"	5900'	200	First stage - 125 sacks 6 percent gel with 1-1/2 pounds Tuf Plug per sack with 75 sacks neat on bottom.

Second stage - 150 sacks neat cement, 4-1/2" casing to be cemented by the second stage method with the stage tool set about 100' below base of Pictured Cliffs.

Copies of location plats attached. A copy of any survey taken will be submitted upon completion of well.

I understand that this plan of work must receive approval in writing by the Geological Survey before operations may be commenced.

Company **Pan American Petroleum Corporation**

Address **P. O. Box 480**

Farmington, New Mexico

By _____

Attn: **L. O. Speer, Jr.**

Title **Senior Petroleum Engineer**

Verbal approval received Krah1 to Glover September 12, 1961.

NEW MEXICO OIL CONSERVATION COMMISSION

Well Location and Acreage Dedication Plat

SECTION A.

Date **September 12, 1961**

Operator **Pan American Petroleum Corporation** Lease **Gallegos Canyon Unit**
Well No. **113** Unit Letter **M** Section **14** Township **28 North** Range **13 West** NMPM
Located **510** Feet From **South** Line **510** Feet From **West** Line
County **San Juan** G. L. Elevation **to report later** Dedicated Acreage **80** Acres
Name of Producing Formation **Gallup** Pool **Cha Cha Gallup**

1. Is the Operator the only owner* in the dedicated acreage outlined on the plat below? Yes ☒ No ☐
2. If the answer to question One is "No," have the interests of all the owners been consolidated by communication agreement or otherwise? Yes ☒ No ☐ If answer is "Yes," Type of Consolidation **Gallegos Canyon Unit acreage**
3. If the answer to question Two is "No," list all the owners and their respective interests below:

OWNER

LAND DEED RECORD



SECTION B.

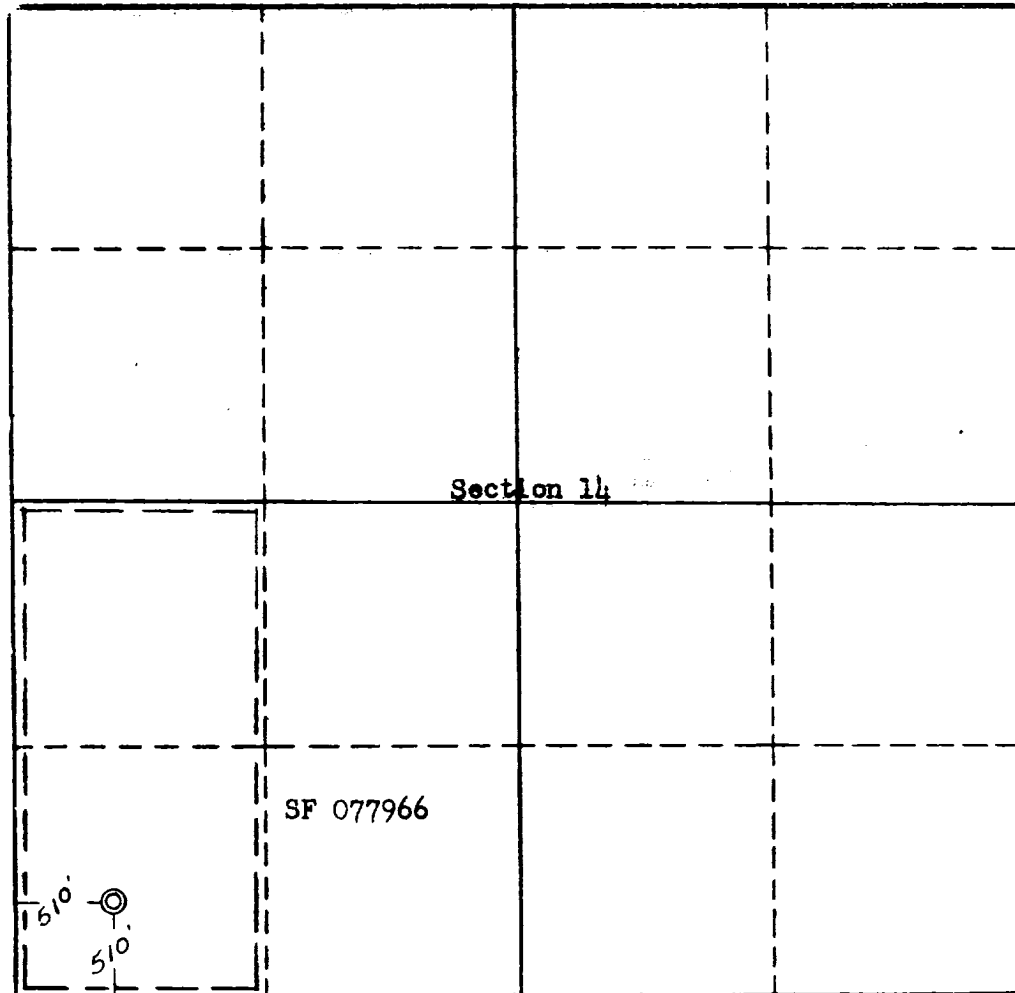

This is to certify that the information in Section A above is true and complete to the best of my knowledge and belief

Pan American Petroleum Corp.

R. M. Bauer, Jr.
R. M. Bauer, Jr.

Box 480, Farmington, New Mexico

This is to certify that the location shown on the plat in Section B was plotted from field notes of actual survey made by me under my supervision and that the same is true and correct to the best of my knowledge and belief

Date Surveyed **September 2, 1961**

Four States Engineering Co.

FARMINGTON, NEW MEXICO

REGISTERED PROFESSIONAL LAND SURVEYOR

Certificate No. **3084**

