

(SUBMIT IN TRIPLICATE)

UNITED STATES
DEPARTMENT OF THE INTERIOR
GEOLOGICAL SURVEY

Land Office Santa Fe
Lease No. 37-077968
Unit C. J. Holder

SUNDRY NOTICES AND REPORTS ON WELLS

NOTICE OF INTENTION TO DRILL	<input checked="" type="checkbox"/>	SUBSEQUENT REPORT OF WATER SHUT-OFF	
NOTICE OF INTENTION TO CHANGE PLANS		SUBSEQUENT REPORT OF SHOOTING OR ACIDIZING	
NOTICE OF INTENTION TO TEST WATER SHUT-OFF		SUBSEQUENT REPORT OF ALTERING CASING	
NOTICE OF INTENTION TO RE-DRILL OR REPAIR WELL		SUBSEQUENT REPORT OF RE-DRILLING OR REPAIR	
NOTICE OF INTENTION TO SHOOT OR ACIDIZE		SUBSEQUENT REPORT OF ABANDONMENT	
NOTICE OF INTENTION TO PULL OR ALTER CASING		SUPPLEMENTARY WELL HISTORY	
NOTICE OF INTENTION TO ABANDON WELL			

(INDICATE ABOVE BY CHECK MARK NATURE OF REPORT, NOTICE, OR OTHER DATA)

C. J. Holder

Farmington, New Mexico

May 23, 19 61

Well No. 14 is located 810 ft. from S line and 2130 ft. from W line of sec. 16

SE/4 SW/4 of Section 16T-28-N

4-13-N

S.M.P.M.

(1/4 Sec. and Sec. No.)

(Twp.)

(Range)

(Meridian)

Cha Cha Gallup

San Juan

New Mexico

(Field)

(County or Subdivision)

(State or Territory)

The elevation of the derrick floor above sea level is _____ ft. (To be reported later.)

DETAILS OF WORK

(State names of and expected depths to objective sands; show sizes, weights, and lengths of proposed casings; indicate mudding jobs, cementing points, and all other important proposed work)

We propose to drill the above well to approximately 5850' to test and develop production Gallup zones. Stimulation will be as indicated upon penetration of Gallup pay. Rotary tools will be used to total depth. Casing program as follows:

SIZE	DEPTH	CEMENT	REMARKS
8-5/8"	200'	110-160	Neat - circulate.
4-1/2"	5850'	225	6 percent gel with 1-1/2 pounds tuf plug per sack with 100 sacks neat on bottom

Copies of location plate attached. A copy of any survey taken will be submitted upon completion of well.

I understand that this plan of work must receive approval in writing by the Geological Survey before operations may be commenced.

Company Pan American Petroleum Corporation

Address Box 480

Farmington, New Mexico

Attn: L. C. Speer, Jr.

By _____

Title Senior Petroleum Engineer

NEW MEXICO OIL CONSERVATION COMMISSION

Well Location and Acreage Dedication Plat

SECTION A.

Date May 22, 1961

Operator Pan American Petroleum Corporation

Lease C. J. Holder

Well No. 14 Unit Letter N Section 16

Township 28 North Range 13 West NMPM

Located 810 Feet From South Line 2130 Feet From West Line

County San Juan G. L. Elevation To report later Dedicated Acreage 80 Acres

Name of Producing Formation Gallup Pool Cha Cha Gallup

1. Is the Operator the only owner* in the dedicated acreage outlined on the plat below? Yes ☒ No ☐
2. If the answer to question One is "No," have the interests of all the owners been consolidated by communication agreement or otherwise? Yes ☒ No ☐ If answer is "Yes," Type of Consolidation Co-owner Southern Union Production Company
3. If the answer to question Two is "No," list all the owners and their respective interests below:

OWNER

LAND DESCRIPTION

SECTION B.

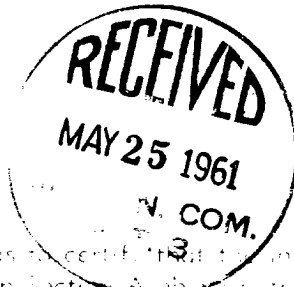
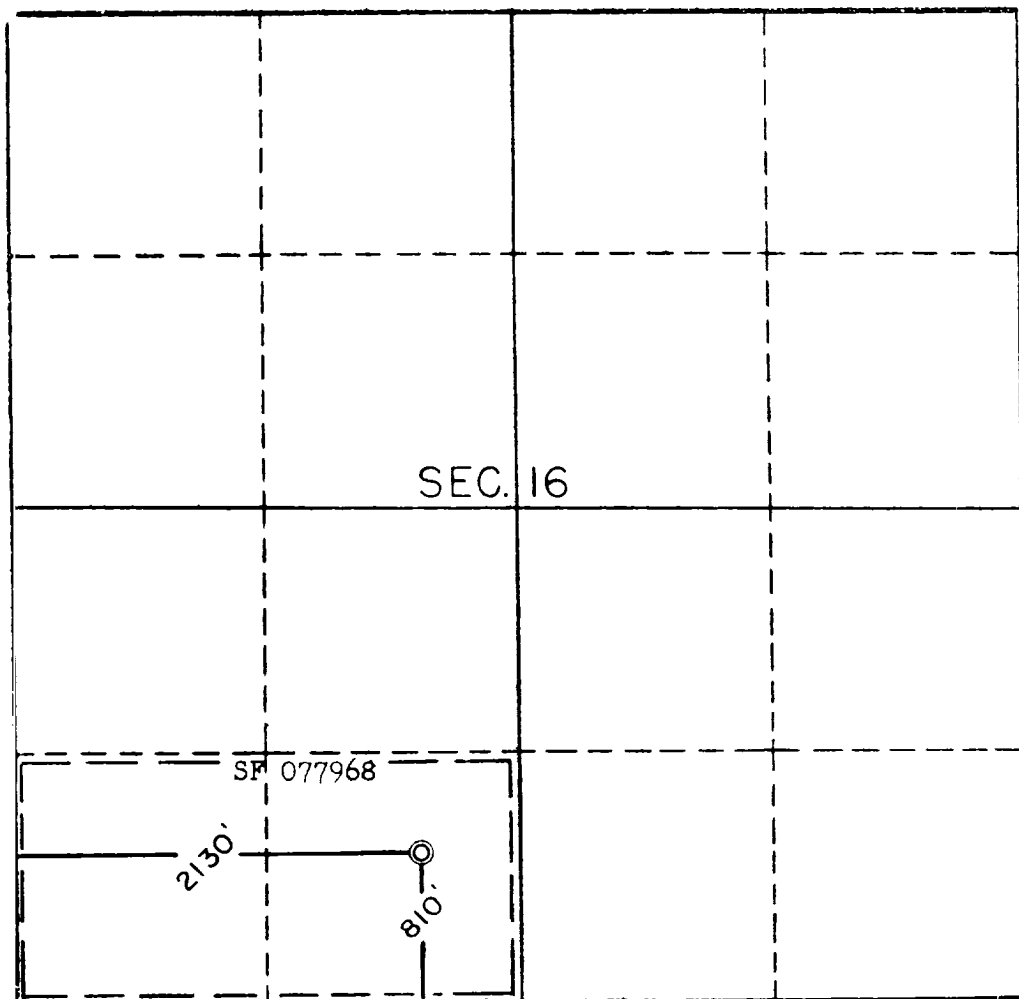

This is to certify that the information in Section A above is true and complete to the best of my knowledge and belief.

Pan American Petroleum Corp.

R. M. Bauer, Jr.

R. M. Bauer, Jr.

Box 480, Farmington, New Mexico

This is to certify that the well location shown on the plat in Section B was plotted from a survey of actual surveys made and in accordance with my supervision and that the same is true and correct to the best of my knowledge and belief.

Date Surveyed May 18, 1961

Four States Engineering Co.

FARMINGTON, NEW MEXICO

REGISTERED ENGINEER
LAND SURVEYOR

Certificate No. 3084

