

(SUBMIT IN TRIPLICATE)

UNITED STATES  
DEPARTMENT OF THE INTERIOR  
GEOLOGICAL SURVEY

Land Office **Santa FE**  
Lease No. **84-09979**  
Unit **Robinson**

SUNDRY NOTICES AND REPORTS ON WELLS

NOTICE OF INTENTION TO DRILL	<input checked="" type="checkbox"/>	SUBSEQUENT REPORT OF WATER SHUT-OFF	
NOTICE OF INTENTION TO CHANGE PLANS		SUBSEQUENT REPORT OF SHOOTING OR ACIDIZING	
NOTICE OF INTENTION TO TEST WATER SHUT-OFF		SUBSEQUENT REPORT OF ALTERING CASING	
NOTICE OF INTENTION TO RE-DRILL OR REPAIR WELL		SUBSEQUENT REPORT OF RE-DRILLING OR REPAIR	
NOTICE OF INTENTION TO SHOOT OR ACIDIZE		SUBSEQUENT REPORT OF ABANDONMENT	
NOTICE OF INTENTION TO PULL OR ALTER CASING		SUPPLEMENTARY WELL HISTORY	
NOTICE OF INTENTION TO ABANDON WELL			

(INDICATE ABOVE BY CHECK MARK NATURE OF REPORT, NOTICE, OR OTHER DATA)

February 5, 1961

Well No. **2-4** is located **1960** ft. from **MX** line and **600** ft. from **W** line of sec. **15**  
**SW $\frac{1}{4}$ , Section 15** **28N** **13W** **S.A.P.M.**  
 (¼ Sec. and Sec. No.) (Twp.) (Range) (Meridian)  
**Chaco Gallup** **San Juan** **New Mexico**  
 (Field) (County or Subdivision) (State or Territory)

The elevation of the derrick floor above sea level is **5009** ft. (Ground Elevation)

DETAILS OF WORK

(State names of and expected depths to objective sands; show sizes, weights, and lengths of proposed casings; indicate mudding jobs, cementing points, and all other important proposed work)

Propose To:

Set 300 feet of  $6 \frac{3}{8}$ " surface casing and cement to surface. Drill with rotary to approximate total depth of 5000 feet or through Gallup formation. Set  $4 \frac{1}{2}$ " production casing at total depth and cement with 250 sz. Set two-stage cement collar approximately 100 feet below the Pictured Cliffs formation and cement with 150 sz.

Perforate Gallup formation with four shots per foot. Sand-oil frac with 50,000/ sand and 50,000 gals. oil. Run  $2 \frac{1}{8}$ " tubing.

West one-half of the SW $\frac{1}{4}$  of Section 15, 80 acres, dedicated to well.

I understand that this plan of work must receive approval in writing by the Geological Survey before operations may be commenced.

Company **Astec Oil and Gas Company**  
 Address **Drawer 570**  
**Farmington, New Mexico**  
 By **ORIGINAL SIGNED BY JOE C. SALMON**  
**Joe C. Salmon**  
 Title **District Superintendent**

# NEW MEXICO OIL CONSERVATION COMMISSION

## Well Location and Acreage Dedication Plat

SECTION A.

Date February 6, 1961

Operator AZTEC OIL & GAS CO.

Lease \_\_\_\_\_

Well No. 9-2 Unit Letter L Section 15 Township 28-North Range 13-West NMPM

Located 1980 Feet From South Line, 660 Feet From West Line

County Santa Fe G. L. Elevation 6089 Dedicated Acreage 80 Acres

Name of Producing Formation Gallup Pool Ch-Cha Gallup

1. Is the Operator the only owner\* in the dedicated acreage outlined on the plat below? Yes IX No \_\_\_\_\_

2. If the answer to question One is "No," have the interests of all the owners been consolidated by communitization agreement or otherwise? Yes \_\_\_\_\_ No \_\_\_\_\_ If answer is "Yes," Type of Consolidation \_\_\_\_\_

3. If the answer to question Two is "No," list all the owners and their respective interests below:

OWNER

LAND DESCRIPTION

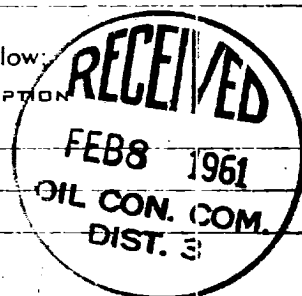

SECTION B.

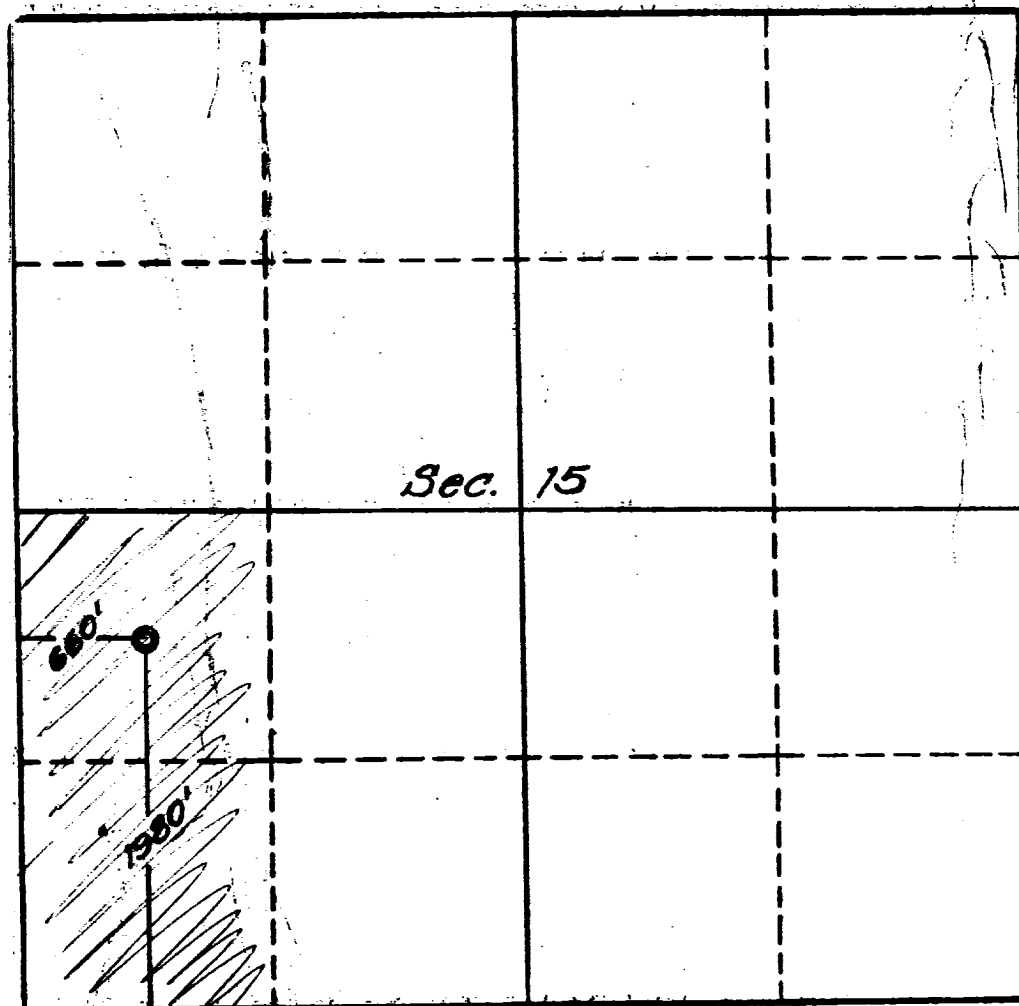

This is to certify that the information in Section A above is true and complete to the best of my knowledge and belief.

Aztec Oil and Gas Co.

(OPERATOR)

ORIGINAL SIGNED BY JOE C. SALMON

Aztec Oil & Gas Company

P. O. Drawer 570

Farmington, New Mexico

(ADDRESS)

This is to certify that the well location shown on the plat in Section B was plotted from field notes of actual surveys made by me or under my supervision and that the same is true and correct to the best of my knowledge and belief.

Date Surveyed Feb 6 1961

Four States Engineering Co.  
FARMINGTON, NEW MEXICO

E. J. Edwards  
REGISTERED ENGINEER OR  
LAND SURVEYOR

Certificate No. 1545

